

| REVISION HISTORY | | | |
|------------------|-----------|---------|----------------|
| REV | DATE | BY | DESCRIPTION |
| B | 23MAY2023 | SAK/DMS | PRN:P2023-0949 |

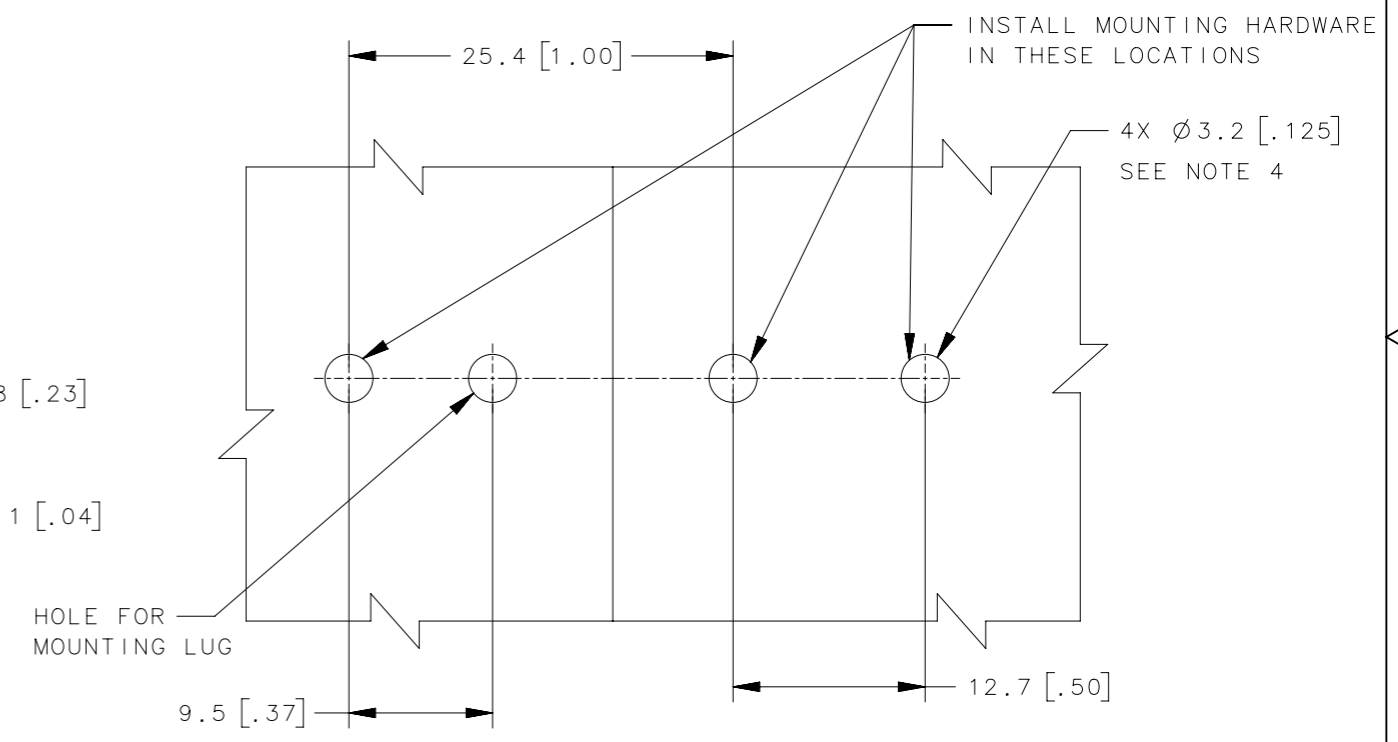

PANEL PREPARATION

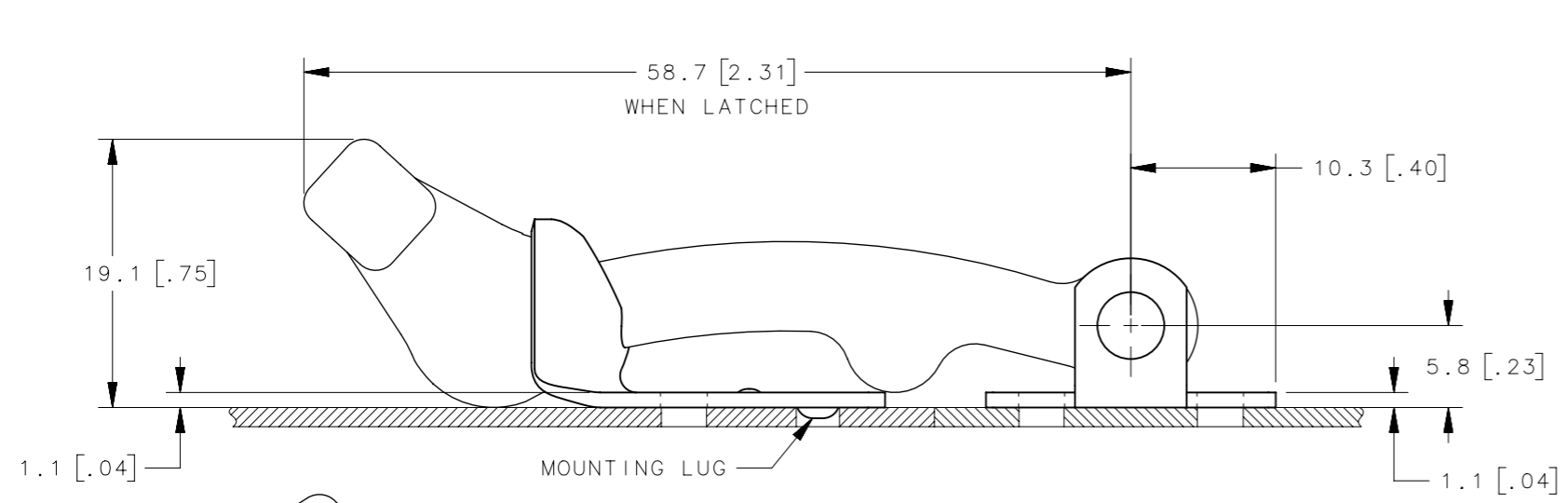
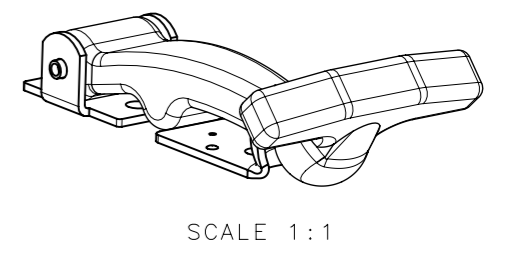
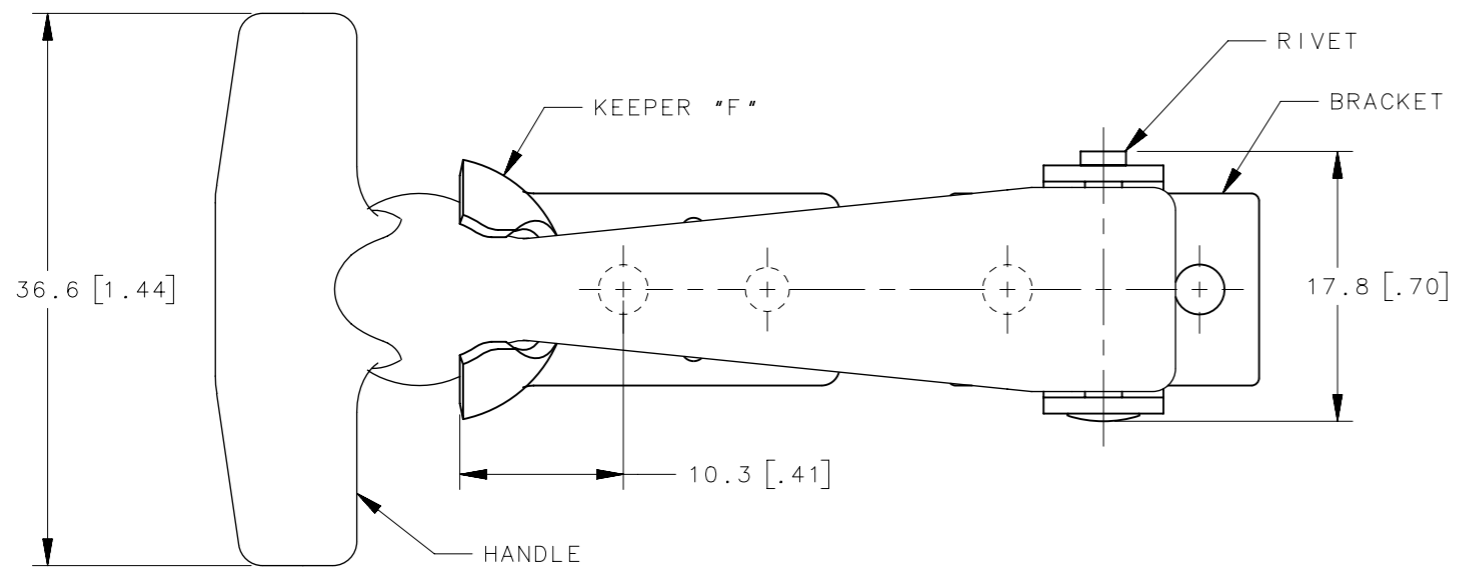
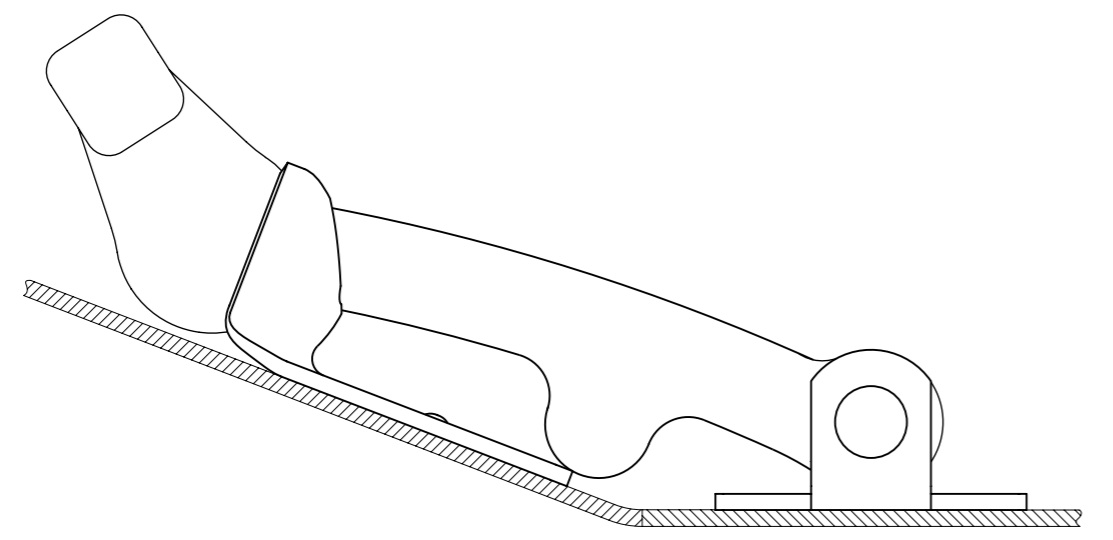

- NOTES:
- LATCH PACKAGED ONE HANDLE SUB-ASSEMBLY AND ONE KEEPER PER BAG. FOR BULK PACKAGING: ORDER HANDLE SUB-ASSEMBLY AND KEEPER PART NUMBERS SEPARATELY.
 - STEEL, ZINC PLATE, BRIGHT CHROMATE PLUS SEALER.
 - STAINLESS STEEL, PASSIVATED.
 - INSTALL USING THREE M3 OR NO.4 SCREWS (NOT SUPPLIED).

| | | | | | |
|------------------|---------------------|--------------------|------------|-------------------|------------|
| 37-15-061-24 | KEEPER | - | - | - | SEE NOTE 3 |
| 37-11-065-20 | HANDLE SUB-ASSEMBLY | EPDM RUBBER, BLACK | SEE NOTE 3 | ALUMINUM, NATURAL | - |
| 37-10-065-20 | LATCH, ASSEMBLED | - | - | - | - |
| 37-15-061-17 | KEEPER | - | - | - | SEE NOTE 2 |
| 37-11-065-10 | HANDLE SUB-ASSEMBLY | EPDM RUBBER, BLACK | SEE NOTE 2 | ALUMINUM, NATURAL | - |
| 37-10-065-10 | LATCH, ASSEMBLED | - | - | - | - |
| PART NUMBER | TYPE OF COMPONENT | HANDLE | BRACKET | RIVET | KEEPER |
| MATERIAL, FINISH | | | | | |

| | | | | | |
|---|--|---|-------------------|---------------------|-----------------|
| THIRD ANGLE PROJECTION | | southco [®] CONNECT • CREATE • INNOVATE | | | |
| MILLIMETERS [IN] | | | | | |
| TOLERANCES UNLESS OTHERWISE NOTED | | DESCRIPTION 37 FLEXIBLE DRAW LATCH 060 SERIES, T-HANDLE | | | |
| ALL DIMENSIONS WITHOUT TOLERANCES ARE FOR REFERENCE ONLY. | | | | | |
| PROPRIETARY ITEM <small>EXCEPT FOR USES EXPRESSLY GRANTED IN WRITING, INFORMATION DISCLOSED HEREON IS CONFIDENTIAL AND ALL RIGHTS, PATENT AND OTHERWISE, ARE RESERVED BY SOUTHCO, INC.</small> | | SIZE A3 | SYSTEM NX | DWG NO. J-37-065 | |
| PER ASME Y14.5M-1994 | | DRAWN BY DMS/YGC | DATE 13JAN2016 | SCALE 2:1 | SHEET 1 OF 1 |