

REVISION HISTORY			
REV	DATE	BY	DESCRIPTION
E	21AUG2018	CBI/DMS	PRN: P2018-1972

TORX® IS A REGISTERED TRADEMARK OF ACUMENT™ INTELLECTUAL PROPERTIES, LLC.

PART NUMBER 52-SM-A3111-K SHOWN



SCALE 1:1

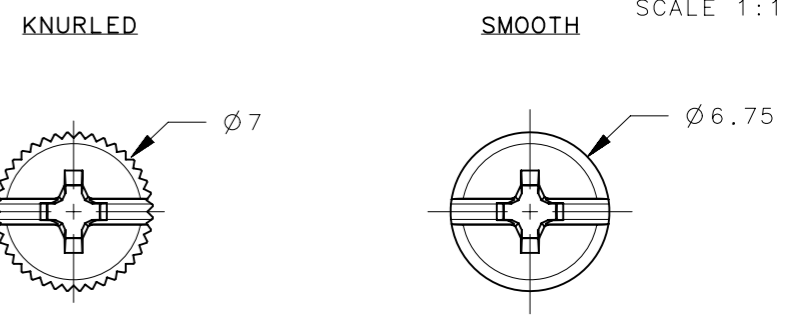

No. 2 PHILLIPS/SLOT RECESS No. 2 PHILLIPS/SLOT RECESS

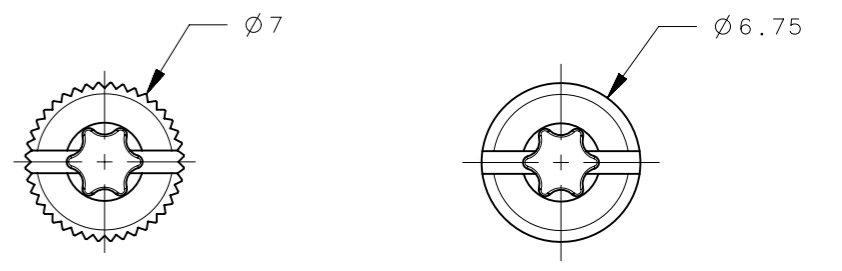

T15 TORX®/SLOT RECESS T15 TORX®/SLOT RECESS

***X* SCREW RECESS AND KNOB STYLE**

- 3 - No.2 PHILLIPS/SLOT RECESS
- 4 - T15 TORX/SLOT RECESS

***D* KNURL STYLE**

- K - KNURL
- N - SMOOTH

***F* SKIRT LENGTH**

- R - MAIN REEL
- T - MAIN TRAY

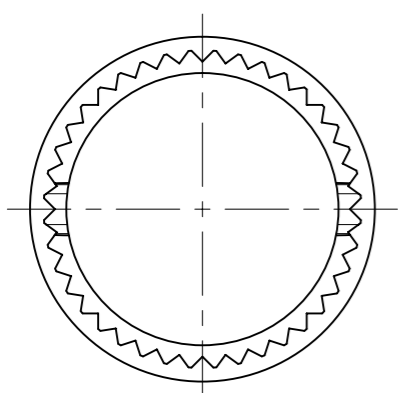

POLYIMIDE PATCH TAPE ON TOP SURFACE OF SCREW FOR VACUUM PICK UP

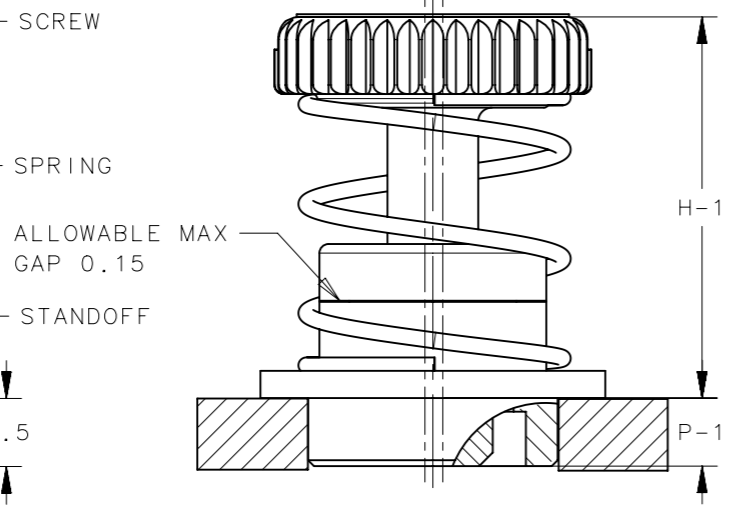
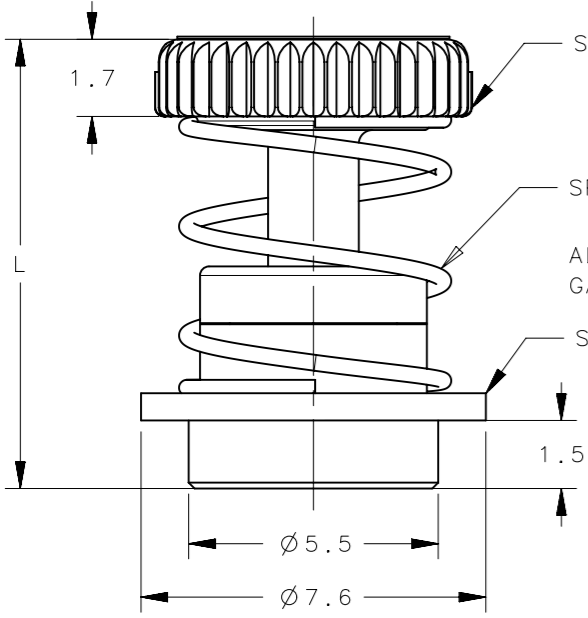
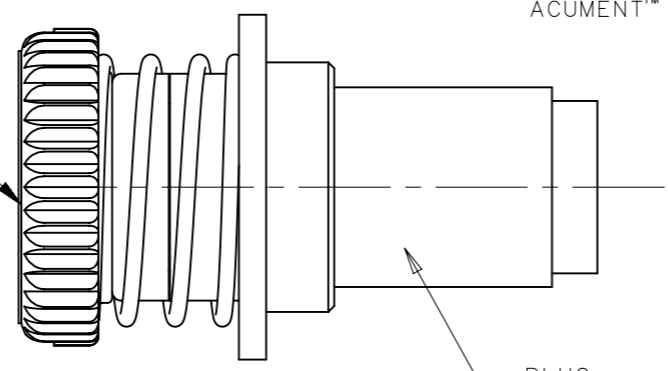

UNFASTENED

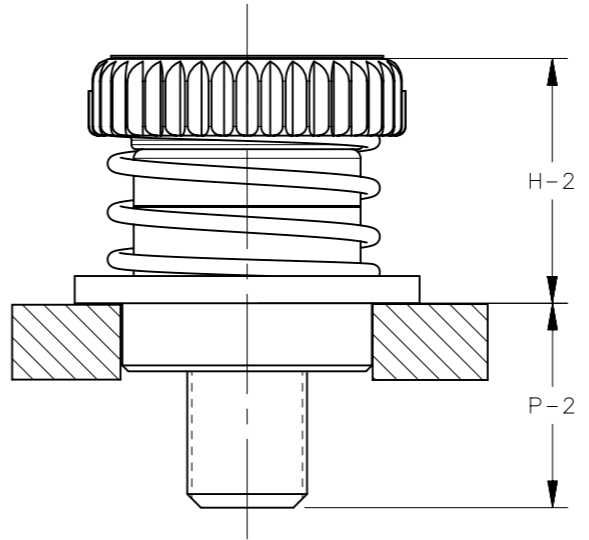

FASTENED

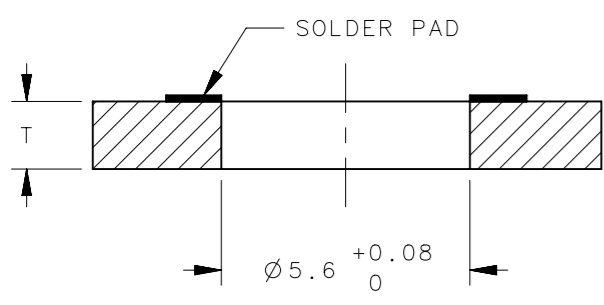

PANEL PREPARATION

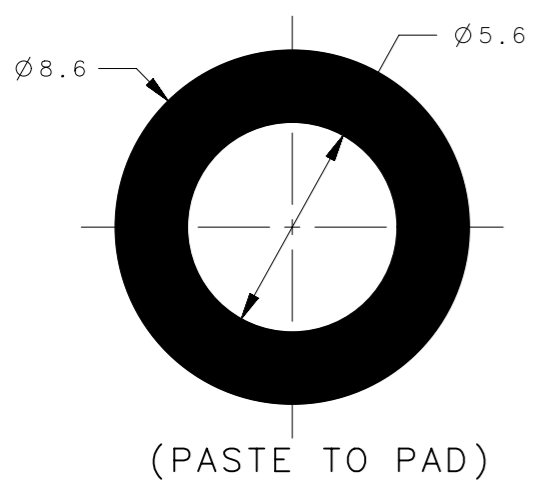

NOTES:

- A. MATERIAL AND FINISH: ROHS COMPLIANT
 SCREW: STEEL, HARDENED, ZINC PLATE PLUS SEALER
 SPRING: 300 SERIES STAINLESS STEEL, PASSIVATED
 STANDOFF: STEEL, TIN PLATE
 PLUG: SILICONE RUBBER
 PATCH: POLYIMIDE
- B. INSTALLATION INSTRUCTION:
 1. PREPARE HOLE AND SOLDER PAD AS SHOWN. HOLE DIAMETER, INCLUDING TOLERANCE, IS FINAL SIZE.
 2. PRINT THE PCB BOARD WITH SOLDER PASTE. THE SOLDER PASTE SHOULD COVER THE SOLDER PAD.
 3. SMT MACHINE TO PICK AND PLACE THE WHOLE SCREW WITH PATCH AND PLUG INTO LOCATED PANEL HOLES.
 4. THE PC BOARDS WILL CONTINUE THROUGH THE SET UP HEAT SOLDERING CHAMBER AND FINISH THE CYCLE. MAXIMUM TEMP 535°F (280°C).
 5. THE PATCH AND PLUG ON SCREW WILL BE REMOVED AFTER SOLDERING DONE AND CANNOT BE REUSED.
 6. TO REMOVE THE PLUG: PULL SCREW HEAD UP TO UNFASTENED POSITION, THEN THE PLUG CAN BE PULLED OFF EASILY.
- C. TORX® IS REGISTERED TRADEMARK OF ACUMENT™ INTELLECTUAL PROPERTIES, LLC.
- D. COSMETIC SPECIFICATION: ALL SURFACES (UNLESS OTHERWISE SPECIFIED) ARE TO BE PER SOUTHCO SPECIFICATION S-121-02, CLASS B, STANDOFF CLASS C (REFER TO SECTION 1.0 FOR CROSS REFERENCE TABLE).
- E. SEE PAGE 2 FOR PACKAGE INFORMATION.
- F. RECOMMENDED MAXIMUM TORQUE OF 60 N-cm.

52-SM-A3X11-D-F	9.9	8.4	5.4	1.6	1.5	4.5
PART NUMBER	L	H-1	H-2	T	P-1	P-2
THIRD ANGLE PROJECTION						
MILLIMETERS [IN]						
TOLERANCES UNLESS OTHERWISE NOTED		DESCRIPTION				
UP TO 0.5 ±0.1		No.52 LOW PROFILE CAPTIVE FASTENER				
OVER 0.5 UP TO 6 ±0.2		SMT STYLE, M3 THREAD				
OVER 6 UP TO 30 ±0.4		SIZE	SYSTEM	DWG NO.		
OVER 30 ±0.6		A3	NX	J-52-SM-A-M3		
ANGLES ±5°		DRAWN BY		DATE	SCALE	SHEET
PER ASME Y14.5M-1994		MAL/JQ		28APR2016	6:1	1 OF 2

EXCEPT FOR USES EXPRESSLY GRANTED IN WRITING, INFORMATION DISCLOSED HEREON IS CONFIDENTIAL AND ALL RIGHTS, PATENT AND OTHERWISE, ARE RESERVED BY SOUTHCO, INC.

REVISION HISTORY			
REV	DATE	BY	DESCRIPTION
E	21AUG2018	CBI/DMS	PRN: P2018-1972

TRAY PACKAGE: 120 PIECES PER TRAY

REEL PACKAGE: 13 INCH REEL PER EIA-481, 200 PIECES PER REEL 00-149-21155

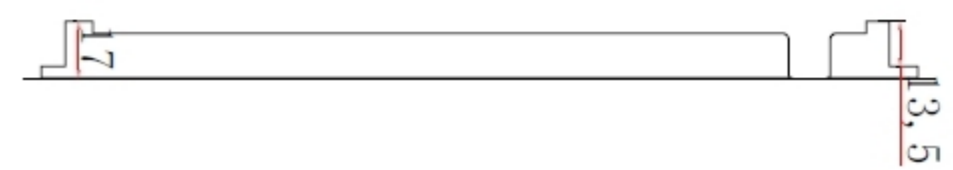
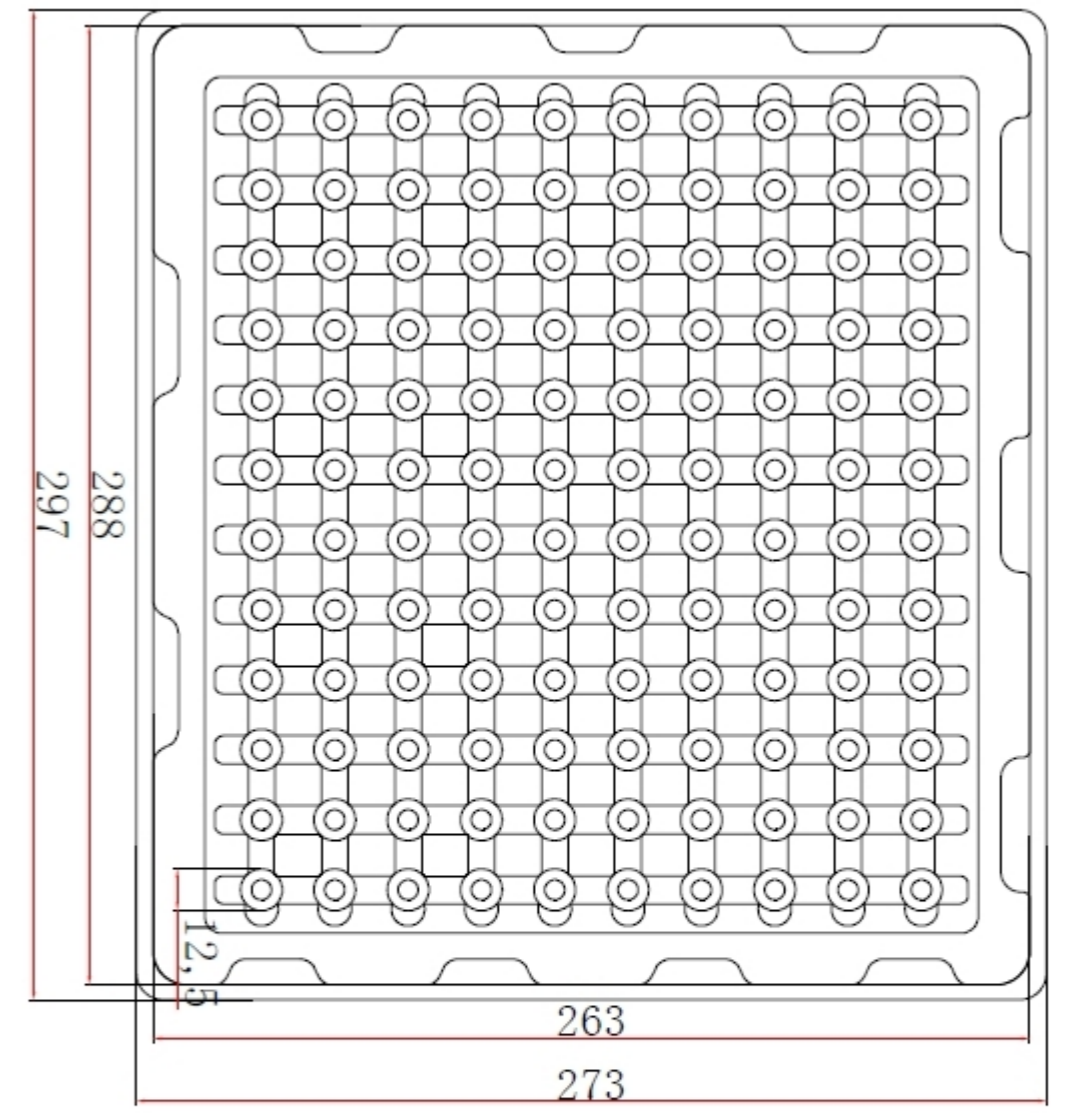
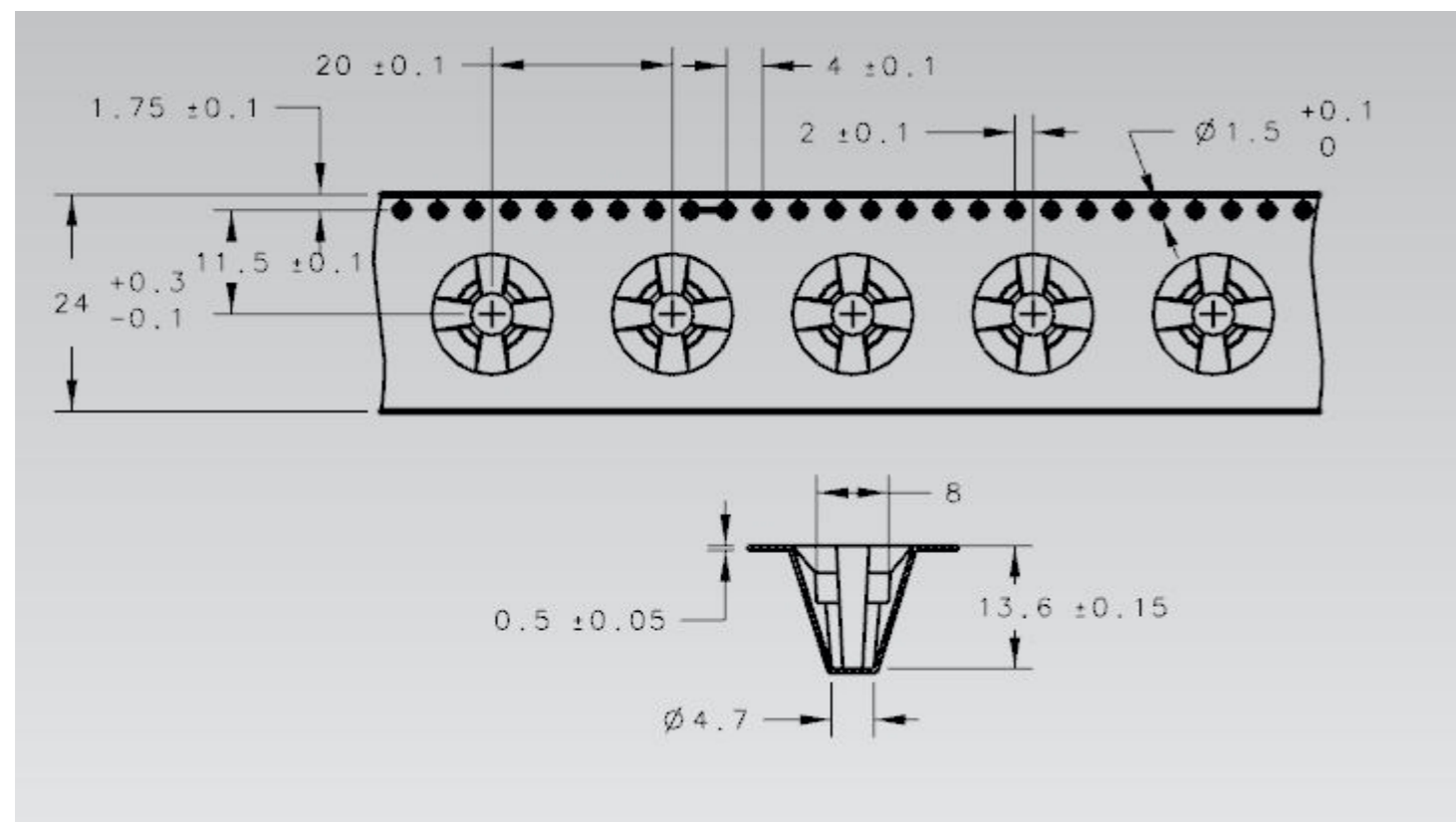

	THIRD ANGLE PROJECTION			southco [®] CONNECT • CREATE • INNOVATE	
	MILLIMETERS [IN]				
SURFACE AREA	TOLERANCES UNLESS OTHERWISE NOTED		DESCRIPTION		
VOLUME	UP TO 0.5 ±0.1 OVER 0.5 UP TO 6 ±0.2 OVER 6 UP TO 30 ±0.4 OVER 30 ±0.6 ANGLES ±5°		No.52 LOW PROFILE CAPTIVE FASTENER SMT STYLE, M3 THREAD		
PROPRIETARY ITEM	PER ASME Y14.5M-1994		SIZE	SYSTEM	DWG NO.
EXCEPT FOR USES EXPRESSLY GRANTED IN WRITING, INFORMATION DISCLOSED HEREON IS CONFIDENTIAL AND ALL RIGHTS, PATENT AND OTHERWISE, ARE RESERVED BY SOUTHCO, INC.			A3	NX	J-52-SM-A-M3
			DRAWN BY	DATE	SCALE
			MAL/JQ	28APR2016	NTS
					SHEET 2 OF 2