

REVISION HISTORY			
REV	DATE	BY	DESCRIPTION
B	13JUN2017	CJ/JQ	PRN: P2017-1086

PART NUMBER 52-SM-A3111-KEEE SHOWN

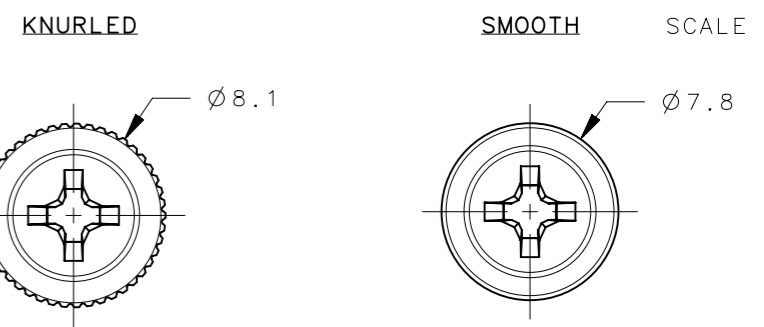

SCALE 1:1



No. 2 PHILLIPS RECESS No. 2 PHILLIPS RECESS

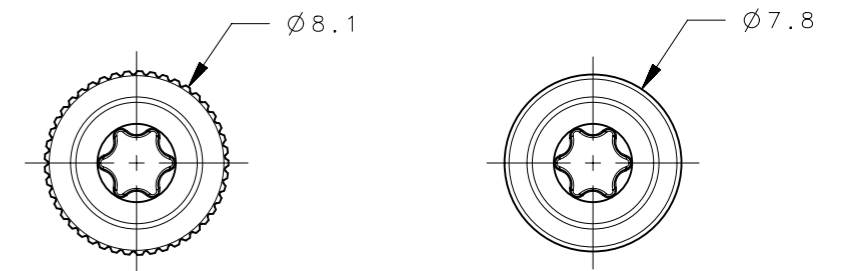

T15 TORX® RECESS T15 TORX® RECESS

TORX® IS A REGISTERED TRADEMARK OF ACUMENT™ INTELLECTUAL PROPERTIES, LLC.

POLYIMIDE PATCH TAPE ON TOP SURFACE OF SCREW FOR VACUUM PICK UP

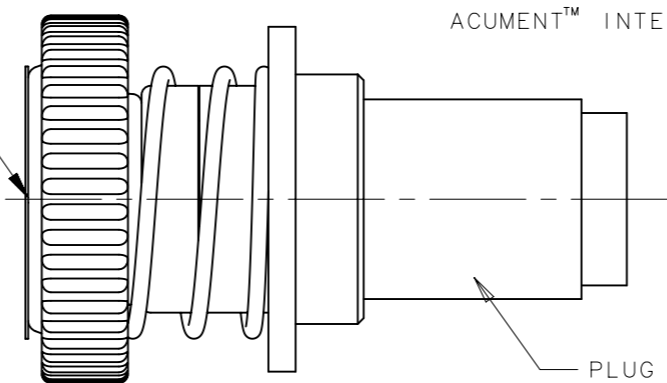

PACKED WITH PLUG

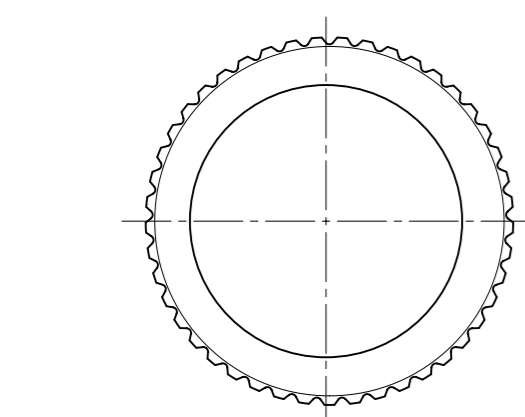

SCREW/KNOB SUBASSEMBLY

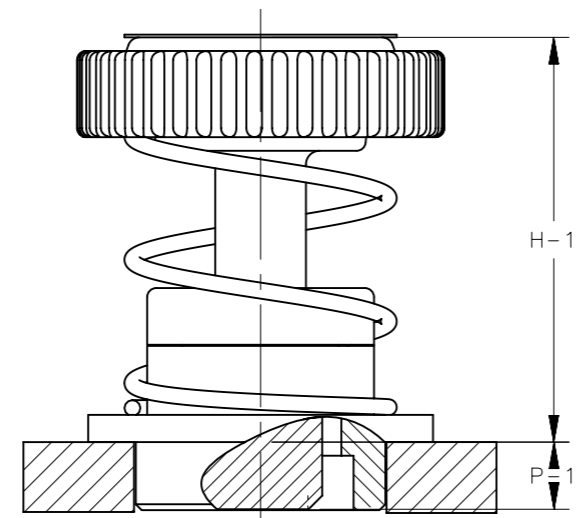
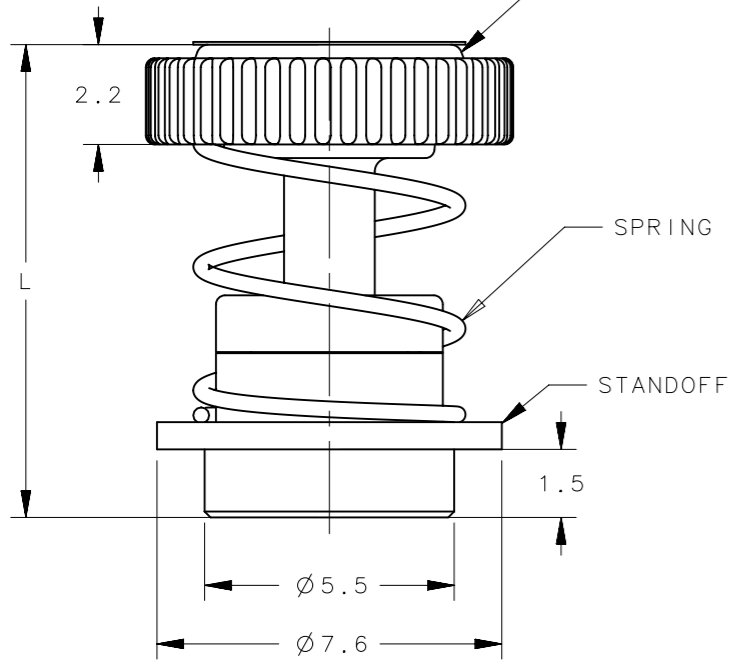

UNFASTENED

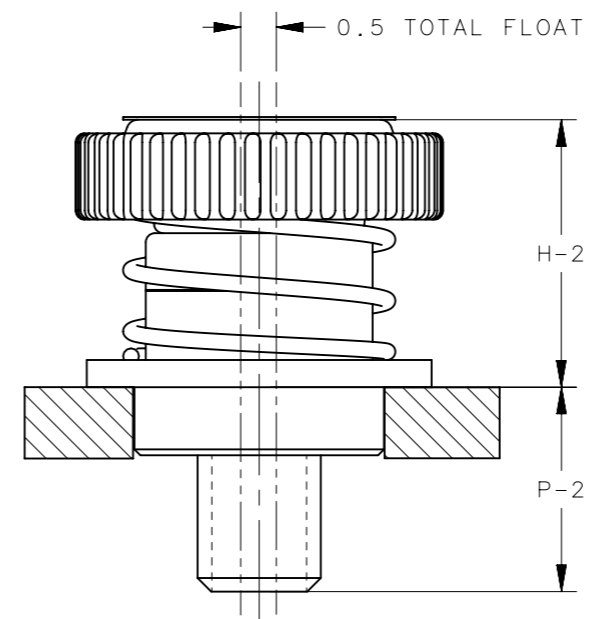

FASTENED

NOTES:

- A. MATERIAL AND FINISH: RoHS COMPLIANT
 SCREW: STEEL, HARDENED, ZINC PLATE PLUS SEALER
 KNOB: HIGH HEAT RESISTANCE PLASTIC
 SPRING: 300 SERIES STAINLESS STEEL, PASSIVATED
 STANDOFF: STEEL, TIN PLATE
 PLUG: SILICONE RUBBER
 PATCH: POLYIMIDE
- B. INSTALLATION INSTRUCTION:
 1. PREPARE HOLE AND SOLDER PAD AS SHOWN. HOLE DIAMETER, INCLUDING TOLERANCE, IS FINAL SIZE.
 2. PRINT THE PCB BOARD WITH SOLDER PASTE. THE SOLDER PASTE SHOULD COVER THE SOLDER PAD.
 3. SMT MACHINE TO PICK AND PLACE THE WHOLE SCREW WITH PATCH AND PLUG INTO LOCATED PANEL HOLES.
 4. THE PC BOARDS WILL CONTINUE THROUGH THE SET UP HEAT SOLDERING CHAMBER AND FINISH THE CYCLE. MAXIMUM TEMP 535°F (280°C).
 5. THE PATCH AND PLUG ON SCREW WILL BE REMOVED AFTER SOLDERING DONE AND CANNOT BE REUSED.
 6. TO REMOVE THE PLUG: PULL SCREW HEAD UP TO UNFASTENED POSITION, THEN THE PLUG CAN BE PULLED OFF EASILY.
- C. TORX® IS REGISTERED TRADEMARK OF ACUMENT™ INTELLECTUAL PROPERTIES, LLC.
- D. COSMETIC SPECIFICATION: ALL SURFACES (UNLESS OTHERWISE SPECIFIED) ARE TO BE PER SOUTHCO SPECIFICATION S-121-02, CLASS B, STANDOFF CLASS C (REFER TO SECTION 1.0 FOR CROSS REFERENCE TABLE).
- E. SEE PAGE 2 FOR PACKAGE INFORMATION.
- F. RECOMMENDED MAXIMUM TORQUE OF 60 N-cm.

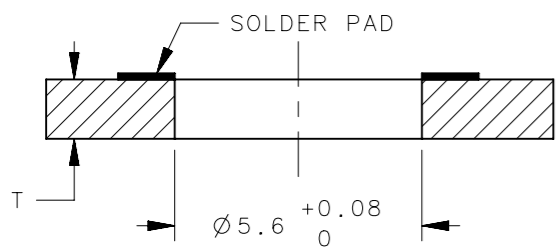

PANEL PREPARATION

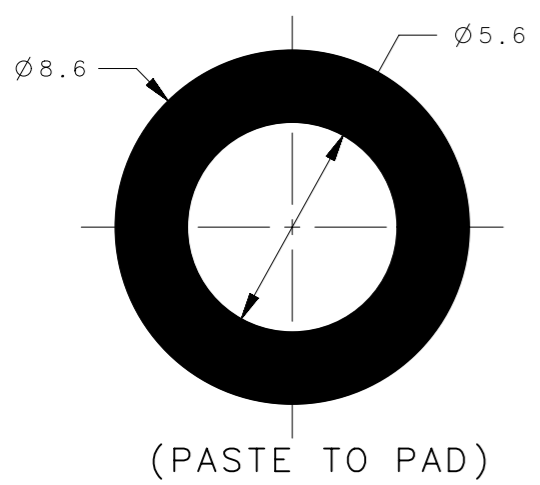

D KNURL STYLE

K - KNURL
 N - SMOOTH

X SCREW RECESS

1 - No.2 PHILLIPS RECESS
 2 - T15 TORX RECESS

EEE KNOB COLOR

SEE J-47-0-3 FOR DETAIL

F PACKAGE

R - MAIN REEL
 T - MAIN TRAY

52-SM-A3X11-DEEE-F	10.4	8.9	5.9	1.6	1.5	4.5
PART NUMBER	L	H-1	H-2	T	P-1	P-2
THIRD ANGLE PROJECTION						
MILLIMETERS [IN]						
TOLERANCES UNLESS OTHERWISE NOTED		DESCRIPTION No.52 LOW PROFILE CAPTIVE FASTENER SMT STYLE, M3 THREAD, OVERMOLDED				
SURFACE AREA	UP TO 0.5	±0.1	SIZE SYSTEM			
VOLUME	OVER 0.5 UP TO 6	±0.2	A3	NX	DWG NO.	
PROPRIETARY ITEM	OVER 6 UP TO 30	±0.4	J-52-SM-A1-M3			
EXCEPT FOR USES EXPRESSLY GRANTED IN WRITING, INFORMATION DISCLOSED HEREON IS CONFIDENTIAL AND ALL RIGHTS, PATENT AND OTHERWISE, ARE RESERVED BY SOUTHCO, INC.	OVER 30 ANGLES	±0.6	DRAWN BY MAL/JQ			
PER ASME Y14.5M-1994		±0.6	DATE 28APR2016		SCALE 6:1	SHEET 1 OF 2



REVISION HISTORY			
REV	DATE	BY	DESCRIPTION
B	13JUN2017	CJ/JQ	PRN: P2017-1086

TRAY PACKAGE: 120 PIECES PER TRAY

REEL PACKAGE: 13 INCH REEL PER EIA-481-D, 200 PIECES PER REEL, 00-149-21155

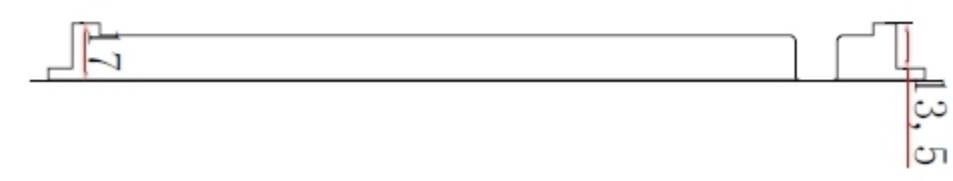
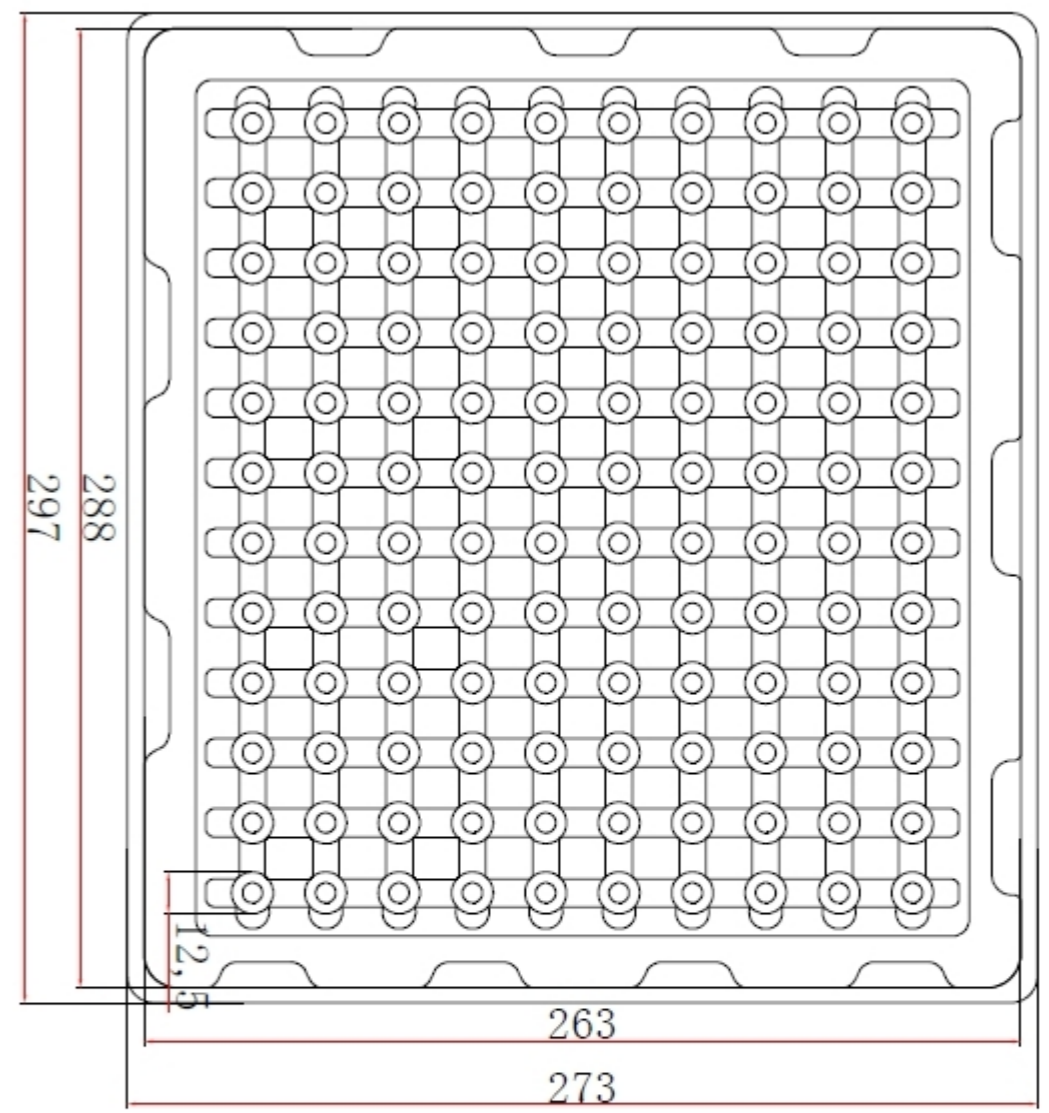
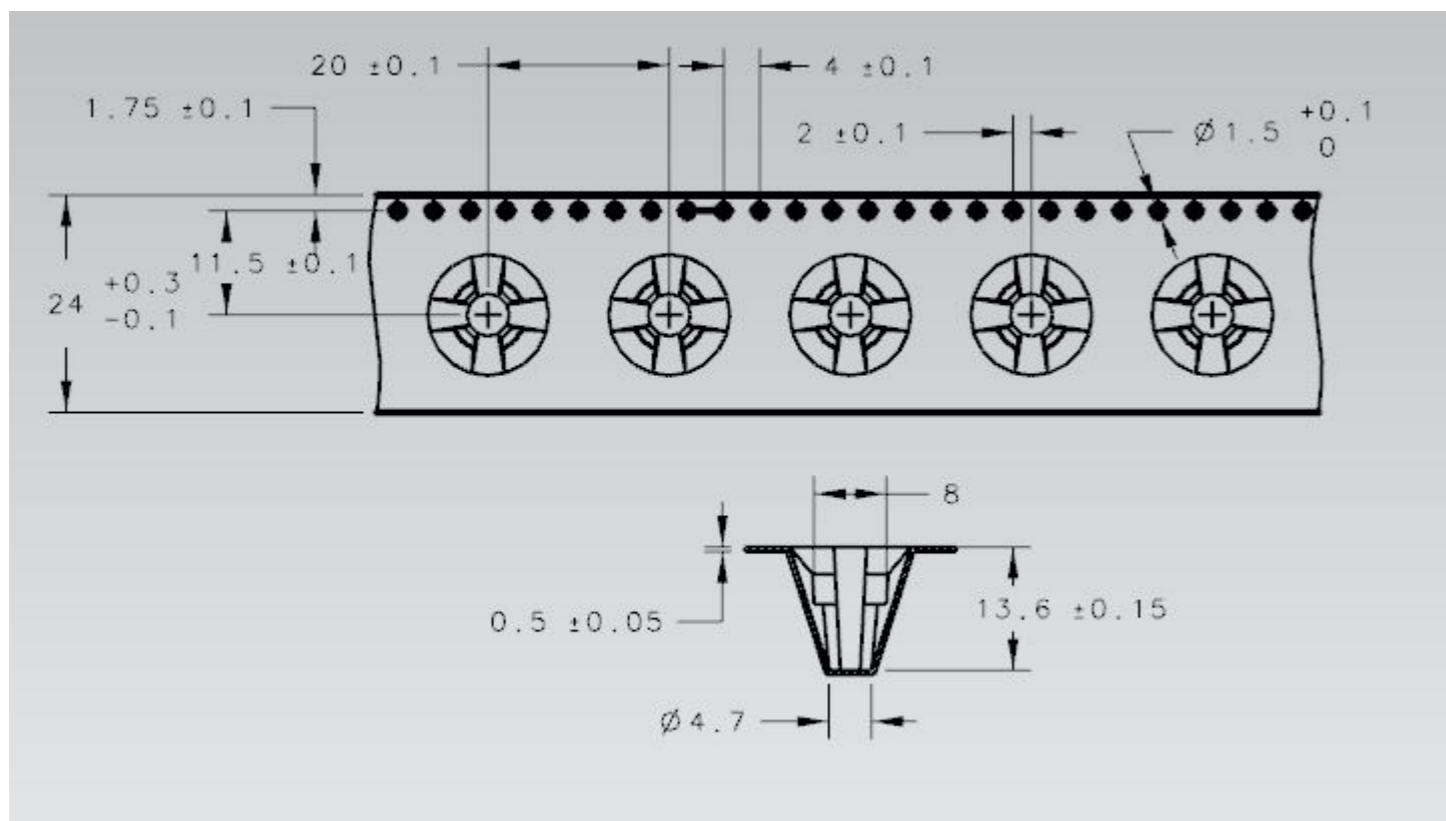

	THIRD ANGLE PROJECTION	 CONNECT • CREATE • INNOVATE	
	MILLIMETERS [IN]		
SURFACE AREA	TOLERANCES UNLESS OTHERWISE NOTED	DESCRIPTION	
VOLUME	UP TO 0.5 ±0.1	No.52 LOW PROFILE CAPTIVE FASTENER	
	OVER 0.5 UP TO 6 ±0.2	SMT STYLE, M3 THREAD, OVERMOLDED	
	OVER 6 UP TO 30 ±0.4	SIZE	SYSTEM
	OVER 30 ±0.6	A3	NX
	ANGLES ±5°	DWG NO.	J-52-SM-A1-M3
PROPRIETARY ITEM	PER ASME Y14.5M-1994	DRAWN BY	DATE
EXCEPT FOR USES EXPRESSLY GRANTED IN WRITING, INFORMATION DISCLOSED HEREON IS CONFIDENTIAL AND ALL RIGHTS, PATENT AND OTHERWISE, ARE RESERVED BY SOUTHCO, INC.		MAL/JQ	28APR2016
		SCALE	SHEET
		NTS	2 OF 2