

REVISION HISTORY			
REV	DATE	BY	DESCRIPTION
B	04APR2024	PBJ/VK	PRN: P2024-0610

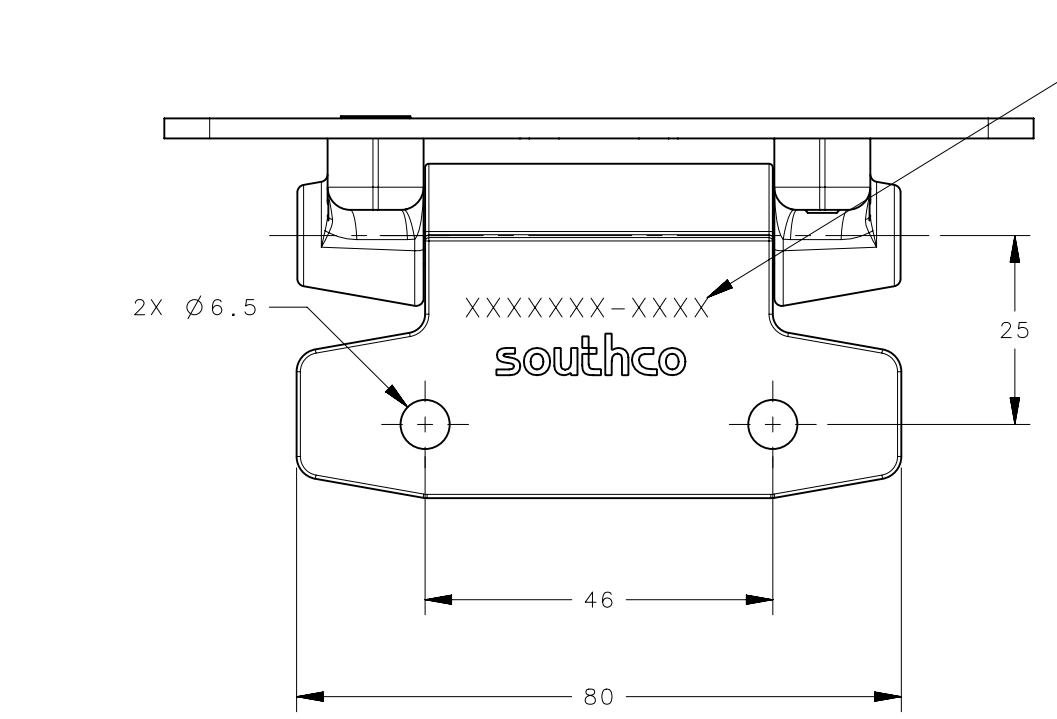

LASER DATE OF MANUFACTURE, PART NUMBER AND BATCH NUMBER THIS SURFACE.

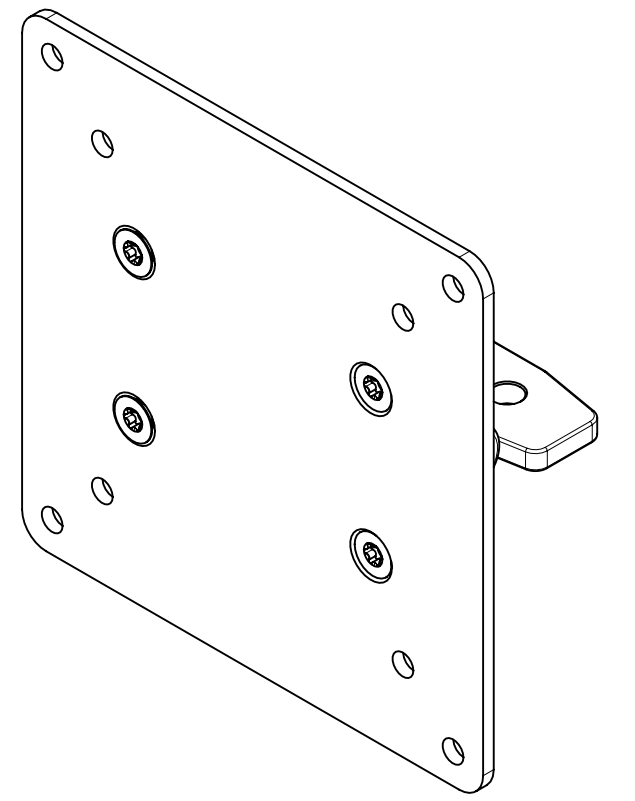
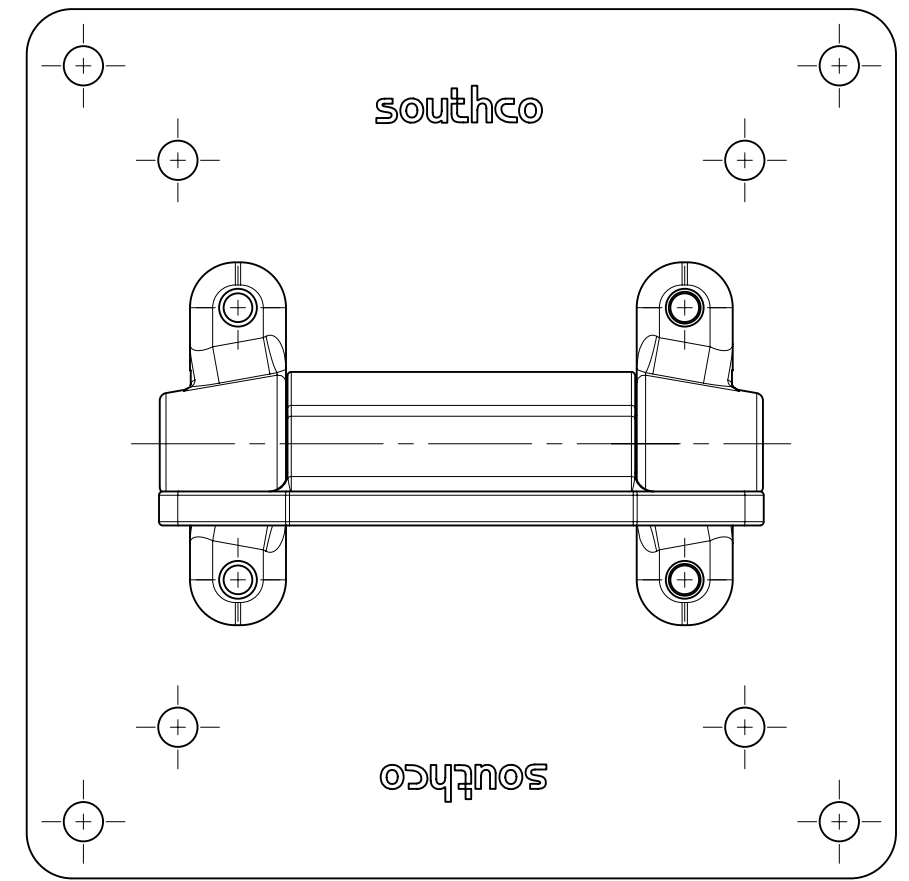
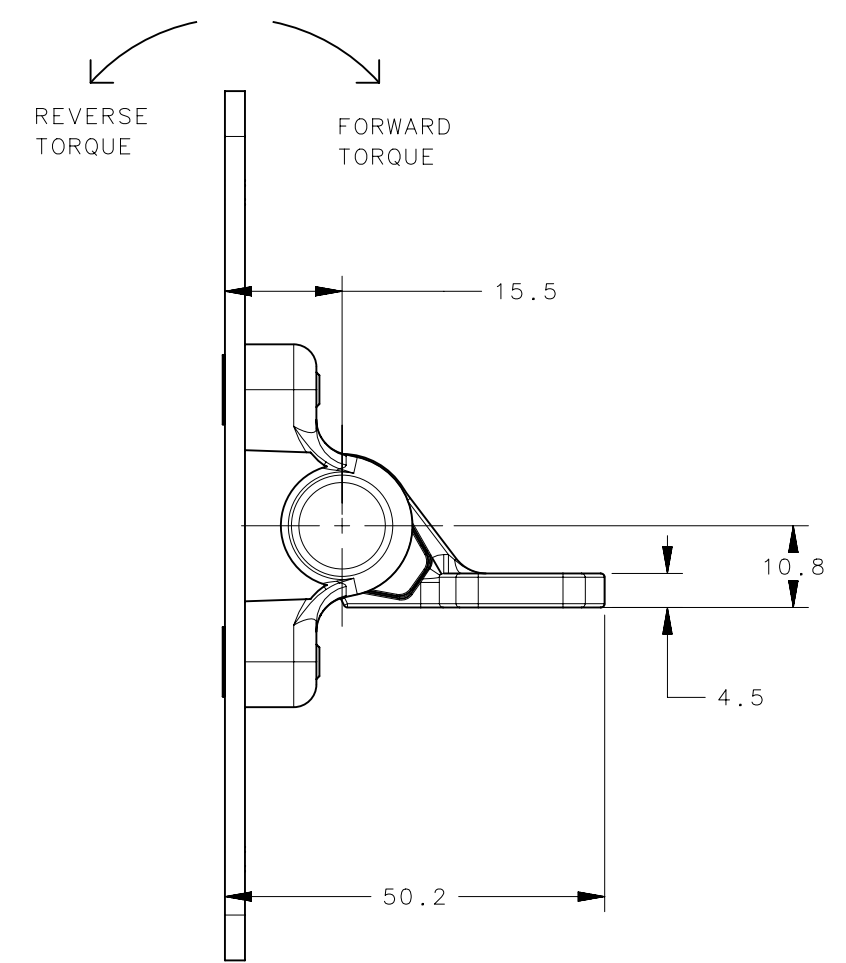
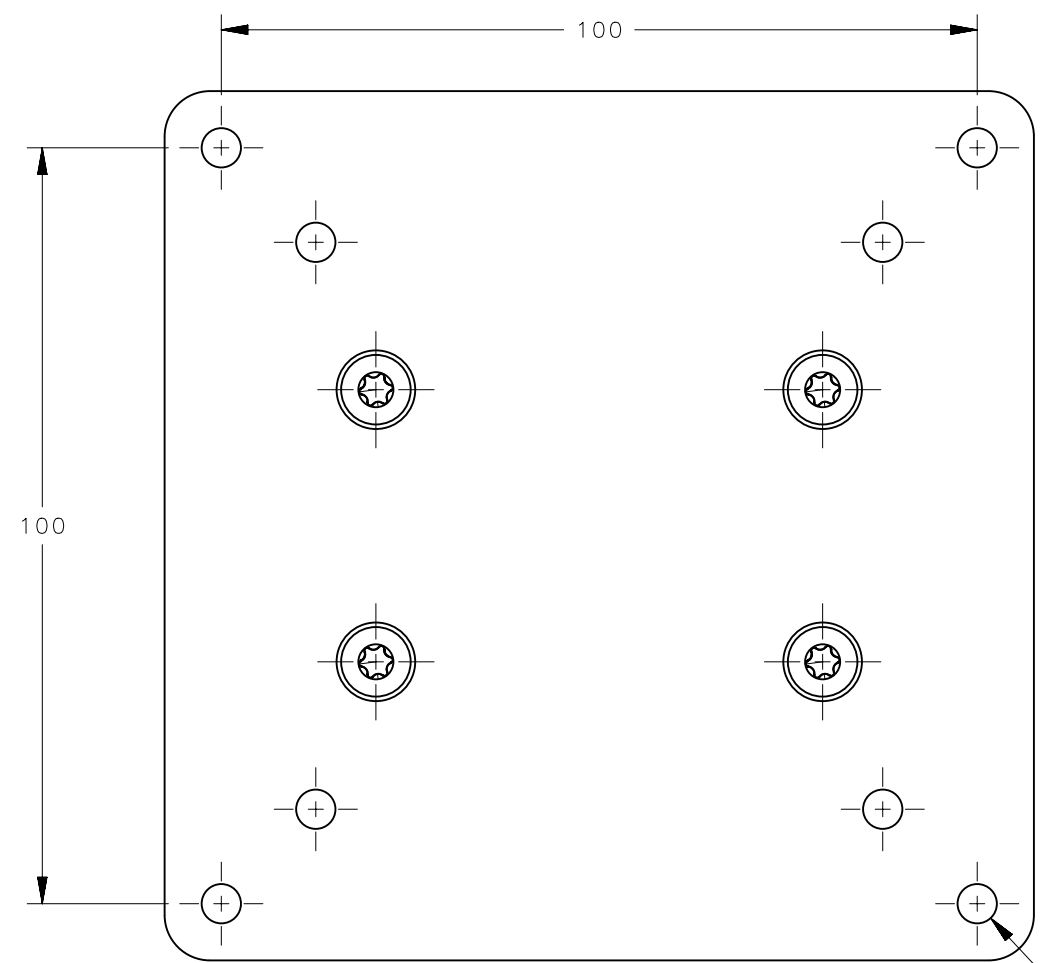
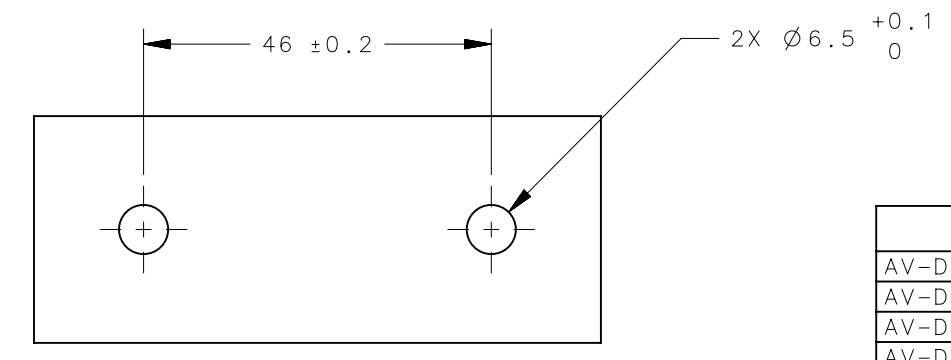

PANEL PREPARATION

PART NUMBER	DESCRIPTION	FINISH
AV-D25-XXXXX-50	ASSEMBLY - COATED	BLACK POWDER
AV-D25-XXXXX-76	ASSEMBLY - COATED	WHITE

PART NUMBER	FORWARD TORQUE	REVERSE TORQUE
AV-D25-2T35F-XX	3.9 N-m (35.0 in-lbs)	3.0 N-m (26.7 in-lbs)
AV-D25-2T50F-XX	5.7 N-m (50.0 in-lbs)	4.0 N-m (35.7 in-lbs)
AV-D25-2T65F-XX	7.3 N-m (65.0 in-lbs)	5.4 N-m (47.5 in-lbs)
AV-D25-2T80F-XX	9.0 N-m (80.0 in-lbs)	6.7 N-m (59.4 in-lbs)
AV-D25-2T95F-XX	10.7 N-m (95.0 in-lbs)	7.8 N-m (68.9 in-lbs)
AV-D25-2T110F-XX	12.4 N-m (110.0 in-lbf)	9.0 N-m (79.8 in-lbf)
AV-D25-2T35R-XX	3.0 N-m (26.7 in-lbs)	3.9 N-m (35.0 in-lbs)
AV-D25-2T50R-XX	4.0 N-m (35.7 in-lbs)	5.7 N-m (50.0 in-lbs)
AV-D25-2T65R-XX	5.4 N-m (47.5 in-lbs)	7.3 N-m (65.0 in-lbs)
AV-D25-2T80R-XX	6.7 N-m (59.4 in-lbs)	9.0 N-m (80.0 in-lbs)
AV-D25-2T95R-XX	7.8 N-m (68.9 in-lbs)	10.7 N-m (95.0 in-lbs)
AV-D25-2T110R-XX	9.0 N-m (79.8 in-lbf)	12.4 N-m (110.0 in-lbf)

- NOTES:
- PERFORMANCE TORQUE TOLERANCE ±20%
 - DESIGNED TO ACCEPT M6 SCREW OR EQUIVALENT
 - MATERIAL AND FINISH:
HINGE LEAVES AND HOUSING: DIE CAST ALUMINUM, SEE TABLE FOR FINISH
SHAFT & PIN: STEEL
O-RINGS: BUNA-N RUBBER
BEARINGS: BRASS

THIRD ANGLE PROJECTION		southco CONNECT • CREATE • INNOVATE
MILLIMETERS [IN]		
SURFACE AREA XXXXXmm ²	TOLERANCES UNLESS OTHERWISE NOTED	DESCRIPTION Hinge & Controlled Motion Device ARM ASSEMBLY
VOLUME XXXXXmm ³	ALL DIMENSIONS WITHOUT TOLERANCES ARE FOR REFERENCE ONLY.	
PROPRIETARY ITEM EXCEPT FOR USES EXPRESSLY GRANTED IN WRITING, INFORMATION DISCLOSED HEREON IS CONFIDENTIAL AND ALL RIGHTS, PATENT AND OTHERWISE, ARE RESERVED BY SOUTHCO, INC.	PER ASME Y14.5M-2009	SIZE SYSTEM C NX DWG NO. J-AV-D25-2T
		DRAWN BY JJT DATE 12MAR2012 SCALE 1:1 SHEET 1 OF 3

REVISION HISTORY			
REV	DATE	BY	DESCRIPTION
B	04APR2024	PBJ/VK	PRN: P2024-0610

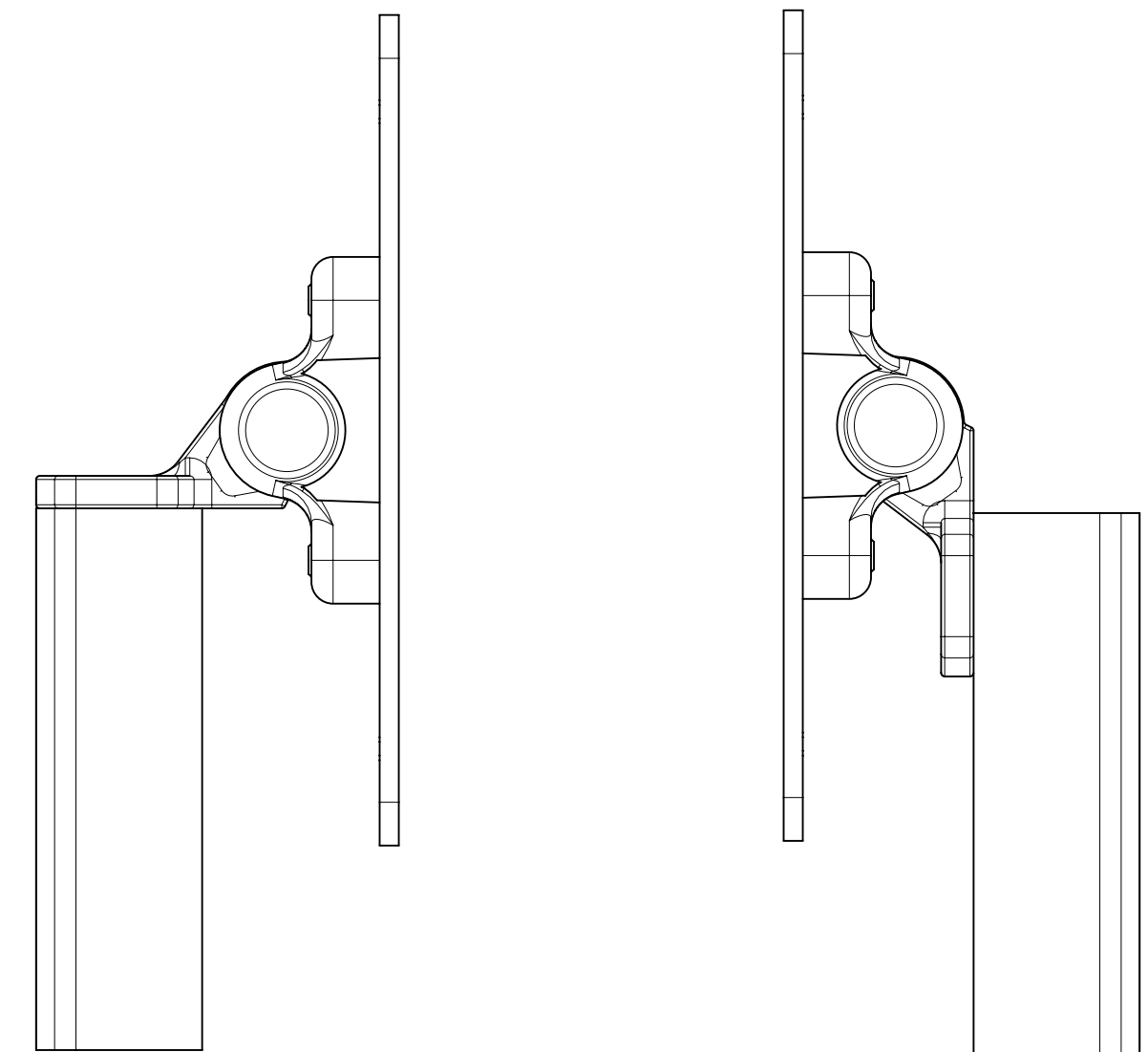
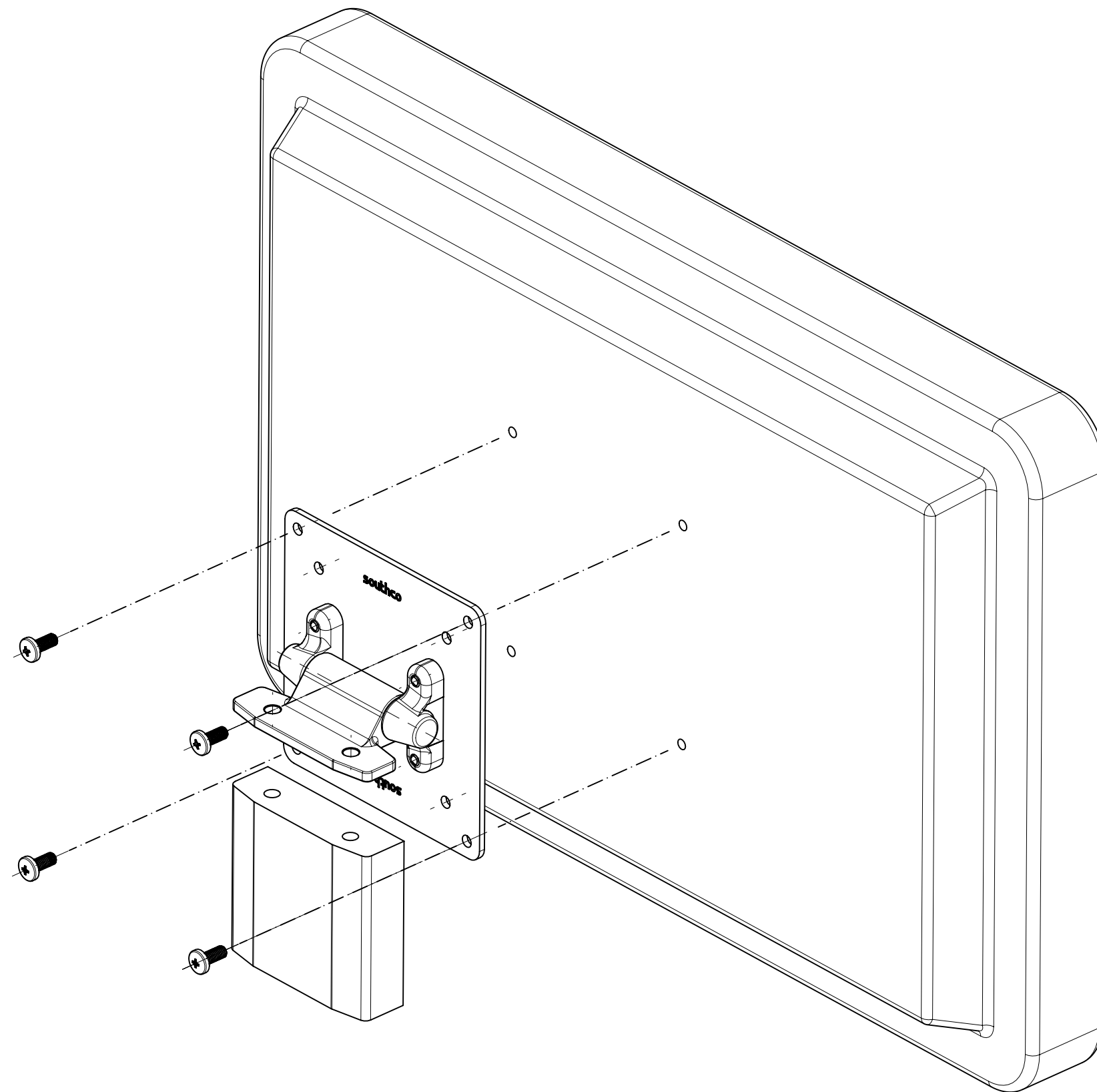

MOUNT OPTION 1

MOUNT OPTION 2

PANEL PREPARATION

1. SLIDE ON WALL MOUNTING HARDWARE COVERS AND ATTACHED MONITOR TO MOUNTING PLATE USING 4 EACH DISPLAY MANUFACTURERS RECOMMENDED HARDWARE (NOT PROVIDED), AS SHOWN.

THIRD ANGLE PROJECTION		southco CONNECT • CREATE • INNOVATE	
MILLIMETERS [IN]			
SURFACE AREA XXXXXmm ²		DESCRIPTION Hinge & Controlled Motion Device ARM ASSEMBLY	
VOLUME XXXXXmm ³		SIZE C SYSTEM NX DWG NO. J-AV-D25-2T	
PROPRIETARY ITEM <small>EXCEPT FOR USES EXPRESSLY GRANTED IN WRITING, INFORMATION DISCLOSED HEREON IS CONFIDENTIAL AND ALL RIGHTS, PATENT AND OTHERWISE, ARE RESERVED BY SOUTHCO, INC.</small>		DRAWN BY JJT DATE 12MAR2012 SCALE 1:1 SHEET 2 OF 3	
TOLERANCES UNLESS OTHERWISE NOTED ALL DIMENSIONS WITHOUT TOLERANCES ARE FOR REFERENCE ONLY. PER ASME Y14.5M-2009			

REVISION HISTORY			
REV	DATE	BY	DESCRIPTION
B	04APR2024	PBJ/VK	PRN: P2024-0610

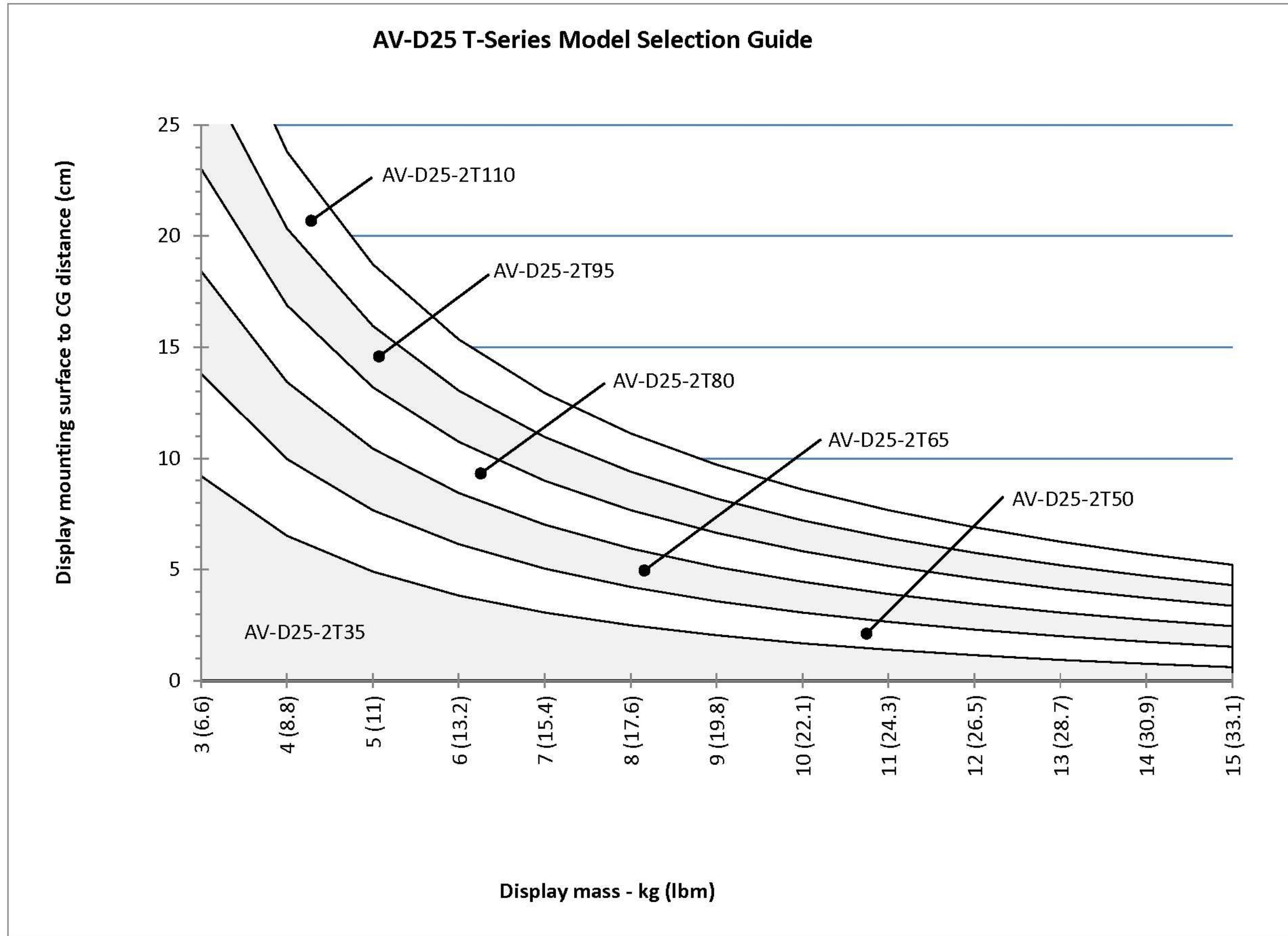

THIRD ANGLE PROJECTION		southco CONNECT • CREATE • INNOVATE	
MILLIMETERS [IN]		DESCRIPTION Hinge & Controlled Motion Device ARM ASSEMBLY	
SURFACE AREA XXXXXmm ²		SIZE SYSTEM C NX	
VOLUME XXXXXmm ³		DWG. NO. J-AV-D25-2T	
PROPRIETARY ITEM <small>EXCEPT FOR USES EXPRESSLY GRANTED IN WRITING, INFORMATION DISCLOSED HEREON IS CONFIDENTIAL AND ALL RIGHTS, PATENT AND OTHERWISE, ARE RESERVED BY SOUTHCO, INC.</small>		SCALE 1:1	
PER ASME Y14.5M-2009		SHEET 3 OF 3	