

REVISION HISTORY			
REV	DATE	BY	DESCRIPTION
A	02FEB2010	GEA	PRN: INITIAL RELEASE

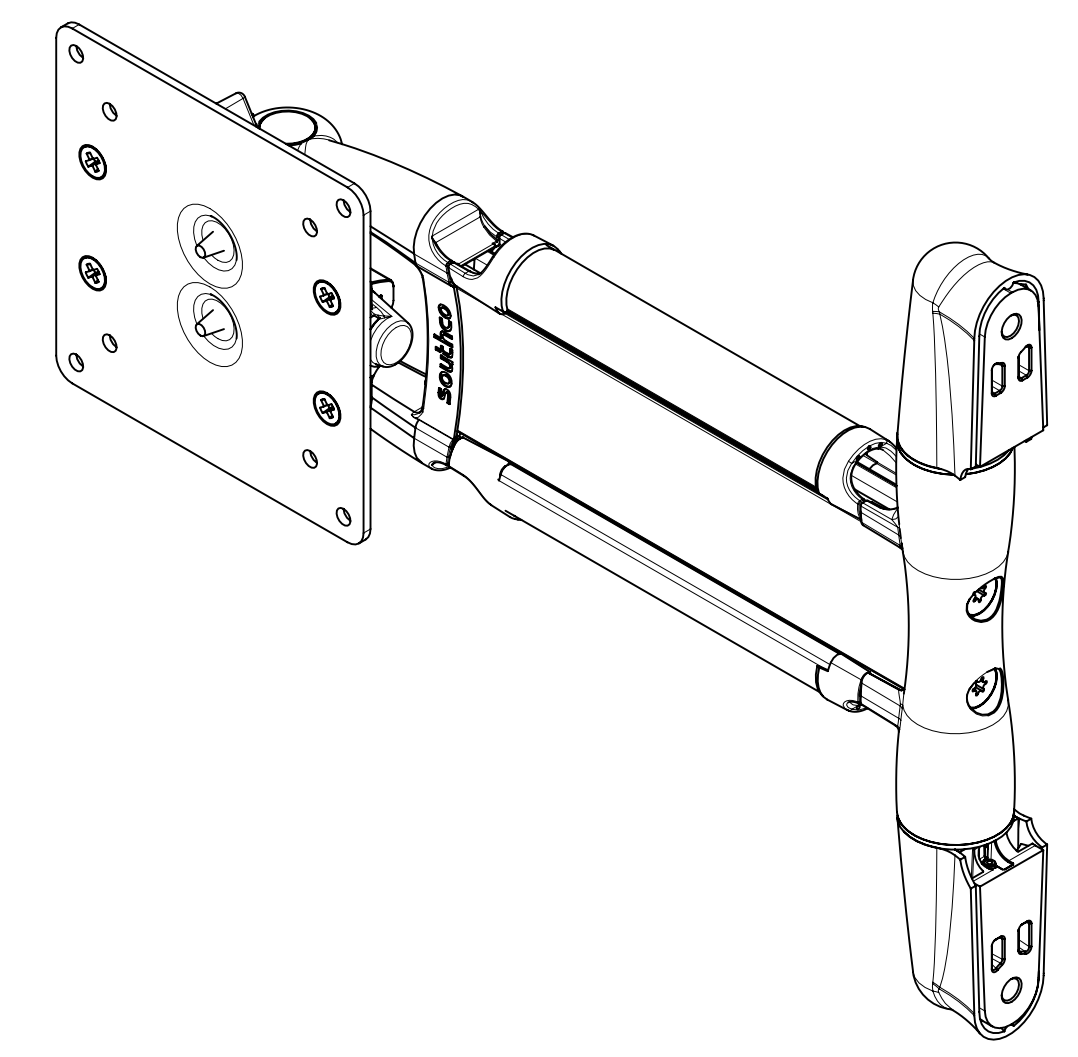

ISOMETRIC VIEW  
(SHOWN ASSEMBLED)

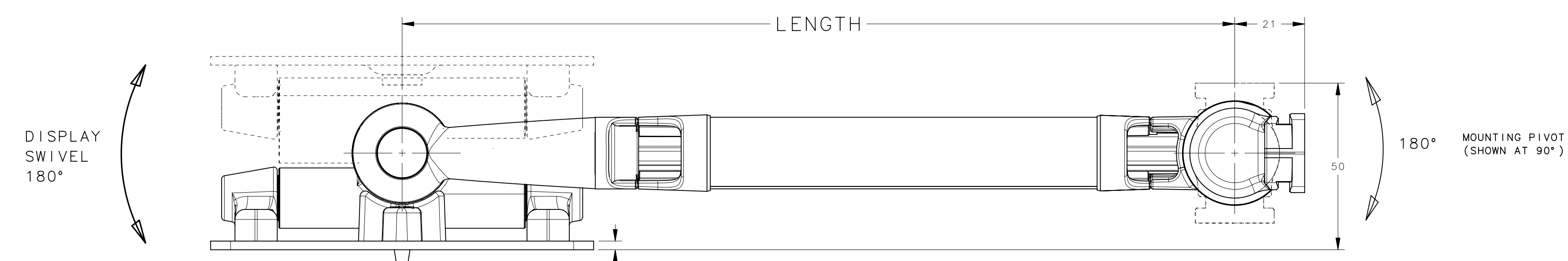
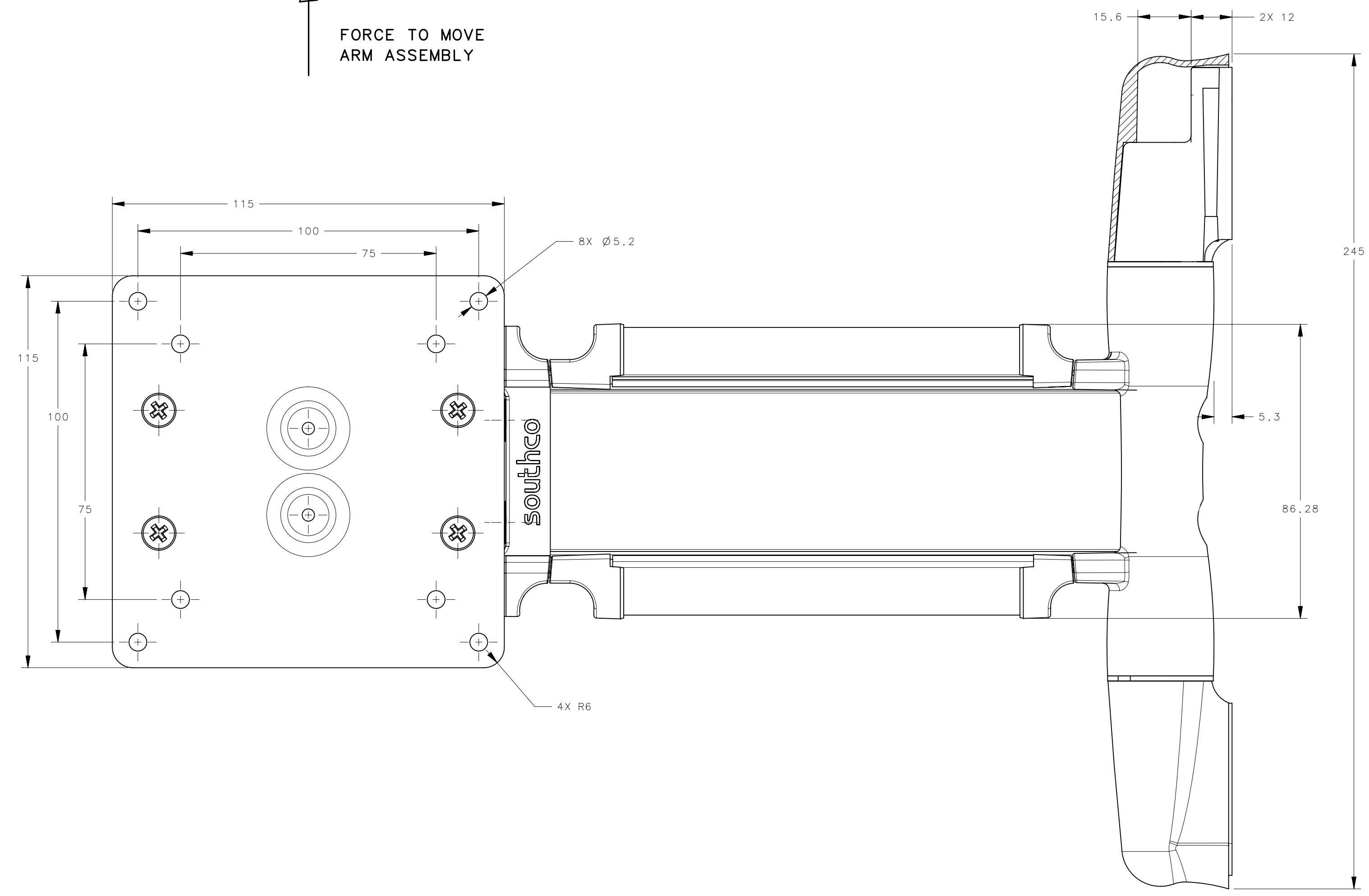
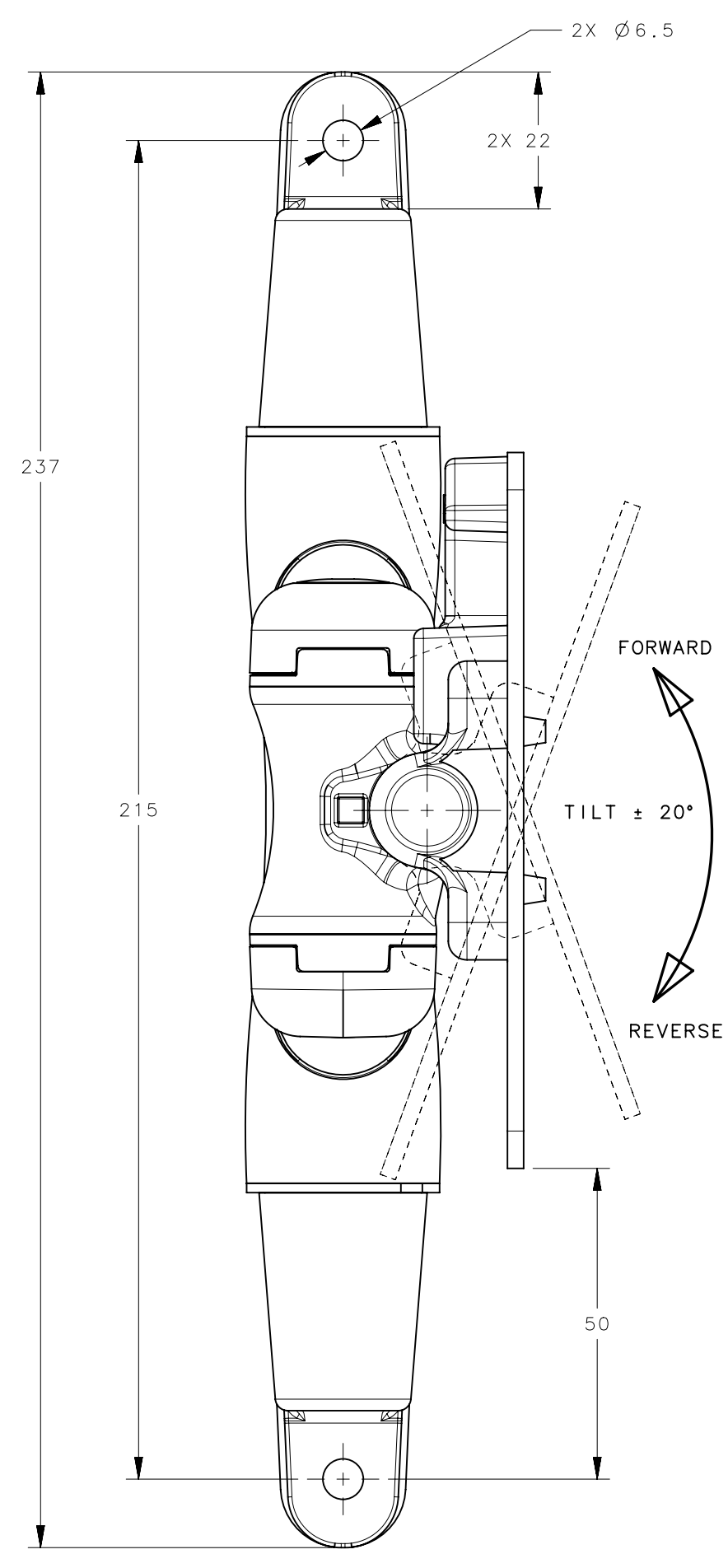

NOTES:

- FINISH: POWDERCOAT COLOR EXTERIOR SURFACES: CLASS "C" PER SOUTHCO SPECIFICATION S-121-03.
- PART SHOWN IN ASSEMBLED POSITION. COVERS SHIPPED IN SEPARATE POLY BAG WITH INSTALLATION INSTRUCTIONS, ASSEMBLY PACKAGED 1 PER CONTAINER.
- MOUNTING ARM SYSTEM AXIS MOTION AS INDICATED:  
FORWARD 20° AND 20° REARWARD DISPLAY TILT  
180° DISPLAY HORIZONTAL SWIVEL  
180° ARM HORIZONTAL ARM PIVOT
- TORQUE SPECIFICATIONS AT A CYCLE LIFE OF 20,000 AT 25% DUTY CYCLE AT SPEEDS LESS THAN 15 RPM:

SWIVEL TORQUE TOLERANCE: +35%/-20%  
TILT TORQUE TOLERANCE: ±20%  
WALL PIVOT FORCE TOLERANCE: ±20%

SEE TABLE FOR DETAIL OF ACTUAL TORQUE AND FORCE SPECIFICATIONS

THE BRACKET SYSTEM SHALL WITHSTAND 20,000 CYCLES FOR THE TILT AND SWIVEL FUNCTION AND 20,000 CYCLES IN THE PIVOT FUNCTION WHILE MAINTAINING TORQUES SPECIFIED ABOVE.

- FOR DETAILED INSTALLATION INSTRUCTIONS, CONSULT THE SOUTHCO DYNAMIC MONITOR ARM INSTALLATION GUIDE (SOUTHCO DRAWING J-AV-D30-25A101-M).

PART NUMBER	LENGTH mm (inch)	MAXIMUM DISPLAY WEIGHT kg (lbf)	REARWARD TILT TORQUE N*m (lbf*in)	FORWARD TILT TORQUE N*m (lbf*in)	SWIVEL SYMMETRIC TORQUE N*m (lbf*in)	FORCE TO MOVE ARM ASSEMBLY N (lbf)	COLOR
AV-D30-15A103-50	150 (5.91)	14.9 (33)	8.58 (76)	6.01 (53.2)	3.39 (30)	33.8 (7.6)	BLACK
AV-D30-15A103-76	150 (5.91)	14.9 (33)	8.58 (76)	6.01 (53.2)	3.39 (30)	33.8 (7.6)	OFFICE WHITE
AV-D30-25A103-50	250 (9.84)	14.9 (33)	8.58 (76)	6.01 (53.2)	3.39 (30)	33.8 (7.6)	BLACK
AV-D30-25A103-76	250 (9.84)	14.9 (33)	8.58 (76)	6.01 (53.2)	3.39 (30)	33.8 (7.6)	OFFICE WHITE
AV-D30-35A103-50	350 (13.78)	14.9 (33)	8.58 (76)	6.01 (53.2)	3.39 (30)	33.8 (7.6)	BLACK
AV-D30-35A103-76	350 (13.78)	14.9 (33)	8.58 (76)	6.01 (53.2)	3.39 (30)	33.8 (7.6)	OFFICE WHITE
AV-D30-45A103-50	450 (17.72)	14.9 (33)	8.58 (76)	6.01 (53.2)	3.39 (30)	33.8 (7.6)	BLACK
AV-D30-45A103-76	450 (17.72)	14.9 (33)	8.58 (76)	6.01 (53.2)	3.39 (30)	33.8 (7.6)	OFFICE WHITE

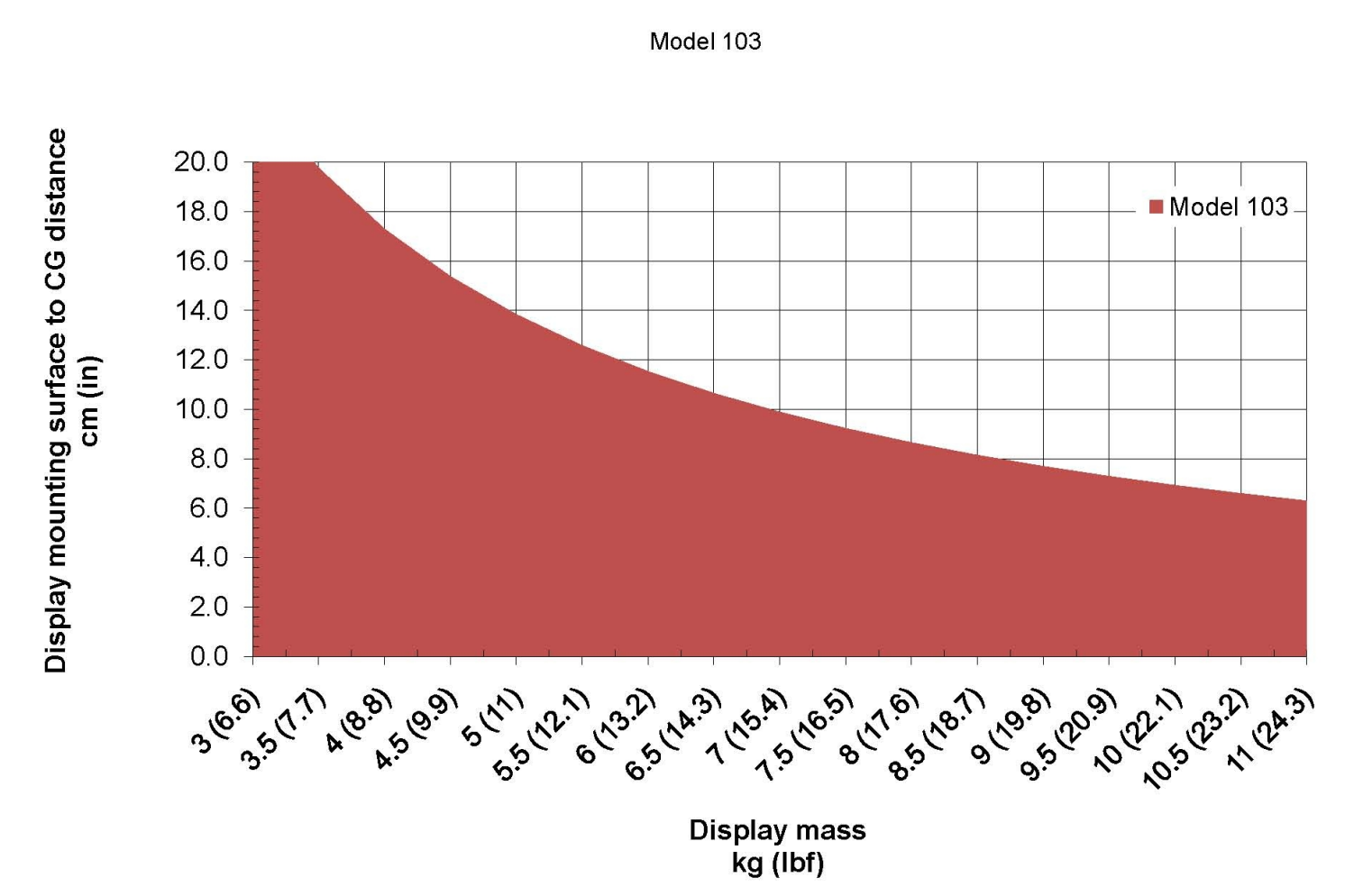

THIRD ANGLE PROJECTION		 CONNECT · CREATE · INNOVATE	
MILLIMETERS [IN]			
SURFACE AREA		TOLERANCES UNLESS OTHERWISE NOTED	
VOLUME		ALL DIMENSIONS WITHOUT TOLERANCES ARE FOR REFERENCE ONLY.	
PROPRIETARY ITEM		DESCRIPTION	
EXCEPT FOR USES EXPRESSLY GRANTED IN WRITING, INFORMATION DISCLOSED HEREON IS CONFIDENTIAL AND ALL RIGHTS, TITLE AND INTEREST ARE RESERVED BY SOUTHCO, INC.		Hinge & Controlled Motion Device ARM ASSEMBLY	
PER ASME Y14.5M-1994		SIZE D	SYSTEM NX
DRAWN BY GEA		DATE 02FEB2010	SCALE 1:1
SHEET 1 OF 5		DWG NO. J-AV-D30-25A103	

REVISION HISTORY			
REV	DATE	BY	DESCRIPTION
A	02FEB2010	GEA	PRN: INITIAL RELEASE

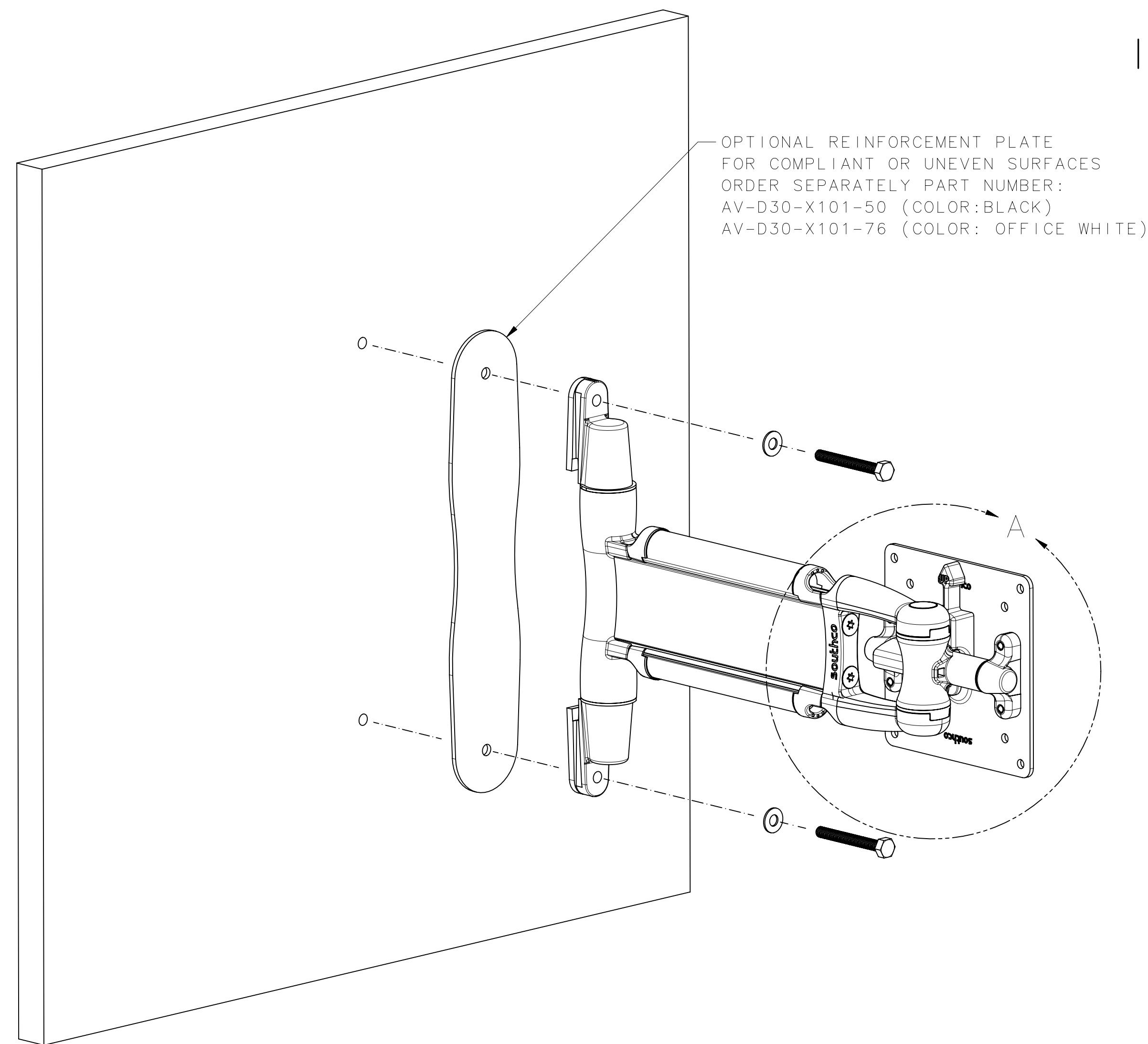
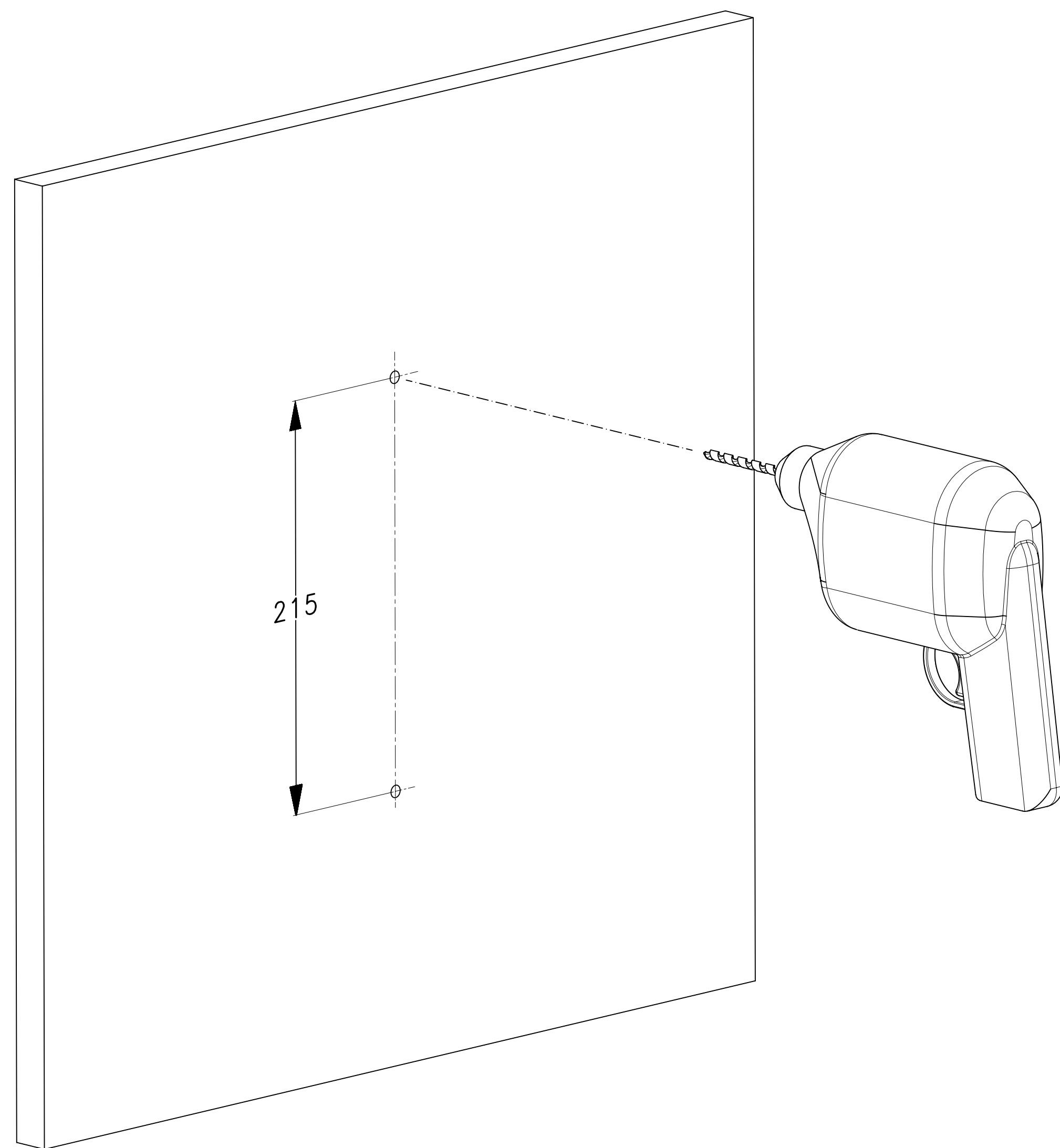

### INCORRECT MOUNTING

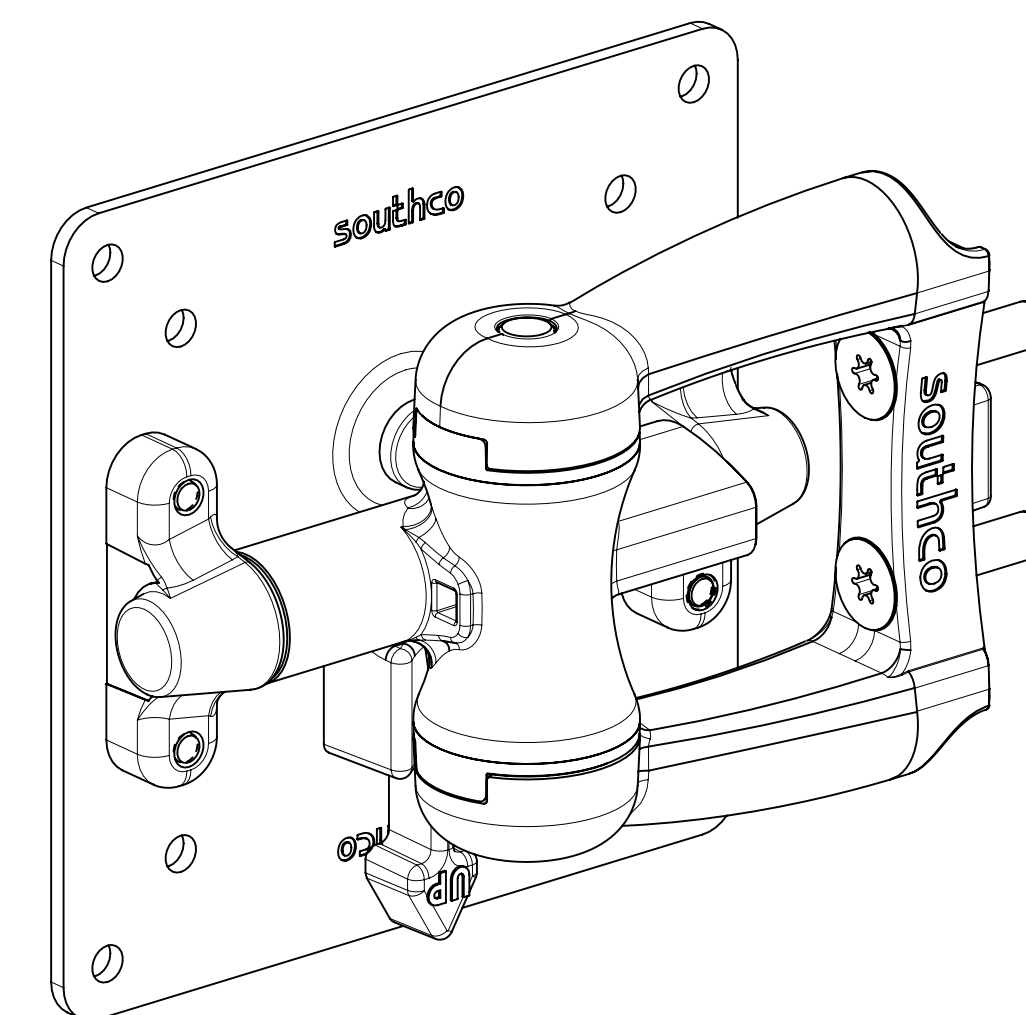

### CORRECT MOUNTING

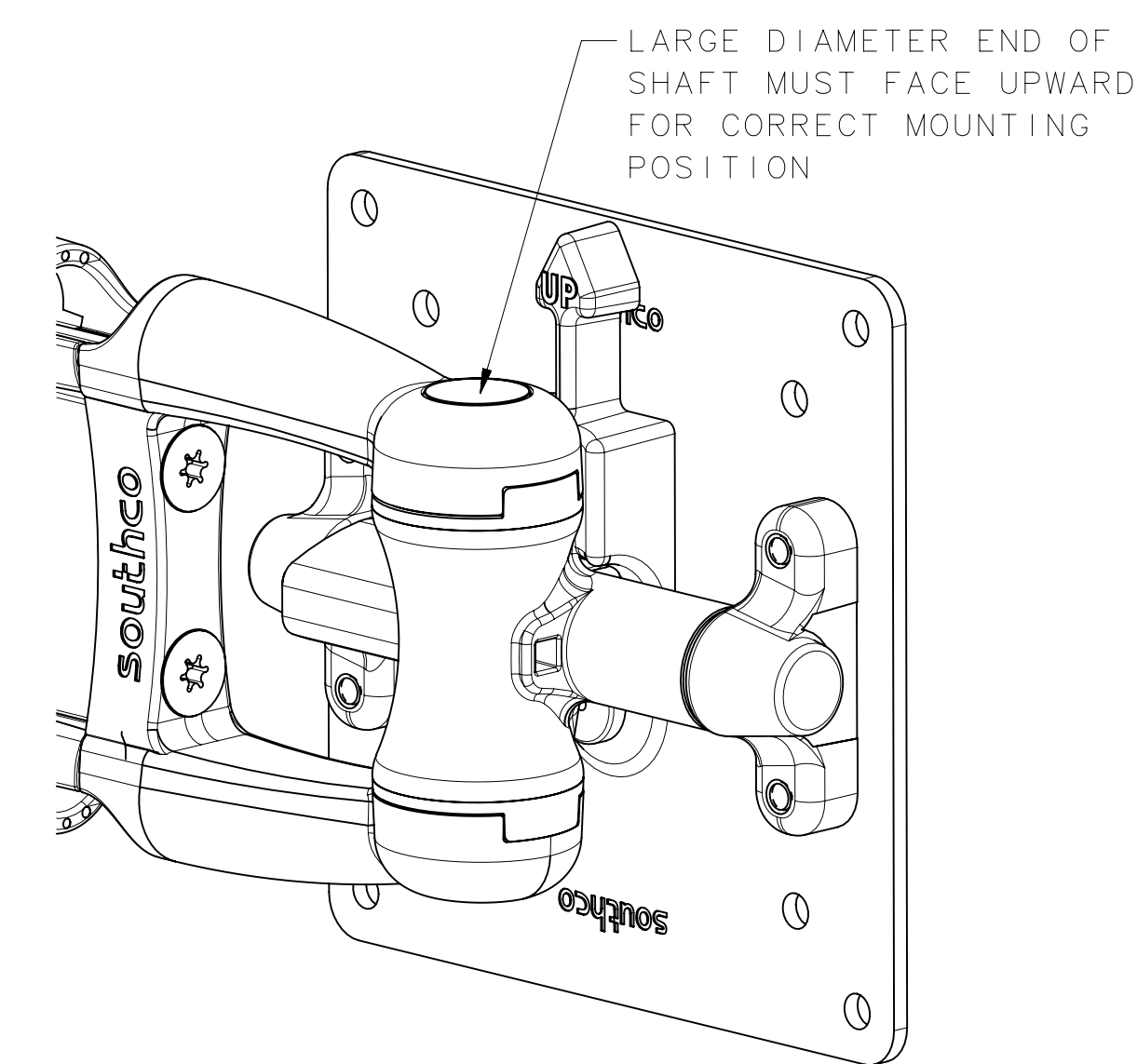

DETAIL A  
SCALE 1:1

#### STEP 1

1. DETERMINE DESIRED MOUNTING LOCATION. PLEASE CONSIDER ALL OBSTACLES THROUGHOUT THE ARMS RANGE OF MOTION WHEN SELECTING THE MOUNTING LOCATION.
2. MARK UPPER AND LOWER MOUNTING HOLES. FOR IDEAL HOLE LOCATION, MARK UPPER HOLE FIRST THEN USE A PLUMB LINE OR LINE LEVEL TO ENSURE VERTICAL ORIENTATION BETWEEN THE UPPER AND LOWER HOLES.

#### STEP 2

3. INTALL ARM ONT THE WALL OR PANEL.
  - A. FOR THRU-BOLT INSTALLATION, DRILL OR PUNCH HOLES AND INSTALL USING 1/4-20 OR M6 MOUNTING HARDWARE (NOT PROVIDED)AND FLAT WASHERS (NOT PROVIDED).
  - B. FOR 1/4 INCH LAG SCREW INSTALLATION IN WOOD STUDS, DRILL A 3/16 INCH PILOT HOLE, THEN INSTALL USING A 1/4 INCH LAG SCREW AND FLAT WASHER. DO NOT OVER TIGHTEN. USE THE OPTIONAL WALL REINFORCEMENT PLATE (SOLD SEPARATELY) WHEN INSTALLING ARM ASSEMBLY ONTO COMPLIANT SURFACES.

NOTE: BECAUSE OF THE WIDE VARIETY OF AVAILABLE WALL MATERIALS, IT IS THE INSTALLER'S RESPONSIBILITY TO ENSURE THAT THE MATERIALS AND STRUCTURE TO WHICH THE ARM IS MOUNTED, AND THE HARDWARE SELECTED, WILL PROVIDE ADEQUATE SUPPPORT.

C. NOTE: FOR PROPER FUNCTION, THE ARM MUST BE INSTALLED WITH THE LARGE DIAMETER SIDE OF THE MONITOR PIVOT PIN FACING UP.

THIRD ANGLE PROJECTION				<b>southco</b> CONNECT · CREATE · INNOVATE	
MILLIMETERS [IN]					
SURFACE AREA mm <sup>2</sup>		TOLERANCES UNLESS OTHERWISE NOTED		DESCRIPTION	
VOLUME mm <sup>3</sup>		ALL DIMENSIONS WITHOUT TOLERANCES ARE FOR REFERENCE ONLY.		Hinge & Controlled Motion Device ARM ASSEMBLY	
PROPRIETARY ITEM		PER ASME Y14.5M-1994		SIZE D	SYSTEM NX
EXCEPT FOR USES EXPRESSLY GRANTED IN WRITING, INFORMATION DISCLOSED HEREON IS CONFIDENTIAL AND ALL RIGHTS, PATENT AND OTHERWISE, ARE RESERVED BY SOUTHCO, INC.		DRAWN BY GEA		DATE 02FEB2010	SCALE 1:1
				SHEET 3 OF 5	

REVISION HISTORY			
REV	DATE	BY	DESCRIPTION
A	02FEB2010	GEA	PRN: INITIAL RELEASE

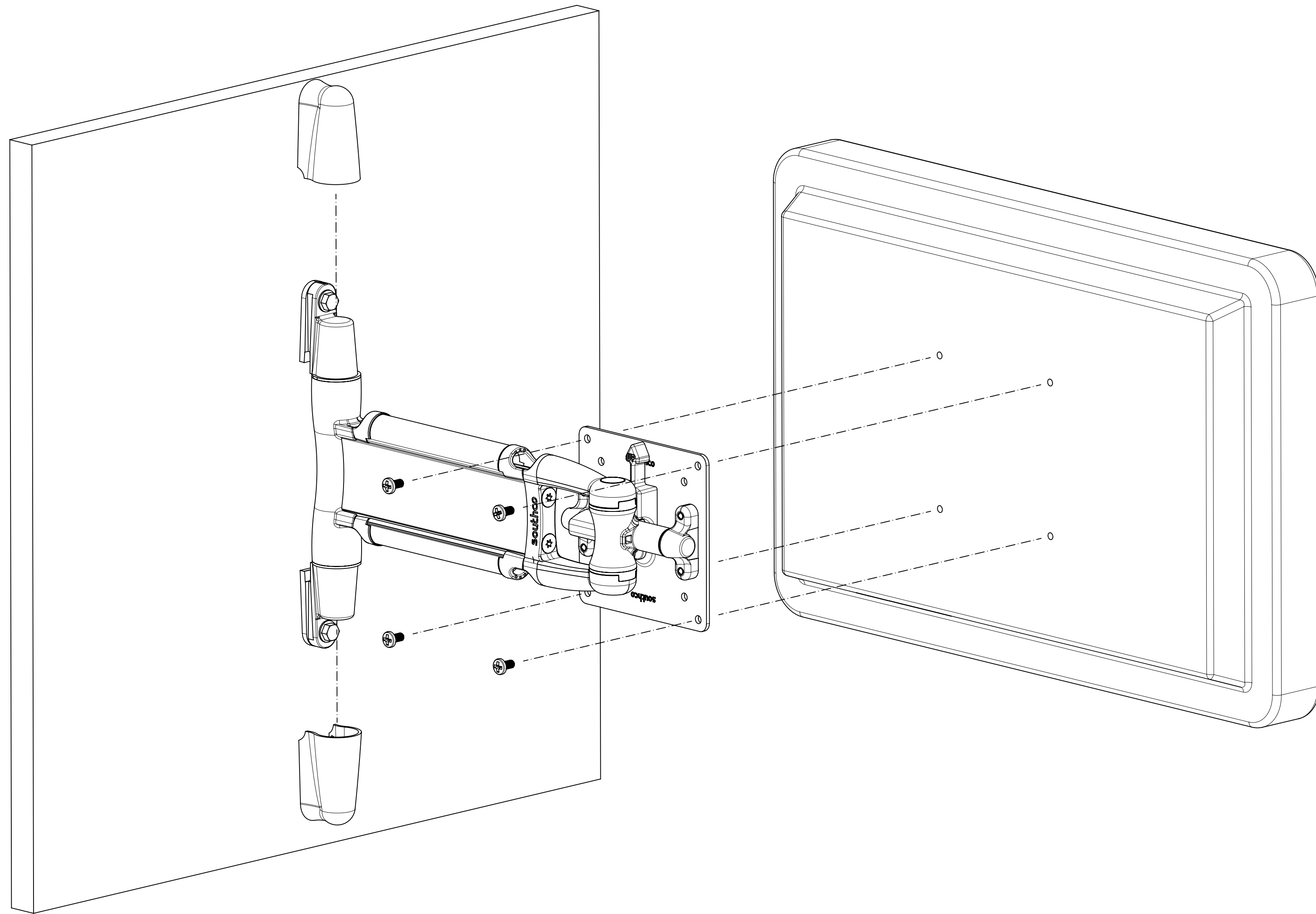

STEP 3

1. SLIDE ON WALL MOUNTING HARDWARE COVERS AND ATTACHED MONITOR TO MOUNTING PLATE USING 4 EACH DISPLAY MANUFACTURERS RECOMMENDED HARDWARE (NOT PROVIDED), AS SHOWN.

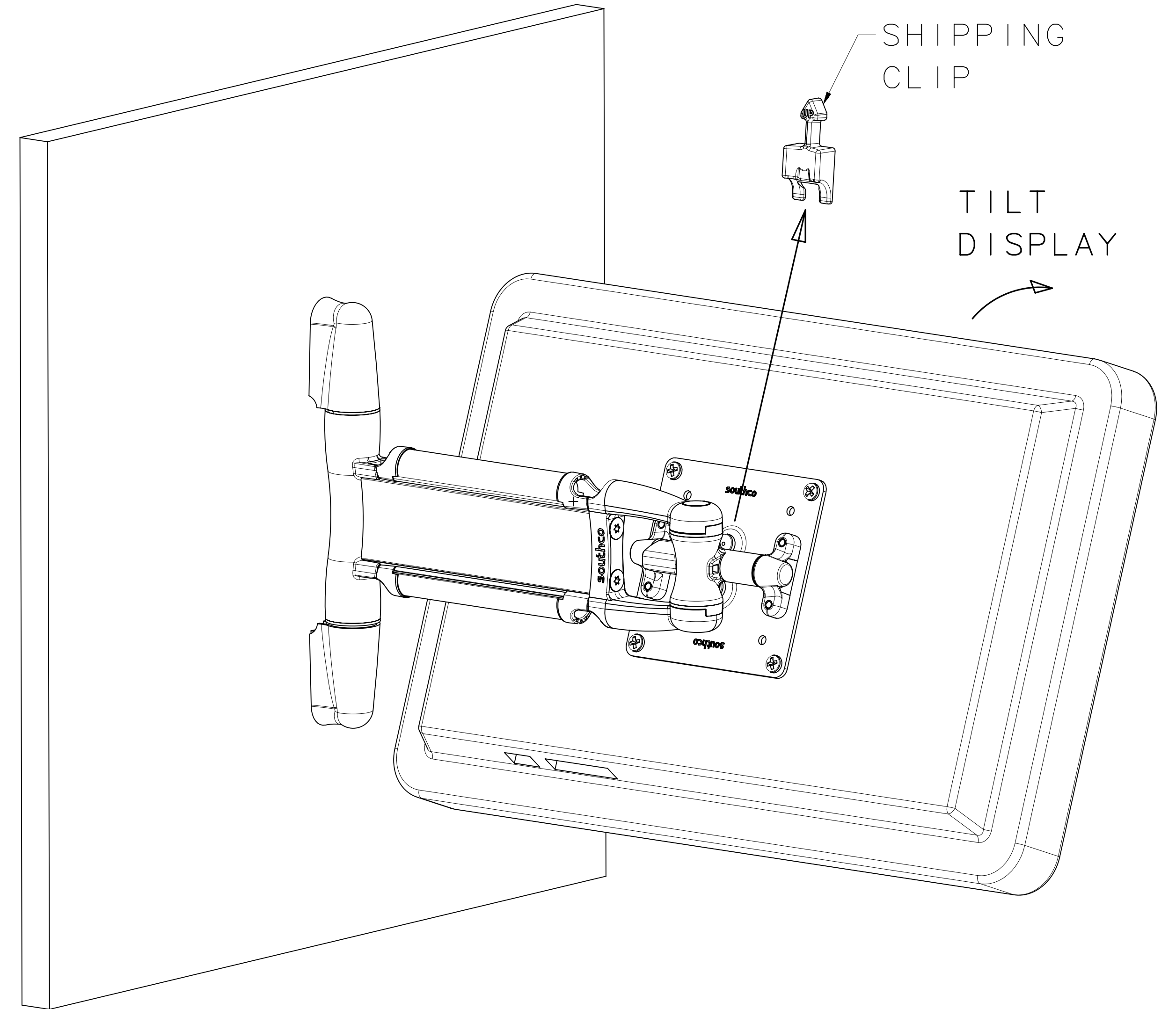

STEP 4

1. TILT DISPLAY FORWARD. REMOVE AND DISCARD SHIPPING CLIP.

THIRD ANGLE PROJECTION				<b>southco</b> <sup>®</sup> CONNECT · CREATE · INNOVATE	
MILLIMETERS [IN]					
SURFACE AREA mm <sup>2</sup>		TOLERANCES UNLESS OTHERWISE NOTED		DESCRIPTION	
VOLUME mm <sup>3</sup>		ALL DIMENSIONS WITHOUT TOLERANCES ARE FOR REFERENCE ONLY.		Hinge & Controlled Motion Device ARM ASSEMBLY	
PROPRIETARY ITEM		SIZE D	SYSTEM NX	DWG NO. J-AV-D30-25A103	
EXCEPT FOR USES EXPRESSLY GRANTED IN WRITING, INFORMATION DISCLOSED HEREON IS CONFIDENTIAL AND ALL RIGHTS, PATENTS AND OTHERS ARE RESERVED BY SOUTHCO, INC.		PER ASME Y14.5M-1994	DRAWN BY GEA	DATE 02FEB2010	SCALE 1:1 SHEET 2 OF 5

REVISION HISTORY			
REV	DATE	BY	DESCRIPTION
A	02FEB2010	GEA	PRN: INITIAL RELEASE

OPEN COVER IN  
DIRECTION OF ARROW

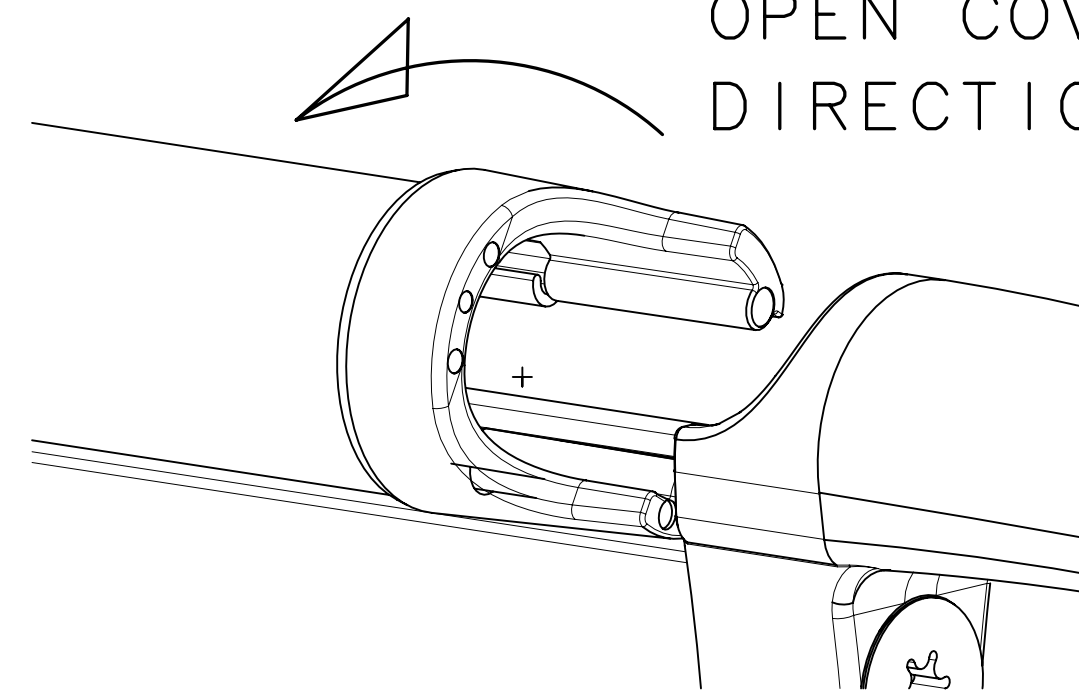

DETAIL C  
SCALE 2:1

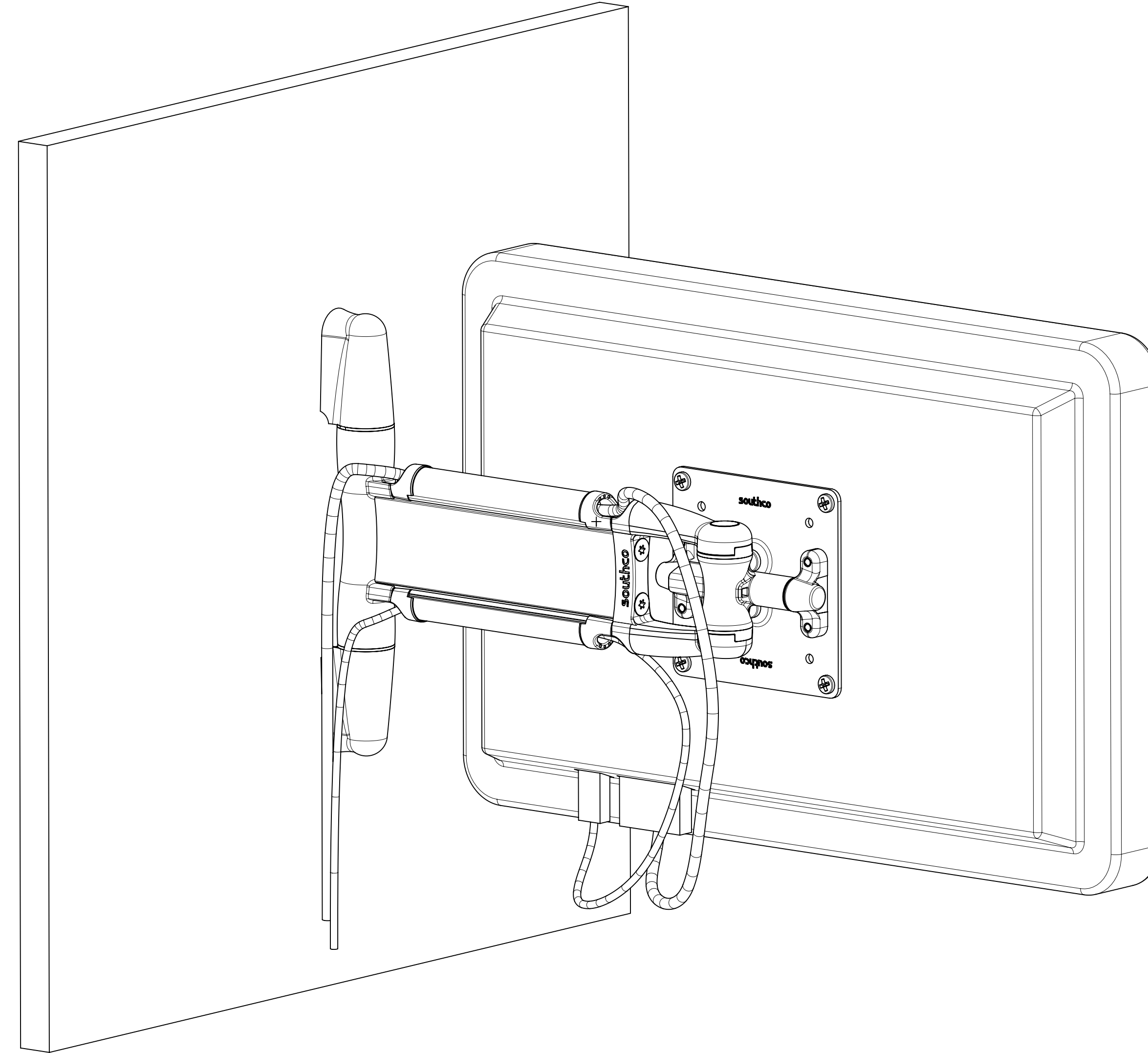
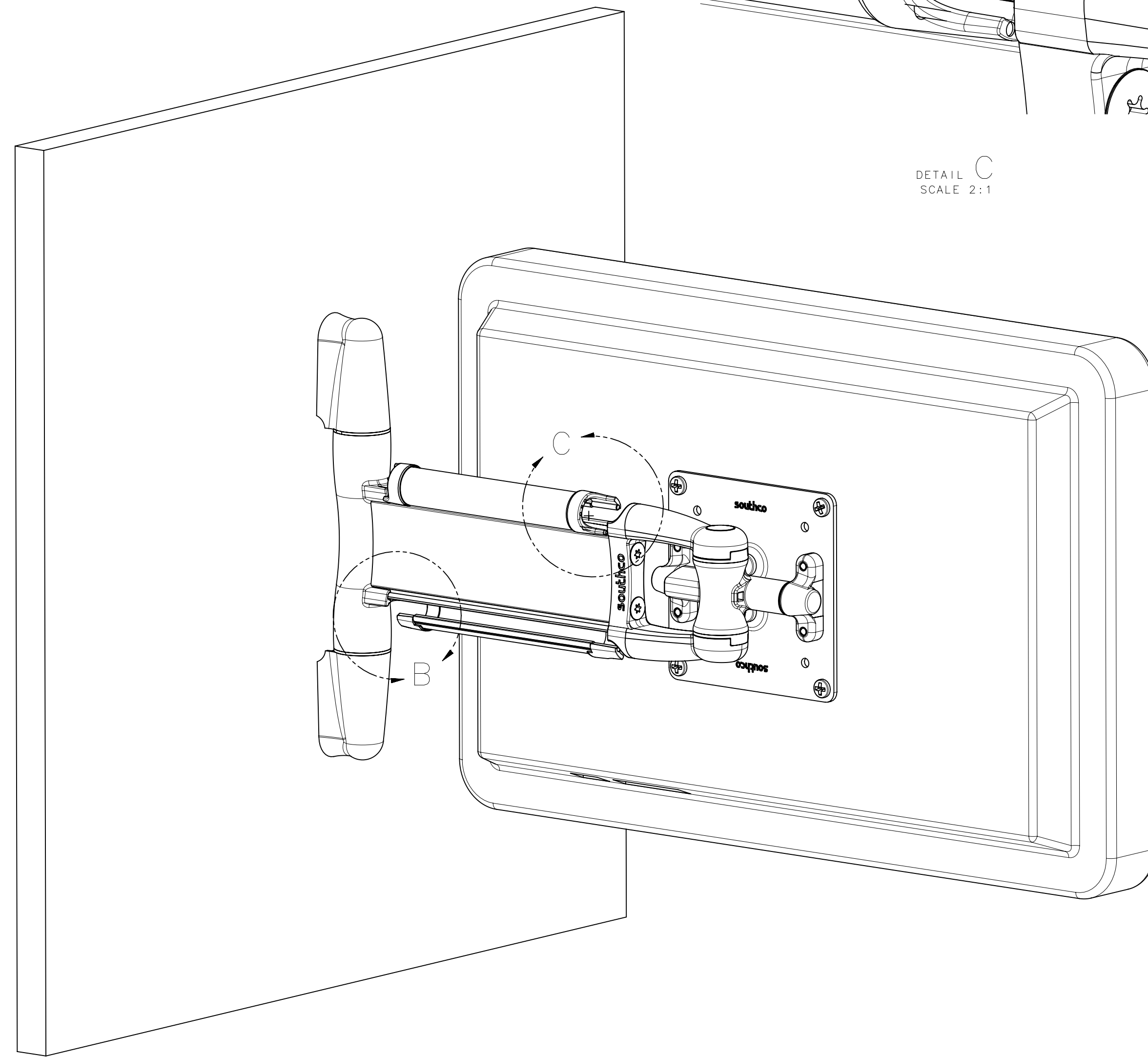

STEP 5

1. SNAP OPEN HINGED COVERS TO ROUTE WIRES THROUGH UPPER OR LOWER CHANNELS TO SUIT INSTALLATION AND DISPLAY WIRING LOCATIONS.

NOTE: TO OPEN COVERS, PLACE THUMBS ON RIB ADJACENT AND PUSH AWAY FROM CENTER ARM SUPPORT TO RELEASE COVER SNAP FIT.

2. CLOSE COVERS UNTIL LATCHED TO SECURE WIRES.

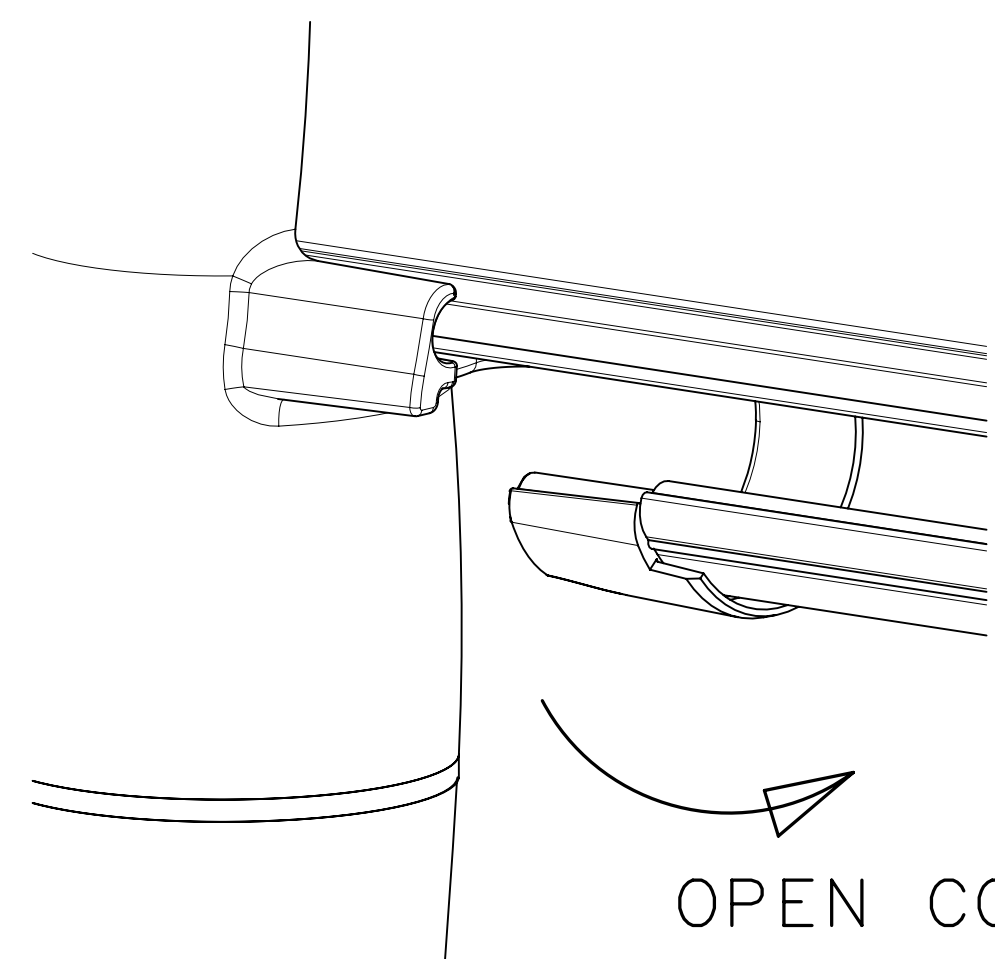

OPEN COVER IN  
DIRECTION OF ARROW

DETAIL B  
SCALE 2:1

THIRD ANGLE PROJECTION				<b>southco</b> CONNECT • CREATE • INNOVATE	
MILLIMETERS [IN]					
SURFACE AREA		mm <sup>2</sup>		TOLERANCES UNLESS OTHERWISE NOTED	
VOLUME		mm <sup>3</sup>		ALL DIMENSIONS WITHOUT TOLERANCES ARE FOR REFERENCE ONLY.	
PROPRIETARY ITEM		EXCEPT FOR USES EXPRESSLY GRANTED IN WRITING, INFORMATION DISCLOSED HEREON IS CONFIDENTIAL AND ALL RIGHTS, PATENT AND OTHER INTEL. ARE RESERVED BY SOUTHCO, INC.		DESCRIPTION Hinge & Controlled Motion Device ARM ASSEMBLY	
PER ASME Y14.5M-1994		SIZE D	SYSTEM NX	DWG NO. J-AV-D30-25A103	
DRAWN BY GEA		DATE 02FEB2010		SCALE 1:1	SHEET 4 OF 5

REVISION HISTORY			
REV	DATE	BY	DESCRIPTION
A	02FEB2010	GEA	PRN: INITIAL RELEASE

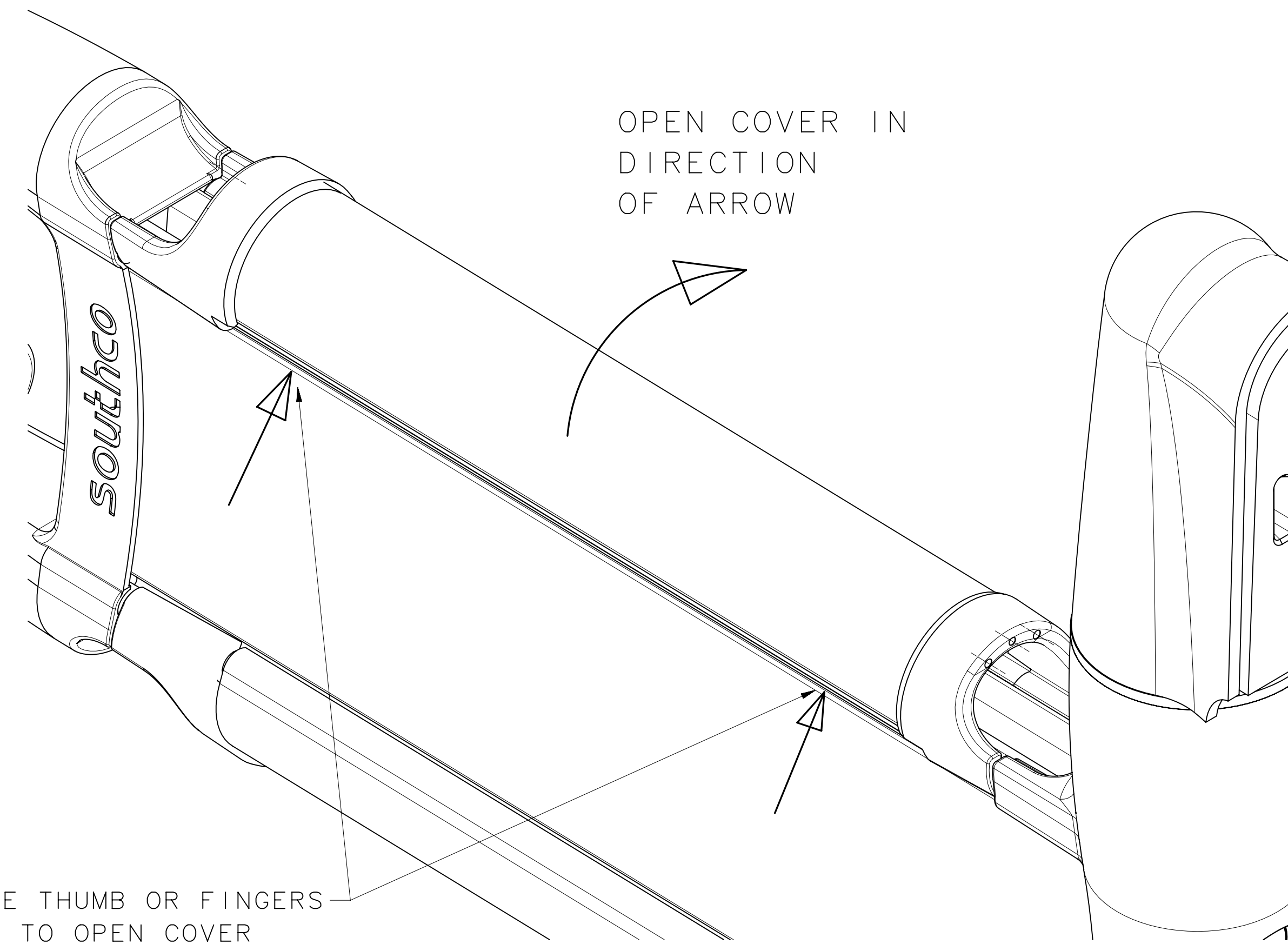
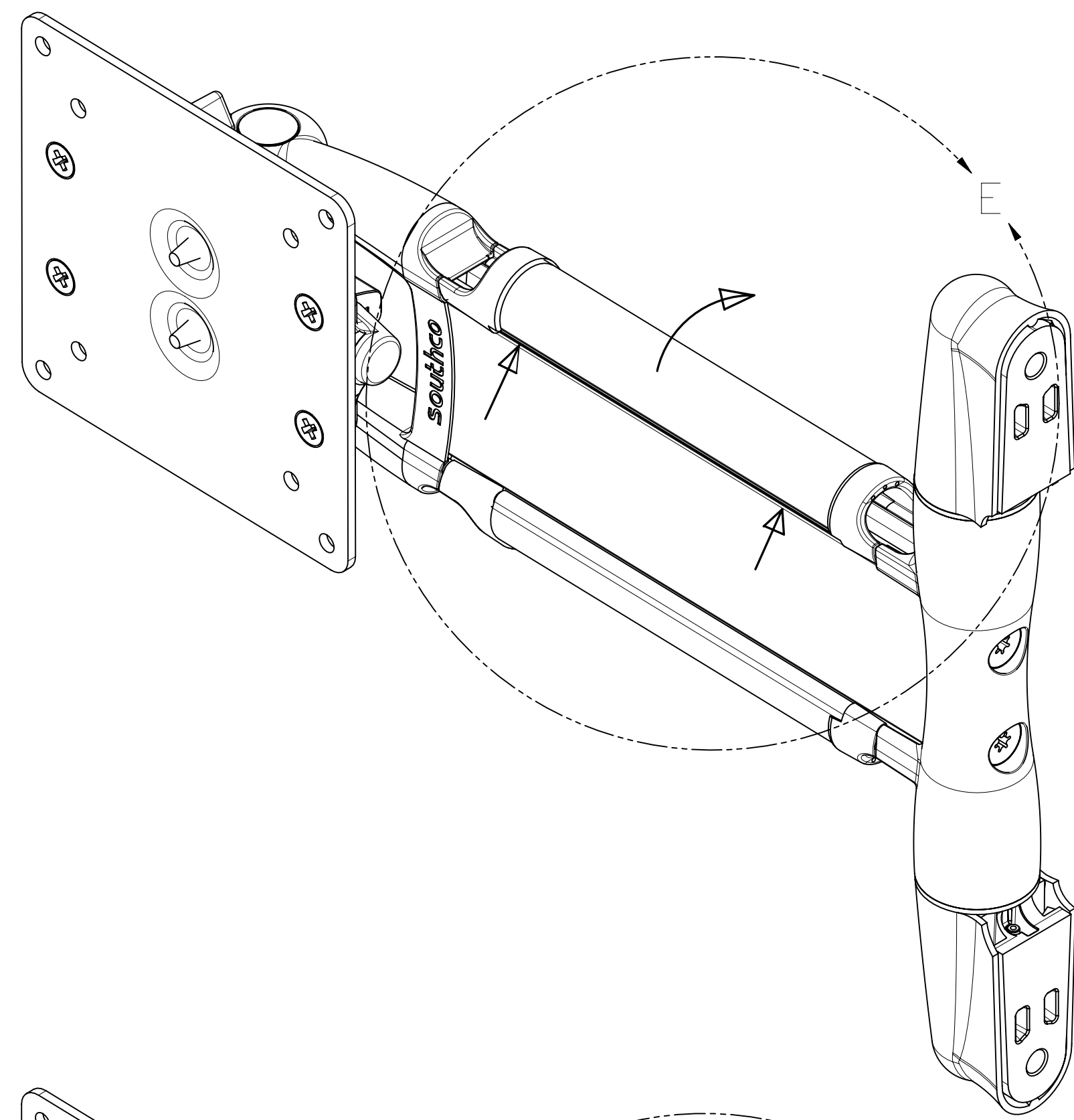

DETAIL E  
SCALE 2:1

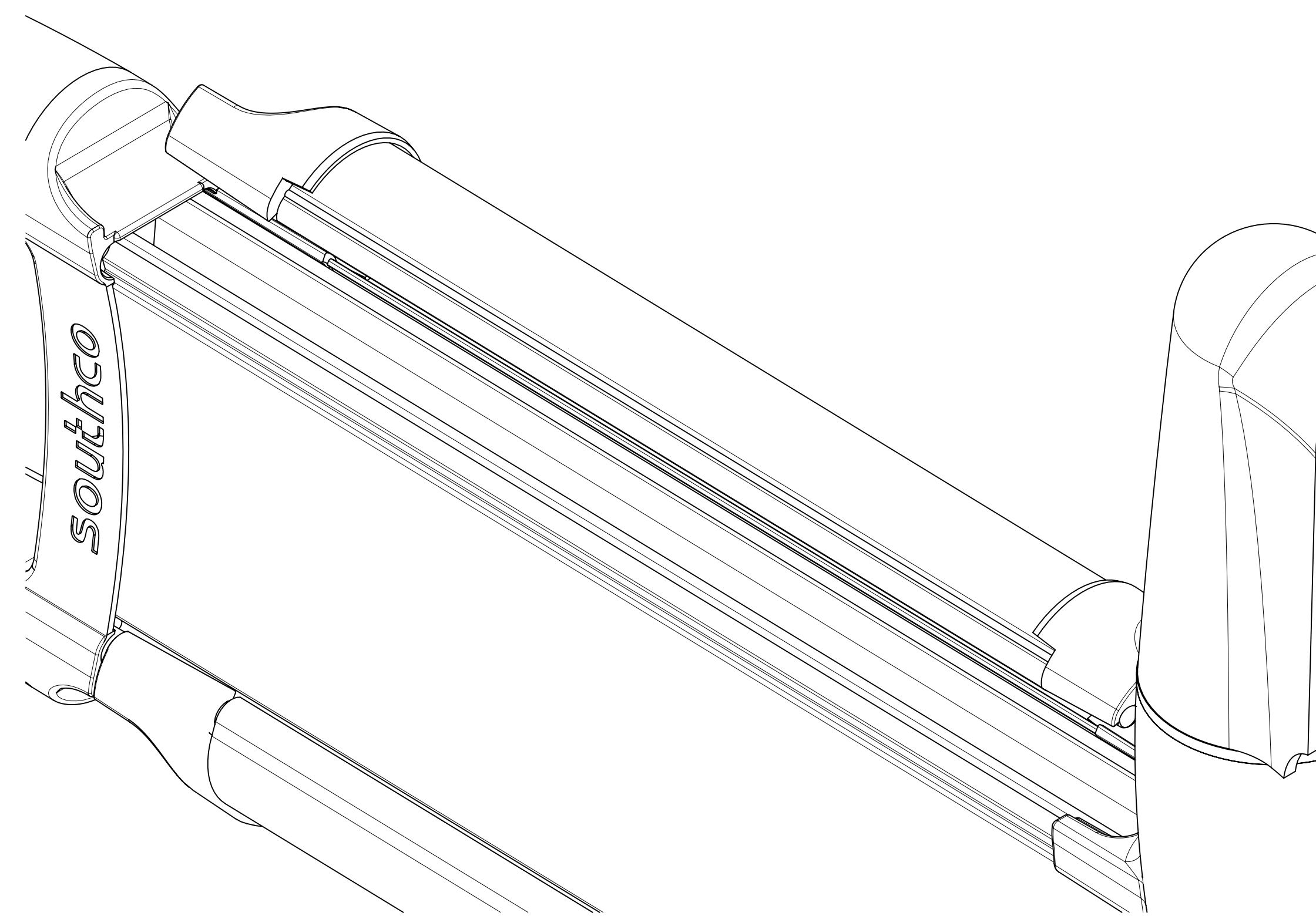
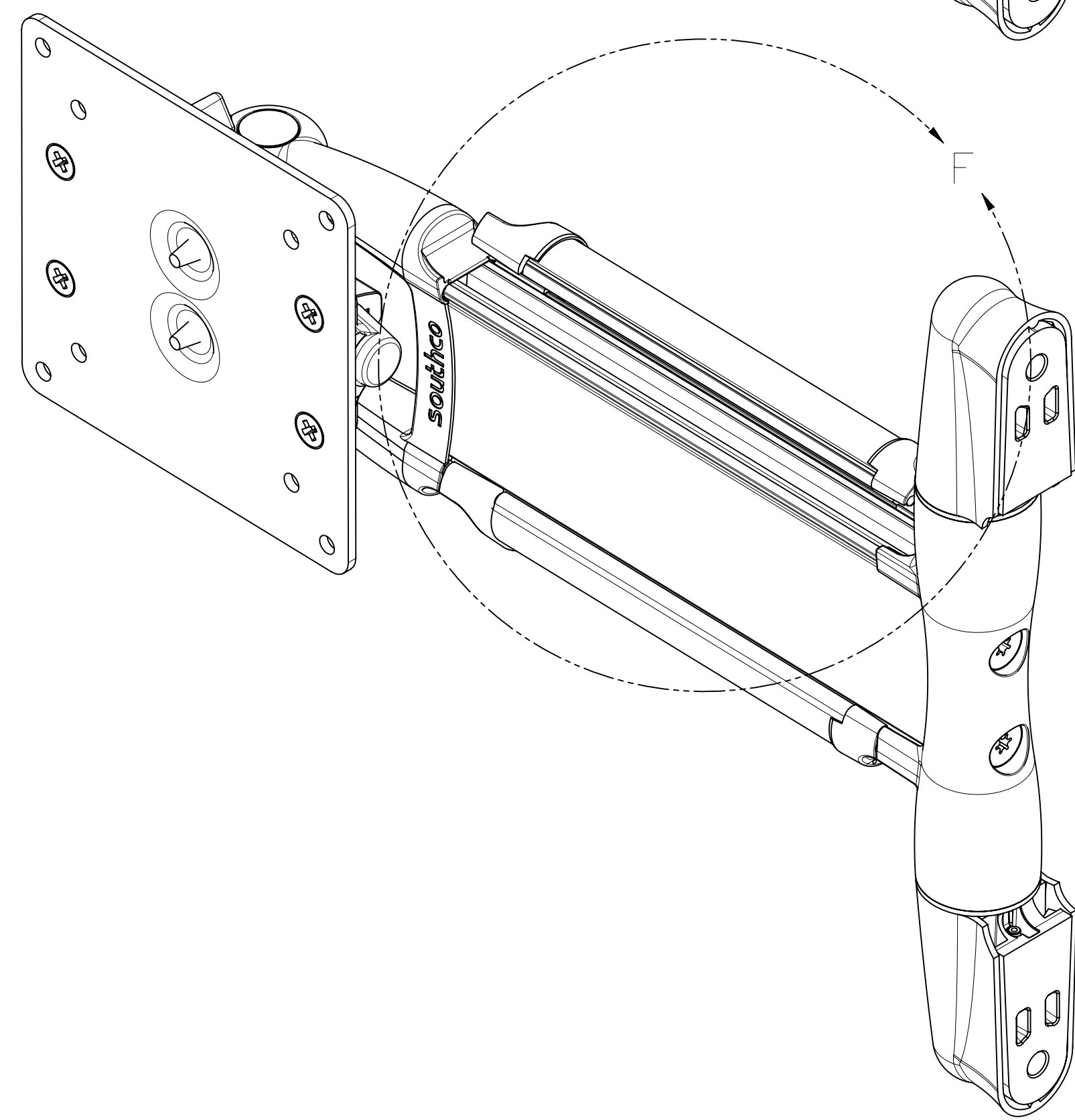

DETAIL F  
SCALE 2:1

THIRD ANGLE PROJECTION				<b>southco</b> <sup>®</sup> CONNECT • CREATE • INNOVATE	
MILLIMETERS [IN]					
SURFACE AREA mm <sup>2</sup>		TOLERANCES UNLESS OTHERWISE NOTED		DESCRIPTION	
VOLUME mm <sup>3</sup>		ALL DIMENSIONS WITHOUT TOLERANCES ARE FOR REFERENCE ONLY.		Hinge & Controlled Motion Device ARM ASSEMBLY	
PROPRIETARY ITEM		PER ASME Y14.5M-1994		SIZE D	SYSTEM NX
EXCEPT FOR USES EXPRESSLY GRANTED IN WRITING, INFORMATION DISCLOSED HEREON IS CONFIDENTIAL AND ALL RIGHTS, PATENT AND OTHERWISE, ARE RESERVED BY SOUTHCO, INC.		DRAWN BY GEA		DATE 02FEB2010	SCALE 1:1
				SHEET 5 OF 5	