

REVISION HISTORY			
REV	DATE	BY	DESCRIPTION
B	26MAY2020	GEA/DMS	PRN: P2020-0958

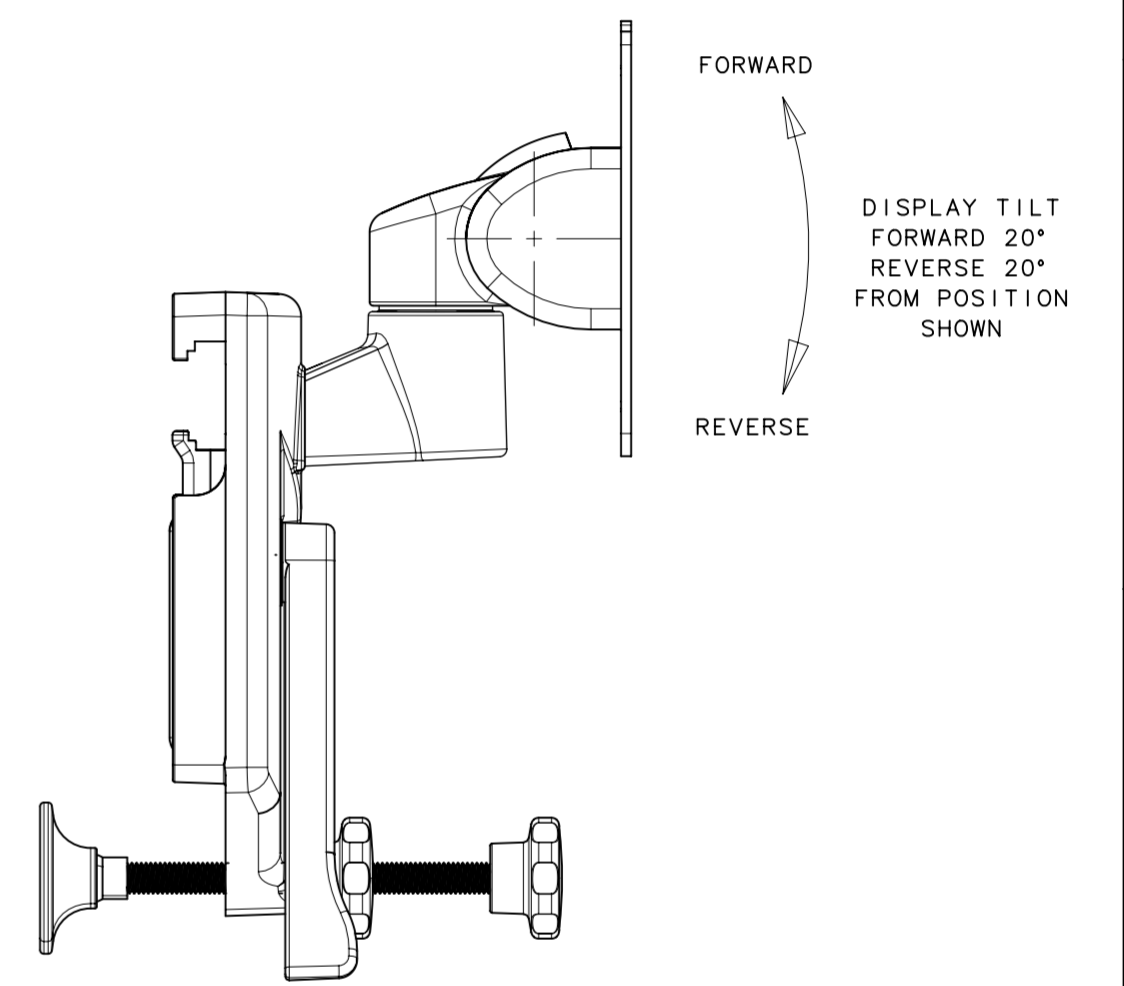

- NOTES:
- ALL EXTERIOR SURFACES CLASS C PER SOUTHCO FINISH SPECIFICATION S-121. ALL INTERIOR SURFACES CLASS D PER SOUTHCO FINISH SPECIFICATION S-121.
 - TILT TORQUE MEASURED WITH VESA DISPLAY PLATE IN THE VERTICAL (0° ± 5°) POSITION WHEN TILTING IN THE REVERSE DIRECTION. NOTE: THE TILT TORQUE VARIES WITH THE COUNTERBALANCE (WHEN EQUIPPED) IN THE FORWARD AND REVERSE DIRECTIONS.
 - DISPLAY MOUNTING PLATE TO HOUSING ANGULAR FREE PLAY TO BE 1.5° MAXIMUM.
 - SCREWS AFFIXING HOUSING MOUNT TO MOUNTING PLATE ARE NOT TO BE REMOVED. IF REMOVED OR LOOSENED, REPLACE USING NEW M6-1.0x0.25, CLASS 12.9, HIGH TENSILE CAP HEAD SCREWS AND PLAIN WASHERS AND TIGHTEN TO 14-16 Nm.
 - MATERIALS AND FINISHES:
 - ADAPTERS: DIE CAST ALUMINUM ANODIZED AND POWDER COATED
 - TILT HOUSING, SWIVEL HOUSING: DIE CAST ALUMINUM, POWDER COATED
 - TILT SLEEVE AND THRUST WASHER: ACETAL, BLACK
 - COILED PIN: STEEL, PHOSPHATE COATED
 - TILT SHAFT, TORQUE ELEMENTS AND STOP WASHER: STEEL, NATURAL FINISH
 - DISPLAY MOUNTING PLATE: PHOSPHATE AND POWDER COATED
 - TORSION SPRING: CARBON STEEL, NICKEL PLATED
 - DISPLAY SCREWS: STEEL, BLACK OXIDE
 - DISPLAY STOPS: POLYETHYLENE, WHITE
 - SWIVEL SHAFT: STAINLESS STEEL AND NYLON
 - LUBRICANT: HYDROCARBON BASE
 - M6X1.0 CAP SCREWS: ALLOY STEEL, BLACK OXIDE
 - M6 FLAT WASHERS: STEEL, ZINC PLATED
 - LABEL: VINYL WITH POLYESTER ADHESIVE
 - DIN RAIL: DIE CAST ALUMINUM ANODIZED AND POWDER COATED
 - DISPLAY PIVOT ANGLE IS LIMITED BY DEVICES INSTALLED ONTO ASSEMBLY WHEN INSTALLED ONTO HORIZONTAL RAIL.

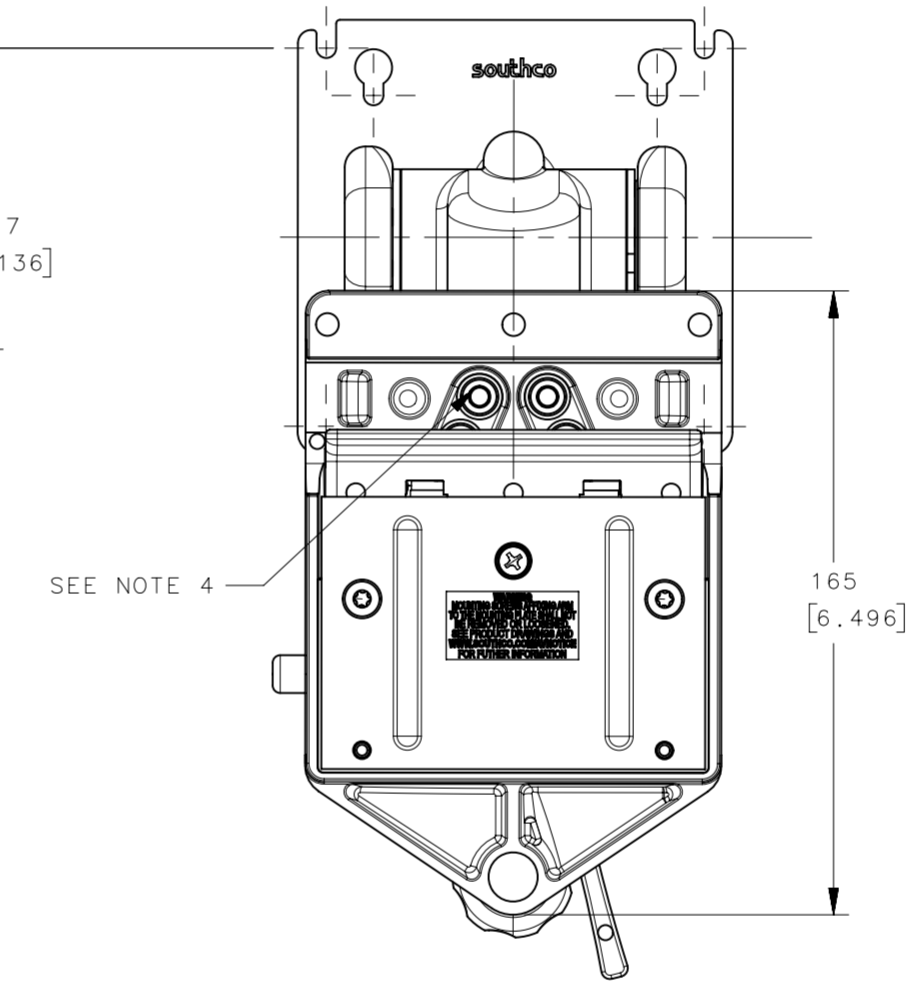
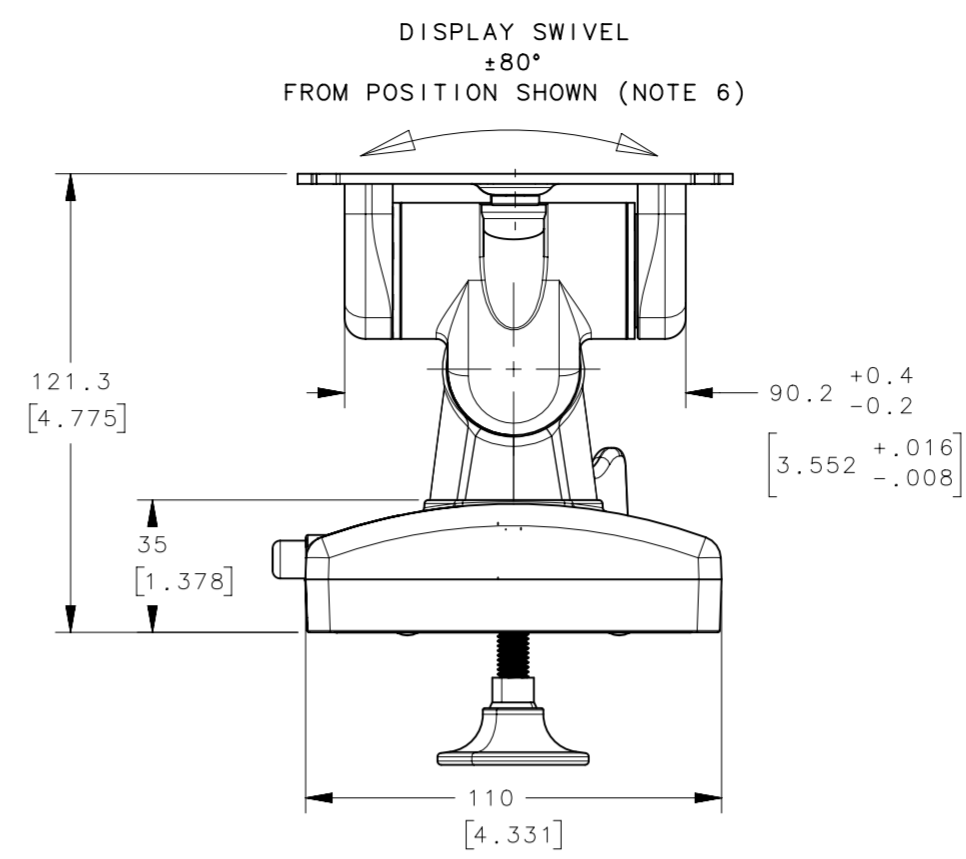
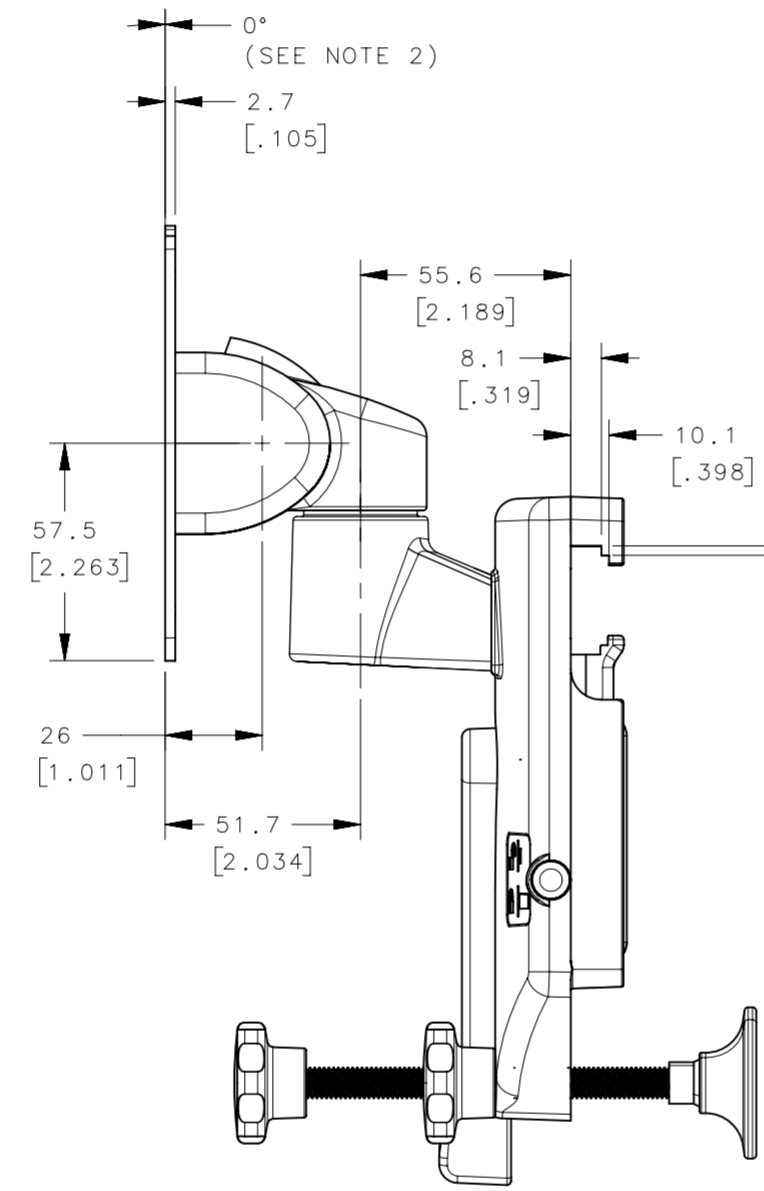
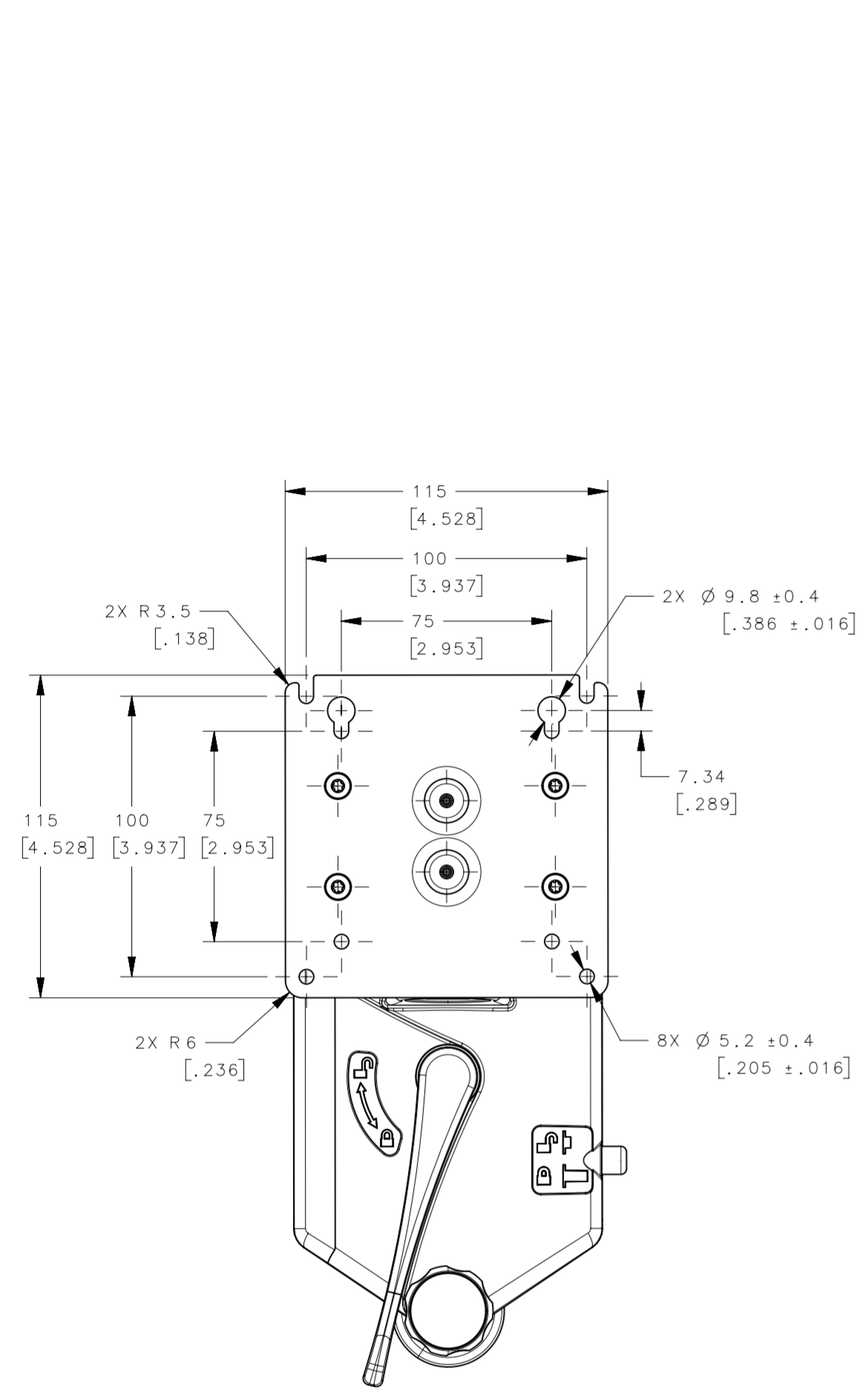
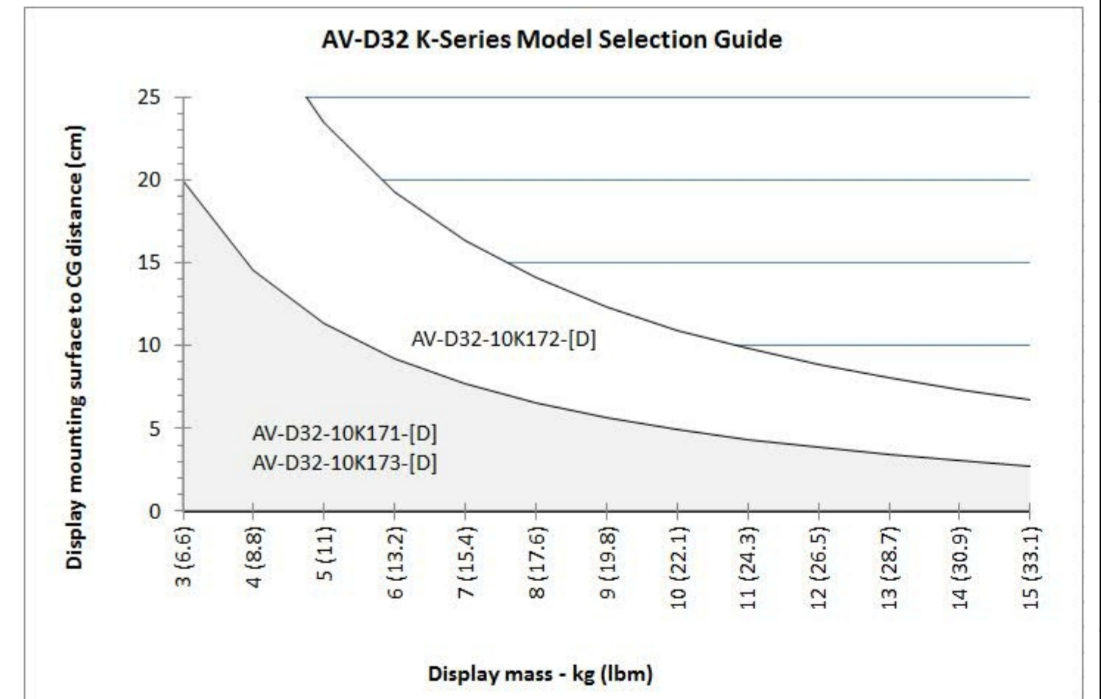

PART NUMBER	REVERSE TILT TORQUE N*m (lbf*in)	FORWARD TILT TORQUE N*m (lbf*in)	SWIVEL SYMMETRIC TORQUE	COLOR
AV-D32-10K171-50	7.9 (70)	1.13 (10)	4.29 N*m (38 lbf*in)	BLACK
AV-D32-10K171-76			NOMINAL / 2.17 N*m (24 lbf*in) MINIMUM	OFFICE WHITE
AV-D32-10K172-50	15.4 (136)	2.26 (20)		BLACK
AV-D32-10K172-76				OFFICE WHITE
AV-D32-10K173-50	8.6 (76)	6.0 (53)		BLACK
AV-D32-10K173-76				OFFICE WHITE

THIRD ANGLE PROJECTION	 CONNECT · CREATE · INNOVATE
MILLIMETERS [IN]	
SURFACE AREA	TOLERANCES UNLESS OTHERWISE NOTED
VOLUME	ALL DIMENSIONS WITHOUT TOLERANCES ARE FOR REFERENCE ONLY.
PROPRIETARY ITEM EXCEPT FOR USES EXPRESSLY GRANTED IN WRITING, INFORMATION DISCLOSED HEREON IS CONFIDENTIAL AND ALL RIGHTS, PATENT AND OTHERWISE, ARE RESERVED BY SOUTHCO, INC.	DESCRIPTION TILT & SWIVEL DISPLAY MOUNT DIN RAIL MOUNT SIZE SYSTEM A2 NX DWG NO. J-AV-D32-10K171 DRAWN BY CBI/DMS DATE 25APR2018 SCALE 1:2 SHEET 1 OF 2

REVISION HISTORY			
REV	DATE	BY	DESCRIPTION
B	26MAY2020	GEA/DMS	PRN: P2020-0958

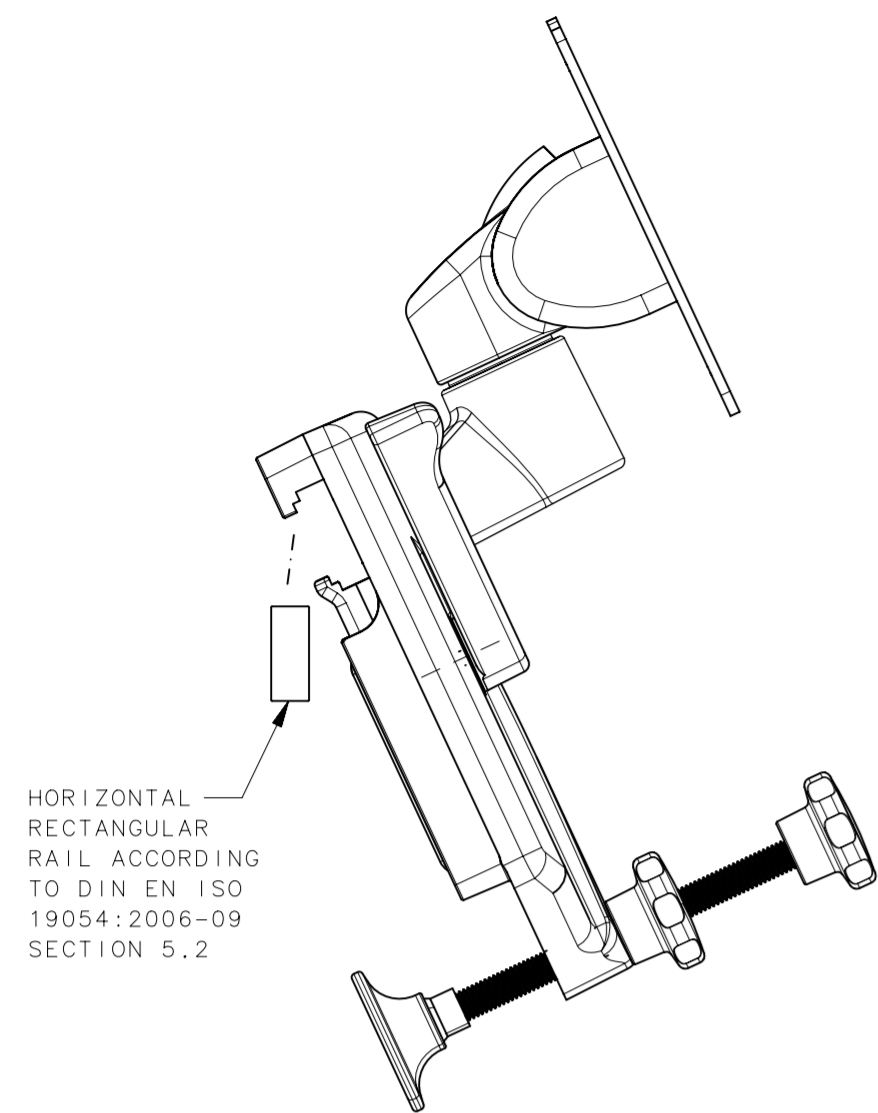

HORIZONTAL RECTANGULAR RAIL ACCORDING TO DIN EN ISO 19054:2006-09 SECTION 5.2

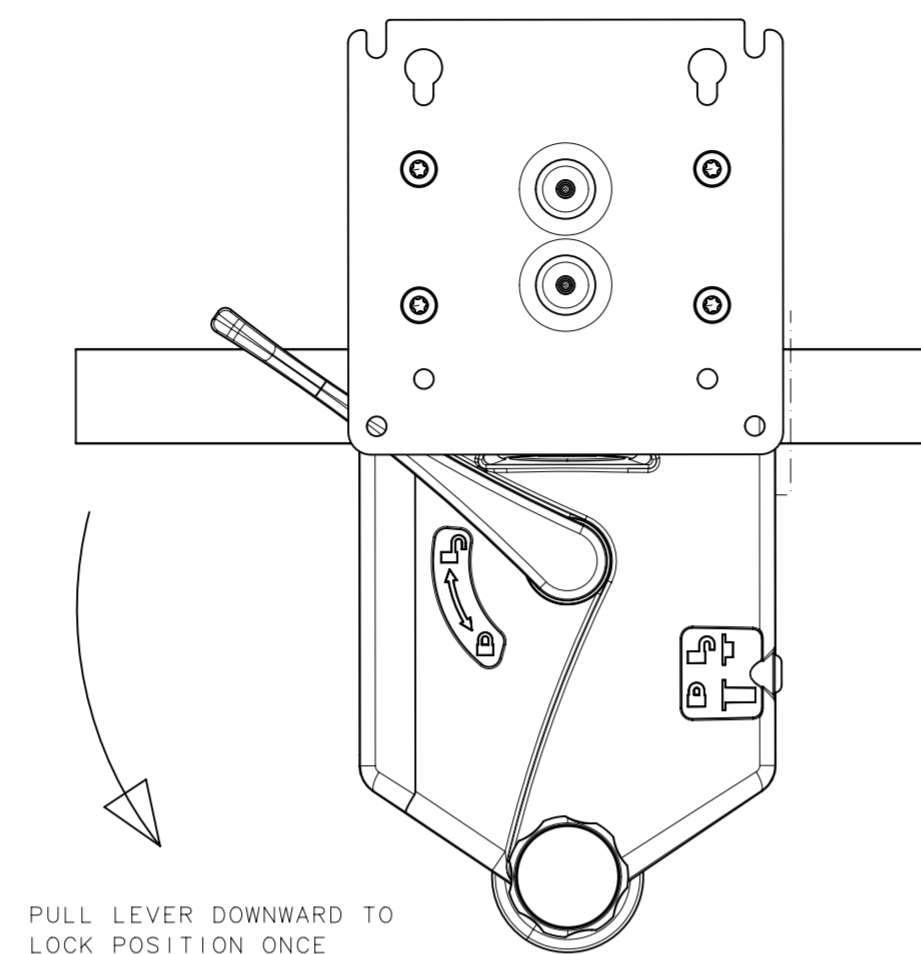

PULL LEVER DOWNWARD TO LOCK POSITION ONCE DIN RAIL IS IN PLACE

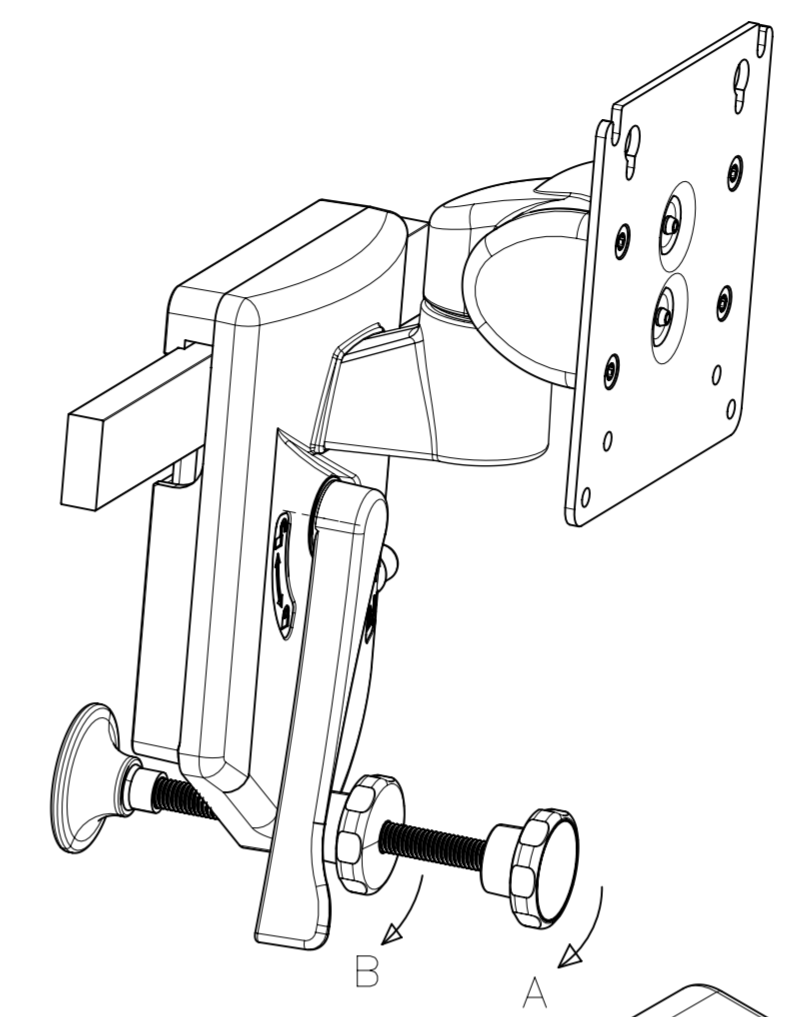

A
B

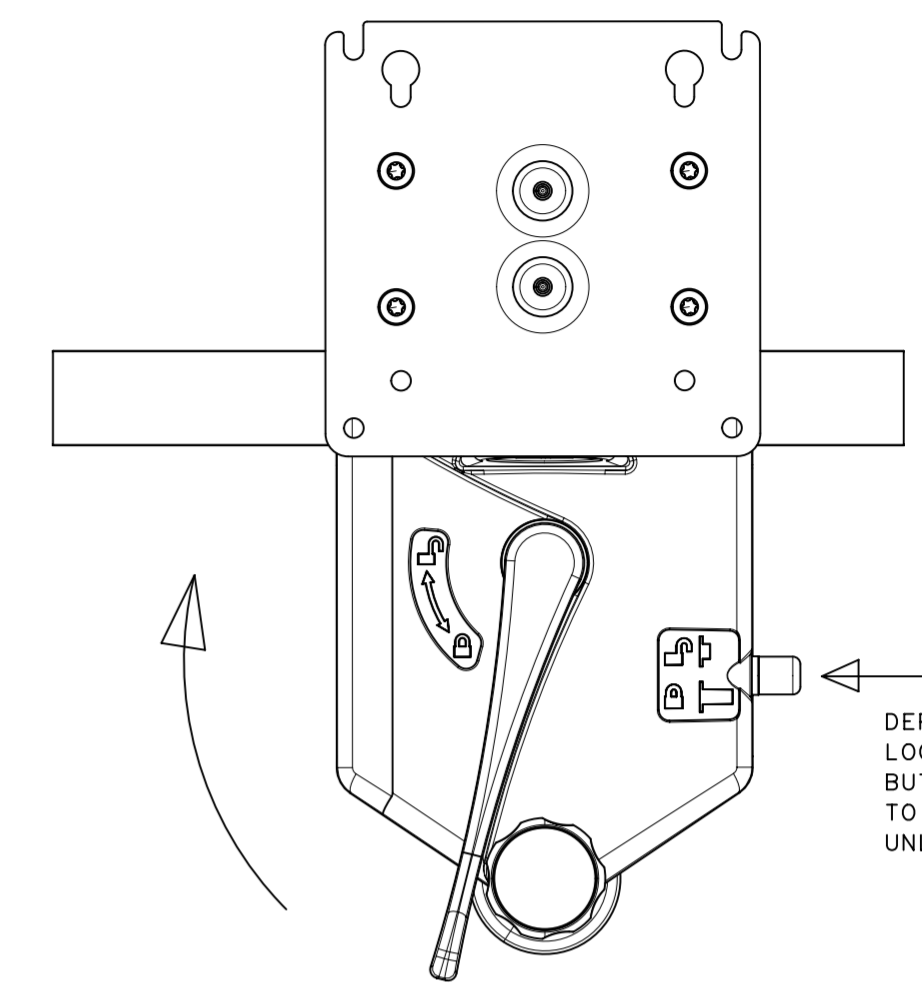

DEPRESS LOCK BUTTON TO UNLOCK

TO UNLOCK, DEPRESS AND HOLD BUTTON AND LIFT LEVER TO THE UNLOCK POSITION

INSTALLATION INSTRUCTIONS:
 INSERT TOP OF DIN RAIL MOUNT CLAMP INTO DIN RAIL AT AN ANGLE AND LOWER THE CLAMP AROUND THE BOTTOM OF THE RAIL. ONCE MOUNT IS IN PLACE, TURN LOCKING LEVER DOWN TO LOCK POSITION. WHILE STILL SUPPORTING THE ARM AT A LEVEL HEIGHT, TURN ADJUSTMENT SCREW 'A' IN DIRECTION SHOWN UNTIL CONTACT WITH WALL IS OBTAINED AND ARM ASSEMBLY IS LEVEL. DO NOT OVERTIGHTEN. TIGHTEN LOCKNUT 'B' TO SECURE. TO UNLOCK AND DISMOUNT FROM DIN RAIL, PRESS AND HOLD BUTTON IN. TURN LEVER BACK TO UNLOCK POSITION.

NOTES:
 DIN RAIL DIMENSION TO BE 8±0.1 X 30±0.2 OR 10±0.1 X 25±0.2. MADE TO SPECIFICATION DIN EN ISO 19054:2006-09 SECTION 5.2

CAUTION:
 BECAUSE OF THE WIDE VARIETY OF AVAILABLE WALL MATERIALS AND MOUNTING HARDWARE, IT IS THE INSTALLER'S RESPONSIBILITY TO ENSURE THAT THE MATERIALS AND STRUCTURE TO WHICH THE ARM IS MOUNTED, AND THE MOUNTING HARDWARE SELECTED WILL PROVIDE ADEQUATE SUPPORT FOR PROPER FUNCTIONING AND WEIGHT BEARING LOAD. SOUTHCO ASSUMES NO LIABILITY FOR THE SELECTION OF WALL MATERIALS, STRUCTURE OR MOUNTING HARDWARE.

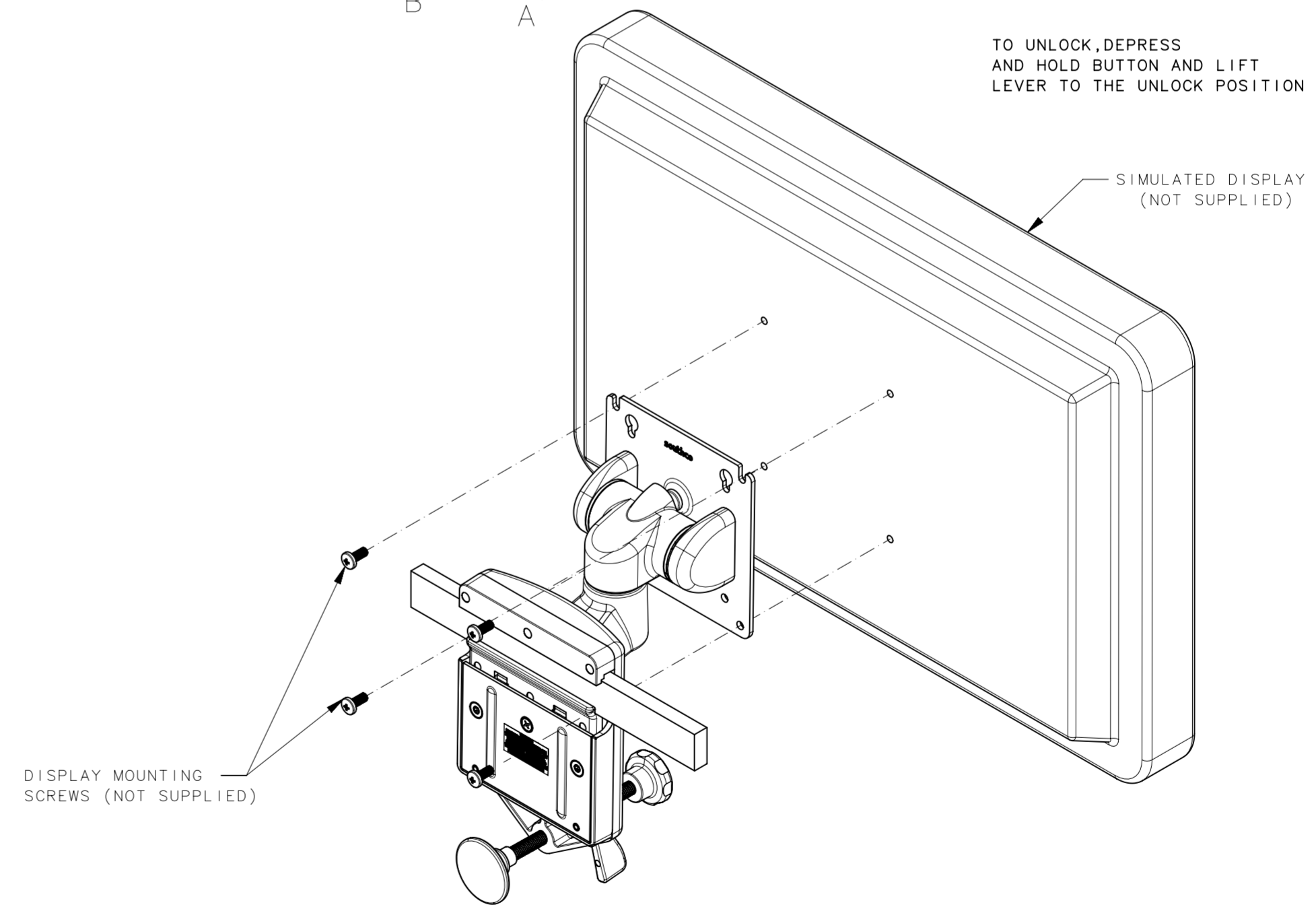

DISPLAY MOUNTING SCREWS (NOT SUPPLIED)

SIMULATED DISPLAY (NOT SUPPLIED)

	THIRD ANGLE PROJECTION	southco CONNECT · CREATE · INNOVATE	
	MILLIMETERS [IN]		
SURFACE AREA	TOLERANCES UNLESS OTHERWISE NOTED	DESCRIPTION TILT & SWIVEL DISPLAY MOUNT DIN RAIL MOUNT	
VOLUME	ALL DIMENSIONS WITHOUT TOLERANCES ARE FOR REFERENCE ONLY.	SIZE A2	SYSTEM NX
PROPRIETARY ITEM	EXCEPT FOR USES EXPRESSLY GRANTED IN WRITING, INFORMATION DISCLOSED HEREON IS CONFIDENTIAL AND ALL RIGHTS, PATENT AND OTHERWISE, ARE RESERVED BY SOUTHCO, INC.	DWG NO. J-AV-D32-10K171	
	PER ASME Y14.5M-1994	DRAWN BY CBI/DMS	DATE 25APR2018
		SCALE 1:2	SHEET 2 OF 2