

WARNING:
TO REDUCE THE RISK OF INJURY MOVE ARM INTO HIGHEST POSITION BEFORE REMOVING DEVICE ATTACHED TO ARM. ARM TO REMAIN IN HIGHEST POSITION UNTIL DEVICE IS FULLY MOUNTED ONTO THE ARM.

警告:
当需要在机械臂上安装或移除设备时, 请将手臂保持在垂直位置, 防止机械臂滑落碰伤。

REVISION HISTORY			
REV	DATE	BY	DESCRIPTION
D	29JUL2020	CWA/JZ	PRN: P2020-1445

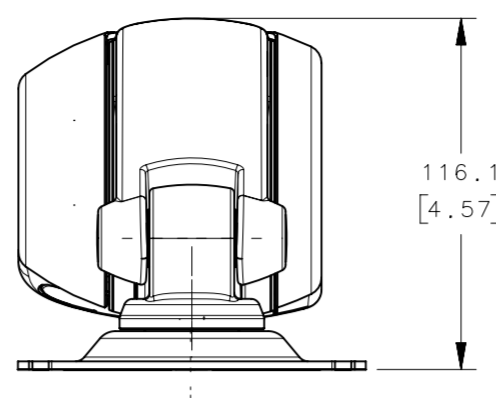

INSIDE HOLE OF PANEL PREPARATION MUST BE FREE OF SHARP CORNERS, EDGES, SAW CUT MARKS, BURRS OR OTHER EDGE CONDITIONS THAT MAY DAMAGE POWER OR SIGNAL CABLES ROUTED THROUGH THE ARM BASE MOUNTING PLATE INTO THE ARM

预备的安装板内孔要求规范: 无尖角, 无锐边, 无明显切割痕迹, 无毛刺等, 为了避免在线缆穿过底座安装板进入机械臂时发生损伤。

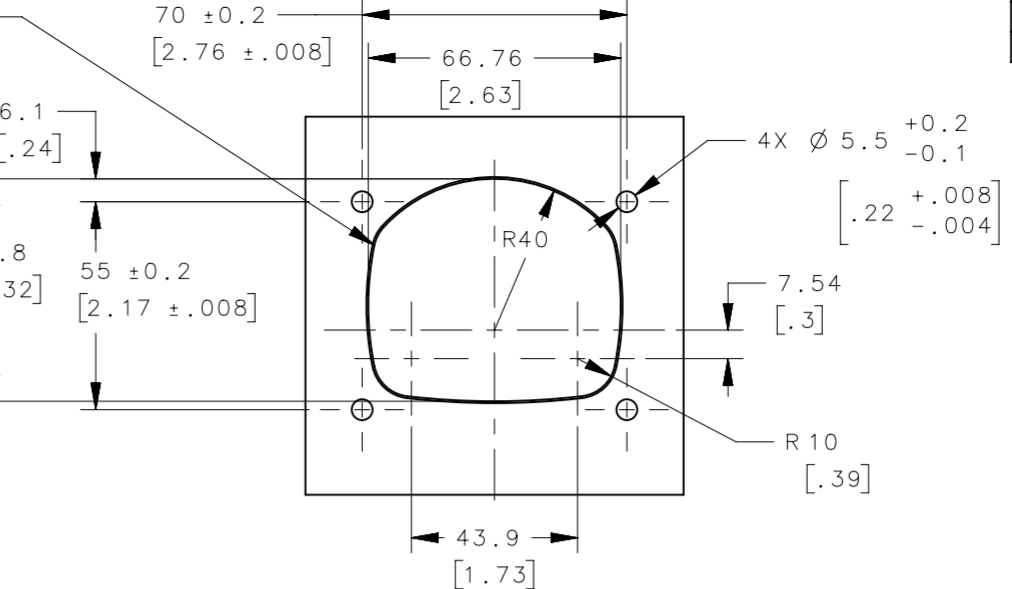

PANEL PREPARATION
预备的安装板

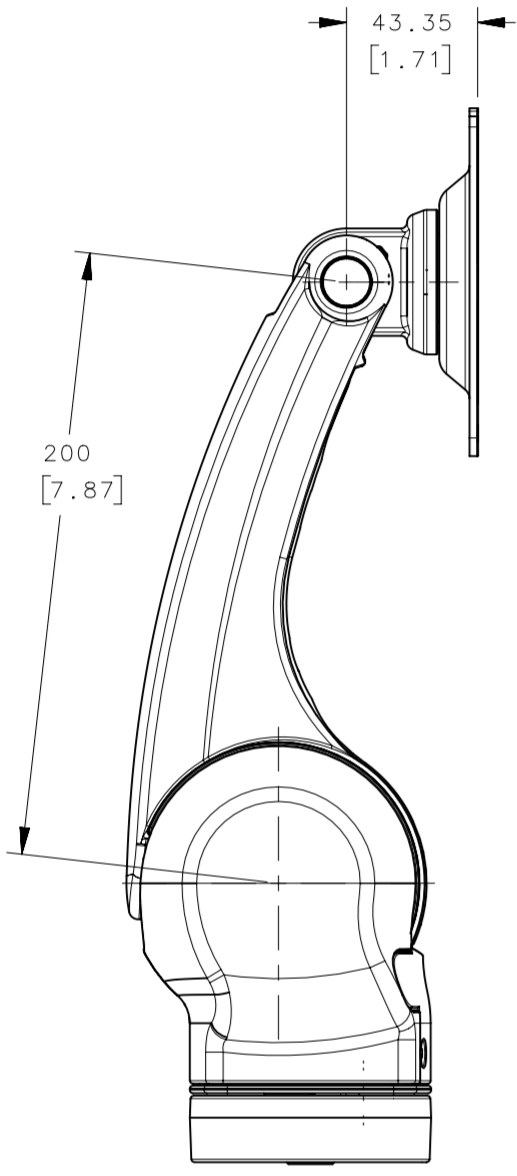
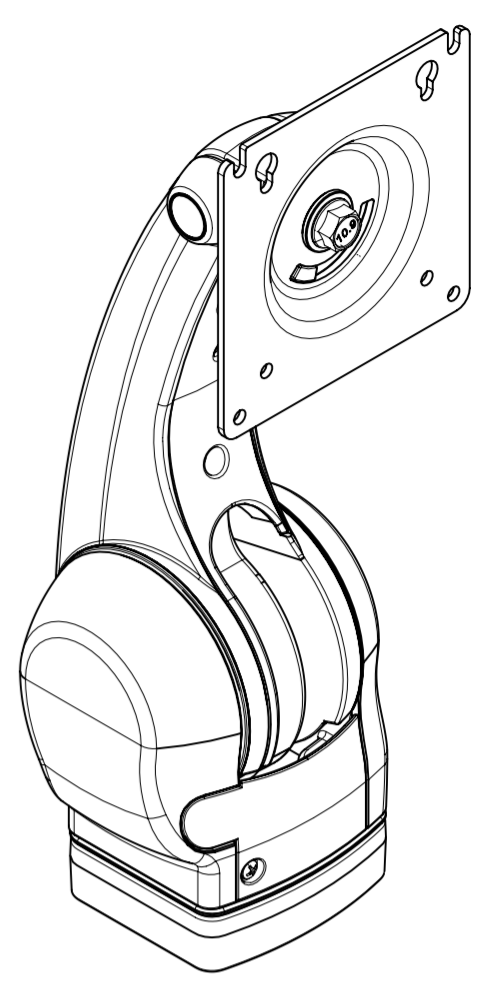

DISPLAY ROTATION (PORTRAIT TO LANDSCAPE)
5° COUNTERCLOCKWISE
95° CLOCKWISE
FROM POSITION SHOWN
从当前位置可逆时针旋转5°
顺时针旋转95°

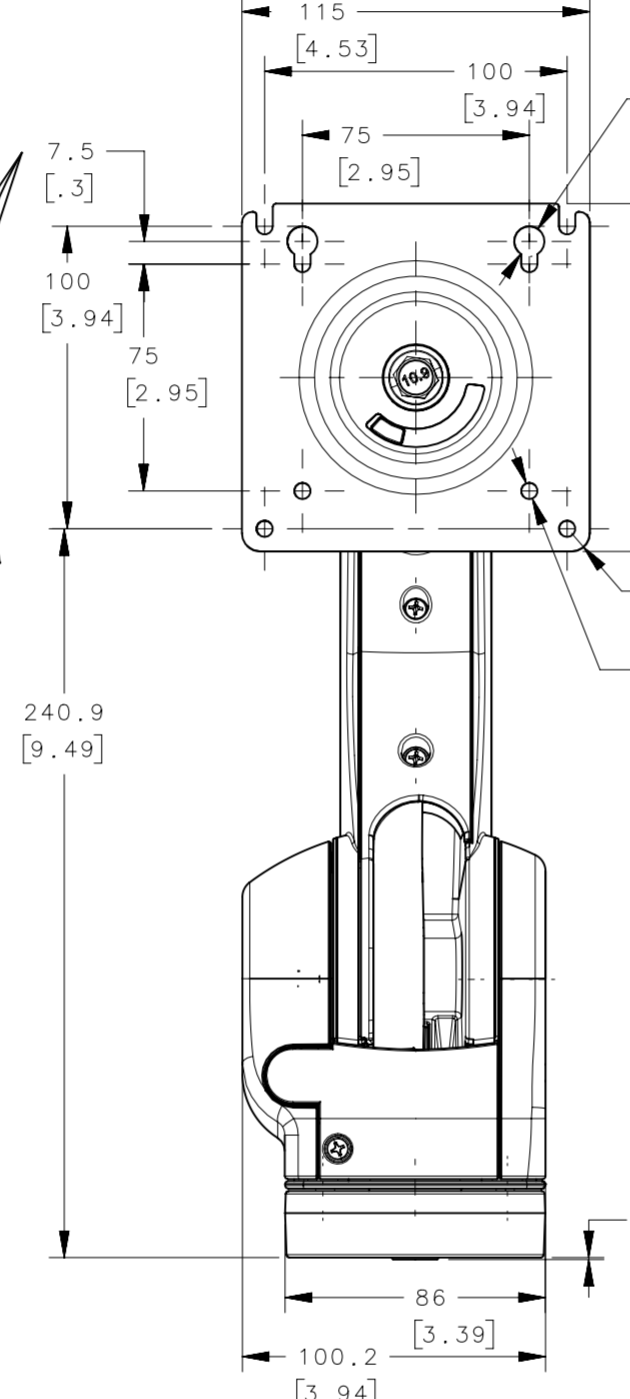

DISPLAY TILT
30° REVERSE
150° FORWARD
FROM POSITION SHOWN
从当前位置可正倾150°
反倾30°

LOWER ARM PIVOT
90° DOWN
FROM POSITION SHOWN
下臂轴可从当前位置向下旋转90°

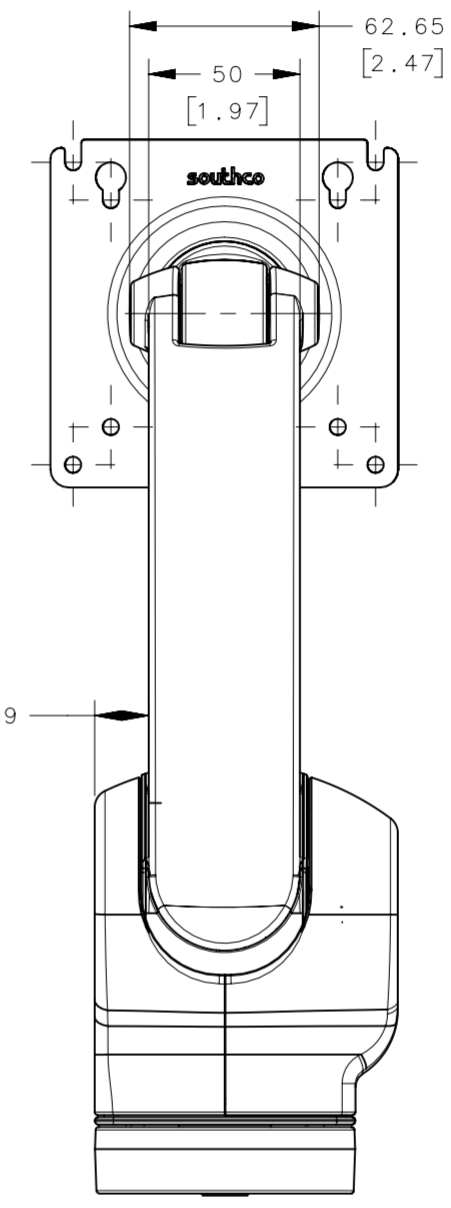
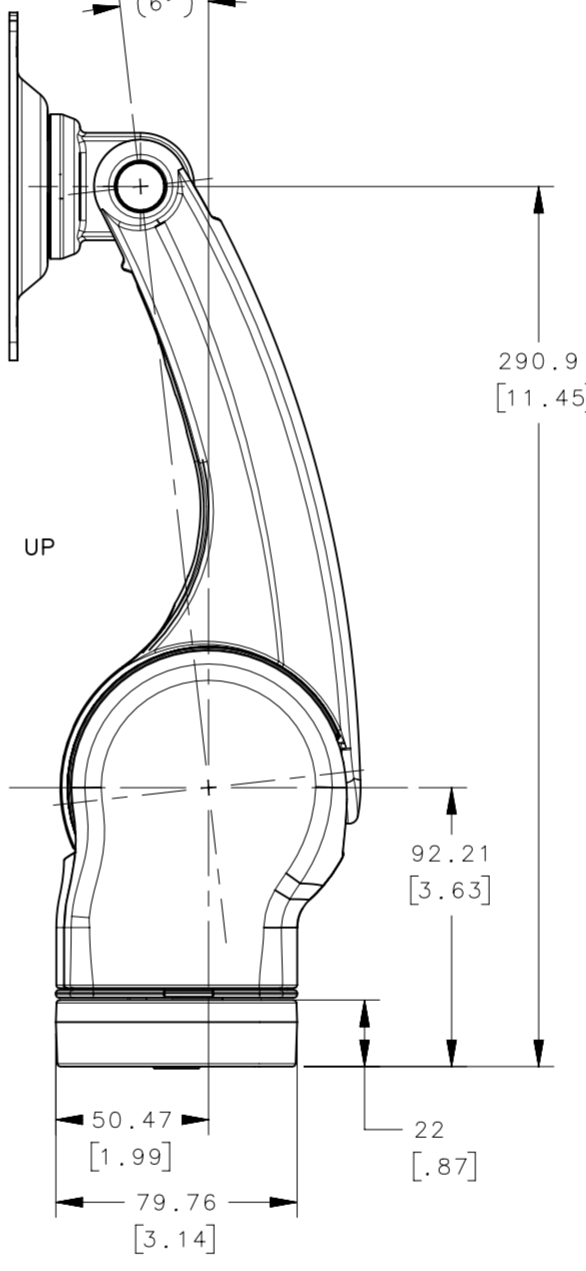

- NOTES:**
- COSMETIC SPECIFICATION PER SOUTHCO S-121 FOR POWDER COATING AND MOLDED PLASTIC PARTS. ALL EXTERIOR POWDER COATED SURFACES ARE CLASS C AND ALL EXTERIOR PLASTIC PART SURFACES CLASS C. ALL POWDER COATED INTERIOR SURFACES ARE CLASS D AND OVERSPRAY IS PERMITTED, WHEREAS ALL INTERIOR PLASTIC PART SURFACES ARE CLASS D.
 - ARM SWIVEL BASE TORQUE IS END USER ADJUSTABLE.
- 注释:**
- 模压塑料件和粉末喷涂的外观规范参考SOUTHCO S-121。所有粉末喷涂的外观为C级, 所有塑料件的外观为C级, 所有粉末喷涂的内表面为D级并允许局部过度喷涂, 所有内部塑料件的外观为D级。
 - 终端用户可调整机械臂底座的扭矩。

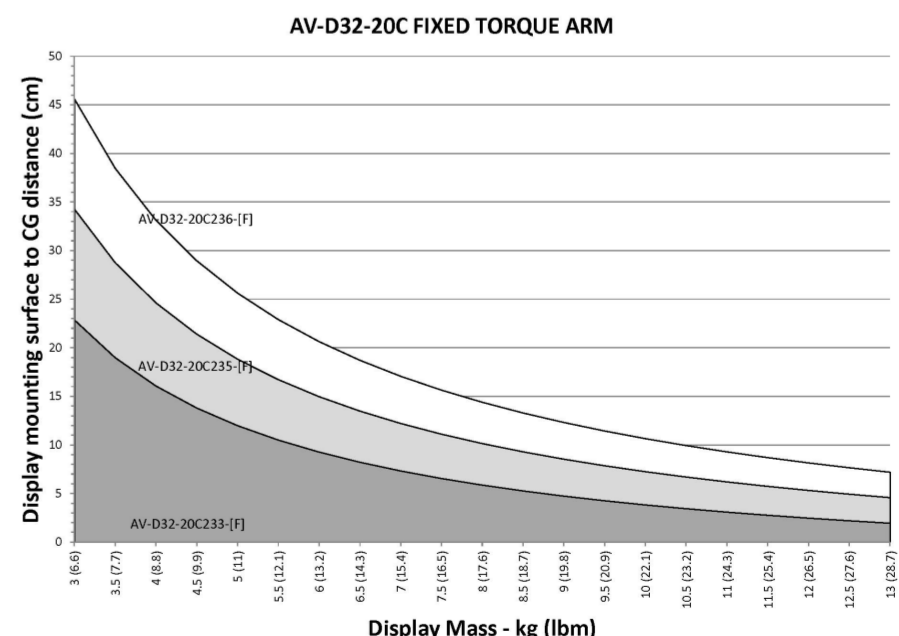
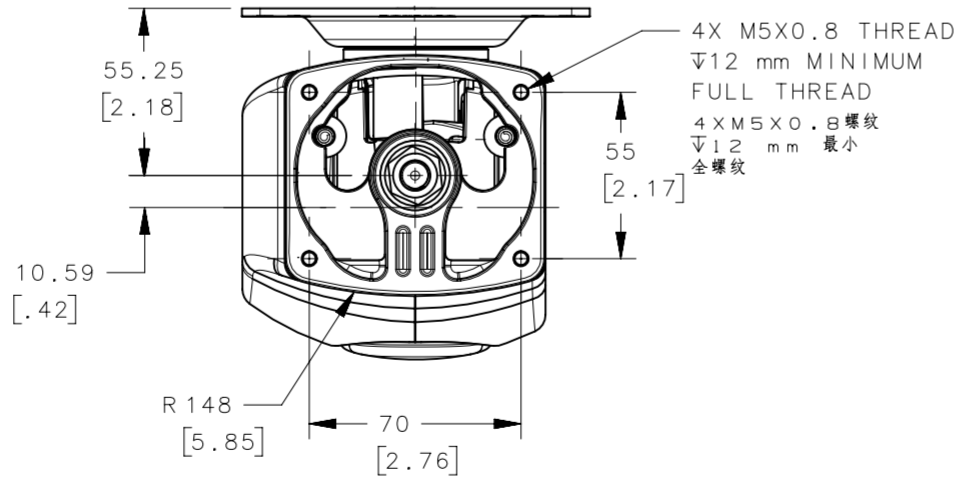

PART NUMBER 零件号	REVERSE DISPLAY TILT TORQUE N*m (lbf*in) 后倾扭矩	FORWARD DISPLAY TILT TORQUE N*m (lbf*in) 前倾扭矩	LOWER ARM PIVOT TORQUE IN DOWN DIRECTION WITHIN 5° OF LOWEST ARM POSITION 机械臂降至底部前5°范围内的最低臂位中心扭矩 N*m (lbf*in)	LOWER ARM PIVOT TORQUE IN DOWN DIRECTION WITHIN 5° FROM HIGHEST ARM POSITION 机械臂初始下拉5°范围内的最低臂位中心扭矩 N*m (lbf*in)	SYMMETRIC TORQUE TO SWIVEL ARM ASSEMBLY 旋转臂对称扭矩 N*m (lbf*in) [NOTE 2]	DISPLAY WEIGHT RANGE 载荷范围 Kg (lbm)	COLOR 颜色
AV-D32-20C233-50	8.0±1.6 (70.8±14.2)	6.4±1.3 (56.9±11.4)	22.8±4.6 (202±40.4)	17.8±3.6 (157.5±31.5)	2.8 (24.8) NOMINAL/ 1.3 (11.5) MINIMUM	3.62 To 6.8 (8 TO 15)	BLACK
AV-D32-20C233-76						5.6 TO 10.4 (12.3 TO 22.9)	OFFICE WHITE
AV-D32-20C235-50	11.35±2.3 (100.5±20)	8.5±1.7 (75.2±15)	40.2±8 (355.4±71)	30.1±6 (267±53.3)		6 TO 13 (13.2 TO 28.7)	BLACK
AV-D32-20C235-76						BLACK	
AV-D32-20C236-50	14.7±2.9 (130±26)	10.5±2.1 (93.6±18.6)				BLACK	
AV-D32-20C236-76							OFFICE WHITE

THIRD ANGLE PROJECTION	 CONNECT · CREATE · INNOVATE
MILLIMETERS [IN]	
SURFACE AREA XXXXXmm ²	TOLERANCES UNLESS OTHERWISE NOTED ALL DIMENSIONS WITHOUT TOLERANCE ARE FOR REFERENCE ONLY.
VOLUME XXXXXmm ³	
PROPRIETARY ITEM	DESCRIPTION HINGE & CONTROLLED MOTION DEVICE STANDARD DESKTOP ARM ASSEMBLY
EXCEPT FOR USES EXPRESSLY GRANTED IN WRITING, INFORMATION DISCLOSED HEREON IS CONFIDENTIAL AND ALL RIGHTS, PATENT AND OTHERWISE, ARE RESERVED BY SOUTHCO, INC.	SIZE SYSTEM A2 NX
PER ASME Y14.5M-1994	DWG NO. J-AV-D32-20C233
DRAWN BY GEA	DATE 03JAN2018
SCALE 1:1	SHEET 1 OF 3

REVISION HISTORY			
REV	DATE	BY	DESCRIPTION
D	29JUL2020	CWA/JZ	PRN: P2020-1445

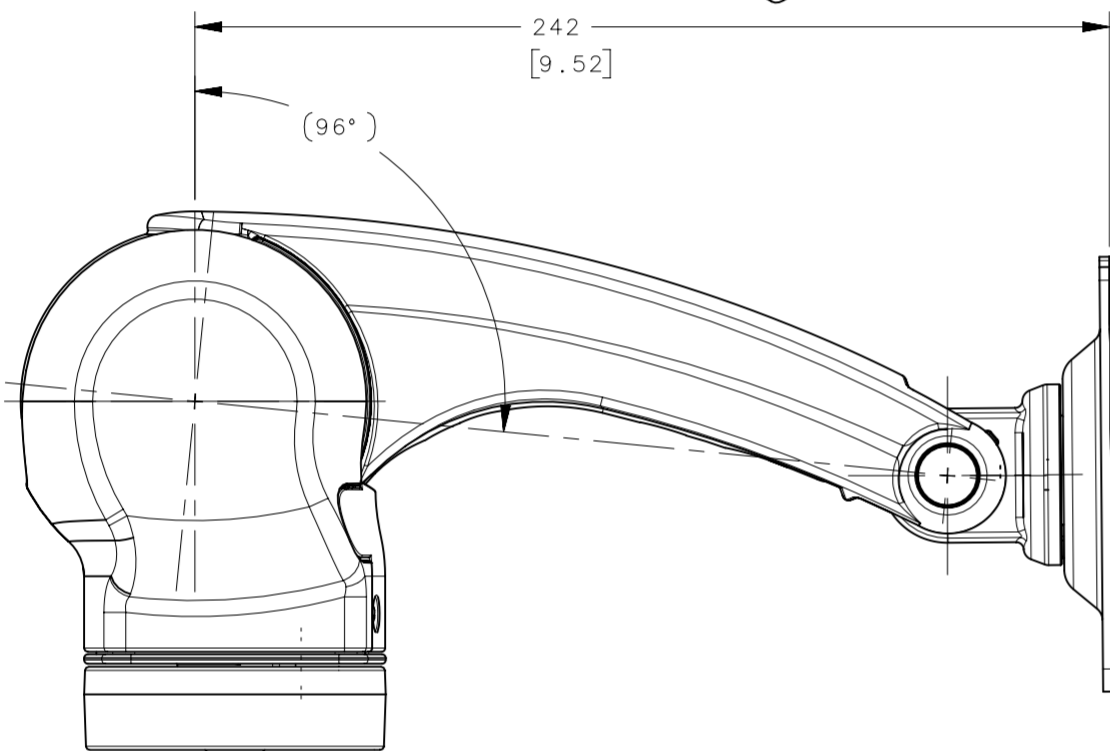
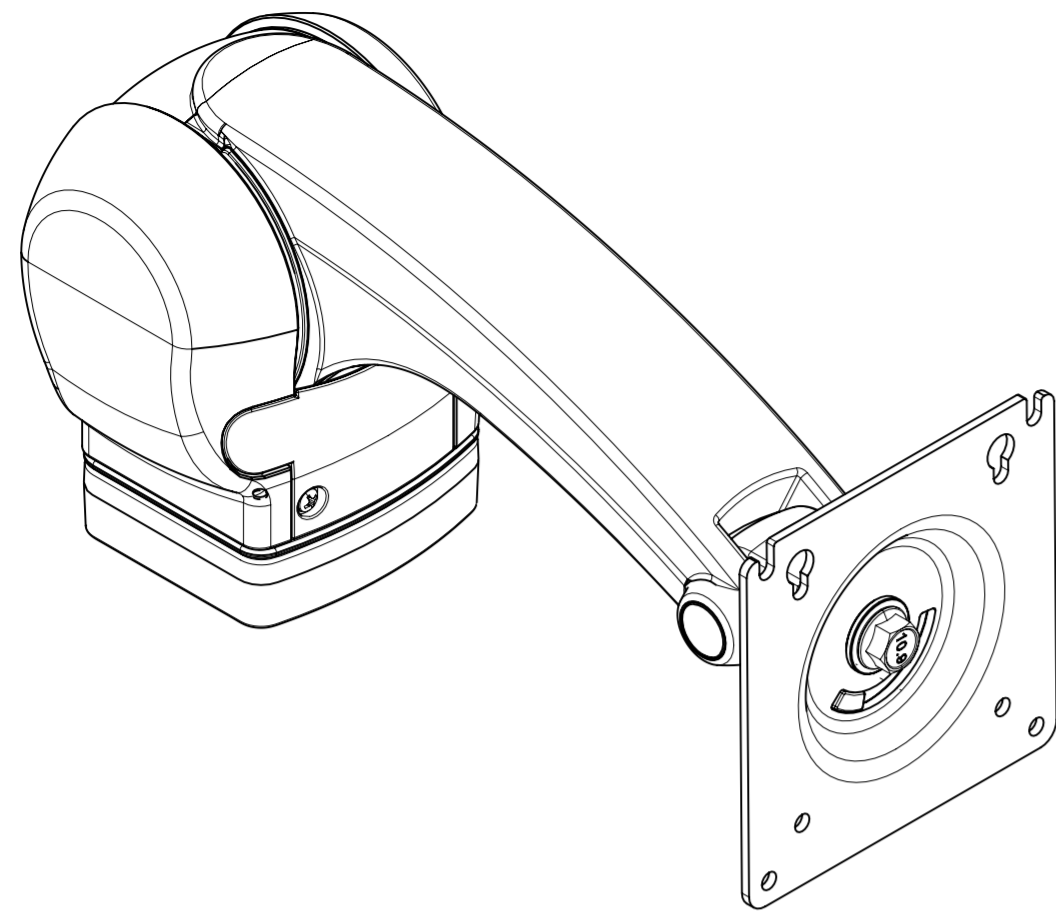

LOWEST ARM POSITION
机械臂最低位

NOTES:

1. MATERIALS AND FINISHES:
 ARM, TILT HOUSING, RIGHT ARM ADAPTER, LEFT ARM ADAPTER
 ARM MOUNT BASE: DIE CAST ALUMINUM, POWDER COATED
 LOWER ARM SLEEVE: NYLON
 SLEEVE BEARINGS, ARM BASE THRUST WASHER: ACETAL
 COILED PIN FOR TORQUE ELEMENTS: STEEL, PHOSPHATE COATED
 DISPLAY TILT SHAFT, ARM PIVOT SHAFT,
 TORQUE ELEMENTS: ALLOY STEEL, NATURAL FINISH
 TORSION SPRING(S) AND SPRING WASHER: CARBON STEEL, BLACK OXIDE
 TORSION SPRING ADAPTER: ZINC, NATURAL
 STOP PIN, TORSION SPRING ADAPTER: STEEL, NATURAL
 SPRING, TORSION SPRING ADAPTER STOP PIN: HIGH CARBON STEEL
 DISPLAY SCREW: STEEL, ZINC PLATED
 SLEEVE DISPLAY: ALLOY STEEL, NICKLE PLATED
 ARM PIVOT STOP PINS AND ARM MOUNT THRUST WASHER: STAINLESS
 STEEL, PASSIVATED
 DISPLAY PLATE, ARM MOUNT BASE PLATE: STEEL, POWDER COATED
 ARM MOUNT BASE PLATE, ARM MOUNT STUD AND
 M10 LOCK NUT, STEEL, BRIGHT ZINC PLATED
 ARM COVER AND LOWER ARM FRONT COVER: PC/ABS
 ARM MOUNT LOWER THRUST WASHER: DELRIN, NATURAL
 COMPRESSION SPRING: HIGH CARBON STEEL, NATURAL
 LUBRICANT: HYDROCARBON BASE AND SILICONE BASE
 THREAD LOCKING ADHESIVE: METHACRYLATE ESTER

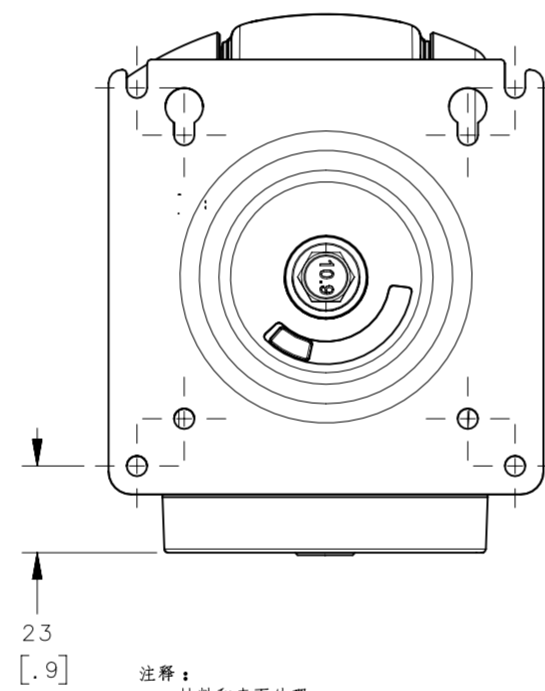

- 注释:
 1. 材料和表面处理:
 臂, 斜壳体, 右臂适配器, 左臂适配器
 臂底座: 压铸铝, 粉末涂层
 下臂套: 尼龙
 轴承轴套, 臂底座垫圈: 乙缩醛
 扭矩元件线圈销: 钢, 磷酸盐涂层
 显示的倾轴, 臂中心轴,
 扭矩元件: 合金钢, 本色
 扭簧和弹垫: 碳钢, 黑色氧化
 扭簧适配器: 合金钢, 本色
 限位销, 扭簧适配器: 钢, 本色
 弹簧, 扭簧适配器止动销: 碳钢
 显示屏螺丝: 钢, 镀锌
 显示屏轴套: 合金钢, 镀铬
 臂中心止动销和止动垫圈: 不锈钢, 钝化
 显示屏安装板, 臂底座: 钢, 粉末喷涂
 臂底座, 臂底座螺栓, M10 锁紧螺母: 钢, 镀锌
 臂盖和下臂前盖: PC/ABS
 臂架阻推垫圈: 聚甲基丙烯酸酯, 本色
 压缩弹簧: 碳钢, 本色
 润滑剂: 烃基和硅基
 螺纹锁定粘合剂: 甲基丙烯酸酯

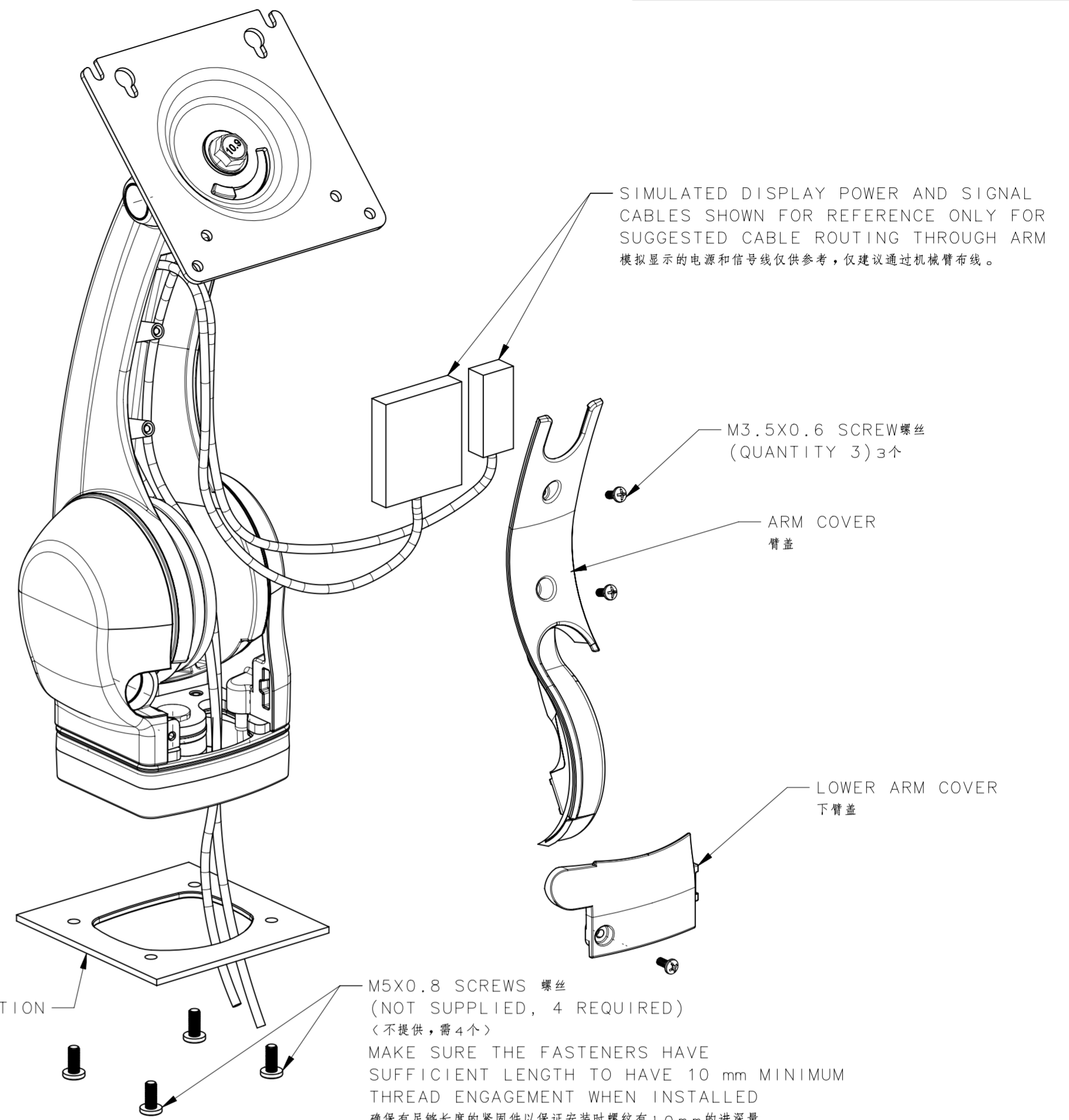

SIMULATED DISPLAY POWER AND SIGNAL CABLES SHOWN FOR REFERENCE ONLY FOR SUGGESTED CABLE ROUTING THROUGH ARM
 模拟显示的电源和信号线仅供参考, 仅建议通过机械臂布线。

M3.5X0.6 SCREW 螺丝
(QUANTITY 3) 3个

ARM COVER
臂盖

LOWER ARM COVER
下臂盖

PANEL PREPARATION
预备安装板

M5X0.8 SCREWS 螺丝
(NOT SUPPLIED, 4 REQUIRED)
(不提供, 需4个)

MAKE SURE THE FASTENERS HAVE SUFFICIENT LENGTH TO HAVE 10 mm MINIMUM THREAD ENGAGEMENT WHEN INSTALLED
 确保有足够长度的紧固件以保证安装时螺纹有10mm的进深量。

FINAL ARM ASSEMBLY:

1. MOUNT ARM TO APPLICATION USING PANEL PREPARATION FOR CABLE MOVEMENT AND SECURE USING 4 EACH M5X0.8 SCREWS (NOT SUPPLIED WITH ARM) WITH 10 mm MINIMUM THREAD ENGAGEMENT.
2. ROUTE DISPLAY CABLES APPROXIMATELY AS SHOWN LEAVING EXTRA CABLE AT THE DISPLAY SIDE TO ALLOW FOR TILTING THE DISPLAY TILT RANGE OF MOTION.
3. INSTALL ARM COVER USING 2 EACH M3.5 SCREWS SUPPLIED WITH ARM. DO NOT OVER TIGHTEN SCREWS.
4. INSTALL LOWER ARM FRONT COVER BY ENGAGING TAB INTO RECESS OF LEFT ADAPTER, THEN PIVOT INTO PLACE AND SECURE USING A M3.5 SCREW SUPPLIED WITH ARM. DO NOT OVER TIGHTEN SCREW.

- 成品机械臂:
 1. 将机线绳穿过安装板并将机械臂安装在应用设备上, 然后使用4个M5*0.8的螺丝(不随臂提供)进行固定, 螺纹进深最少10mm。
 2. 布置显示屏线缆大致如图所示, 并在显示屏侧留出一定长度的线缆, 以便当显示屏在倾斜运动时保持顺畅。
 3. 安装臂盖时使用随臂提供的2个M3.5的螺丝固定, 紧固时无需过度用力。
 4. 通过将卡扣卡入左适配器的卡槽中未安装下臂前盖, 然后转到位, 之后使用随臂提供的M3.5的螺丝固定, 紧固时无需过度用力。

THIRD ANGLE PROJECTION		 CONNECT · CREATE · INNOVATE	
MILLIMETERS [IN]			
SURFACE AREA XXXXXmm ²		DESCRIPTION HINGE & CONTROLLED MOTION DEVICE STANDARD DESKTOP ARM ASSEMBLY	
VOLUME XXXXXmm ³		SIZE SYSTEM A2 NX DWG NO. J-AV-D32-20C233	
PROPRIETARY ITEM		PER ASME Y14.5M-1994	
EXCEPT FOR USES EXPRESSLY GRANTED IN WRITING, INFORMATION DISCLOSED HEREON IS CONFIDENTIAL AND ALL RIGHTS, PATENT AND OTHERWISE, ARE RESERVED BY SOUTHCO, INC.		DRAWN BY GEA DATE 03JAN2018 SCALE 1:1 SHEET 2 OF 3	

8

7

6

5

4

3

2

1

REVISION HISTORY			
REV	DATE	BY	DESCRIPTION
D	29JUL2020	CWA/JZ	PRN: P2020-1445

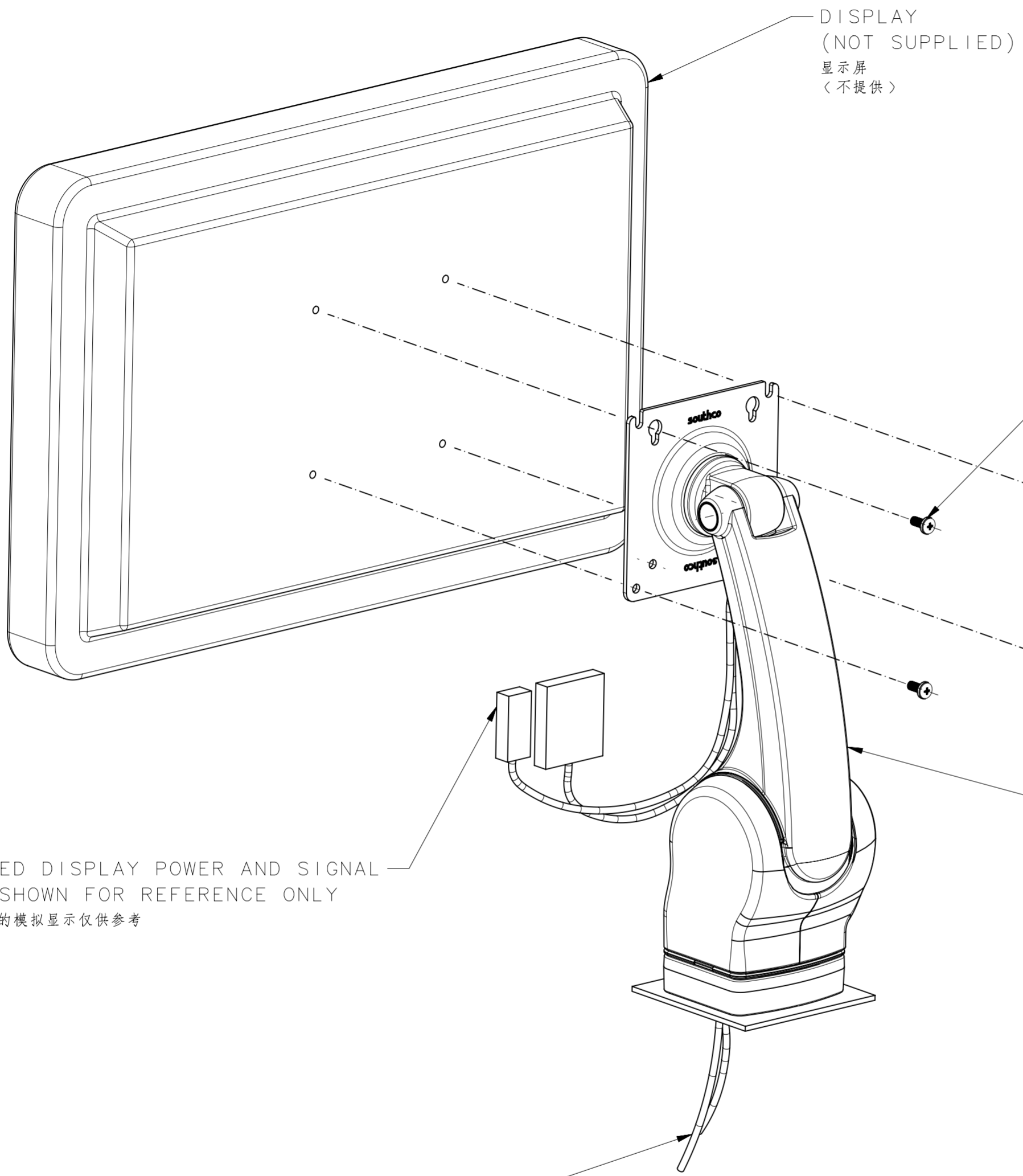

DISPLAY
(NOT SUPPLIED)
显示屏
(不提供)

DISPLAY MOUNTING SCREWS
(NOT SUPPLIED)
SECURE TO DISPLAY PER DISPLAY MANUFACTURES
INSTALLATION INSTRUCTIONS AND TORQUE SPECIFICATIONS.
显示屏安装螺丝
(不提供)
固定方式参考显示屏供应商
安装指导和扭矩规范

ARM ASSEMBLY MUST BE IN THE HIGHEST
POSITION TO INSTALL THE DISPLAY
安装显示屏时机械臂需要保持在最高位

SIMULATED DISPLAY POWER AND SIGNAL
CABLES SHOWN FOR REFERENCE ONLY
功率和信号线的模拟显示仅供参考

MAKE SURE CABLES ARE SUFFICIENTLY
SUPPORTED AND RESTRAINED IN APPLICATION.
在整体设备应用中确保线缆有可靠的支撑与固定

	THIRD ANGLE PROJECTION		southco CONNECT · CREATE · INNOVATE
	MILLIMETERS [IN]		
SURFACE AREA	XXXXXmm ²		DESCRIPTION HINGE & CONTROLLED MOTION DEVICE STANDARD DESKTOP ARM ASSEMBLY
VOLUME	XXXXXmm ³		
PROPRIETARY ITEM			SIZE SYSTEM A2 NX
EXCEPT FOR USES EXPRESSLY GRANTED IN WRITING, INFORMATION DISCLOSED HEREON IS CONFIDENTIAL AND ALL RIGHTS, PATENT AND OTHERWISE, ARE RESERVED BY SOUTHCO, INC.			DWG NO. J-AV-D32-20C233
PER ASME Y14.5M-1994			DRAWN BY GEA
			DATE 03JAN2018
			SCALE 1:1
			SHEET 3 OF 3

8

7

6

5

4

3

2

1