

WARNING:
TO REDUCE THE RISK OF INJURY MOVE ARM INTO HIGHEST POSITION BEFORE REMOVING DEVICE ATTACHED TO ARM. ARM TO REMAIN IN HIGHEST POSITION UNTIL DEVICE IS FULLY MOUNTED INTO THE ARM.

REVISION HISTORY			
REV	DATE	BY	DESCRIPTION
C	10JAN2020	GEA/DMS	PRN: P2019-1890

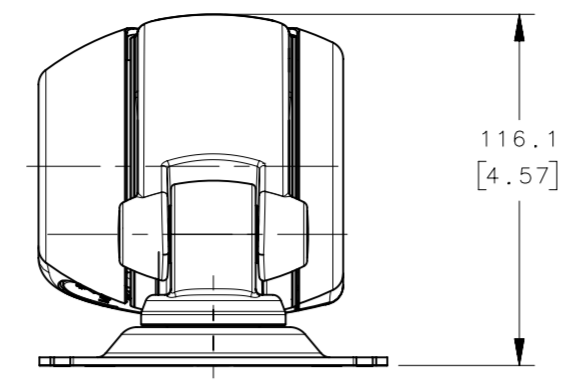

INSIDE HOLE OF PANEL PREPARATION MUST BE FREE OF SHARP CORNERS, EDGES, SAW CUT MARKS, BURRS OR OTHER EDGE CONDITIONS THAT MAY DAMAGE POWER OR SIGNAL CABLES ROUTED THROUGH THE ARM BASE MOUNTING PLATE INTO THE ARM

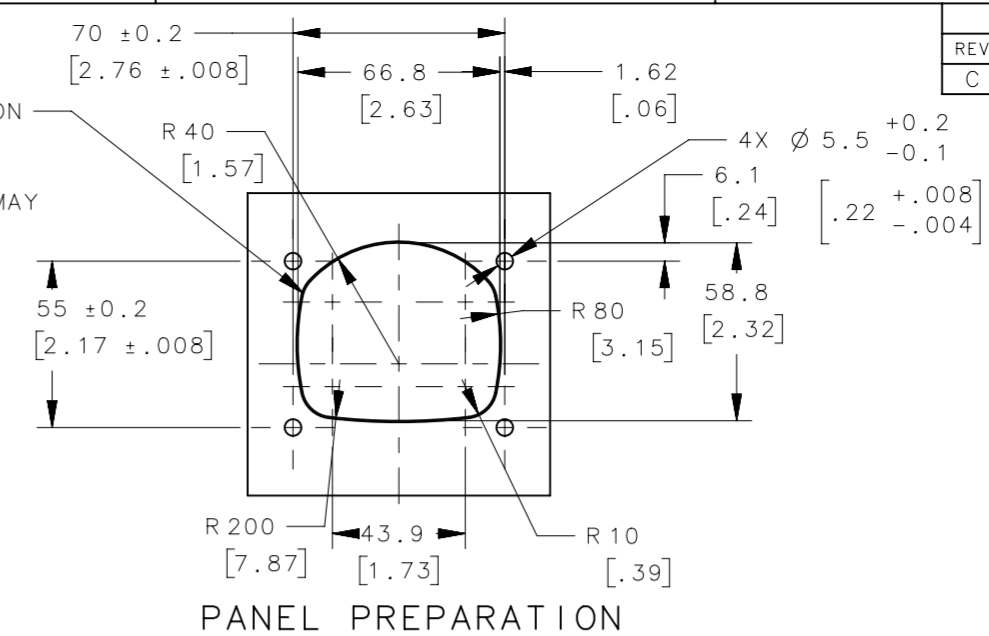

PANEL PREPARATION

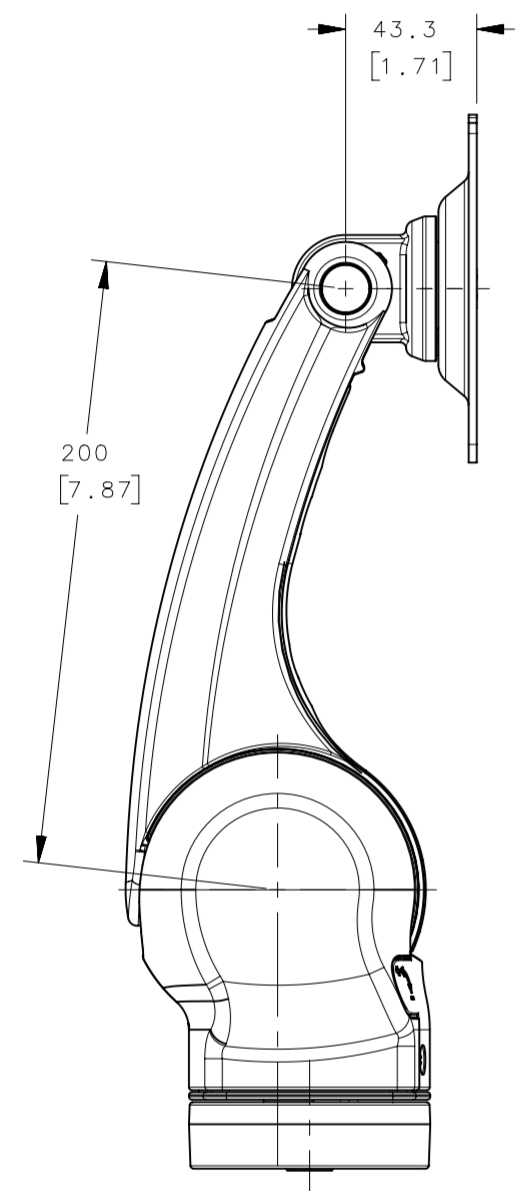
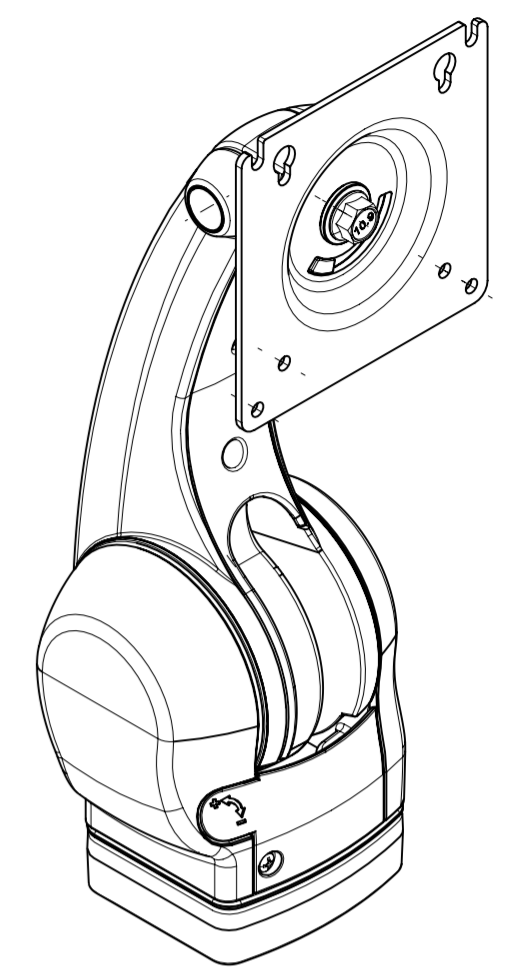

DISPLAY PLATE (PORTRAIT TO LANDSCAPE) 95° CLOCKWISE 5° COUNTERCLOCKWISE FROM POSITION SHOWN

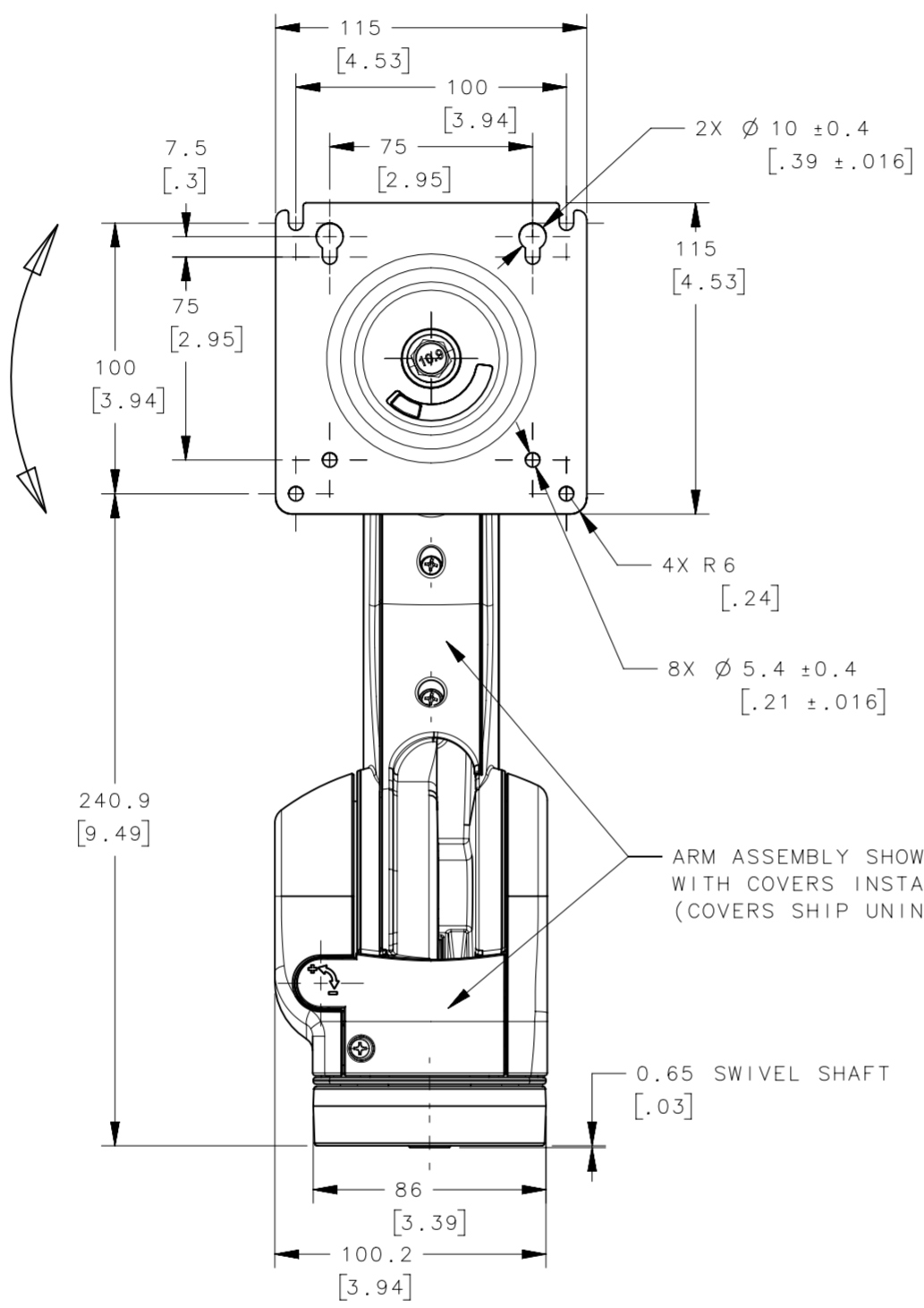

ARM ASSEMBLY SHOWN WITH COVERS INSTALLED (COVERS SHIP UNINSTALLED)

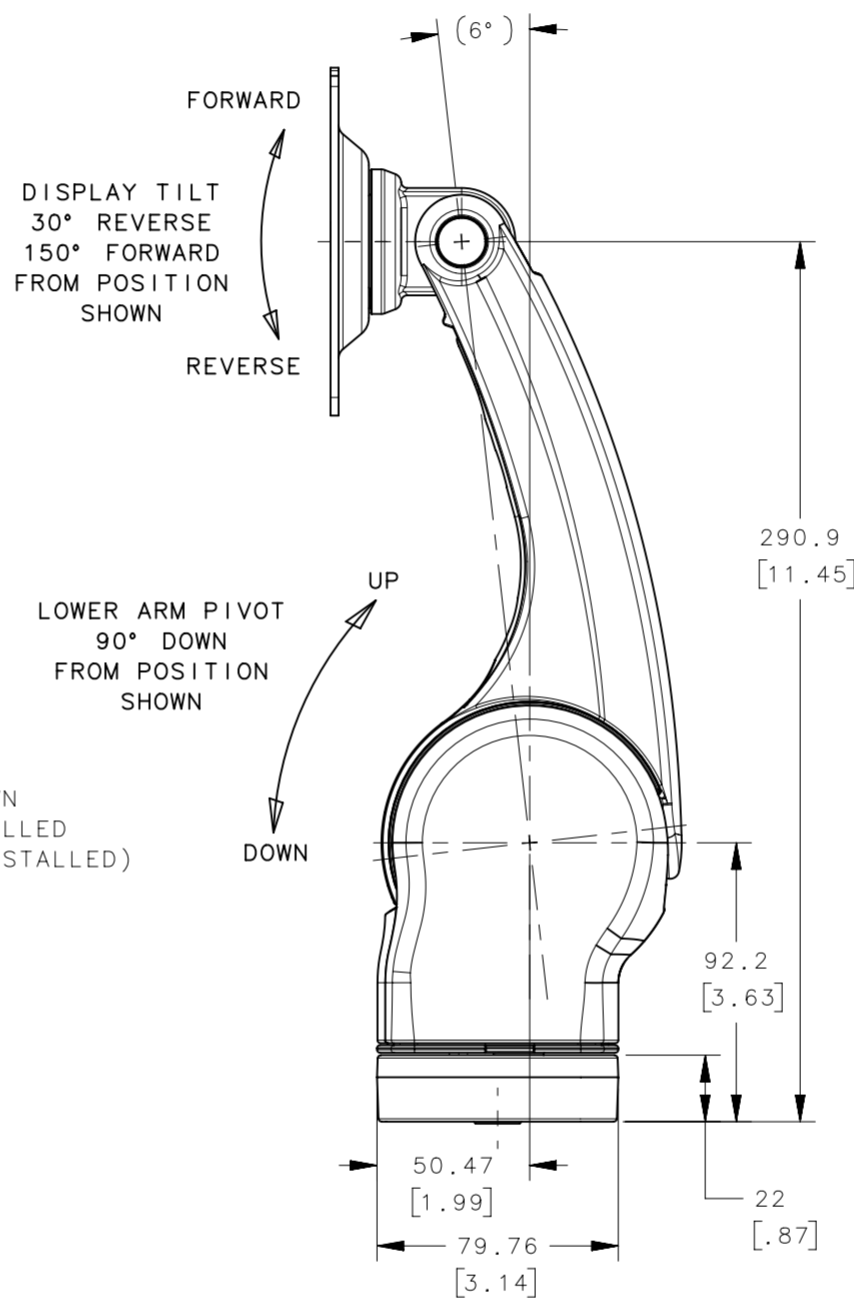

DISPLAY TILT 30° REVERSE 150° FORWARD FROM POSITION SHOWN

LOWER ARM PIVOT 90° DOWN FROM POSITION SHOWN

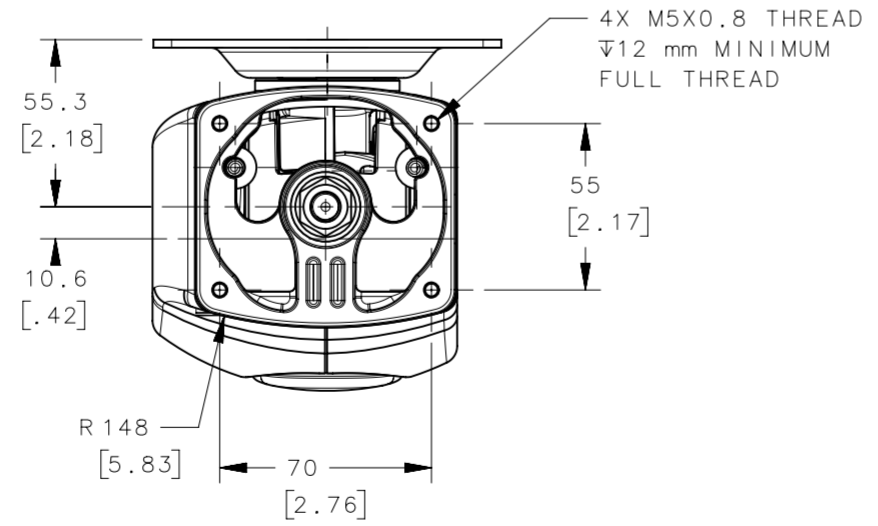

- NOTES:
- COSMETIC SPECIFICATION PER SOUTHCO S-121 FOR POWDER COATING AND MOLDED PLASTIC PARTS. ALL EXTERIOR POWDER COATED SURFACES ARE CLASS C AND ALL EXTERIOR PLASTIC PART SURFACES CLASS C. ALL POWDER COATED INTERIOR SURFACES ARE CLASS D AND OVERSPRAY IS PERMITTED, WHEREAS ALL INTERIOR PLASTIC PART SURFACES ARE CLASS D.
 - DISPLAY MOUNTING PLATE TO ARM ANGULAR FREE PLAY TO BE 1° MAXIMUM.
 - THE ARM LIFT FORCE VARIES WITH THE ARM POSITION IN THE UP AND DOWN DIRECTION. ARM LIFT COUNTERBALANCE IS ADJUSTABLE WITH ACCESS TO THE ADJUSTMENT SCREW (M8 HEX KEY) BEHIND FRONT COVER WITH THE ARM IN THE HIGHEST POSITION. THE ARM SHIPS WITH THE COUNTERBALANCE ADJUSTMENT TO SUPPORT THE LIGHTEST DISPLAY WEIGHT.
 - THE ARM SWIVEL TORQUE IS USER ADJUSTABLE USING A 17 mm HEX SOCKET WRENCH TO ADJUST AS REQUIRED.

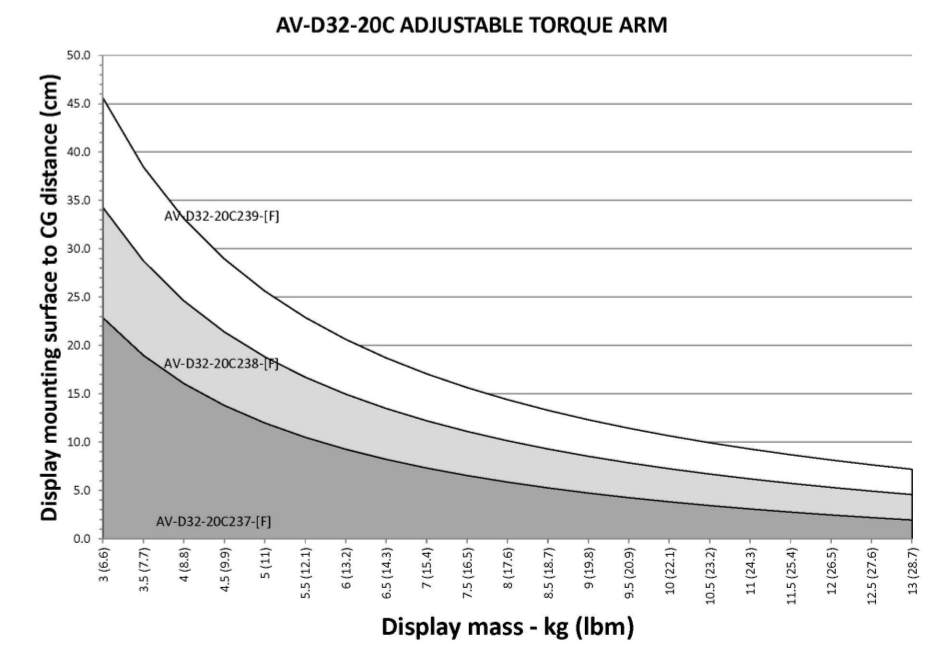

PART NUMBER	REVERSE DISPLAY TILT TORQUE N*m (lbf*in)	FORWARD DISPLAY TILT TORQUE N*m (lbf*in)	LOWER ARM PIVOT TORQUE IN DOWN DIRECTION WITHIN 5° OF LOWEST ARM POSITION N*m (lbf*in)	LOWER ARM PIVOT TORQUE IN DOWN DIRECTION WITHIN 5° FROM HIGHEST ARM POSITION N*m (lbf*in)	SYMMETRIC TORQUE TO SWIVEL ARM ASSEMBLY N*m (lbf*in) [NOTE 4]	DISPLAY WEIGHT RANGE Kg (lbm)	COLOR
AV-D32-20C237-50	8.0±1.6 (70.8±14.2)	6.43±1.3 (56.9±11.4)	10.5 (92.9) MINIMUM 26.4 (233.7) MAXIMUM	6.64 (58.8) MINIMUM 20.4 (180.6) MAXIMUM	2.8 (24.8) NOMINAL 1.3 (11.5) MINIMUM	6.8 (15) MAXIMUM	BLACK
AV-D32-20C237-76							OFFICE WHITE
AV-D32-20C238-50	11.35±2.3 (100.5±20)	8.5±1.7 (75.1±15)	12 (106) MINIMUM 48.2 (426.6) MAXIMUM	9.5 (84.1) MINIMUM 36 (318.3) MAXIMUM			BLACK
AV-D32-20C238-76						OFFICE WHITE	
AV-D32-20C239-50	14.7±2.9 (130±26)	10.5±2.1 (93.6±18.6)				13 (28.7) MAXIMUM	BLACK
AV-D32-20C239-76							OFFICE WHITE

THIRD ANGLE PROJECTION	
MILLIMETERS [IN]	
SURFACE AREA XXXXXmm ²	HINGE & CONTROLLED MOTION DEVICE TABLE MOUNT ARM ASSEMBLY, ADJUSTABLE
VOLUME XXXXXmm ³	
PROPRIETARY ITEM	ALL DIMENSIONS WITHOUT TOLERANCE ARE FOR REFERENCE ONLY SIZE SYSTEM A2 NX DWG NO. J-AV-D32-20C237
PER ASME Y14.5M-1994	DRAWN BY GEA DATE 04AUG2017 SCALE 1:1 SHEET 1 OF 3

8

7

6

5

4

3

2

1

REVISION HISTORY			
REV	DATE	BY	DESCRIPTION
C	10JAN2020	GEA/DMS	PRN: P2019-1890

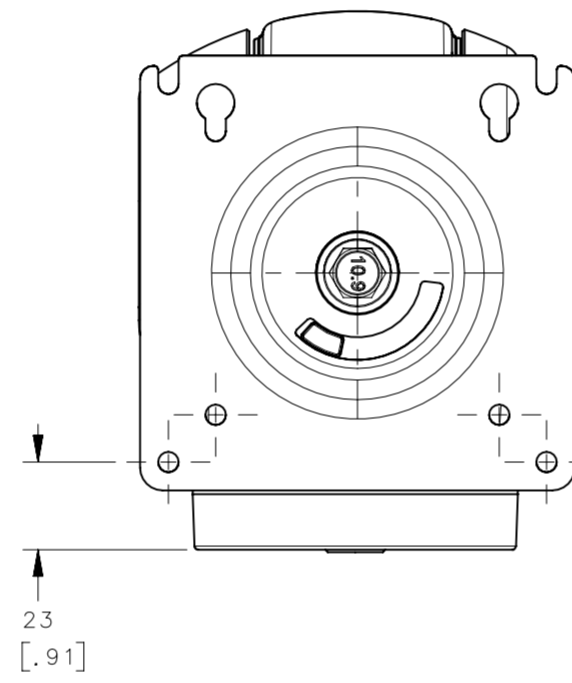
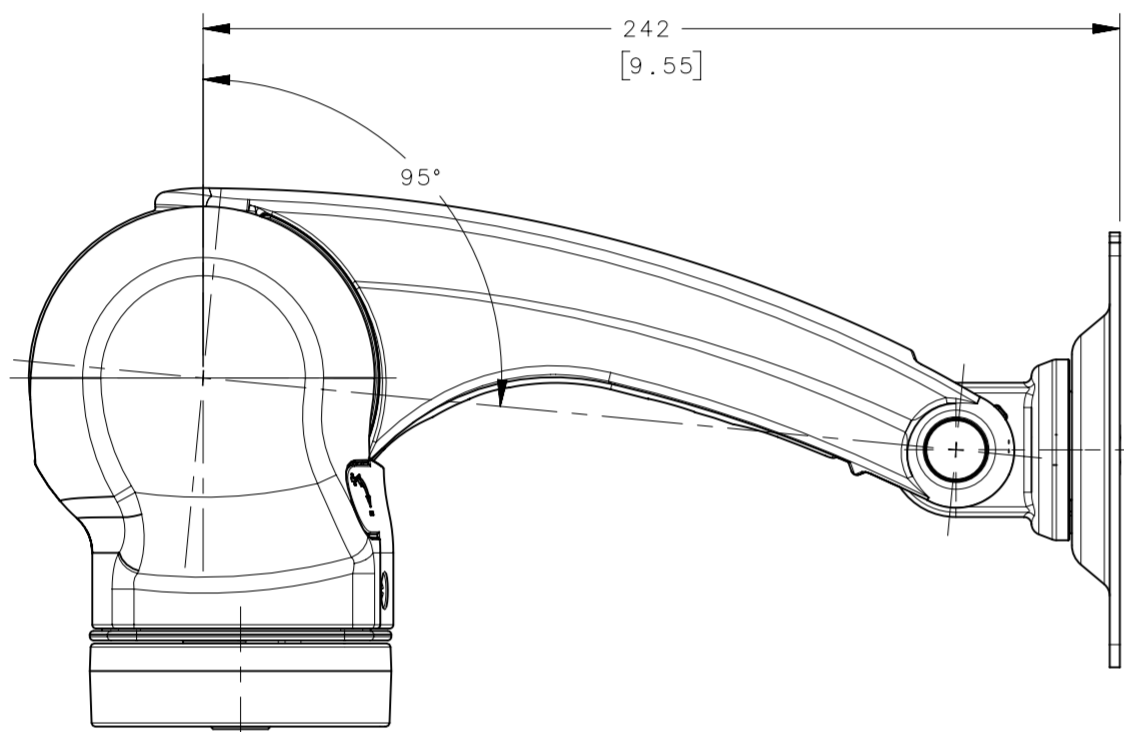
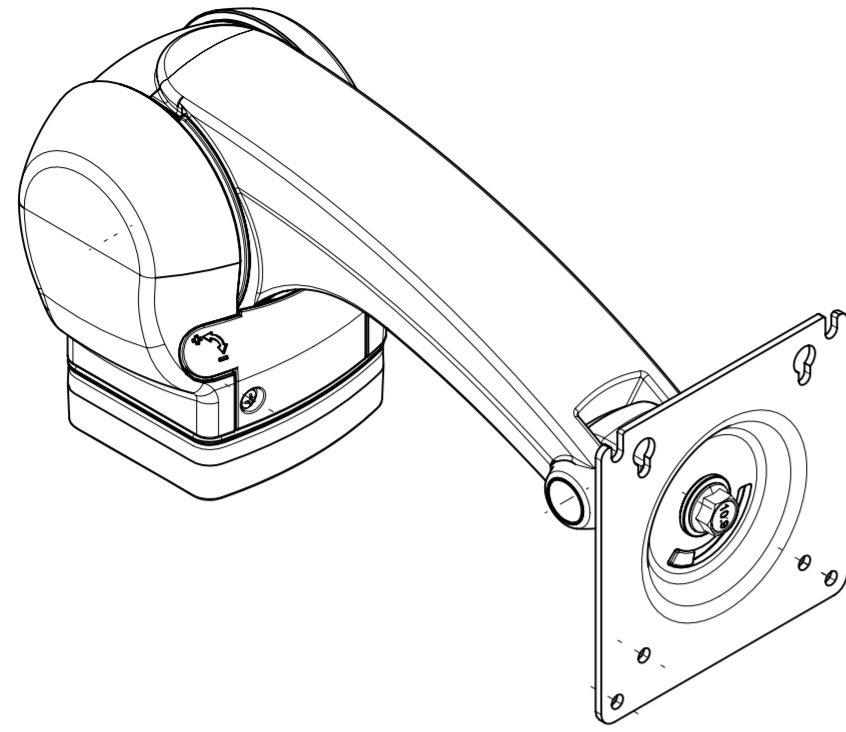

ARM COUNTERBALANCE
ADJUSTMENT USING 8 mm HEX KEY
INSIDE LOWER ARM FRONT COVER

TURN COUNTERCLOCKWISE FOR
HEAVIER DISPLAYS

TURN CLOCKWISE FOR LIGHTER
DISPLAYS

APPLICATION PANEL
PREPARATION

M5X0.8 SCREWS
(NOT SUPPLIED)
10 mm MINIMUM THREAD
ENGAGEMENT INTO MOUNTING
BASE REQUIRED

SIMULATED DISPLAY POWER AND SIGNAL
CABLES SHOWN FOR REFERENCE ONLY FOR
SUGGESTED CABLE ROUTING THROUGH ARM

ARM COVER

M3.5X0.6
PAN HEAD SCREW

LOWER ARM FRONT COVER
(REMOVE TO ACCESS ARM
COUNTERBALANCE ADJUSTMENT
SCREW)

M3.5X0.6
PAN HEAD SCREW

NOTES:

1. MATERIALS AND FINISHES:

- ARM, TILT HOUSING, RIGHT ARM ADAPTER, LEFT ARM ADAPTER
- ARM MOUNT BASE: DIE CAST ALUMINUM, POWDER COATED
- LOWER ARM SLEEVE: NYLON
- SLEEVE BEARINGS, ARM BASE THRUST WASHER: ACETAL
- COILED PIN: STEEL, PHOSPHATE COATED
- DISPLAY TILT SHAFT, ARM PIVOT SHAFT,
- TORQUE ELEMENTS: ALLOY STEEL, NATURAL FINISH
- TORSION SPRING AND SPRING WASHER: CARBON STEEL, BLACK OXIDE
- TORSION SPRING ADAPTER: ZINC,NATURAL
- WORM GEAR, WORM WHEEL GEAR: STEEL, BLACK OXIDE COATED
- INTERNAL RETAINING RING, THRUST WASHER: STAINLES STEEL
- DISPLAY SCREW: STEEL, ZINC PLATED
- SLEEVE DISPLAY: ALLOY STEEL, NICKLE PLATED
- ARM PIVOT STOP PINS AND ARM MOUNT WASHER: STAINLESS STEEL, PASSIVATED
- DISPLAY PLATE, ARM MOUNT BASE PLATE: STEEL, POWDER COATED
- ARM MOUNT STUD AND M10 LOCK NUT, STEEL, BRIGHT ZINC PLATED
- ARM COVER AND LOWER ARM FRONT COVER: PC/ABS
- ARM MOUNT LOWER THRUST WASHER: DELRIN, NATURAL
- LUBRICANT: HYDROCARBON BASE AND SILICONE BASE
- THREAD LOCKING ADHESIVE: METHACRYLATE ESTER

THIRD ANGLE PROJECTION		 CONNECT · CREATE · INNOVATE	
MILLIMETERS [IN]			
SURFACE AREA XXXXXmm ²		DESCRIPTION	
VOLUME XXXXXmm ³		HINGE & CONTROLLED MOTION DEVICE TABLE MOUNT ARM ASSEMBLY, ADJUSTABLE	
PROPRIETARY ITEM		SIZE SYSTEM A2 NX DWG NO. J-AV-D32-20C237	
EXCEPT FOR USES EXPRESSLY GRANTED IN WRITING, INFORMATION DISCLOSED HEREIN IS CONFIDENTIAL AND ALL RIGHTS, PATENT AND OTHERWISE, ARE RESERVED BY SOUTHCO, INC.		PER ASME Y14.5M-1994	
DRAWN BY GEA		DATE 04AUG2017	
SCALE 1:1		SHEET 2 OF 3	

8

7

6

5

4

3

2

1

8

7

6

5

4

3

2

1

REVISION HISTORY			
REV	DATE	BY	DESCRIPTION
C	10JAN2020	GEA/DMS	PRN: P2019-1890

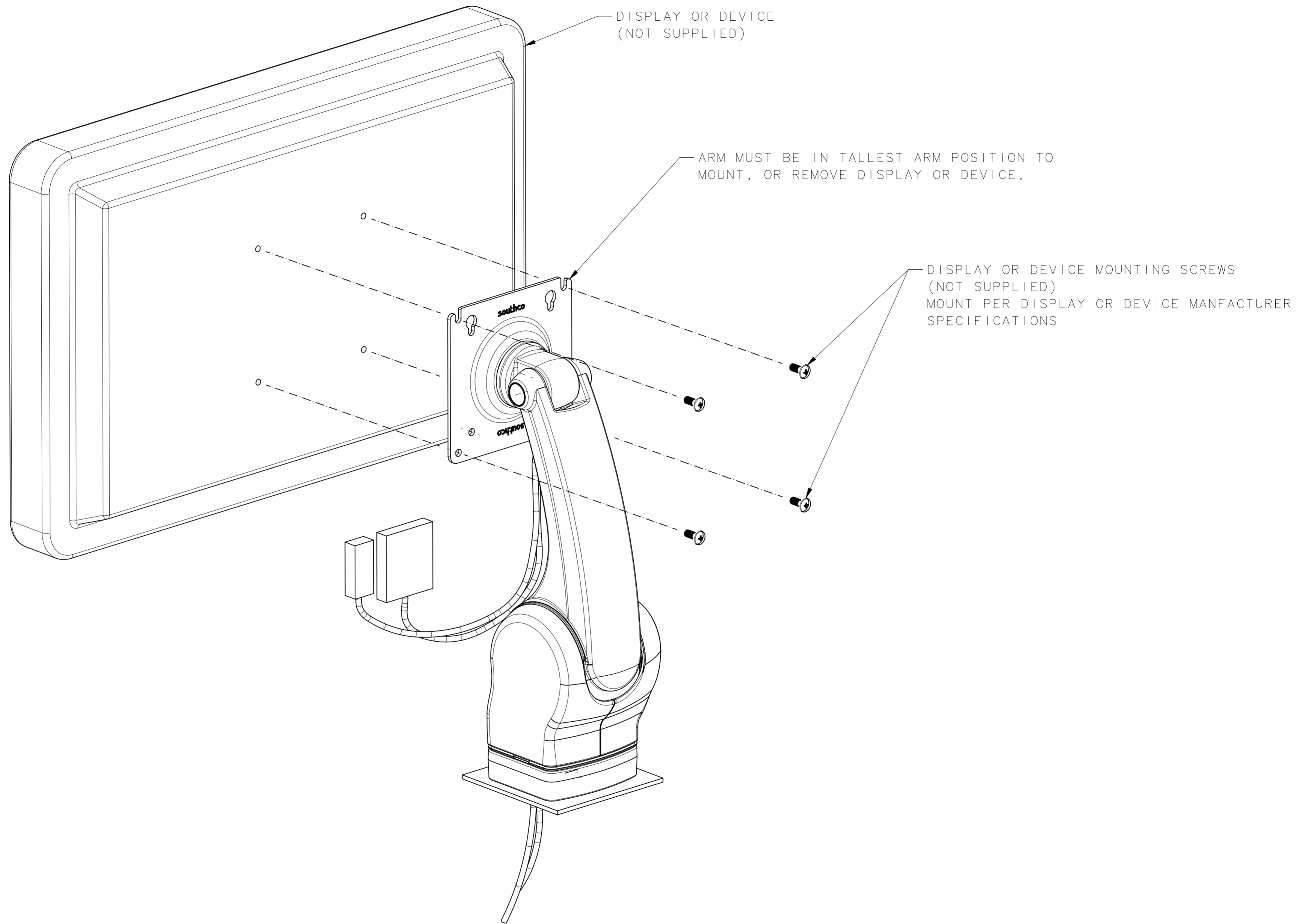

	THIRD ANGLE PROJECTION	southco CONNECT · CREATE · INNOVATE
	MILLIMETERS [IN]	
SURFACE AREA	XXXXXmm ²	DESCRIPTION HINGE & CONTROLLED MOTION DEVICE TABLE MOUNT ARM ASSEMBLY, ADJUSTABLE
VOLUME	XXXXXmm ³	
PROPRIETARY ITEM		SIZE SYSTEM A2 NX
EXCEPT FOR USES EXPRESSLY GRANTED IN WRITING, INFORMATION DISCLOSED HEREON IS CONFIDENTIAL AND ALL RIGHTS, PATENT AND OTHERWISE, ARE RESERVED BY SOUTHCO, INC.		DWG NO. J-AV-D32-20C237
PER ASME Y14.5M-1994		DRAWN BY GEA
		DATE 04AUG2017
		SCALE 1:1
		SHEET 3 OF 3

8

7

6

5

4

3

2

1