

REVISION HISTORY			
REV	DATE	BY	DESCRIPTION
E	08FEB2018	CB1/VK	PRN: P2018-0356

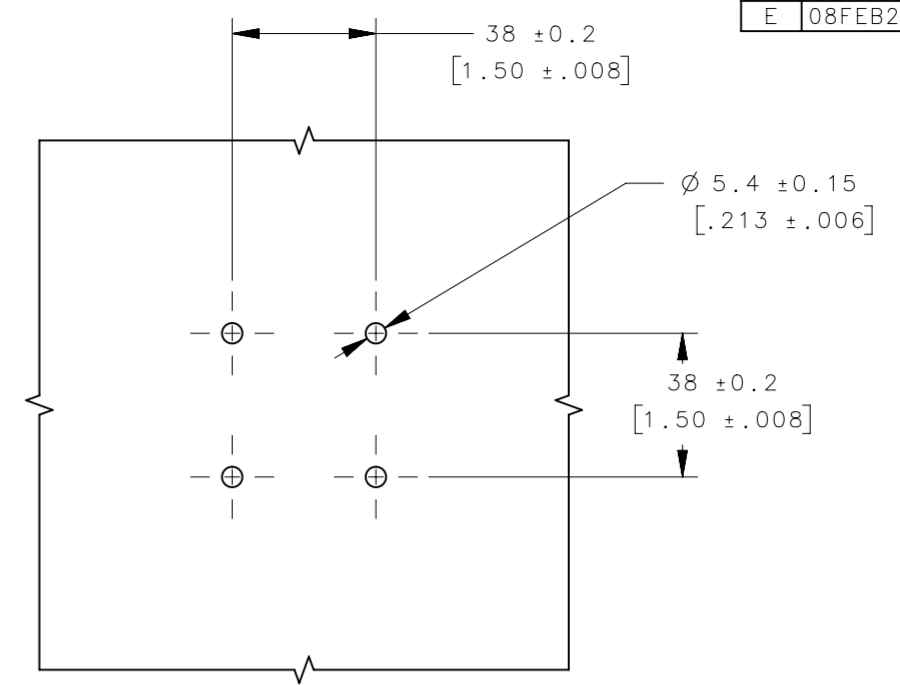

MOUNTING PANEL PREPARATION

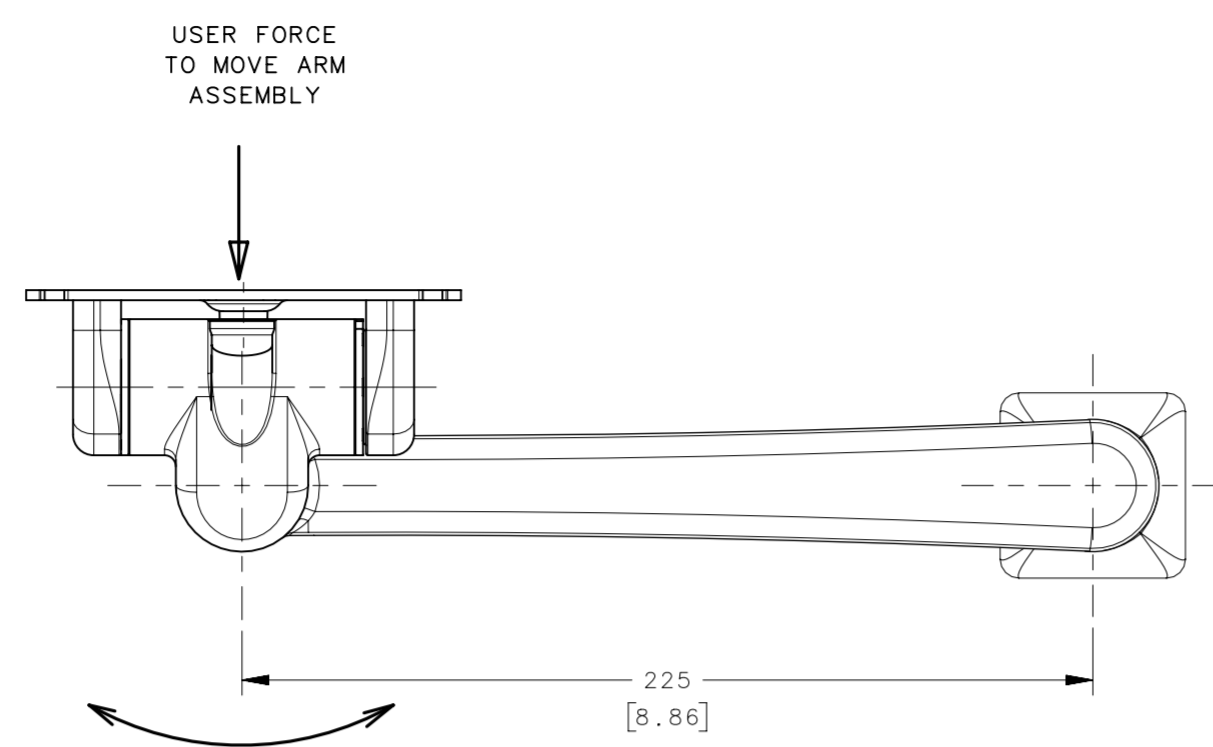
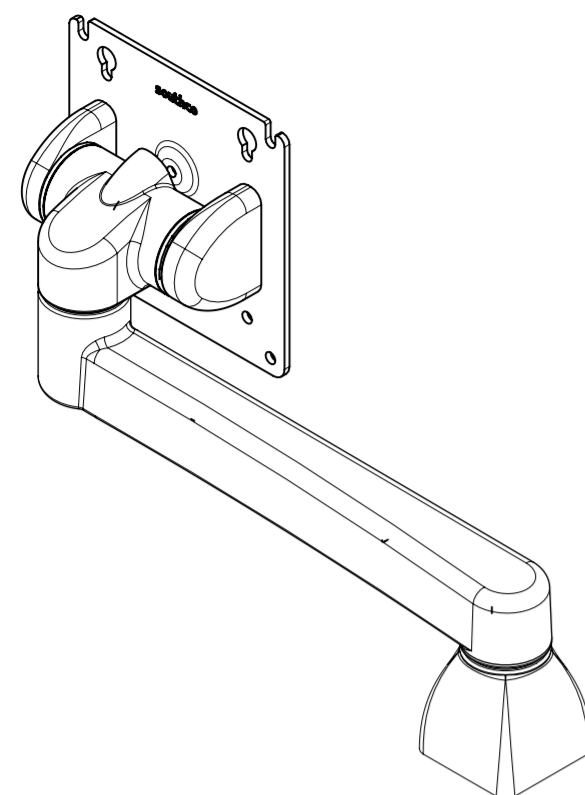
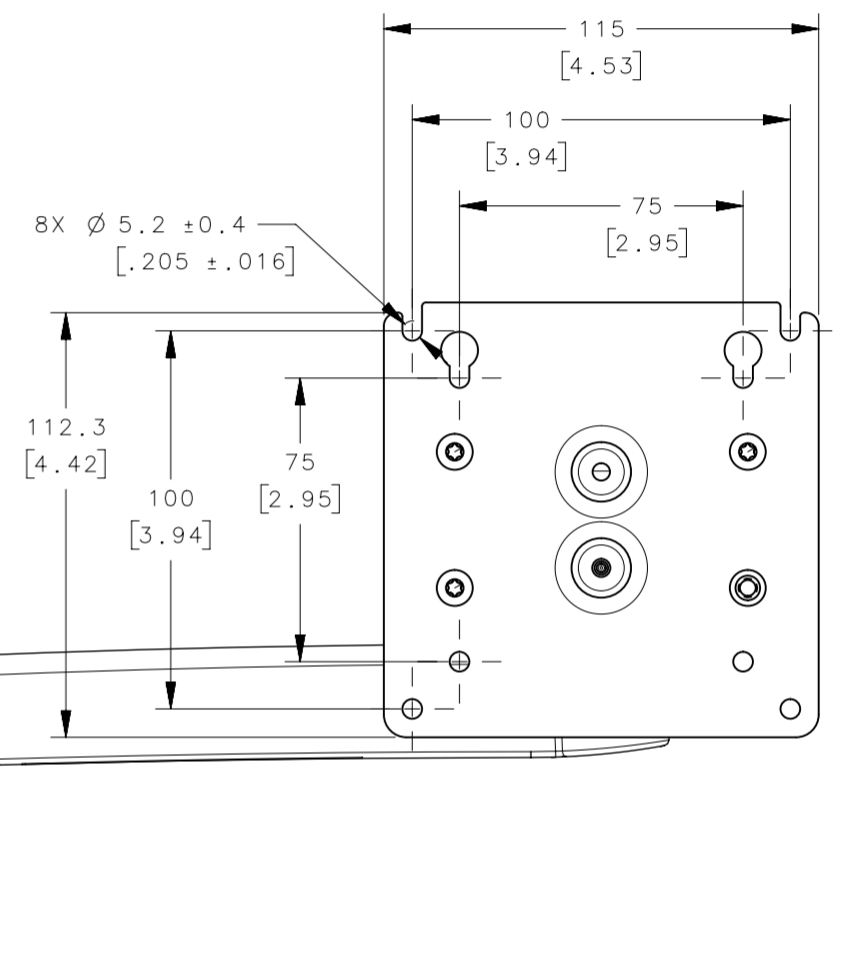
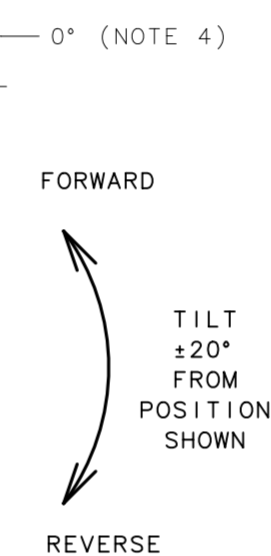
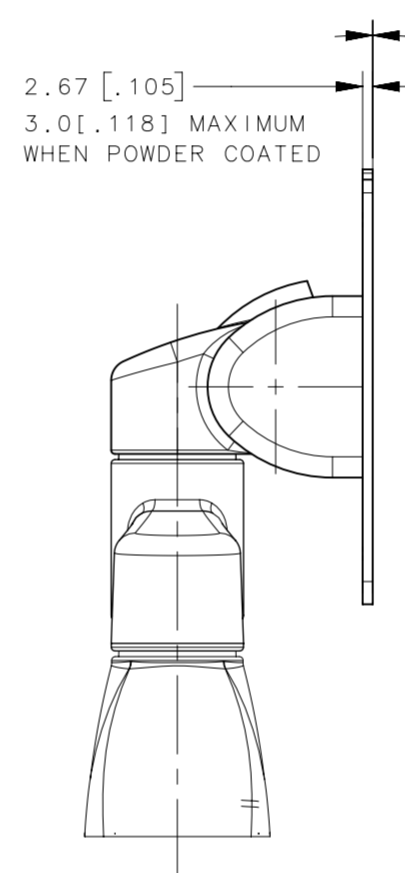
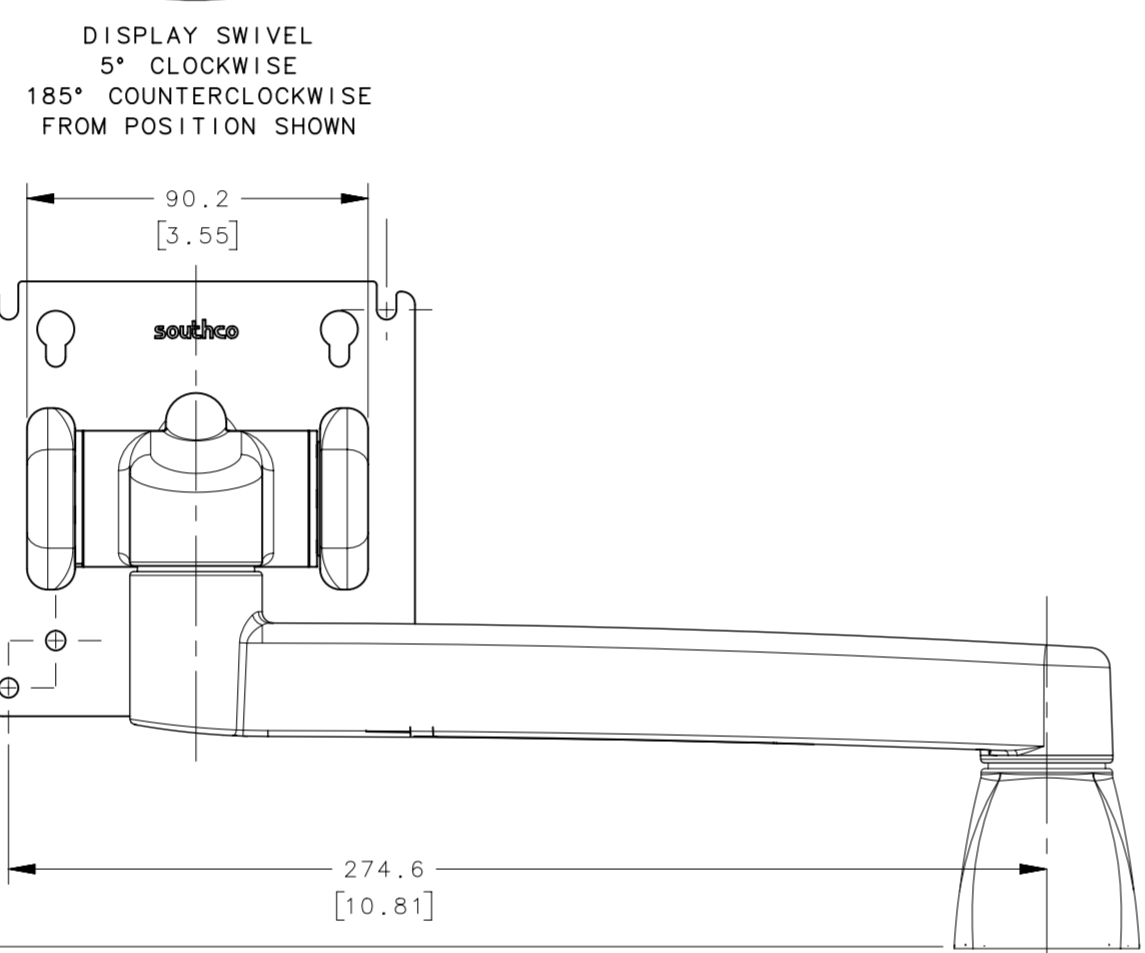
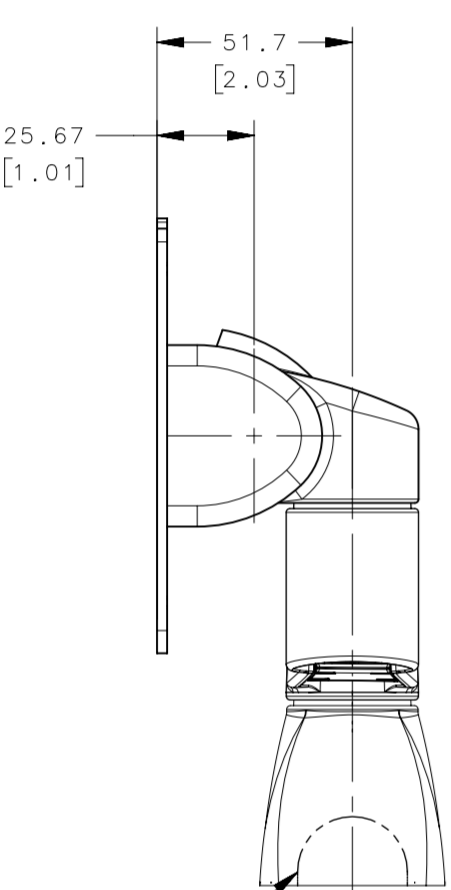

ASSEMBLIES CAN BE ORDERED WITH AN OPTIONAL WIRE NOTCH IN HOUSING FOR EASIER WIRE ROUTING. SEE SHEET 2.

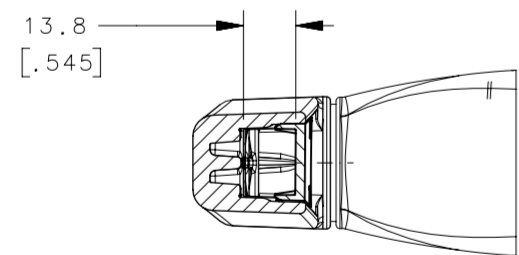

SECTION A-A

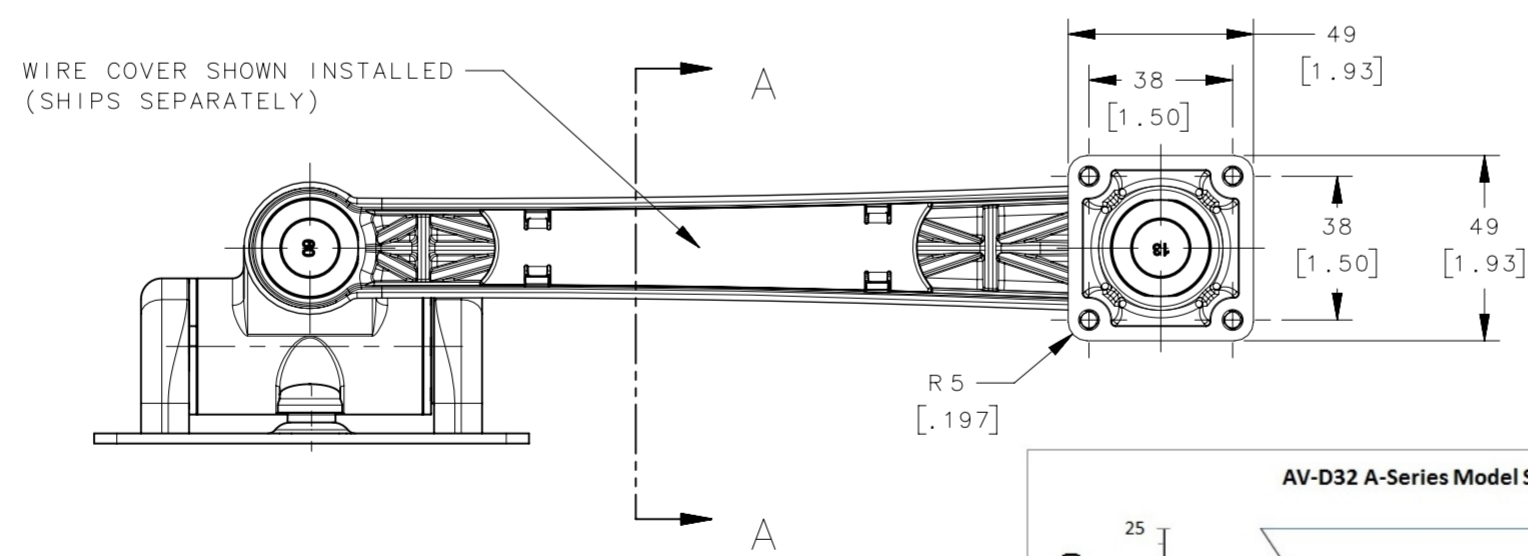

NOTES:

1. FINISH PER SOUTHCO COSMETIC SPECIFICATION S-121 CLASS C EXTERIOR POWDER COATED SURFACES.
2. TILT TORQUE MEASURED WITH VESA DISPLAY PLATE IN THE VERTICAL (0° ± 5°) POSITION WHEN TILTING IN THE REVERSE DIRECTION. THE TILT TORQUE VARIES WITH THE COUNTERBALANCE (WHEN EQUIPPED) IN THE FORWARD AND REVERSE DIRECTIONS.
3. DISPLAY MOUNTING PLATE TO HOUSING ANGULAR FREE PLAY TO BE 1.5° MAXIMUM.
4. MATERIALS AND FINISHES:
ADAPTERS: DIE CAST ALUMINUM ANODIZED AND POWDER COATED
ARM, TILT HOUSING AND SWIVEL HOUSING: DIE CAST ALUMINUM, POWDER COATED
TILT SLEEVE AND THRUST WASHER: ACETAL, BLACK
COILED PIN: STEEL, PHOSPHATE COATED
TILT SHAFT, TORQUE ELEMENTS AND STOP WASHER: STEEL, NATURAL FINISH
TORSION SPRING: CARBON STEEL, NICKEL PLATED
DISPLAY SCREWS: STEEL, BLACK OXIDE
DISPLAY STOPS: POLYETHYLENE, WHITE
SWIVEL SHAFT: STAINLESS STEEL AND NYLON
WIRE COVER: PC/ABS, BLACK
LUBRICANT: HYDROCARBON BASE

PART NUMBER	PART NUMBER WITH WIRE NOTCH IN BASE	REVERSE TILT TORQUE N*m (lbf*in)	FORWARD TILT TORQUE N*m (lbf*in)	DISPLAY SWIVEL SYMMETRIC TORQUE	SYMMETRIC TORQUE TO MOVE ARM ASSEMBLY	COLOR
AV-D32-23A121-50	AV-D32-23A131-50	7.9 (70)	1.13 (10)	4.29 N*m (38 lbf*in)	9.8 N*m (87 lbf*in)	BLACK
AV-D32-23A121-76	AV-D32-23A131-76	7.9 (70)	1.13 (10)	NOMINAL /	NOMINAL /	OFFICE WHITE
AV-D32-23A122-50	AV-D32-23A132-50	15.4 (136)	2.26 (20)	2.17 N*m (24 lbf*in)	5.08 N*m (45 lbf*in)	BLACK
AV-D32-23A122-76	AV-D32-23A132-76	15.4 (136)	2.26 (20)	MINIMUM	MINIMUM	OFFICE WHITE
AV-D32-23A123-50	AV-D32-23A133-50	8.6 (76)	6.0 (53)			BLACK
AV-D32-23A123-76	AV-D32-23A133-76	8.6 (76)	6.0 (53)			OFFICE WHITE

ASSEMBLIES CAN BE ORDERED WITH AN OPTIONAL WIRE NOTCH IN HOUSING FOR EASIER WIRE ROUTING. SEE SHEET 2.

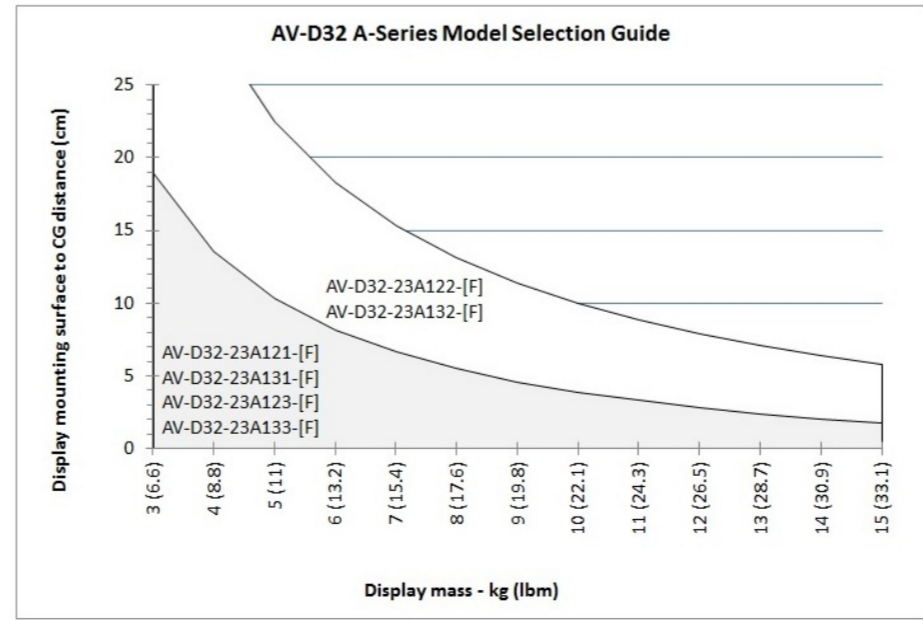

THIRD ANGLE PROJECTION		southco CONNECT · CREATE · INNOVATE	
MILLIMETERS [IN]			
TOLERANCES UNLESS OTHERWISE NOTED		DESCRIPTION	
SURFACE AREA		DISPLAY MOUNT	
VOLUME		TILT & SWIVEL, SINGLE ARM	
PROPRIETARY ITEM		SIZE SYSTEM	DWG NO.
EXCEPT FOR USES EXPRESSLY GRANTED IN WRITING, INFORMATION DISCLOSED HEREON IS CONFIDENTIAL AND ALL RIGHTS, PATENT AND OTHERWISE, ARE RESERVED BY SOUTHCO, INC.		A2 NX	J-AV-D32-23A121
PER ASME Y14.5M-1994		DRAWN BY	DATE
		GEA	22AUG2014
		SCALE	SHEET
		1:1	1 OF 4

REVISION HISTORY			
REV	DATE	BY	DESCRIPTION
E	08FEB2018	CB1/VK	PRN: P2018-0356

DISPLAY SWIVEL
±95°
FROM POSITION
SHOWN

ARM PIVOT
±95°
FROM
POSITION
SHOWN

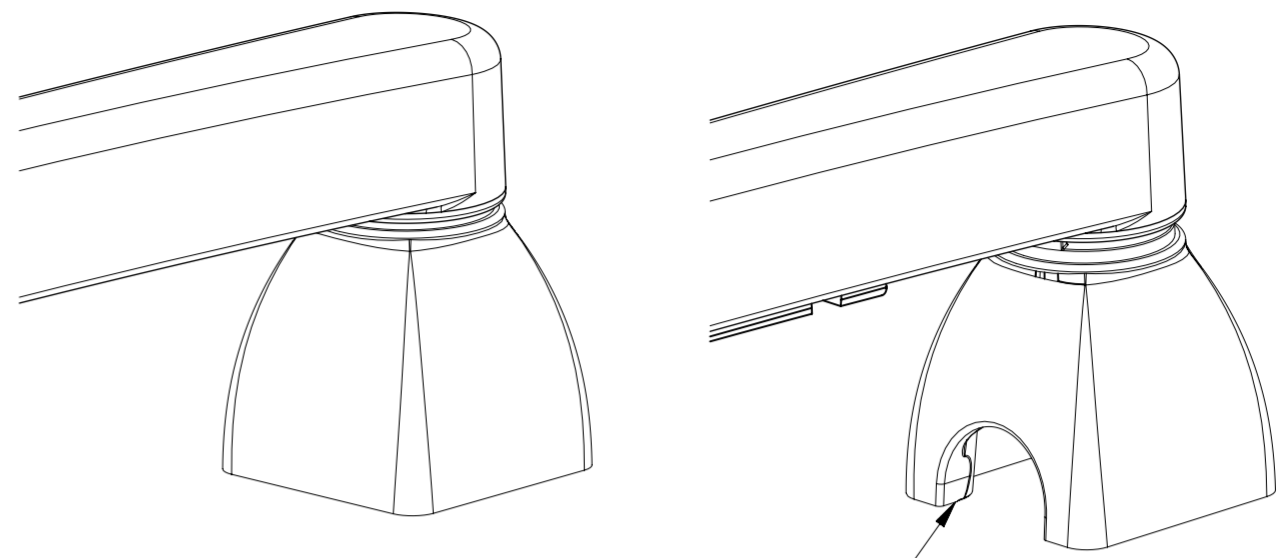

ASSEMBLIES CAN BE ORDERED WITH
AN OPTIONAL WIRE NOTCH IN SWIVEL
HOUSING FOR EASIER WIRE ROUTING.

TILT
±20°
FROM POSITION
SHOWN

FORWARD

REVERSE

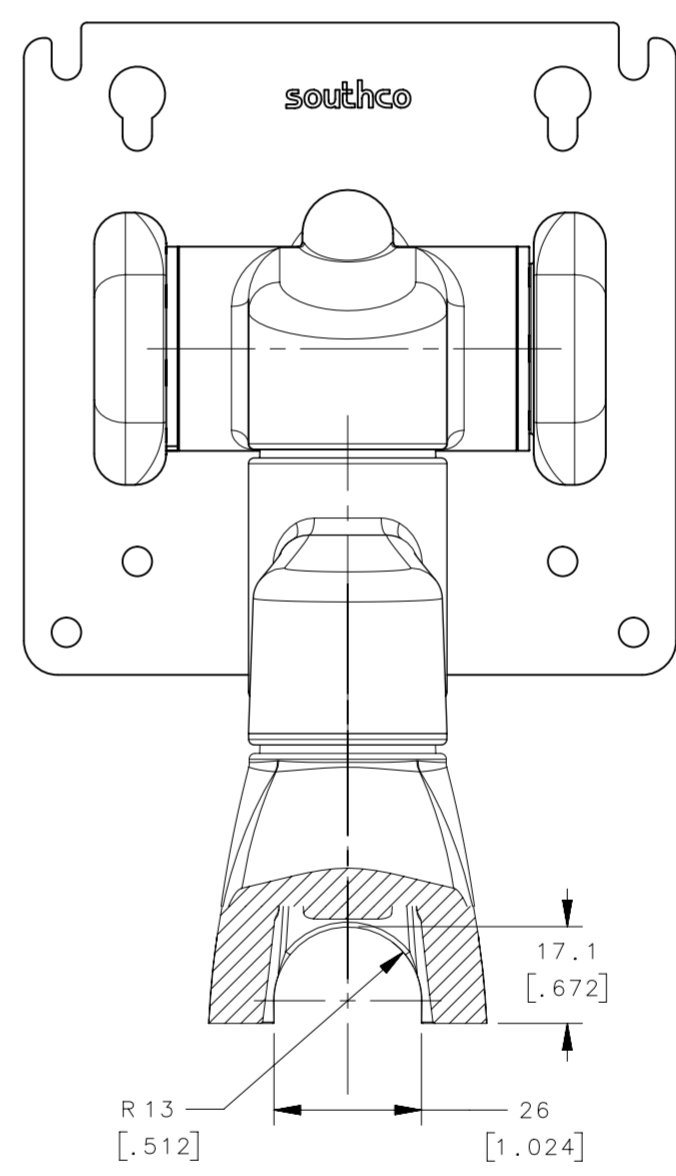

SECTION B-B
(OPTIONAL WIRE NOTCH DETAIL)

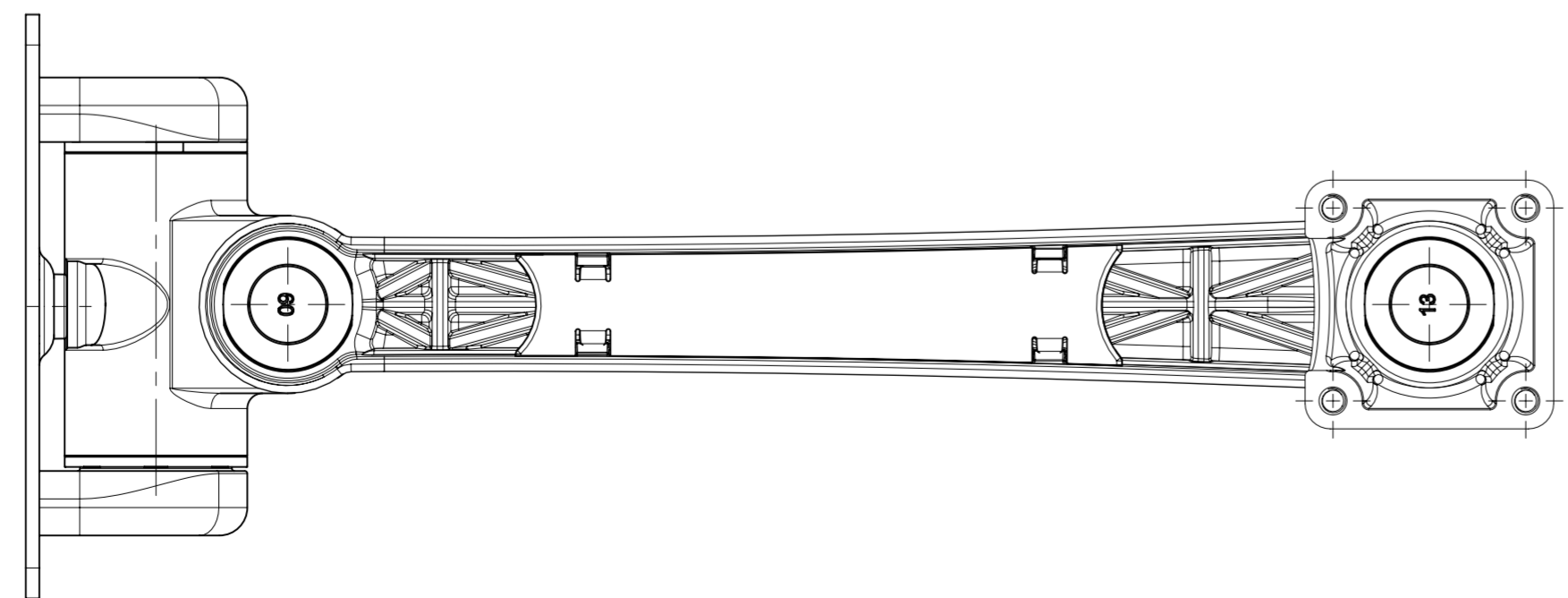

THIRD ANGLE PROJECTION				southco CONNECT · CREATE · INNOVATE	
MILLIMETERS [IN]					
SURFACE AREA		TOLERANCES UNLESS OTHERWISE NOTED		DESCRIPTION	
VOLUME		ALL DIMENSIONS WITHOUT TOLERANCES ARE FOR REFERENCE ONLY.		TILT & SWIVEL, SINGLE ARM	
PROPRIETARY ITEM		SIZE	SYSTEM	DWG NO.	
EXCEPT FOR USES EXPRESSLY GRANTED IN WRITING, INFORMATION DISCLOSED HEREON IS CONFIDENTIAL AND ALL RIGHTS, PATENT AND OTHERWISE, ARE RESERVED BY SOUTHCO, INC.		A2	NX	J-AV-D32-23A121	
PER ASME Y14.5M-1994		DRAWN BY	DATE	SCALE	SHEET
		GEA	22AUG2014	1:1	2 OF 4

8

7

6

5

4

3

2

1

REVISION HISTORY			
REV	DATE	BY	DESCRIPTION
E	08FEB2018	CB1/VK	PRN: P2018-0356

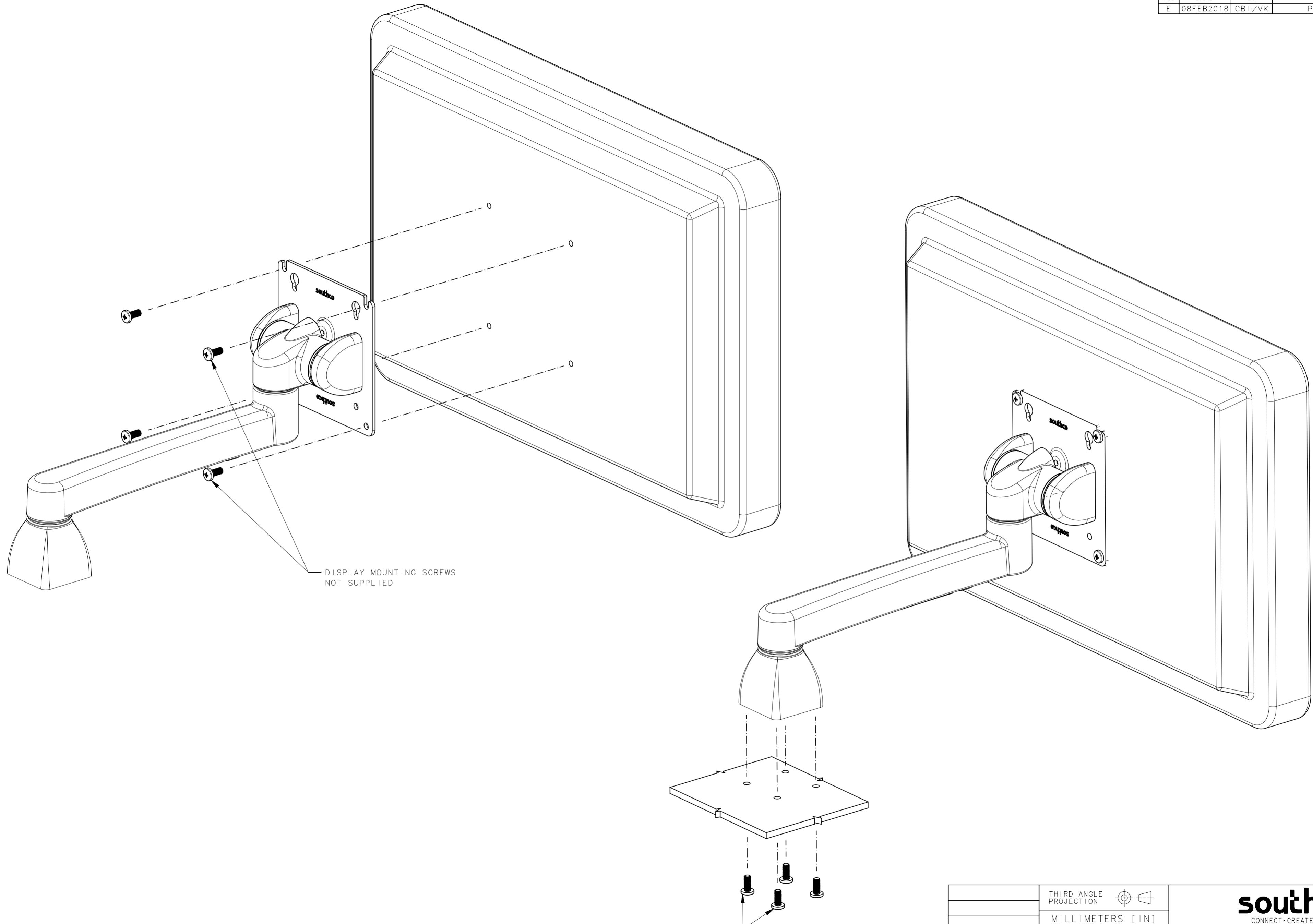

DISPLAY MOUNTING SCREWS
NOT SUPPLIED

M5 X 0.8 SCREWS (NOT SUPPLIED)

NOTE: ARM MOUNTING SCREWS MUST
HAVE 10mm MINIMUM THREAD
ENGAGEMENT.

THIRD ANGLE PROJECTION				southco CONNECT · CREATE · INNOVATE	
MILLIMETERS [IN]					
SURFACE AREA		TOLERANCES UNLESS OTHERWISE NOTED		DESCRIPTION	
VOLUME		ALL DIMENSIONS WITHOUT TOLERANCES ARE FOR REFERENCE ONLY.		TILT & SWIVEL, SINGLE ARM	
PROPRIETARY ITEM		SIZE	SYSTEM	DWG NO.	
EXCEPT FOR USES EXPRESSLY GRANTED IN WRITING, INFORMATION DISCLOSED HEREON IS CONFIDENTIAL AND ALL RIGHTS, PATENT AND OTHERWISE, ARE RESERVED BY SOUTHCO, INC.		A2	NX	J-AV-D32-23A121	
PER ASME Y14.5M-1994		DRAWN BY	DATE	SCALE	SHEET
		GEA	22AUG2014	1:1	3 OF 4

8

7

6

5

4

3

2

1

8

7

6

5

4

3

2

1

REVISION HISTORY			
REV	DATE	BY	DESCRIPTION
E	08FEB2018	CB1/VK	PRN: P2018-0356

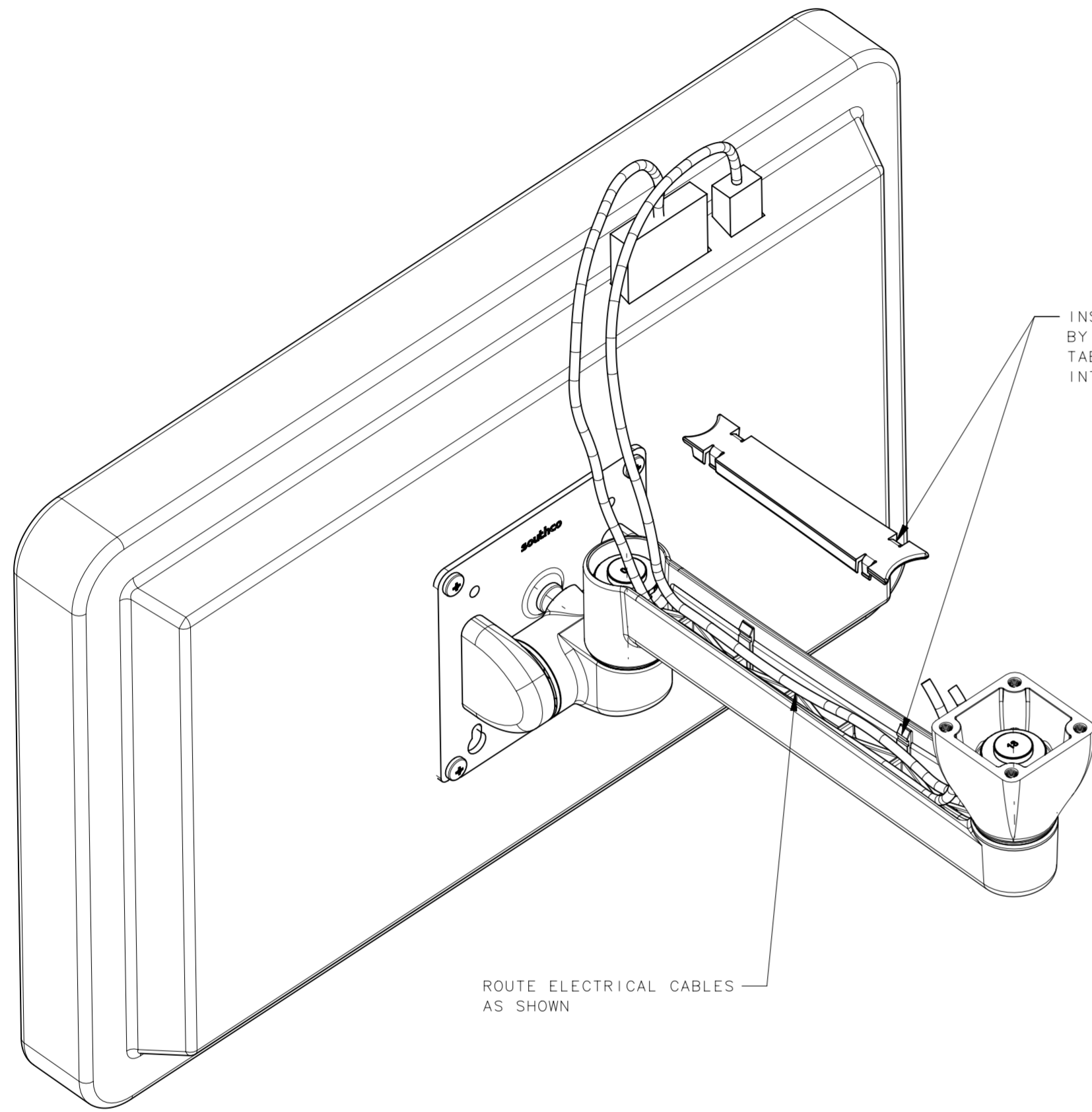

INSTALL WIRE COVER
BY ALIGNING SNAP
TABS. PRESS COVER
INTO ARM TO SECURE.

ROUTE ELECTRICAL CABLES
AS SHOWN

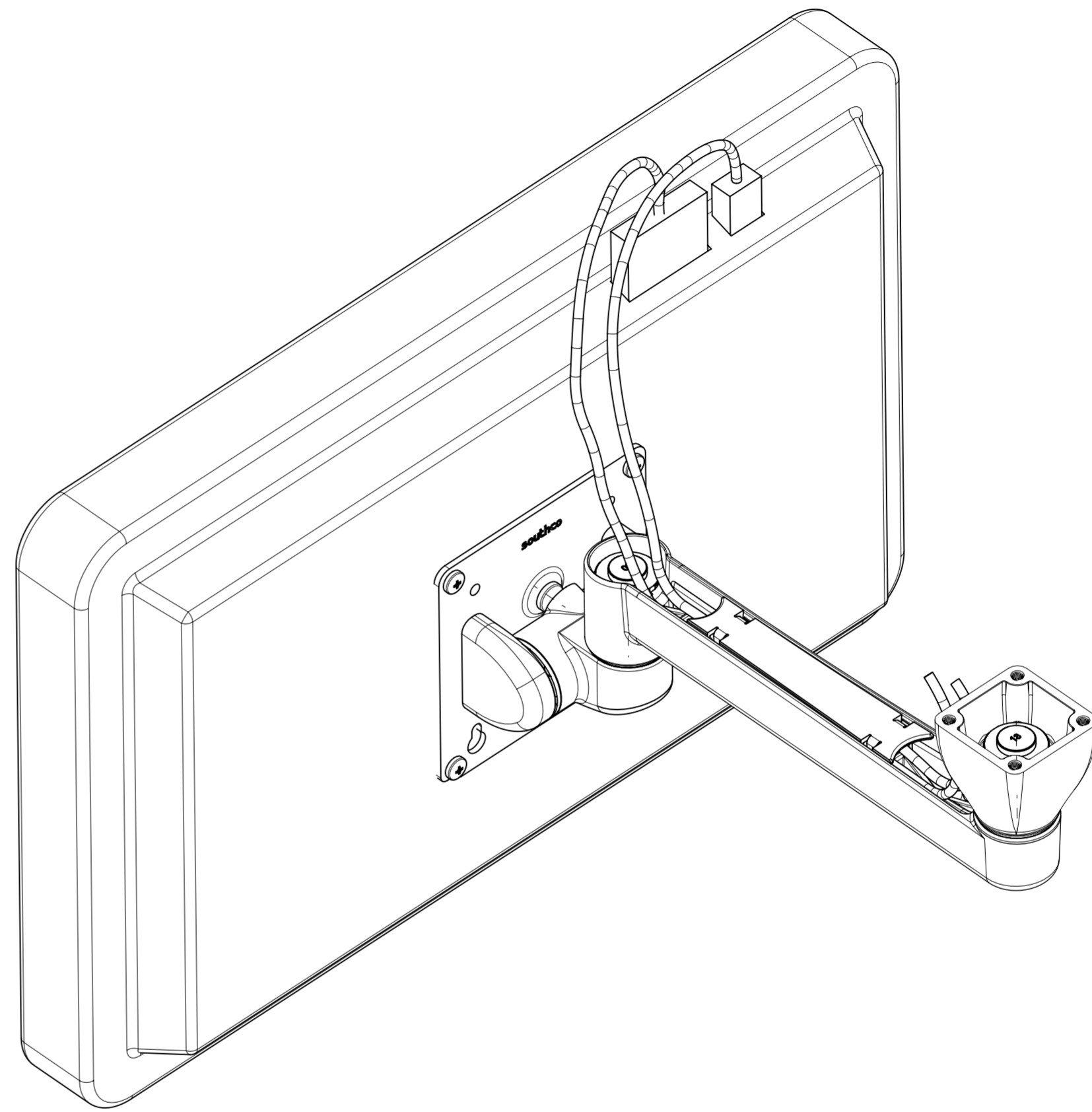

	THIRD ANGLE PROJECTION		southco CONNECT · CREATE · INNOVATE
	MILLIMETERS [IN]		
SURFACE AREA	TOLERANCES UNLESS OTHERWISE NOTED		DESCRIPTION
VOLUME	ALL DIMENSIONS WITHOUT TOLERANCES ARE FOR REFERENCE ONLY.		DISPLAY MOUNT TILT & SWIVEL, SINGLE ARM
PROPRIETARY ITEM EXCEPT FOR USES EXPRESSLY GRANTED IN WRITING, INFORMATION DISCLOSED HEREON IS CONFIDENTIAL AND ALL RIGHTS, PATENT AND OTHERWISE, ARE RESERVED BY SOUTHCO, INC.	PER ASME Y14.5M-1994	SIZE SYSTEM A2 NX	DWG NO. J-AV-D32-23A121
	DRAWN BY GEA	DATE 22AUG2014	SCALE 1:1 SHEET 4 OF 4

8

7

6

5

4

3

2

1