

REVISION HISTORY			
REV	DATE	BY	DESCRIPTION
C	04MAY2020	GEA/DMS	PRN: P2019-3080

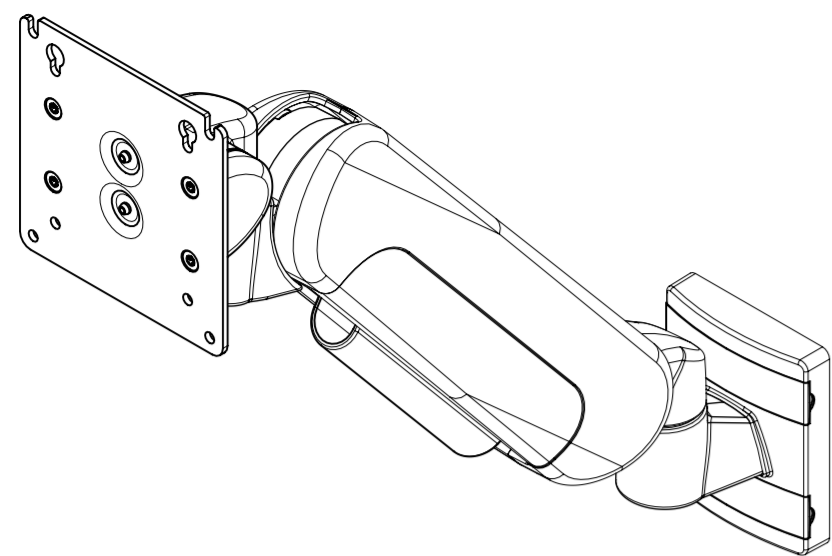

DISPLAY SWIVEL  
±90° FROM  
POSITION SHOWN

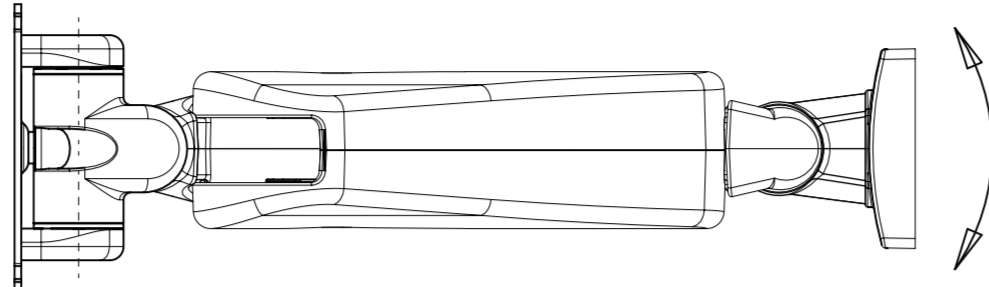

ARM PIVOT  
±90° FROM  
POSITION SHOWN

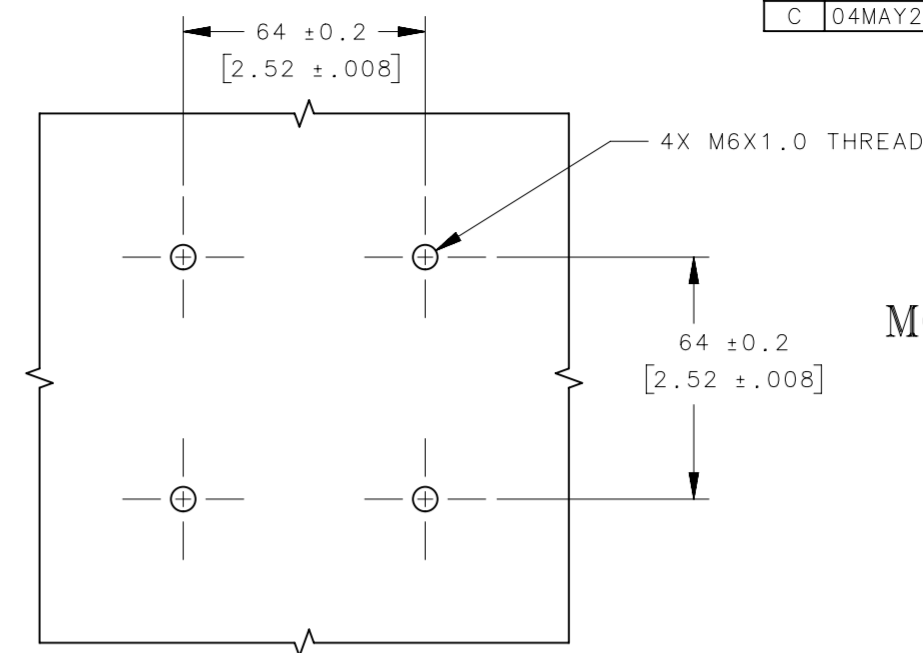

### MOUNTING PANEL PREPARATION

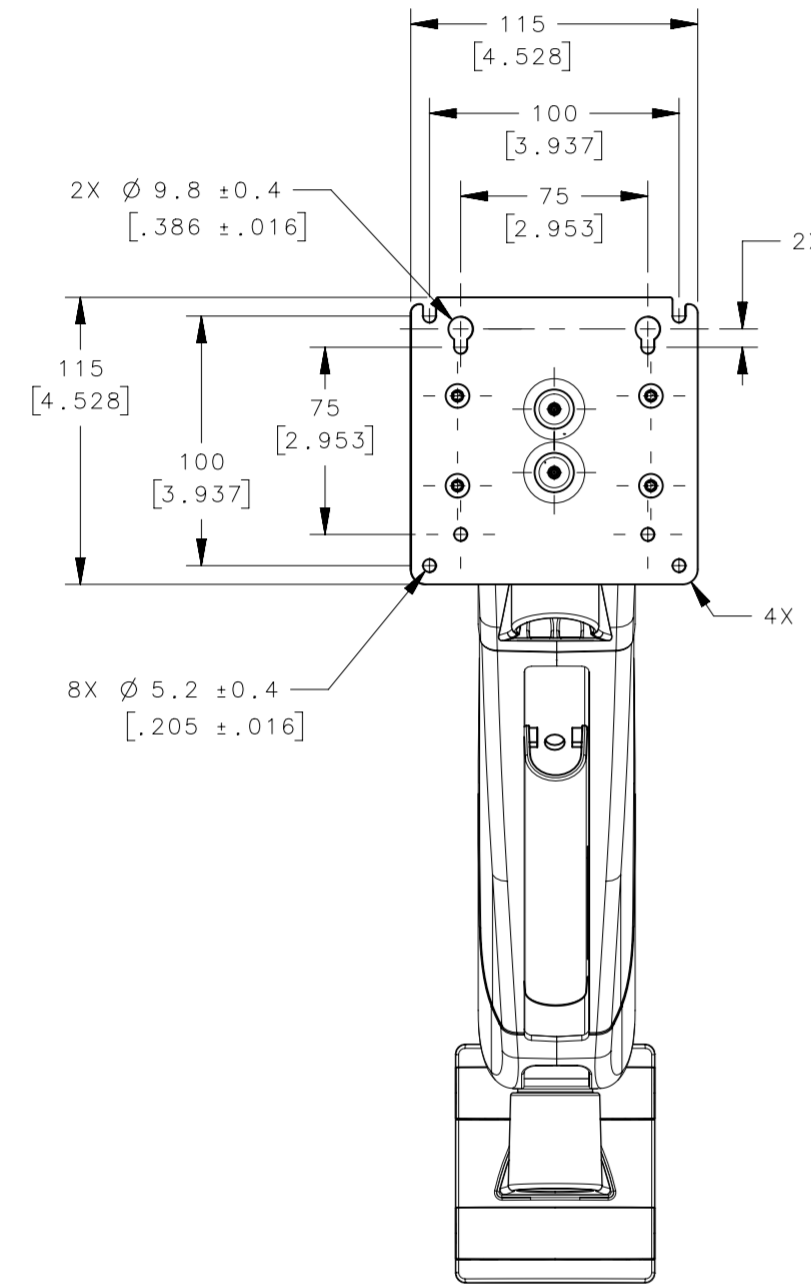

2.67 [.105]  
3.0 [0.118] MAXIMUM  
WHEN POWDER COATED

DISPLAY TILT  
+35° FORWARD  
-20° REVERSE  
FROM POSITION  
SHOWN

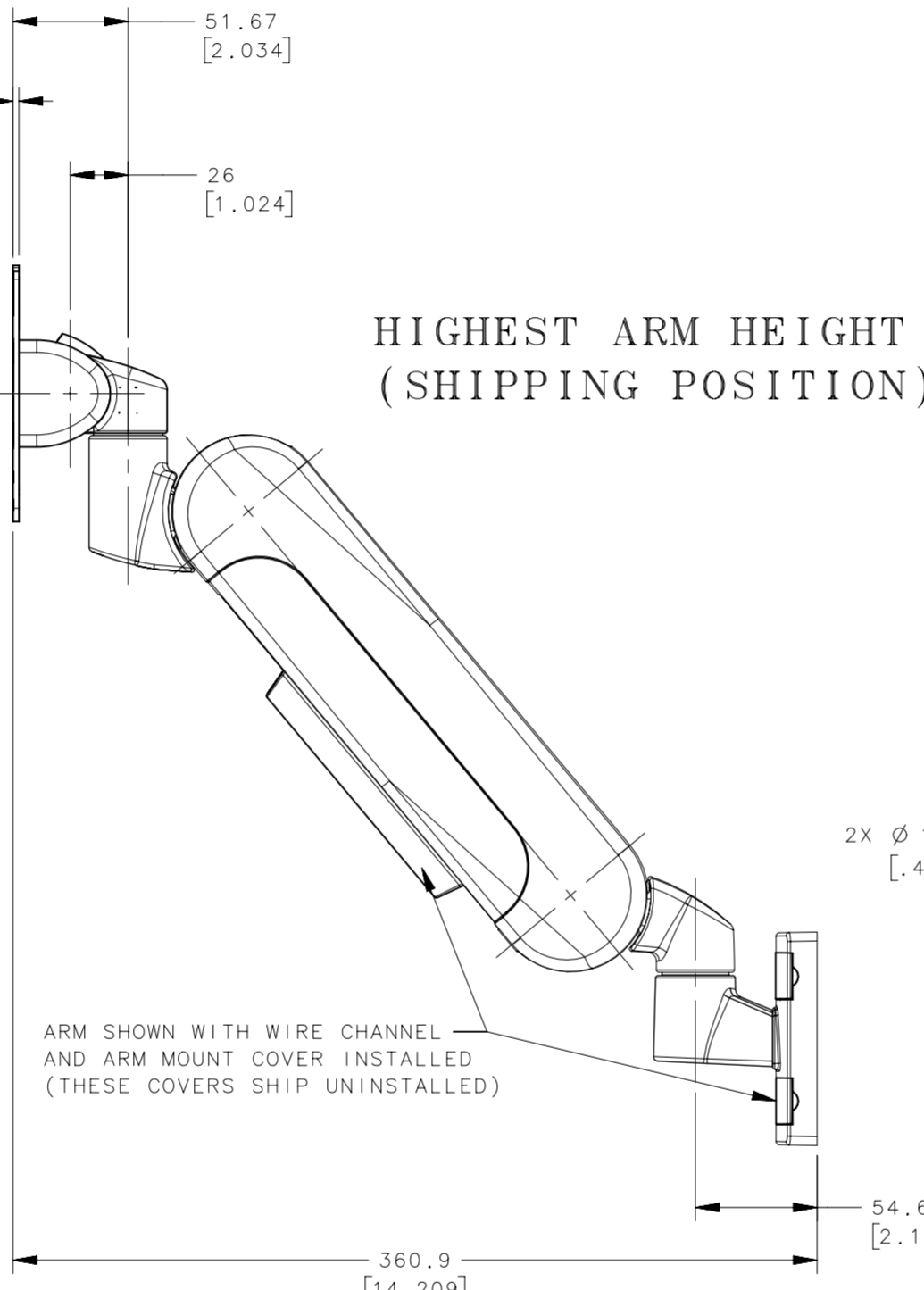

### HIGHEST ARM HEIGHT (SHIPPING POSITION)

ARM SHOWN WITH WIRE CHANNEL AND ARM MOUNT COVER INSTALLED (THESE COVERS SHIP UNINSTALLED)

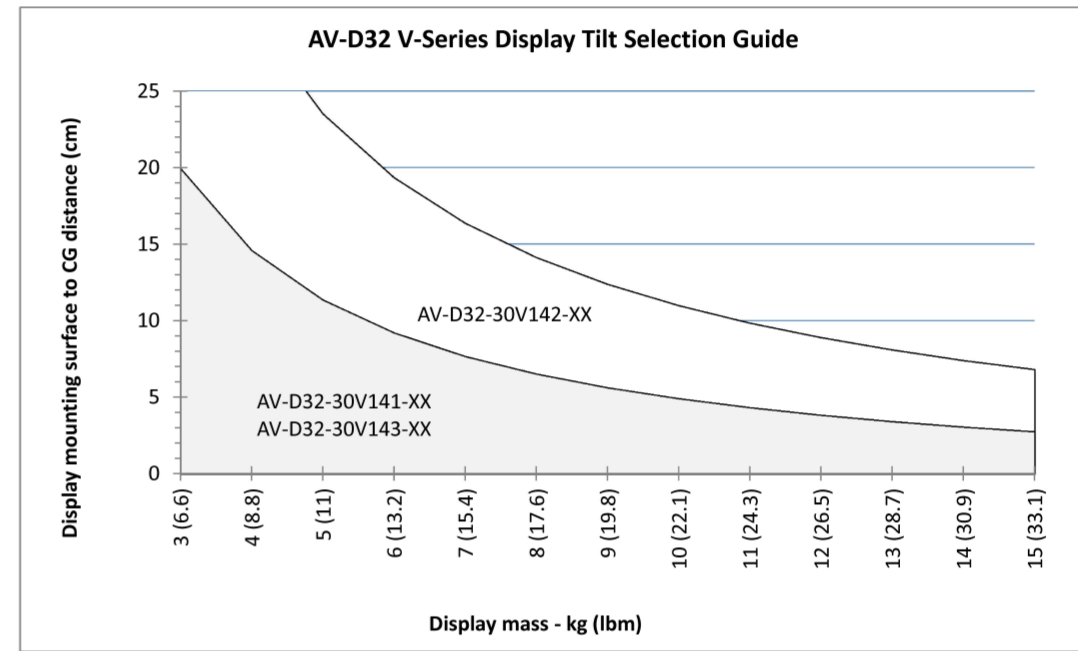
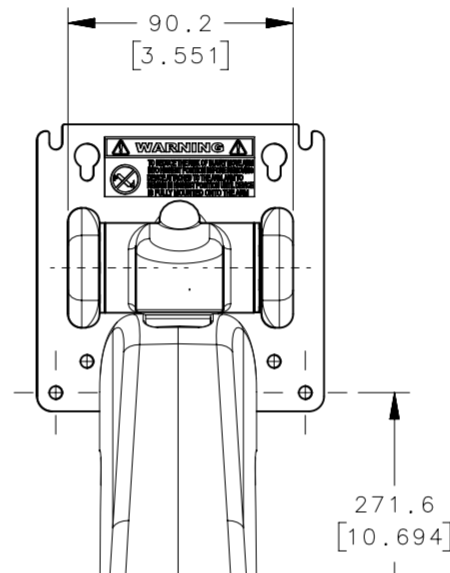

- NOTES:
- FINISH PER SOUTHCO COSMETIC SPECIFICATION S-121. ALL POWDER COATED EXTERIOR VISIBLE SURFACES CLASS C AND PLASTIC COVERS CLASS B.
  - TILT TORQUE MEASURED WITH DISPLAY MOUNTING PLATE IN THE VERTICAL 0° ± 5° POSITION WHEN TILTING IN THE REVERSE DIRECTION. THE TILT TORQUE VARIES WITH THE COUNTERBALANCE (WHEN EQUIPPED) IN THE FORWARD AND REVERSE DIRECTIONS.
  - THE DISPLAY MOUNTING PLATE TO TILT HOUSING ANGULAR FREE PLAY TO BE 1.5° MAXIMUM.
  - THE ARM IS ADJUSTABLE TO SUPPORT DISPLAYS OF WEIGHT WITHIN RANGE SPECIFIED IN THE TABLE BELOW. THE DISPLAY IS ADJUSTED BY USING A 5 mm HEX KEY IN THE TOP OF THE LOWER HOUSING. THIS IS ACCESSED BY LOWERING THE ARM POSITION WITH THE DISPLAY ATTACHED TO JUST BELOW THE HORIZONTAL POSITION. THE ADJUSTMENT SCREW IS TURNED CLOCKWISE FOR A LIGHTER DISPLAY AND COUNTERCLOCKWISE FOR HEAVIER DISPLAYS. THE ARM SHIPS WITH THE ADJUSTMENT FOR THE HEAVIEST DISPLAY. (SEE SHEET 2 OF 4)
  - MATERIALS AND FINISHES:  
 ADAPTERS: DIE CAST ALUMINUM, ANODIZED AND POWDER COATED  
 ARM, TILT HOUSING, UPPER KNUCKLE AND LOWER KNUCKLE, ARM ADAPTER AND WALL MOUNT PLATE: DIE CAST ALUMINUM, POWDER COATED  
 TILT SLEEVE, THRUST WASHER AND SHELL: ACETAL, BLACK  
 COILED PIN: STEEL, PHOSPHATE COATED  
 TILT SHAFT, TORQUE ELEMENTS AND STOP WASHER: STEEL, NATURAL FINISH  
 TORSION SPRING: CARBON STEEL, NICKEL PLATED (WHEN EQUIPPED)  
 DISPLAY SCREWS, WALL MOUNT SCREWS AND RETAINERS: STEEL, BLACK OXIDE  
 DISPLAY STOPS: POLYETHYLENE, WHITE  
 LINK BUSHING AND STRUT ADJUST BUSHING: BRASS, NATURAL  
 LINK FLANGED SLEEVE: STEEL, TEFLON COATED  
 STRUT PIN: STAINLESS STEEL  
 STRUT ADJUST ADAPTER: ZINC, NICKEL PLATED  
 GAS SPRING: STEEL AND ZINC, PAINTED  
 ARM LINKS, STRUT BALL MOUNT: STEEL, ZINC PLATED  
 ARM PIVOT SHAFTS: STAINLESS STEEL AND NYLON  
 LINK PINS: STEEL, NICKEL PLATED  
 ARM COVERS, WALL MOUNT FRONT COVERS AND WIRE CHANNEL: PC/ABS  
 WASHERS (WALL MOUNT PLATE): STEEL, ZINC PLATED  
 INSIDE ARM COVERS: POLYAMIDE (NYLON)  
 LUBRICANT: HYDROCARBON BASE

**WARNING:**  
TO REDUCE THE RISK OF INJURY MOVE ARM INTO HIGHEST POSITION BEFORE REMOVING DEVICE ATTACHED TO ARM. ARM TO REMAIN IN HIGHEST POSITION UNTIL DEVICE IS FULLY MOUNTED INTO THE ARM.

PART NUMBER	REVERSE TILT TORQUE N*m (lbf*in)	FORWARD TILT TORQUE N*m (lbf*in)	DISPLAY SWIVEL SYMMETRIC TORQUE N*m (lbf*in)	SYMMETRIC TORQUE TO MOVE ARM ASSEMBLY N*m (lbf*in)	RECOMMENDED DISPLAY WEIGHT RANGE	COLOR
AV-D32-30V141-50	7.9 (70)	1.13 (10)	4.29 N*m (38 lbf*in) NOMINAL / 2.17 N*m (19.2 lbf*in) MINIMUM	6.0 N*m (53.1 lbf*in) NOMINAL / 4.2 N*m (37.1 lbf*in) MINIMUM	2 To 7 kg (4.4 TO 15.4 lbm)	BLACK
AV-D32-30V141-76					5 To 10 Kg (11 TO 22 lbm)	OFFICE WHITE
AV-D32-30V142-50	15.4 (136)	2.26 (20)			2 To 7 kg (4.4 TO 15.4 lbm)	BLACK
AV-D32-30V142-76						
AV-D32-30V143-50	8.6 (76)	6.0 (53)				BLACK
AV-D32-30V143-76						

\* ASSEMBLIES CAN BE ORDERED WITH AN OPTIONAL WIRE NOTCH IN HOUSING FOR EASIER WIRE ROUTING. SEE SHEET 2.

THIRD ANGLE PROJECTION	
MILLIMETERS [IN]	
SURFACE AREA mm²	DESCRIPTION: HINGE & CONTROLLED MOTION DEVICE (STANDARD LIFT ARM, WALL MOUNT) TOLERANCES UNLESS OTHERWISE NOTED ALL DIMENSIONS WITHOUT TOLERANCES ARE FOR REFERENCE ONLY.
VOLUME mm³	
PROPRIETARY ITEM	SIZE SYSTEM: A2 NX DWG NO.: J-AV-D32-30V141 PER ASME Y14.5M-1994 DRAWN BY: GEA DATE: 01FEB2015 SCALE: 1:1 SHEET: 1 OF 4

REVISION HISTORY			
REV	DATE	BY	DESCRIPTION
C	04MAY2020	GEA/DMS	PRN: P2019-3080

### ARM DISPLAY WEIGHT ADJUSTMENT

(ARM TO BE ADJUSTED WITH DISPLAY MOUNTED)

DISPLAY WEIGHT ADJUSTMENT  
5mm HEX RECESS FOR HEX KEY

- TURN SCREW CW (CLOCKWISE) TO DECREASE TENSION FOR A LIGHTER DISPLAY
- + TURN SCREW CCW (COUNTERCLOCKWISE) TO INCREASE TENSION FOR A HEAVIER DISPLAY

(NOTE: ADJUSTMENT IS EASIER IF ARM IS POSITIONED BELOW HORIZONTAL WITH THE DISPLAY ATTACHED)

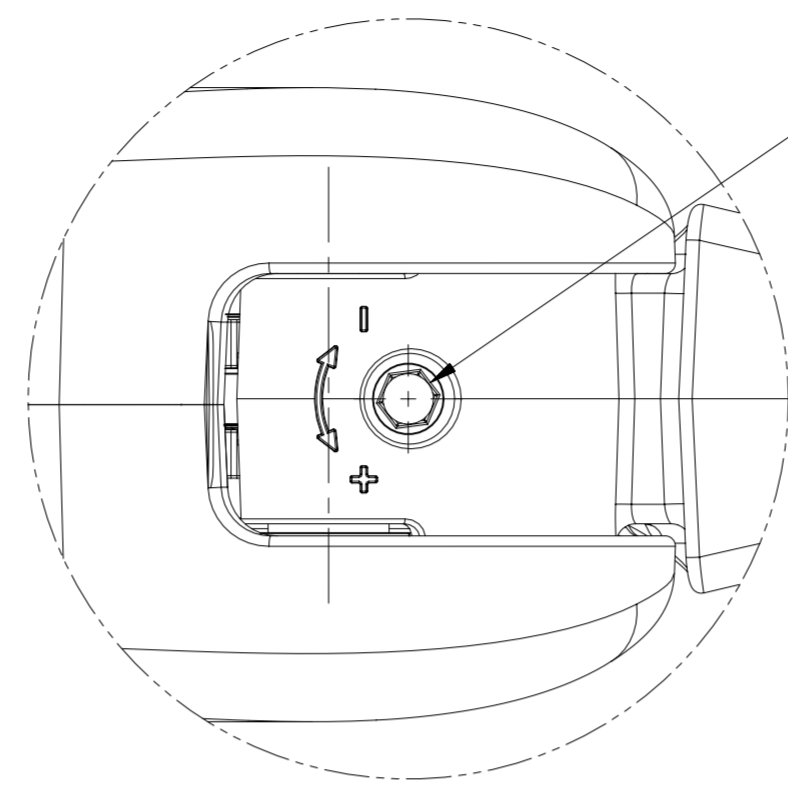

DETAIL A  
SCALE 4:3

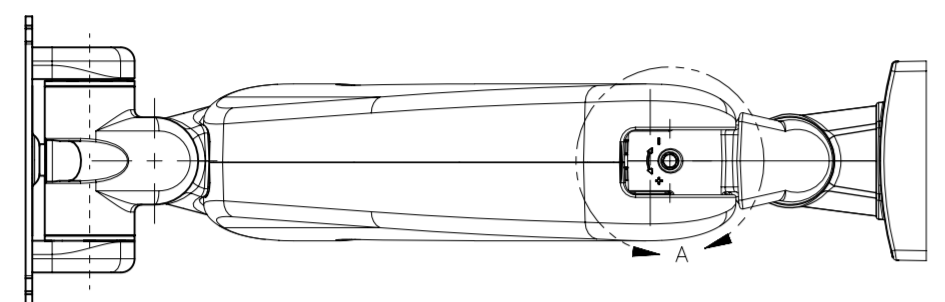

LOWEST ARM POSITION

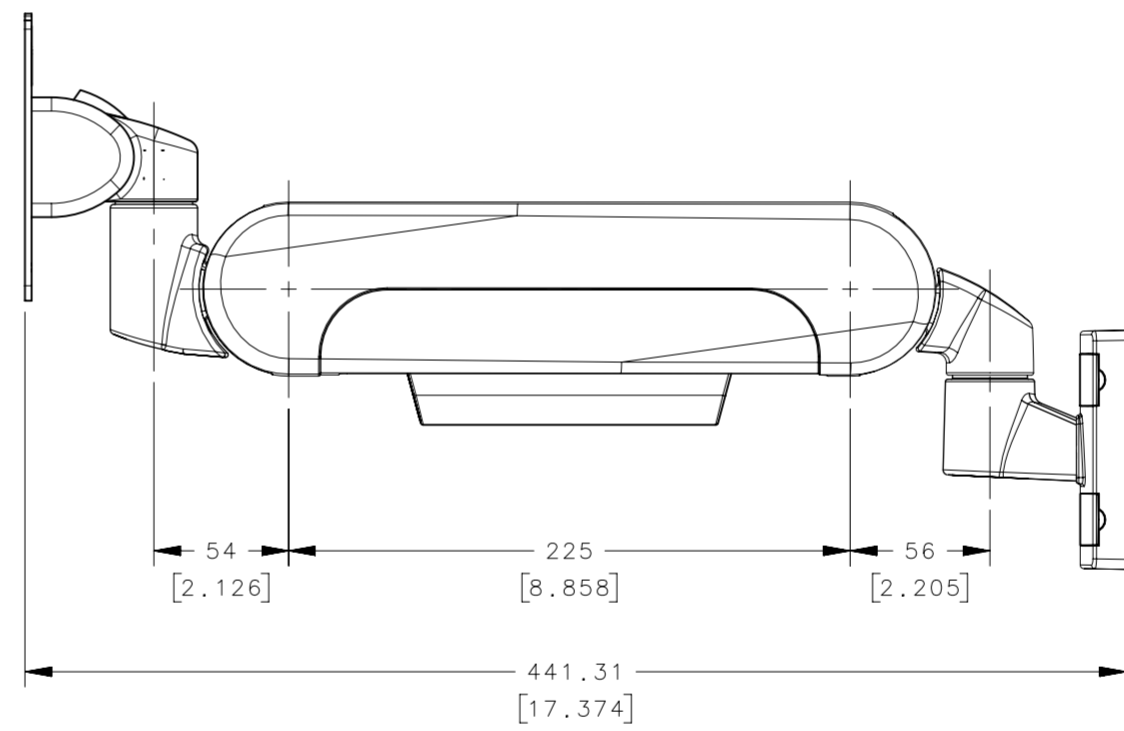
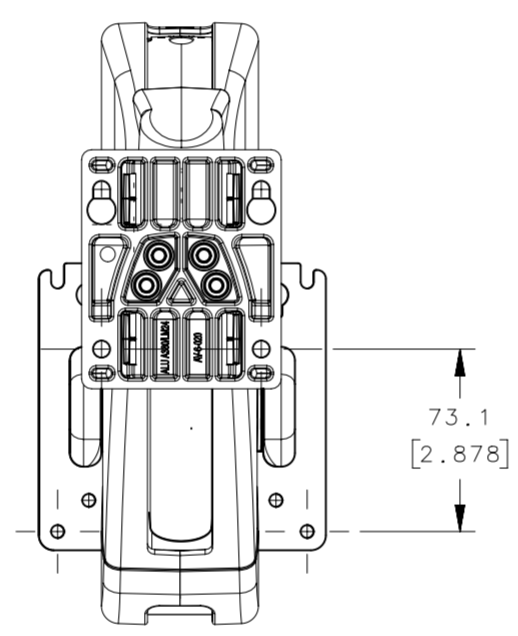
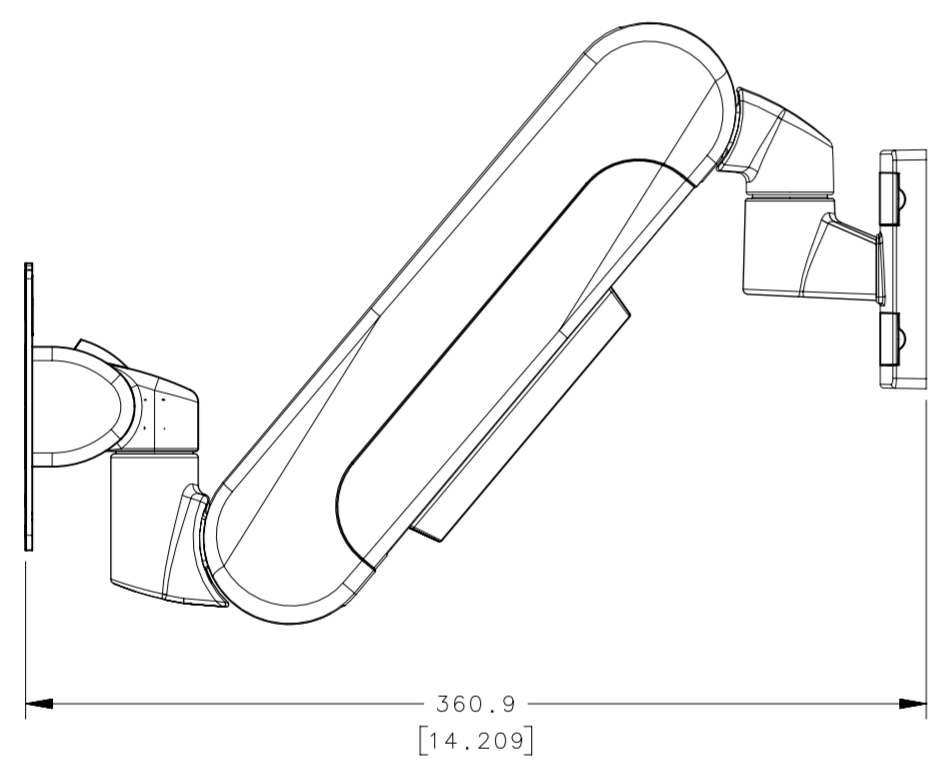

HORIZONTAL ARM POSITION

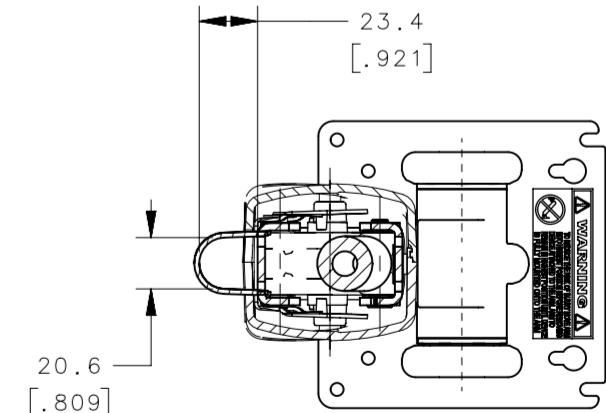
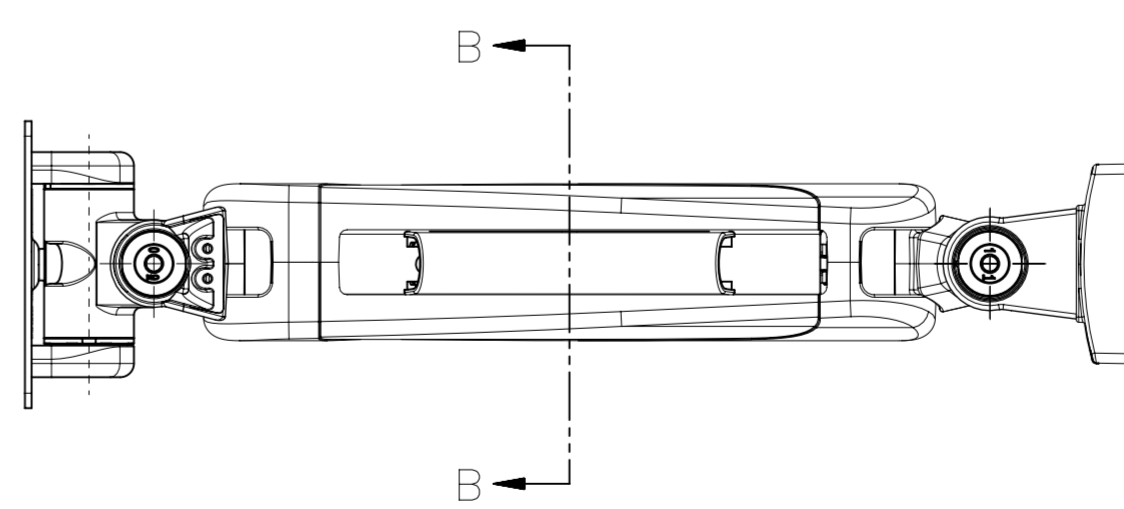
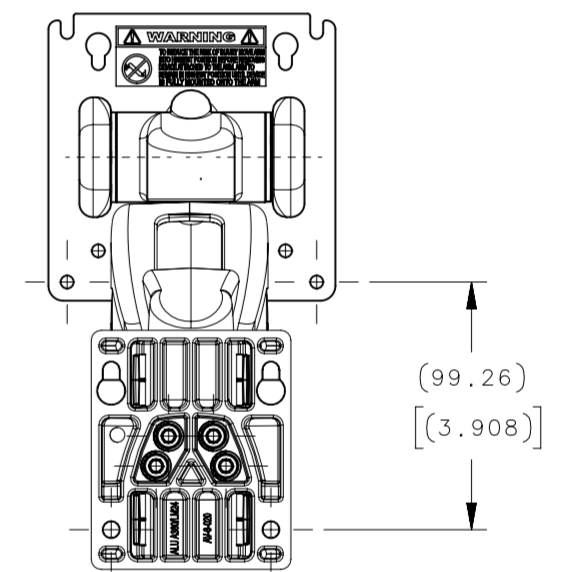

SECTION B-B

THIRD ANGLE PROJECTION				<b>southco</b> CONNECT · CREATE · INNOVATE	
MILLIMETERS [IN]					
SURFACE AREA		TOLERANCES UNLESS OTHERWISE NOTED		DESCRIPTION HINGE & CONTROLLED MOTION DEVICE (STANDARD LIFT ARM, WALL MOUNT)	
mm <sup>2</sup>	UP TO 0.5	±0.1			
VOLUME	mm <sup>3</sup>	OVER 0.5 UP TO 6	±0.2	SIZE SYSTEM	DWG NO.
		OVER 6 UP TO 30	±0.4	A2	NX
PROPRIETARY ITEM		OVER 30	±0.6	J-AV-D32-30V141	
EXCEPT FOR USES EXPRESSLY GRANTED IN WRITING, INFORMATION DISCLOSED HEREON IS CONFIDENTIAL AND ALL RIGHTS, PATENT AND OTHERWISE, ARE RESERVED BY SOUTHCO, INC.		ANGLES	±5°	PER ASME Y14.5M-1994	
		DRAWN BY	DATE	SCALE	SHEET
		GEA	01FEB2015	1:1	2 OF 4

8

7

6

5

4

3

2

1

REVISION HISTORY			
REV	DATE	BY	DESCRIPTION
C	04MAY2020	GEA/DMS	PRN: P2019-3080

REFER TO TABLE ON SHEET 1  
FOR RECOMMENDED DISPLAY  
WEIGHT RANGE

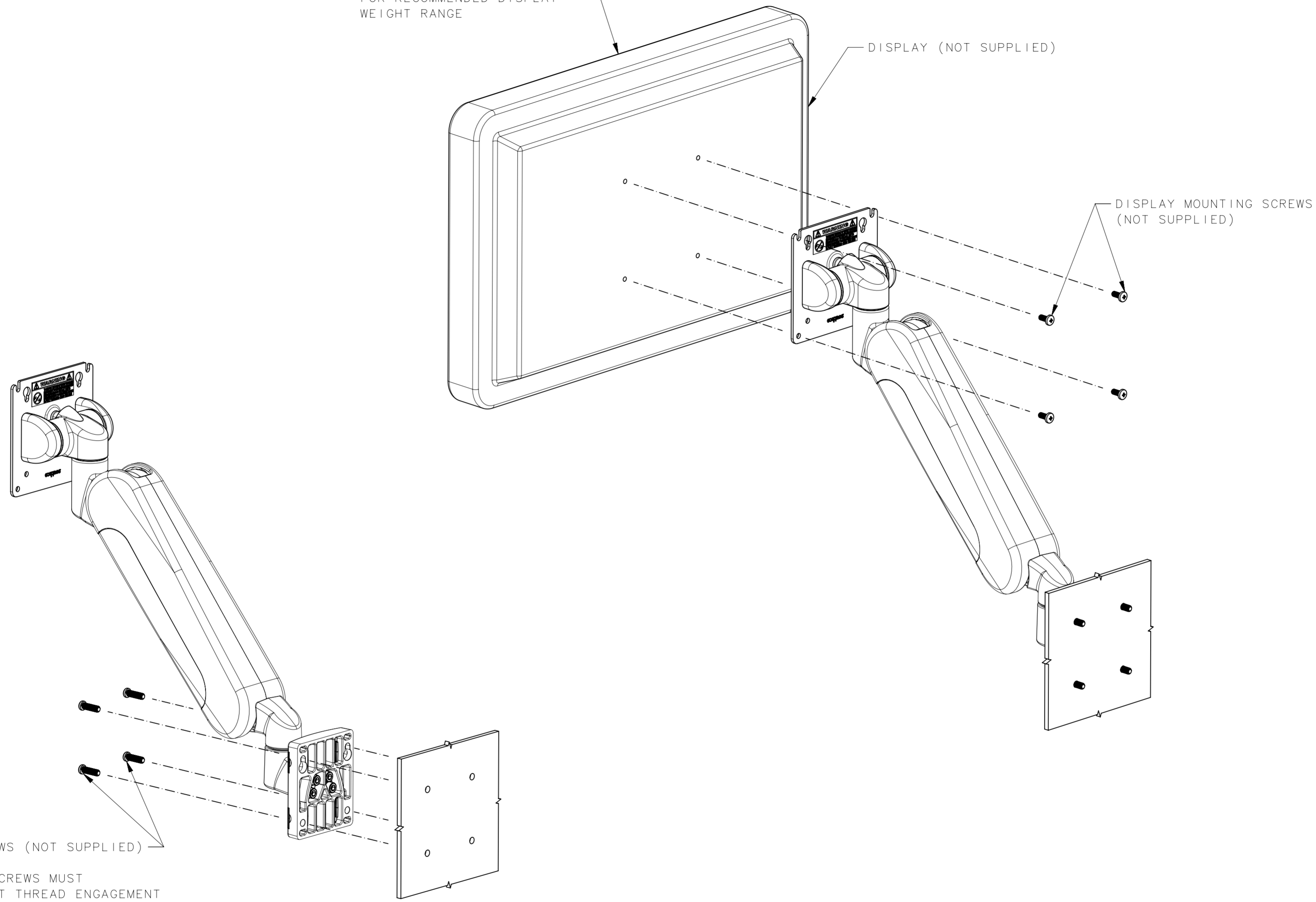

M6X1.0 MOUNTING SCREWS (NOT SUPPLIED)

NOTE: ARM MOUNTING SCREWS MUST  
HAVE SUFFICIENT THREAD ENGAGEMENT  
TO SUPPORT ARM ASSEMBLY.

THIRD ANGLE PROJECTION				<b>southco</b> CONNECT · CREATE · INNOVATE	
MILLIMETERS [IN]					
SURFACE AREA		TOLERANCES UNLESS OTHERWISE NOTED		DESCRIPTION	
mm <sup>2</sup>	UP TO 0.5	±0.1	HINGE & CONTROLLED MOTION DEVICE		
	OVER 0.5 UP TO 6	±0.2	(STANDARD LIFT ARM, WALL MOUNT)		
VOLUME	mm <sup>3</sup>	OVER 6 UP TO 30	±0.4	SIZE	SYSTEM
		OVER 30	±0.6	A2	NX
PROPRIETARY ITEM		ANGLES	±5°	DWG NO. J-AV-D32-30V141	
EXCEPT FOR USES EXPRESSLY GRANTED IN WRITING, INFORMATION DISCLOSED HEREON IS CONFIDENTIAL AND ALL RIGHTS, PATENT AND OTHERWISE, ARE RESERVED BY SOUTHCO, INC.		PER ASME Y14.5M-1994		DRAWN BY	DATE
				GEA	01FEB2015
				SCALE	SHEET
				1:1	3 OF 4

8

7

6

5

4

3

2

1

8

7

6

5

4

3

2

1

REVISION HISTORY			
REV	DATE	BY	DESCRIPTION
C	04MAY2020	GEA/DMS	PRN: P2019-3080

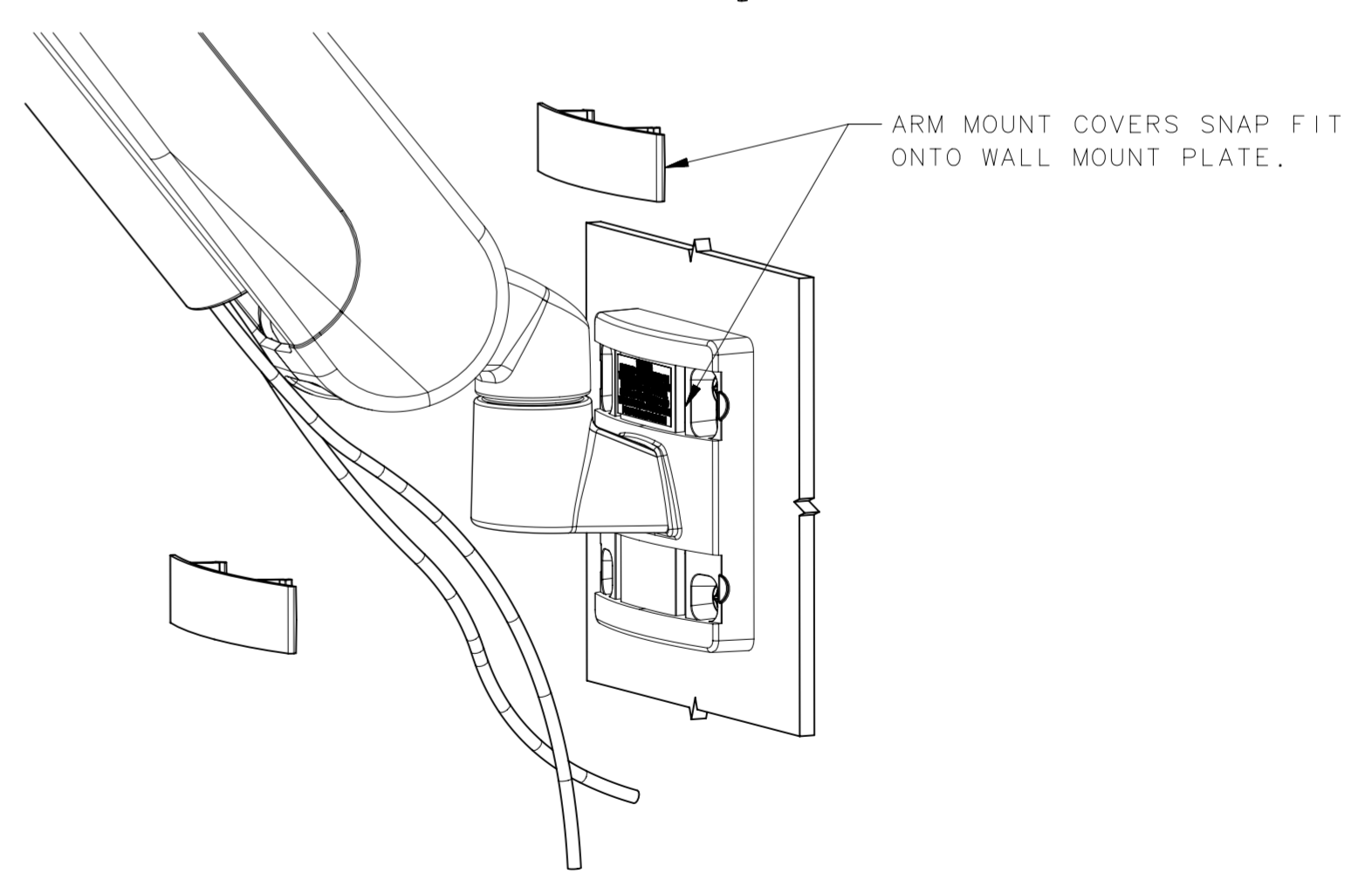
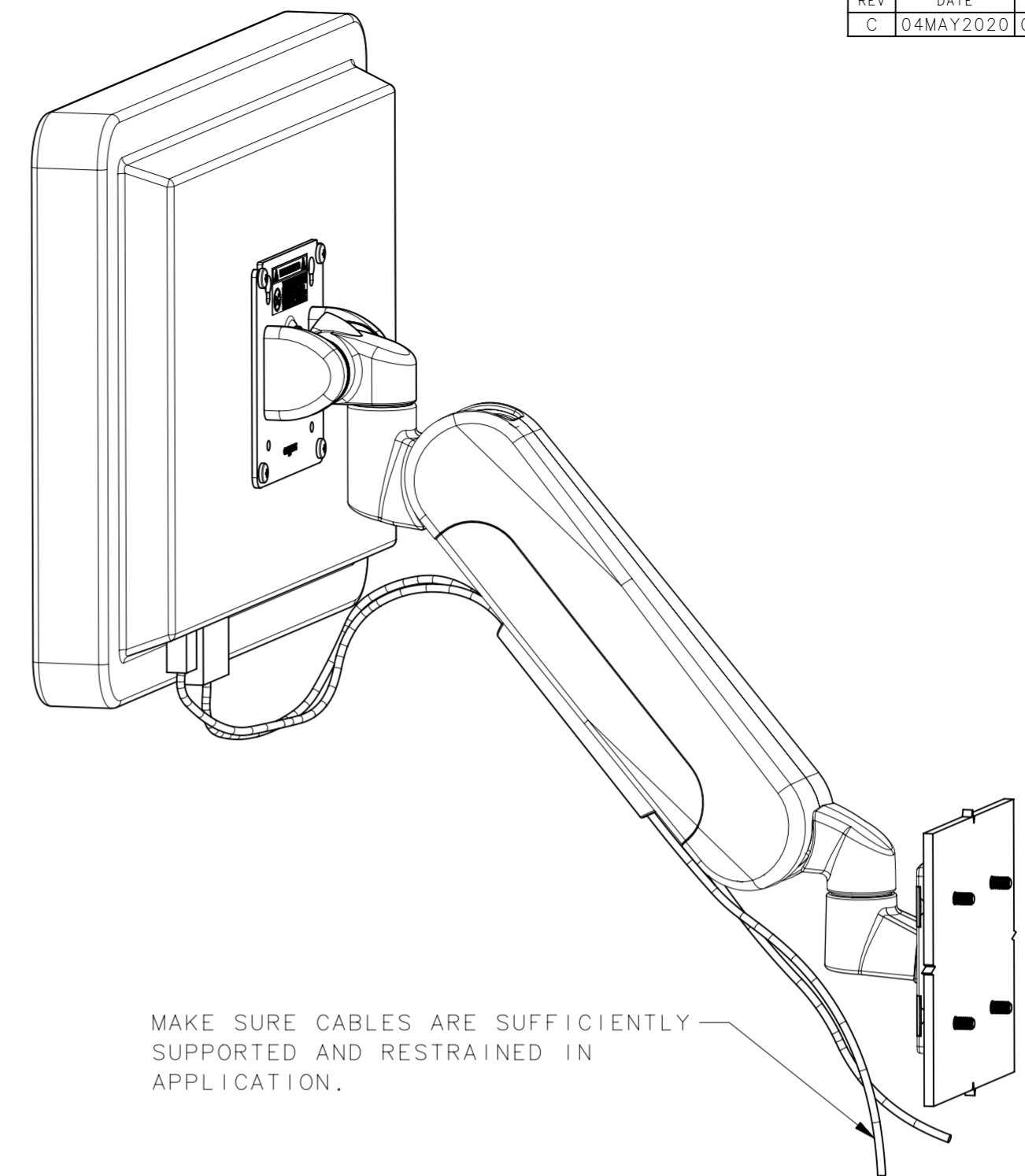
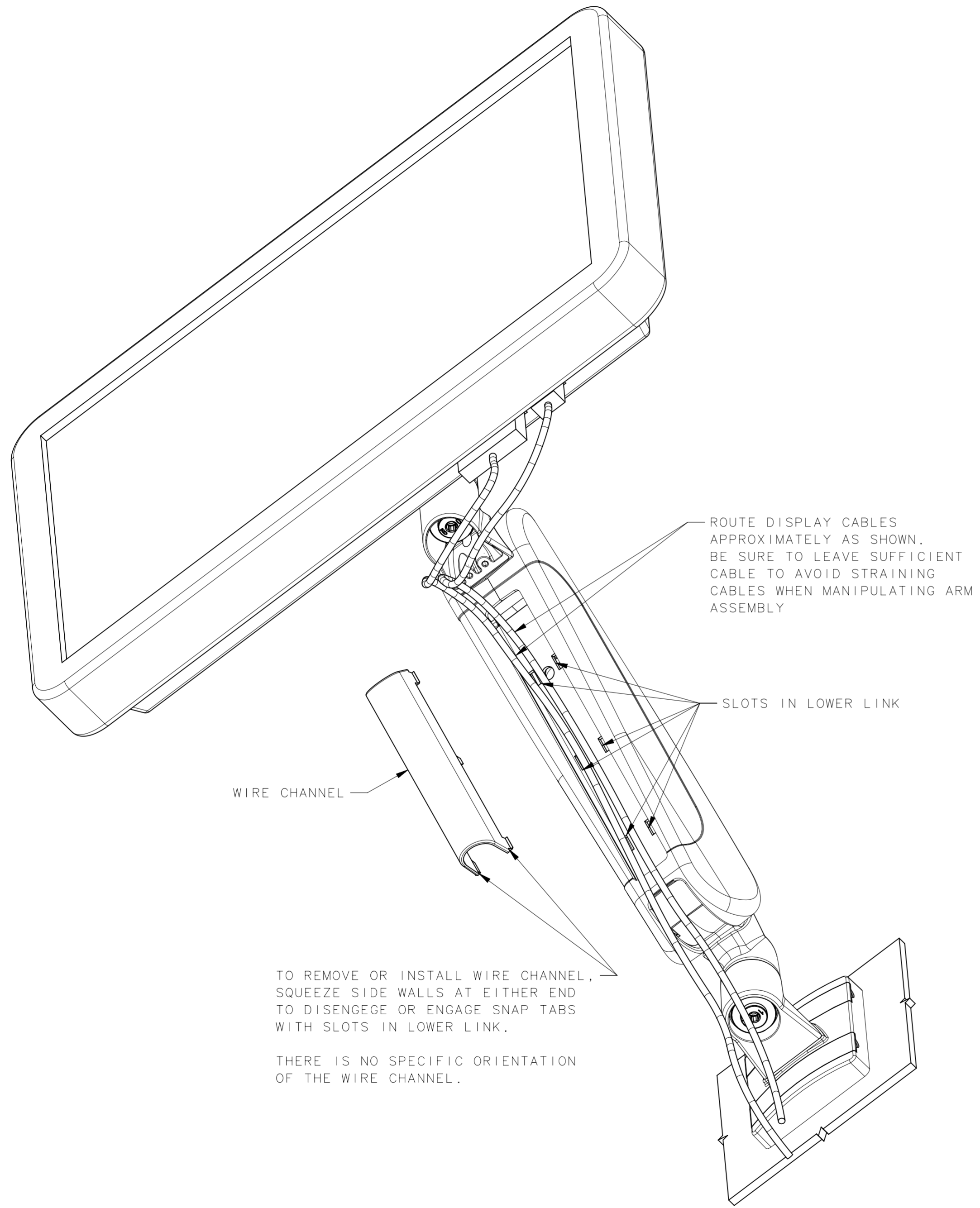

THIRD ANGLE PROJECTION				<b>southco</b> CONNECT · CREATE · INNOVATE	
MILLIMETERS [IN]					
SURFACE AREA		mm <sup>2</sup>	UP TO 0,5	±0,1	DESCRIPTION HINGE & CONTROLLED MOTION DEVICE (STANDARD LIFT ARM, WALL MOUNT)
VOLUME		mm <sup>3</sup>	OVER 0,5 UP TO 6	±0,2	
PROPRIETARY ITEM			OVER 6 UP TO 30	±0,4	
EXCEPT FOR USES EXPRESSLY GRANTED IN WRITING, INFORMATION DISCLOSED HEREON IS CONFIDENTIAL AND ALL RIGHTS, PATENT AND OTHERWISE, ARE RESERVED BY SOUTHCO, INC.			OVER 30	±0,6	
			ANGLES	±5°	SIZE SYSTEM A2 NX
		PER ASME Y14.5M-1994		DRAWN BY	DWG NO. J-AV-D32-30V141
				DATE	SCALE 1:1
				GEA	SHEET 4 OF 4
				01FEB2015	

8

7

6

5

4

3

2

1