

CAUTION:
 THE GAS SPRING CONTAINED IN THIS ASSEMBLY IS UNDER HIGH PRESSURE. DO NOT ACTUATE ARM ASSEMBLY WITH OUT DISPLAY OR TEST WEIGHT SECURELY FASTENED TO THE DISPLAY MOUNTING PLATE. THE DISPLAY OR TEST WEIGHT MUST BE INSTALLED AND REMOVED WITH THE ARM IN THE HIGHEST POSITION (SHIPPING POSITION).

REVISION HISTORY			
REV	DATE	BY	DESCRIPTION
C	15JUN2020	GEA/DMS	PRN: P2020-1029

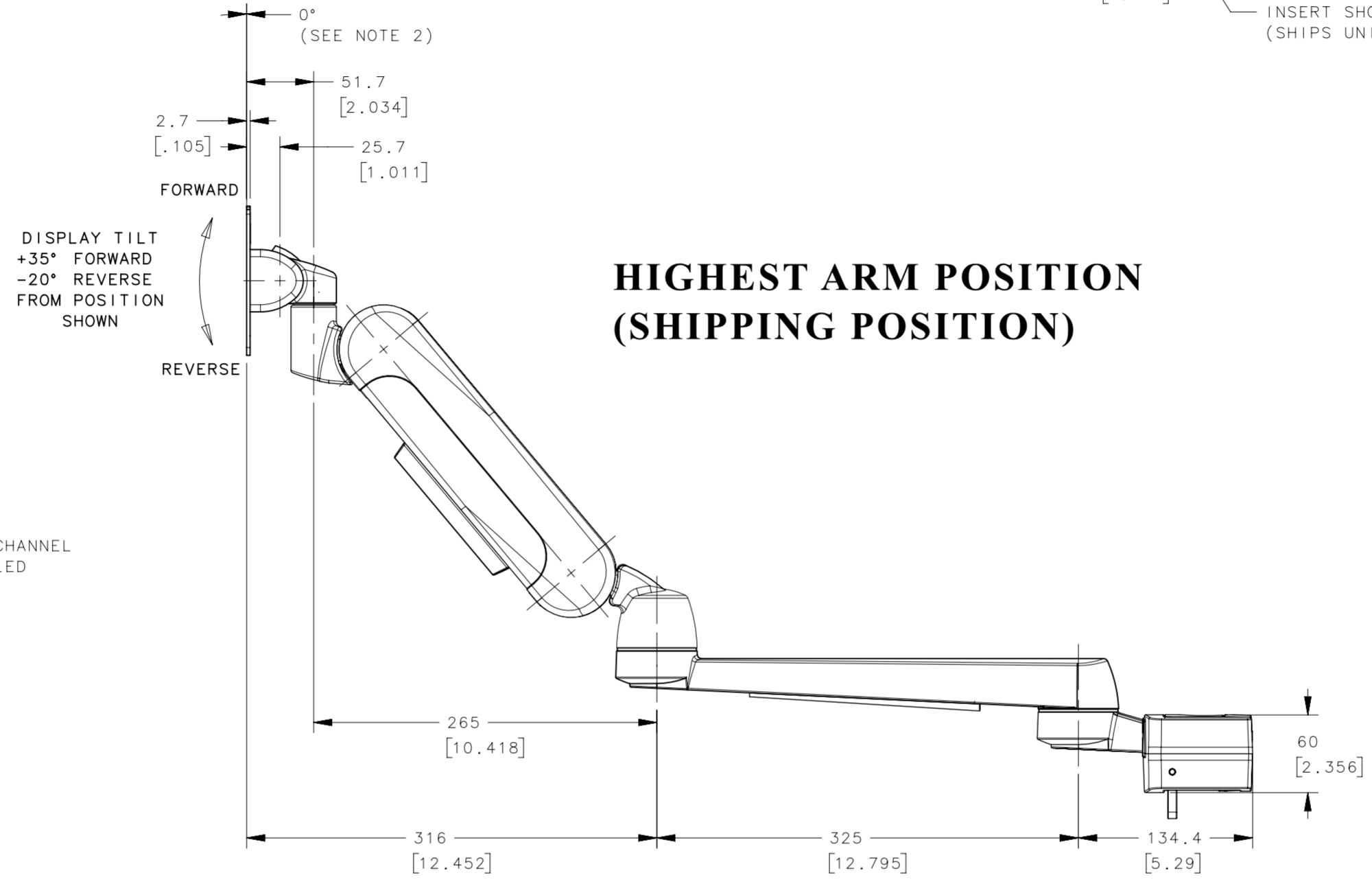

HIGHEST ARM POSITION (SHIPPING POSITION)

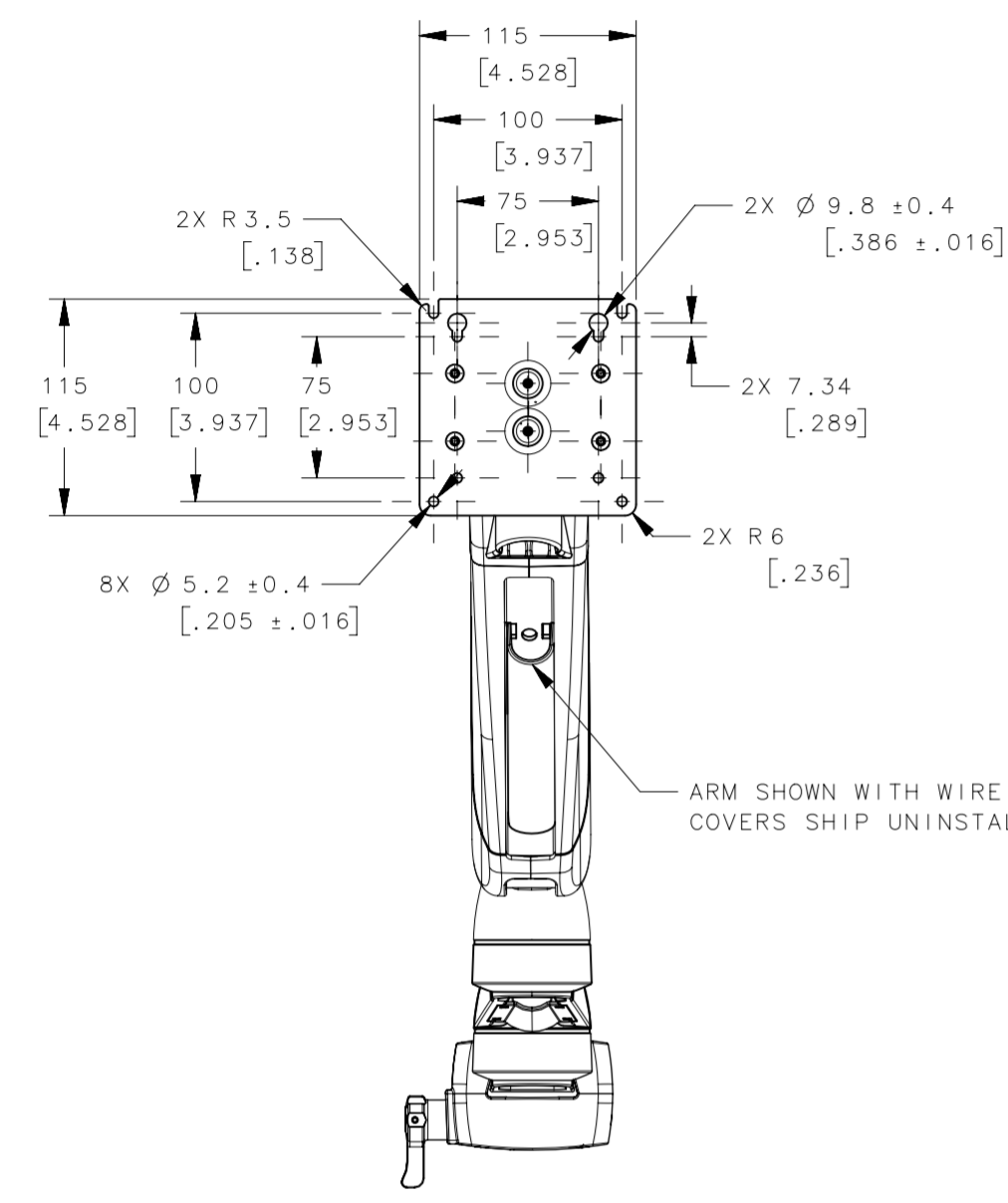
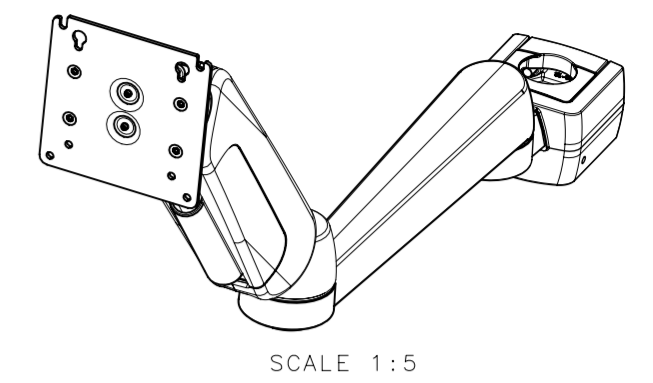
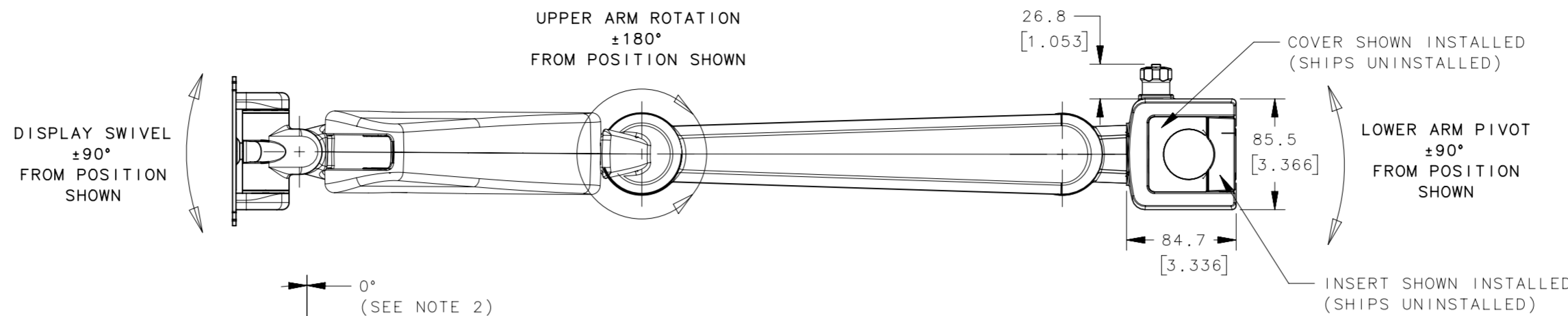
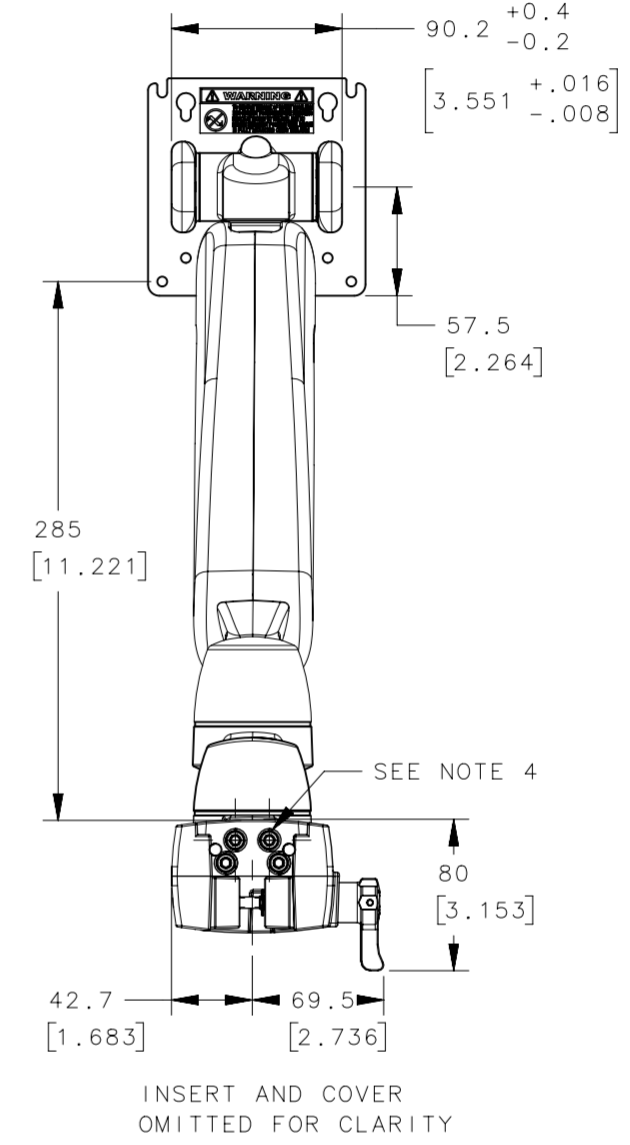

- NOTES:
- FINISH PER SOUTHCO COSMETIC SPECIFICATION S-121, CLASS C FOR POWDER COATING AND MOLDED PLASTIC PARTS. ALL POWDER COATED INTERIOR SURFACES ARE CLASS D AND OVERSPRAY IS PERMITTED, WHEREAS ALL INTERIOR PLASTIC PART SURFACES ARE CLASS D.
 - TILT TORQUE MEASURED WITH VESA DISPLAY PLATE IN THE VERTICAL (0°±5°) POSITION WHEN TILTING IN THE REVERSE DIRECTION FROM -5° TO 0°. TILT TORQUE VARIES WITH THE COUNTERBALANCE (WHEN EQUIPPED) IN THE FORWARD AND REVERSE DIRECTIONS.
 - DISPLAY MOUNTING PLATE TO TILT HOUSING ANGULAR FREE PLAY TO BE 1.5° MAXIMUM.
 - ASSEMBLY MODELED WITHOUT FINISH APPLIED. POWDER COATING ADDS 0.1+0.15/-0.05 mm TO EACH SURFACE.
 - THE ARM LIFT FORCE VARIES WITH THE ARM POSITION IN THE UP AND DOWN DIRECTION. ARM LIFT COUNTERBALANCE IS ADJUSTABLE WITH ACCESS TO THE ADJUSTMENT SCREW IN THE LOWER KNUCKLE WITH THE ARM IN THE LOWEST POSITION. THE ARM SHIPS WITH THE STRUT ADJUSTMENT TO SUPPORT THE LARGEST DISPLAY WEIGHT.
 - PACKAGE ARM ASSEMBLY PER PACKAGING SPECIFICATION DRAWING K-AV-D32-79W161, LATEST REVISION.

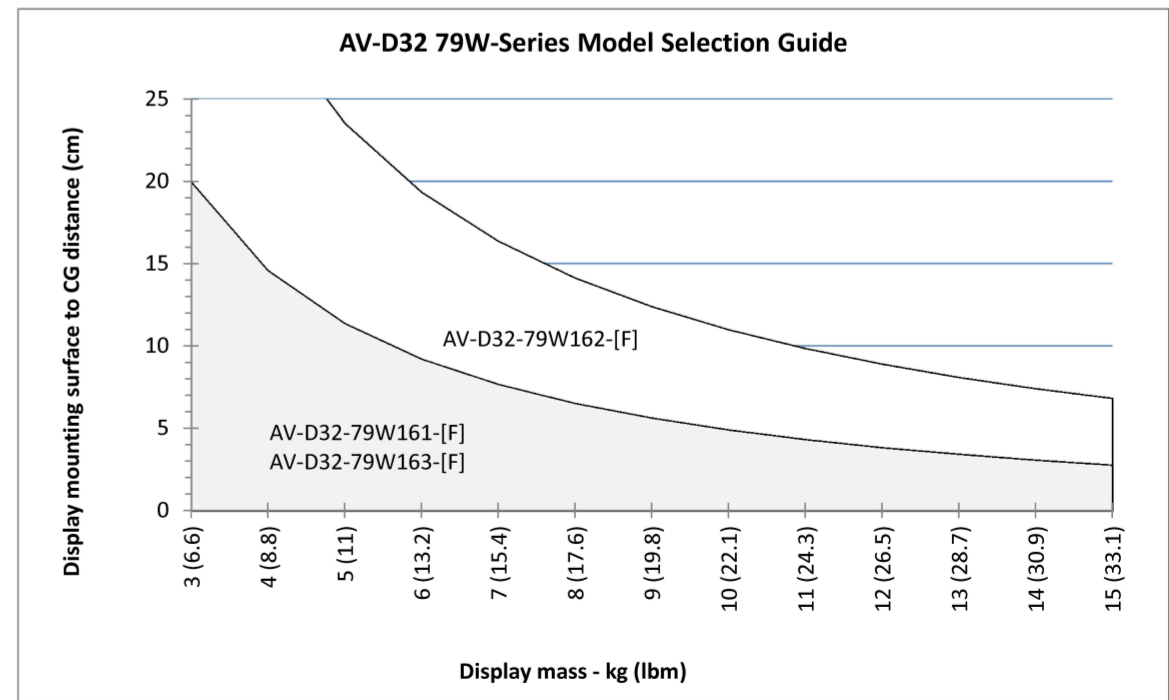
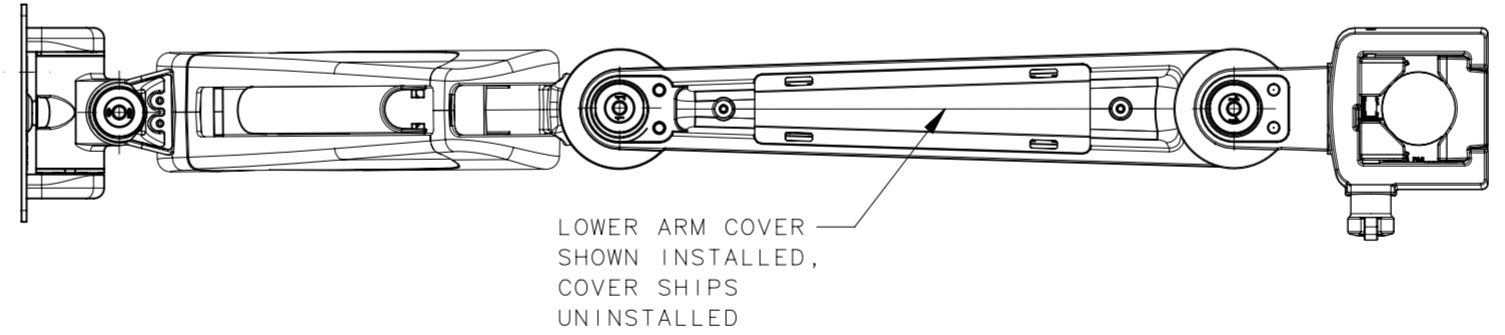

PART NUMBER	REVERSE TILT TORQUE N*m (lbf*in)	FORWARD TILT TORQUE N*m (lbf*in)	DISPLAY SWIVEL SYMMETRIC TORQUE N*m (lbf*in)	SYMMETRIC TORQUE TO MOVE UPPER ARM ASSEMBLY N*m (lbf*in)	SYMMETRIC TORQUE TO MOVE LOWER ARM ASSEMBLY N*m (lbf*in)	RECOMMENDED DISPLAY WEIGHT RANGE	COLOR
AV-D32-79W161-50	7.9 (70)	1.13 (10)	4.29 (38) NOMINAL / 2.17 (19.2) MINIMUM	6.0 (53.1) NOMINAL / 4.2 (37.1) MINIMUM	6.0 (53.1) NOMINAL / 4.2 (37.1) MINIMUM	2 To 7 kg (4.4 TO 15.4 lbm)	BLACK
AV-D32-79W161-76						OFFICE WHITE	
AV-D32-79W162-50	15.4 (136)	2.26 (20)				5 TO 10 Kg (11 TO 22 lbm)	BLACK
AV-D32-79W162-76						OFFICE WHITE	
AV-D32-79W163-50	8.6 (76)	6.0 (53)				2 To 7 kg (4.4 TO 15.4 lbm)	BLACK
AV-D32-79W163-76						OFFICE WHITE	

THIRD ANGLE PROJECTION

MILLIMETERS [IN]

TOLERANCES UNLESS OTHERWISE NOTED

ALL DIMENSIONS WITHOUT TOLERANCES ARE FOR REFERENCE ONLY.

PROPRIETARY ITEM EXCEPT FOR USES EXPRESSLY GRANTED IN WRITING. INFORMATION DISCLOSED HEREON IS CONFIDENTIAL AND ALL RIGHTS, PATENT AND OTHERWISE, ARE RESERVED BY SOUTHCO, INC.

PER ASME Y14.5M-1994

DRAWN BY: DMS/GEA

DATE: 10MAY2018

SCALE: 1:1

SHEET: 1 OF 4

southco
 CONNECT · CREATE · INNOVATE

DESCRIPTION: HINGE & CONTROLLED MOTION DEVICE ARTICULATING FIXED ARM ASSEMBLY POLE MOUNT

SIZE SYSTEM: A2 NX

DWG NO.: J-AV-D32-79W161

ARM DISPLAY WEIGHT ADJUSTMENT

(ARM TO BE ADJUSTED WITH THE DISPLAY MOUNTED)

REVISION HISTORY			
REV	DATE	BY	DESCRIPTION
C	15JUN2020	GEA/DMS	PRN: P2020-1029

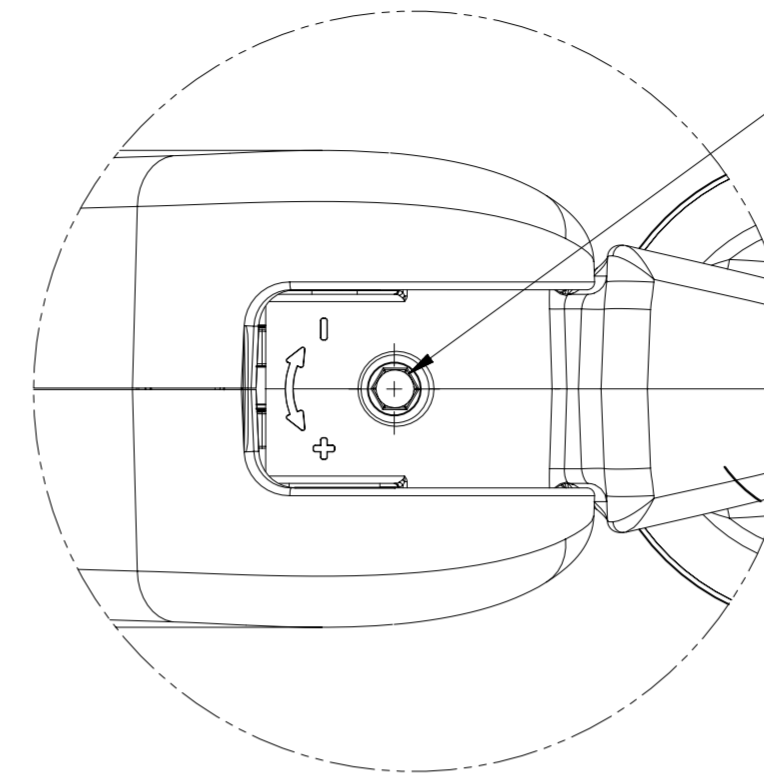
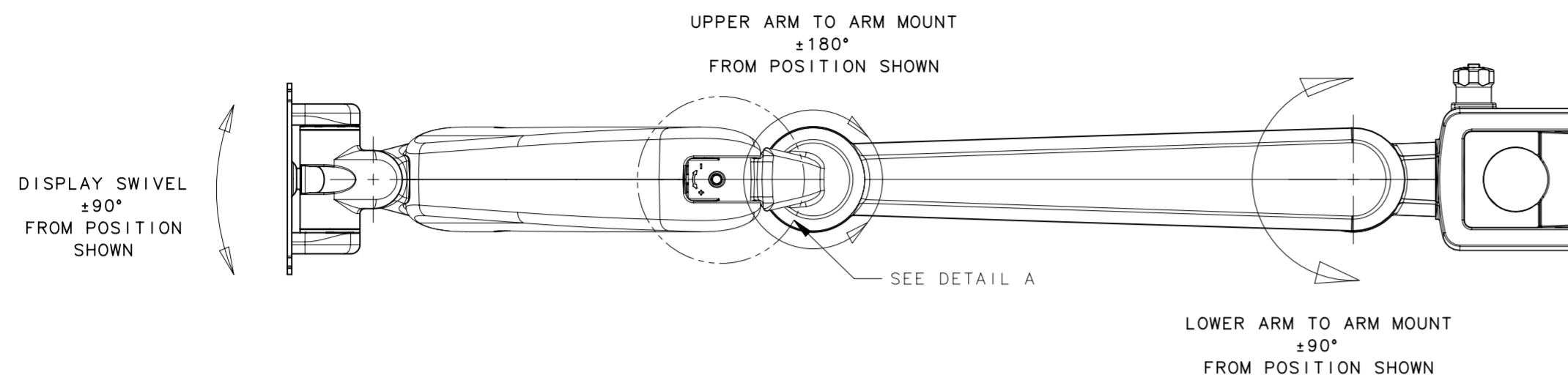

LOWEST ARM POSITION

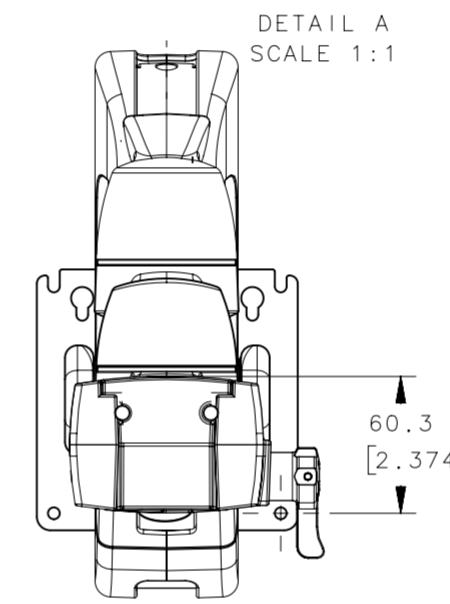
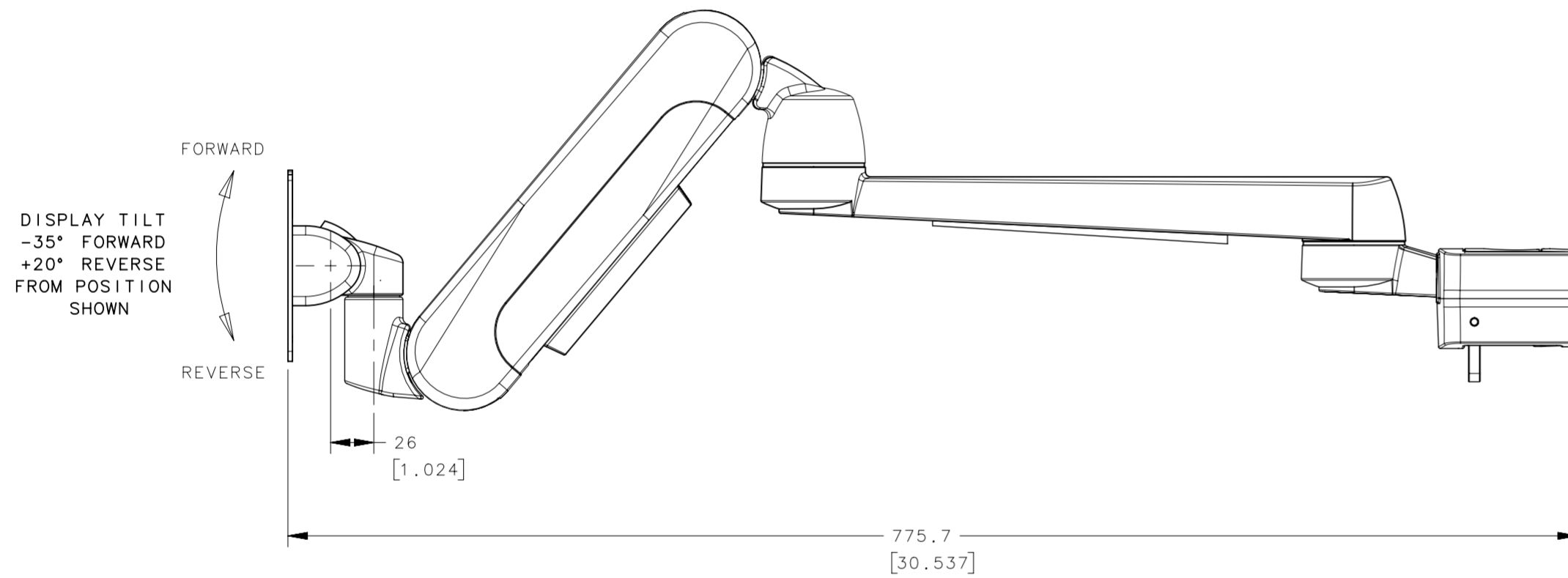

NOTES:

- MATERIALS AND FINISHES:
 ADAPTERS: DIE CAST ALUMINUM, ANODIZED AND POWDER COATED
 LOWER ARM, TILT HOUSING, UPPER KNUCKLE AND LOWER KNUCKLE, ARM ADAPTER AND WALL MOUNT PLATE: DIE CAST ALUMINUM, POWDER COATED
 TILT SLEEVE, THRUST WASHER AND SHELL: ACETAL, BLACK
 COILED PIN: STEEL, PHOSPHATE COATED
 TILT SHAFT, TORQUE ELEMENTS AND STOP WASHER: STEEL, NATURAL FINISH
 TORSION SPRING: CARBON STEEL, NICKEL PLATED (WHEN EQUIPPED)
 DISPLAY SCREWS, WALL MOUNT SCREWS AND RETAINERS: STEEL, BLACK OXIDE
 DISPLAY STOPS: POLYETHYLENE, WHITE
 LINK BUSHING AND STRUT ADJUST BUSHING: BRASS, NATURAL
 LINK FLANGED SLEEVE: STEEL, TEFLON COATED
 STRUT PIN: STAINLESS STEEL
 STRUT ADJUST ADAPTER: ZINC, NICKEL PLATED
 GAS SPRING: STEEL AND ZINC, PAINTED
 ARM LINKS, STRUT BALL MOUNT: STEEL, ZINC PLATED
 ARM PIVOT SHAFTS: STAINLESS STEEL AND NYLON
 LINK PINS: STEEL, NICKEL PLATED
 ARM COVERS, WALL MOUNT FRONT COVERS, LOWER ARM COVER AND WIRE CHANNEL: PC/ABS
 WASHERS (WALL MOUNT PLATE): STEEL, ZINC PLATED
 LUBRICANT: HYDROCARBON BASE
 POLE MOUNT: DIE CAST ALUMINUM, ANODIZED AND POWDER COATED
 POLE MOUNT INSERT: DIE CAST ALUMINUM, ANODIZED AND POWDER COATED, ROD: EPDM, BLACK
 POLE MOUNT COVER: NYLON, BLACK OR OFFICE WHITE

HORIZONTAL ARM POSITION

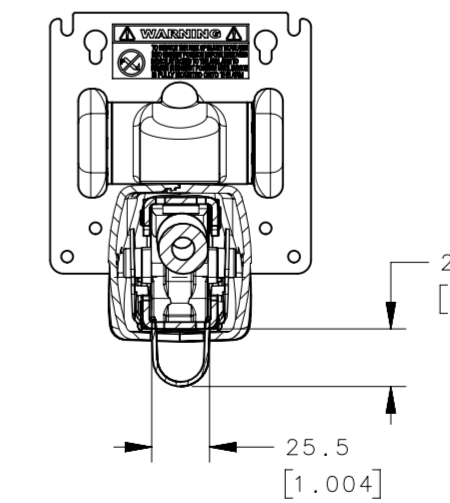
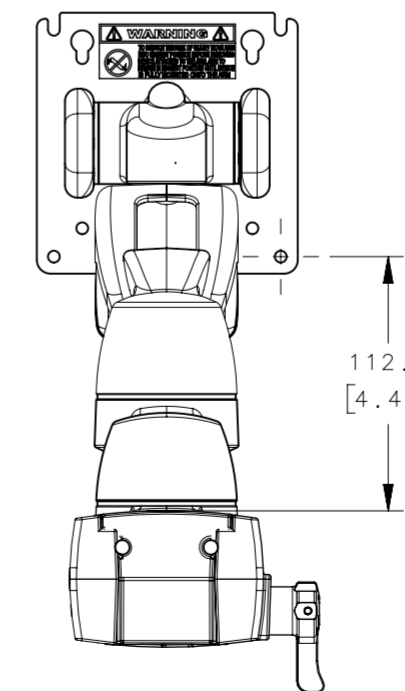
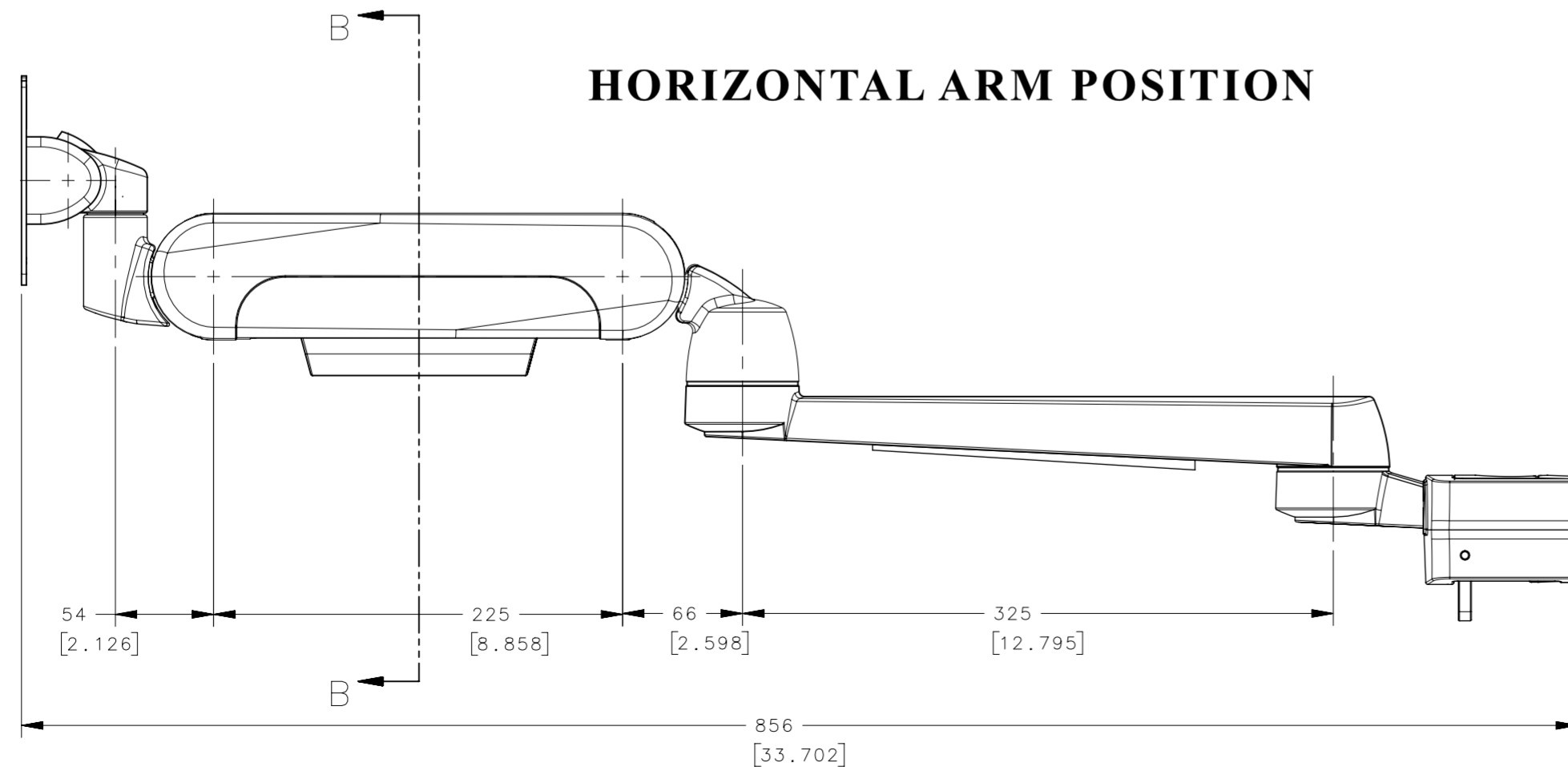

THIRD ANGLE PROJECTION		 CONNECT · CREATE · INNOVATE	
MILLIMETERS [IN]			
SURFACE AREA		DESCRIPTION	
VOLUME		HINGE & CONTROLLED MOTION DEVICE	
PROPRIETARY ITEM		ARTICULATING FIXED ARM ASSEMBLY POLE MOUNT	
EXCEPT FOR USES EXPRESSLY GRANTED IN WRITING, INFORMATION DISCLOSED HEREON IS CONFIDENTIAL AND ALL RIGHTS, PATENT AND OTHERWISE, ARE RESERVED BY SOUTHCO, INC.		SIZE SYSTEM	DWG NO.
PER ASME Y14.5M-1994		A2 NX	J-AV-D32-79W161
DRAWN BY		DATE	SCALE SHEET
DMS/GEA		10MAY2018	1:1 2 OF 4

MOUNT ARM TO POLE

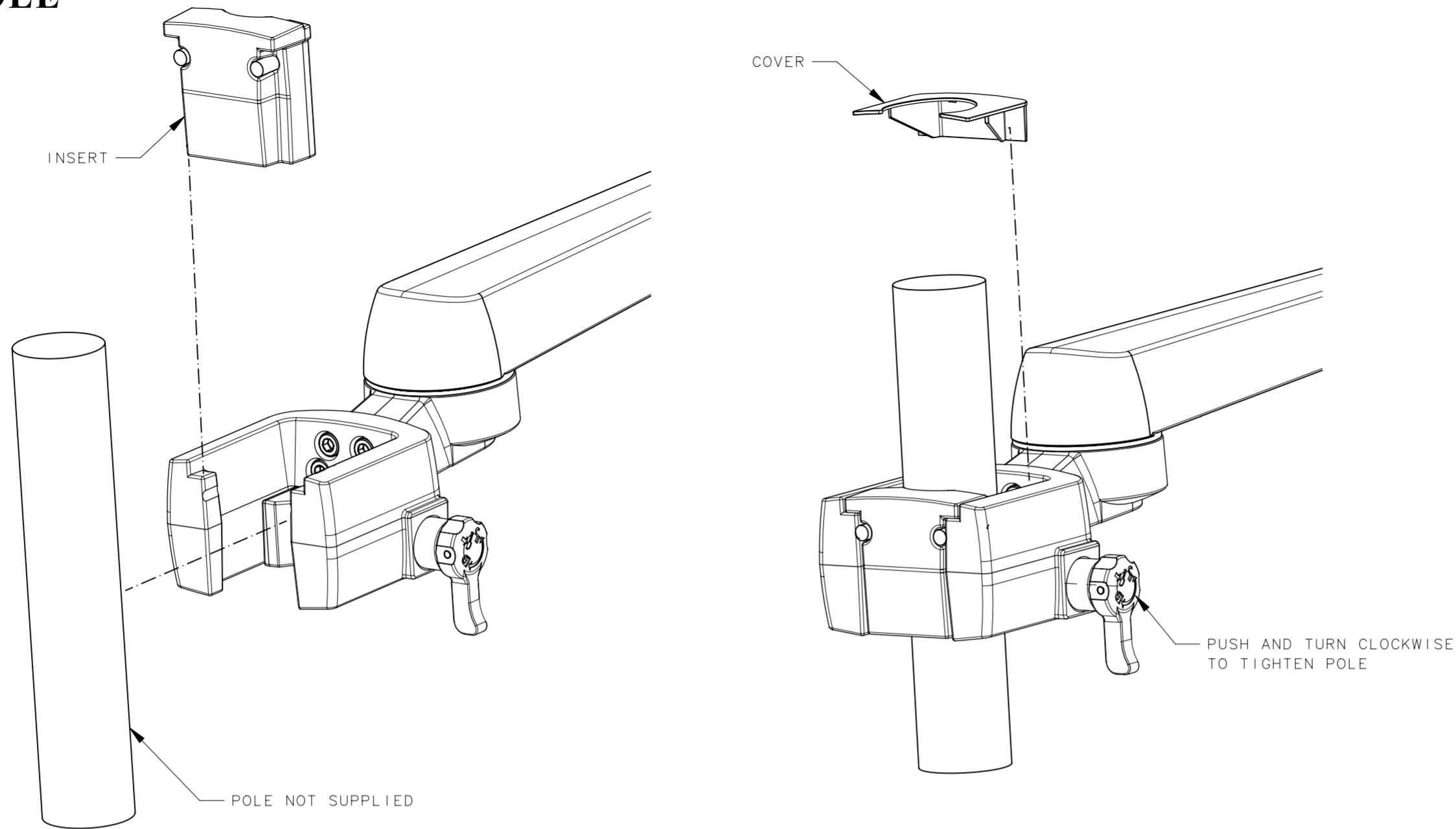

REVISION HISTORY			
REV	DATE	BY	DESCRIPTION
C	15JUN2020	GEA/DMS	PRN: P2020-1029

REFER TO TABLE ON SHEET 1 FOR RECOMMENDED DISPLAY WEIGHT RANGE

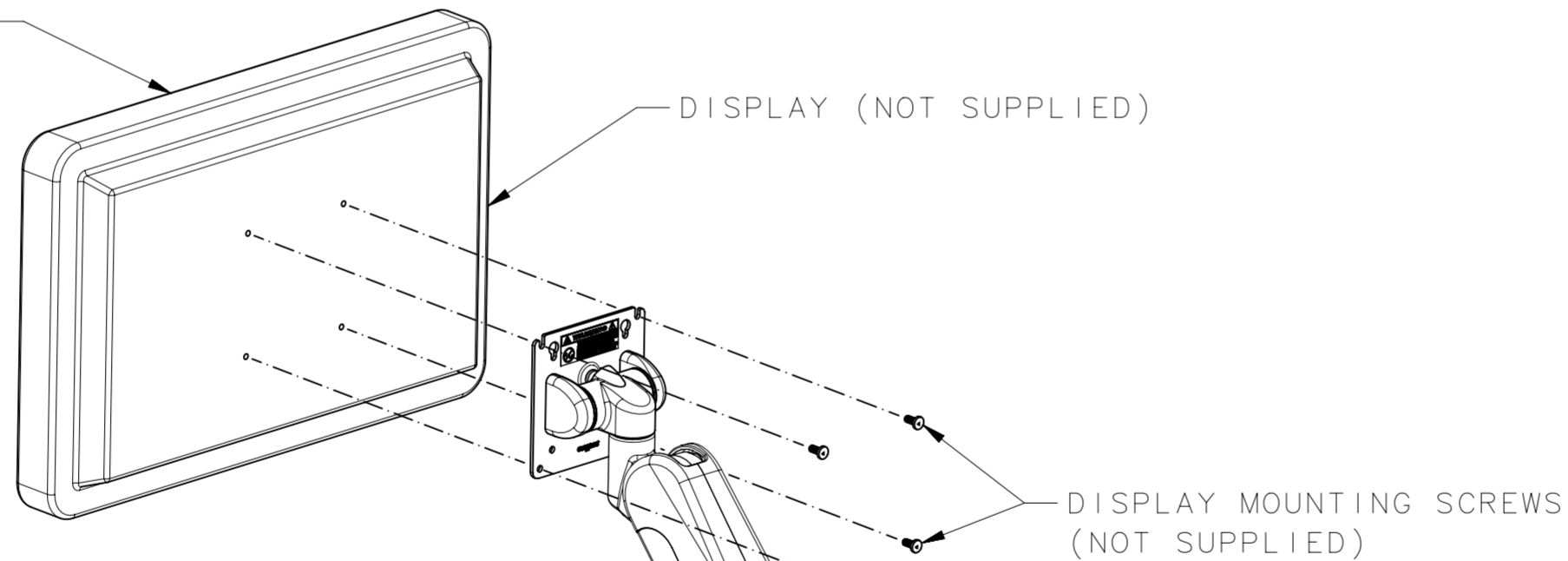

INSTALL DISPLAY WITH THE ARM IN THE HIGHEST POSITION

NOTE: SEE SHEET 2 OF 4 FOR ARM ADJUSTMENT PROCEDURE TO ADJUST FOR WEIGHT OF DISPLAY WHEN INSTALLED.

INSTALL DISPLAY ONTO ARM

- INSTALLATION INSTRUCTIONS:
1. INSERT POLE INTO MOUNT.
 2. DROP INSERT BEHIND POLE TO LOCK POLE IN MOUNT.
 3. PLACE TOP COVER INTO POSITION ON TOP OF MOUNT.
 4. PUSH AND TURN KNOB TO LOCK/UNLOCK.
 5. ALIGN AND INSTALL SCREWS WITH DISPLAY.

	THIRD ANGLE PROJECTION	 CONNECT · CREATE · INNOVATE	
	MILLIMETERS [IN]		
SURFACE AREA	TOLERANCES UNLESS OTHERWISE NOTED	DESCRIPTION	HINGE & CONTROLLED MOTION DEVICE ARTICULATING FIXED ARM ASSEMBLY POLE MOUNT
VOLUME	ALL DIMENSIONS WITHOUT TOLERANCES ARE FOR REFERENCE ONLY.	SIZE SYSTEM	
PROPRIETARY ITEM	PER ASME Y14.5M-1994	DWG NO.	J-AV-D32-79W161
EXCEPT FOR USES EXPRESSLY GRANTED IN WRITING, INFORMATION DISCLOSED HEREON IS CONFIDENTIAL AND ALL RIGHTS, PATENT AND OTHERWISE, ARE RESERVED BY SOUTHCO, INC.		DRAWN BY	DMS/GEA
		DATE	10MAY2018
		SCALE	1:1
		SHEET	3 OF 4

8

7

6

5

4

3

2

1

REVISION HISTORY			
REV	DATE	BY	DESCRIPTION
C	15JUN2020	GEA/DMS	PRN: P2020-1029

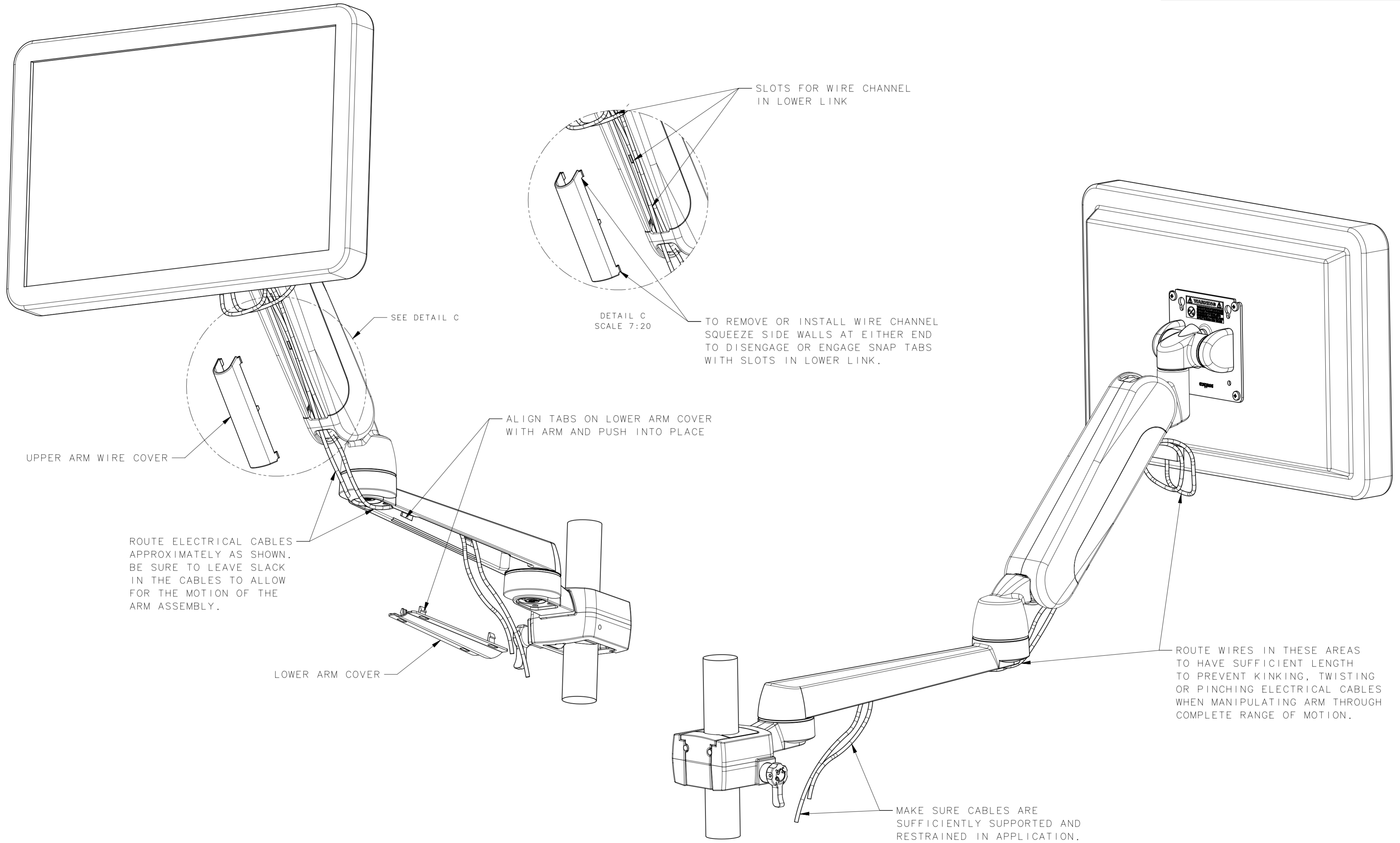

F

E

D

C

B

A

F

E

D

C

B

A

THIRD ANGLE PROJECTION				southco CONNECT · CREATE · INNOVATE	
MILLIMETERS [IN]					
SURFACE AREA		TOLERANCES UNLESS OTHERWISE NOTED		DESCRIPTION	
VOLUME		ALL DIMENSIONS WITHOUT TOLERANCES ARE FOR REFERENCE ONLY.		HINGE & CONTROLLED MOTION DEVICE ARTICULATING FIXED ARM ASSEMBLY POLE MOUNT	
PROPRIETARY ITEM		PER ASME Y14.5M-1994		SIZE SYSTEM A2 NX	
EXCEPT FOR USES EXPRESSLY GRANTED IN WRITING, INFORMATION DISCLOSED HEREON IS CONFIDENTIAL AND ALL RIGHTS, PATENT AND OTHERWISE, ARE RESERVED BY SOUTHCO, INC.		DRAWN BY DMS/GEA		DATE 10MAY2018	
		SCALE 0.35:1		SHEET 4 OF 4	

8

7

6

5

4

3

2

1