

8

7

6

5

4

3

2

1

REVISION HISTORY

REV	DATE	BY	DESCRIPTION
E	03AUG2022	JEM/AJT	PRN: P2022-1383

NOTES

- A. MATERIAL AND FINISH
- HOUSING, LEVER, KEEPER (BLACK FOR ALL VARIANTS), AND LOCKPLUG: DIECAST ZINC, POWDERCOATED
 - BUTTON: (BLACK FOR ALL VARIANTS)
 - NON LOCKING AND AUTO RELOCKING; POLYETHYLENE
 - KEY LOCKING; NYLON
 - SPRINGS: STAINLESS STEEL,
 - SCREW AND HEX NUT: LOW CARBON STEEL, ZINC ALLOY PLATE BRIGHT PLUS SEALER
 - BRACKET: 1010 STEEL, ZINC ALLOY PLATE BRIGHT PLUS SEALER
 - KEYS: BRASS, NICKEL PLATED
- B. PANEL PREPARATION ON SHEET 2
- C. LOCK PLUG INSTALLATION:
- POSITION LOCKPLUG AND ORIENT RETAINING WAFER (LAST WAFER LOCATED AT THE BOTTOM OF LOCK) AT THE 3 O'CLOCK POSITION AND INSERT INTO THE BUTTON.
 - ENSURE THE LOCK PLUG IS FULLY SEATED AGAINST THE BUTTON, THEN REMOVE KEY
- D. FOR LAYER PACKED, [P]=3, FULL BOX QUANTITY IS 40PCS / BOX

C2-5 G - L F - P

[G] GRIP_RANGE
 2 STANDARD 1-18mm
 3 EXTENDED 18-40mm

[F] FINISH
 1 BRIGHT CHROME
 5 BLACK POWDERCOAT

[P] PACKAGING
 3 LAYER PACKED
 OMIT FOR INDIVIDUALLY PACKAGED

[L] LOCK_STYLE

1	NON LOCKING,	RAISED TRIGGER
2	KEY LOCKING CH751,	RAISED TRIGGER
22	KEY LOCKING CH751,	RAISED TRIGGER (KEY RETAINED IN UNLOCKED POSITION)
4	4mm HEX RECESS,	RAISED TRIGGER
10	No2 PHILIPS,	RAISED TRIGGER
13	WITHOUT LOCKCORE,	RAISED TRIGGER
14	RAILWAY STANDARD,	RAISED TRIGGER
15	8mm HEX RECESS,	RAISED TRIGGER
16	SLOTTED RECESS,	RAISED TRIGGER
34	AUTO RELOCK, 4mm HEX RECESS,	FLUSH TRIGGER
310	AUTO RELOCK, No2 PHILIPS,	FLUSH TRIGGER
314	AUTO RELOCK, RAILWAY STANDARD,	FLUSH TRIGGER
315	AUTO RELOCK, 8mm HEX RECESS,	FLUSH TRIGGER
316	AUTO RELOCK, SLOTTED RECESS,	FLUSH TRIGGER

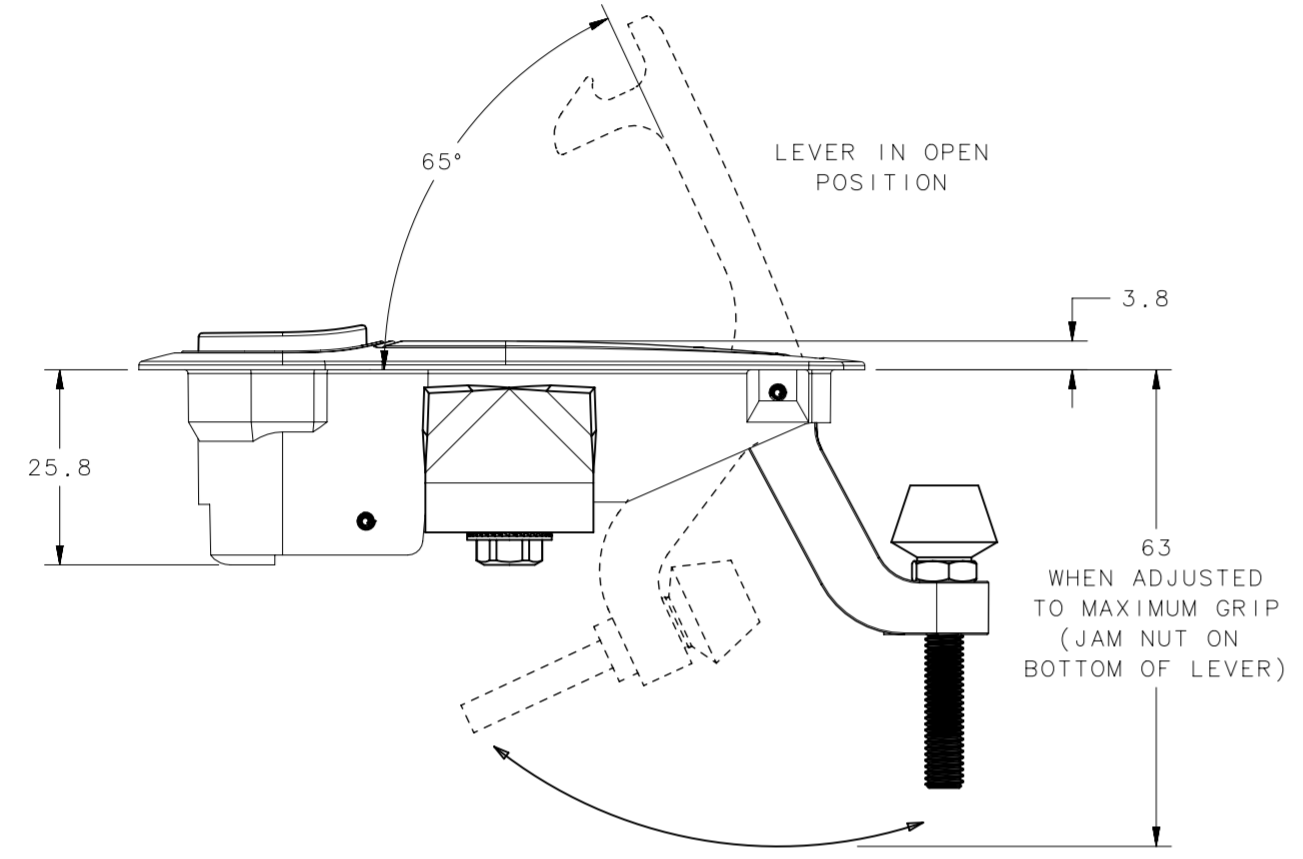
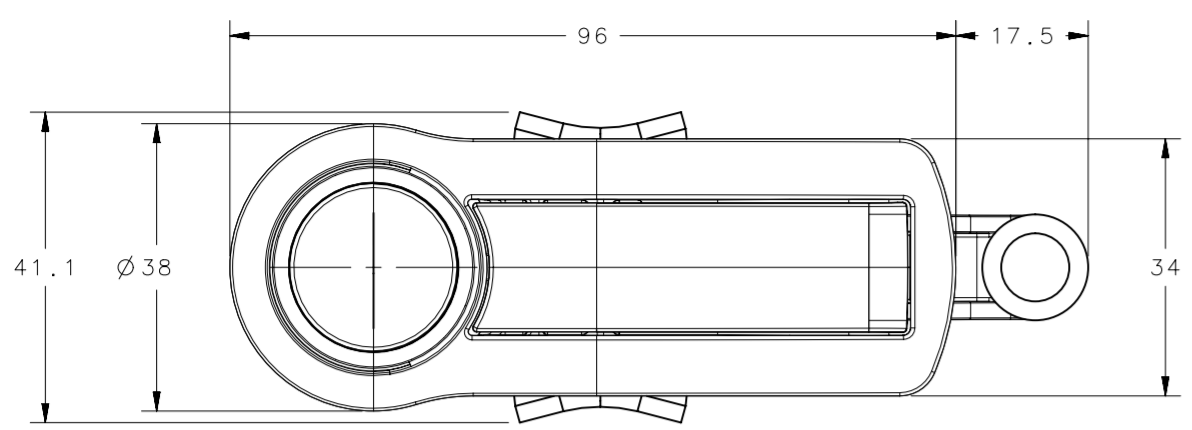

STANDARD LEVER
NON LOCKING LATCH SHOWN

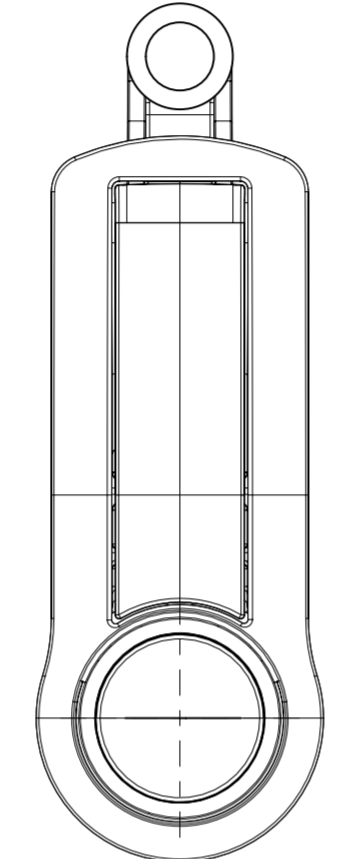

NON LOCKING

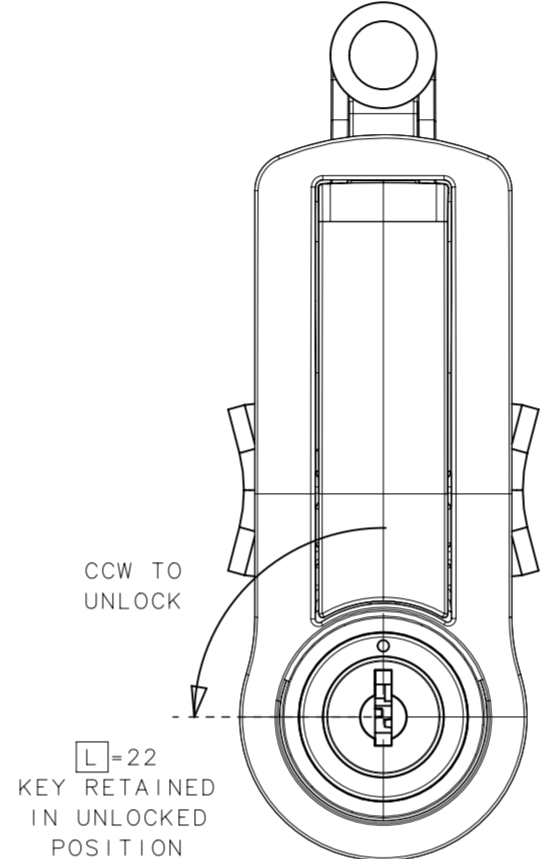
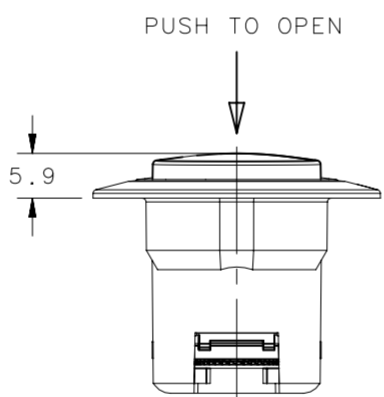

LOCKING
KEY LOCKING
OR TOOL ACCESS

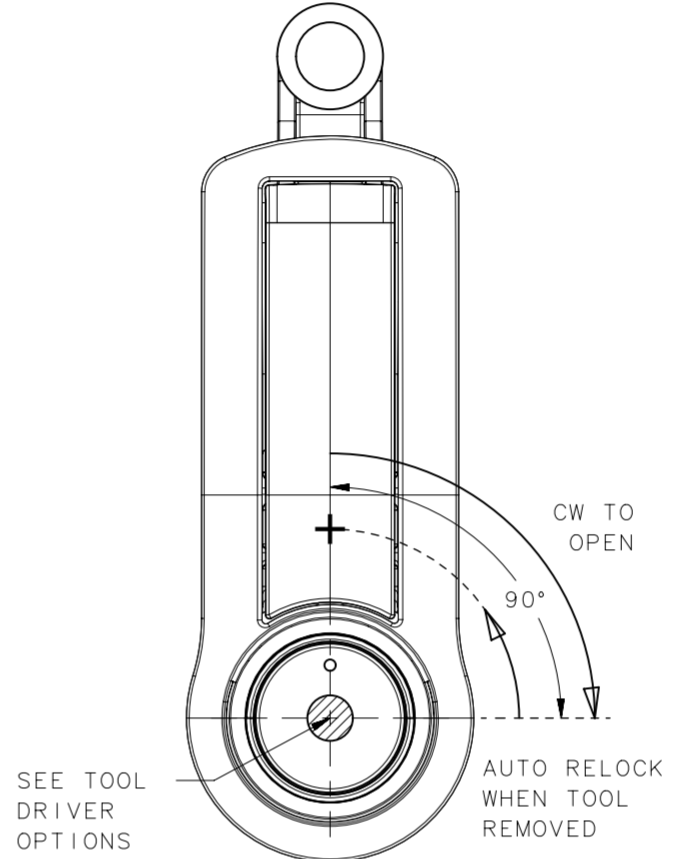
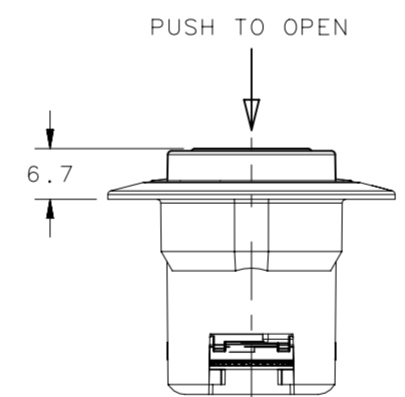

AUTO RELOCKING
TOOL ACCESS

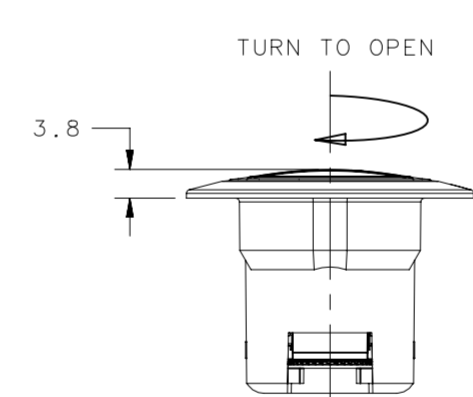

TOOL DRIVER OPTIONS

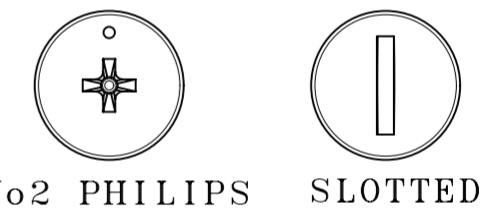
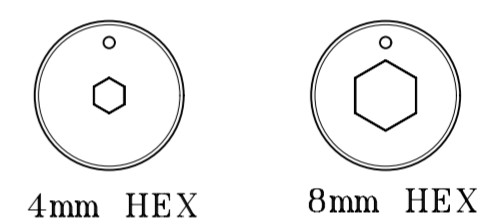

KEY LOCKING

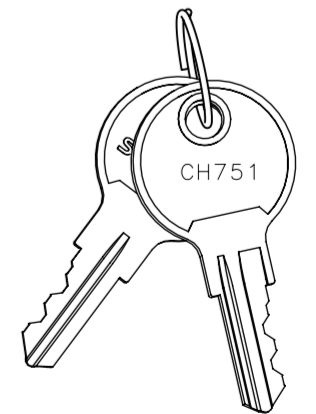

2 KEYS INCLUDED
KEY LOCKING ONLY

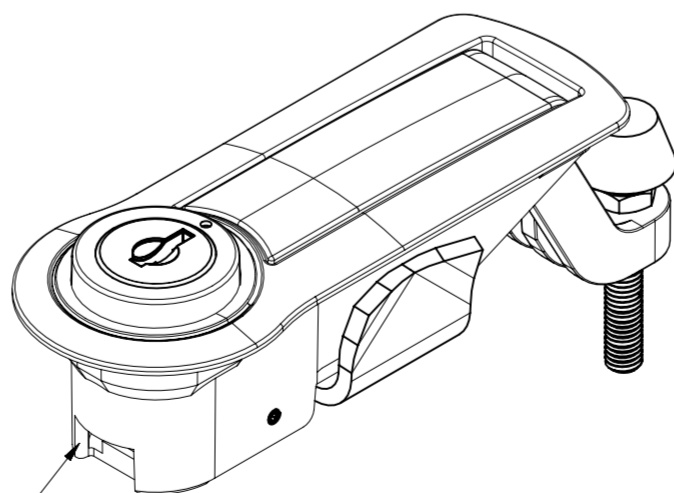

DEBRIS DRAINAGE FEATURE
ISO VIEW
LOCKING VERSION SHOWN
SCALE 1:1

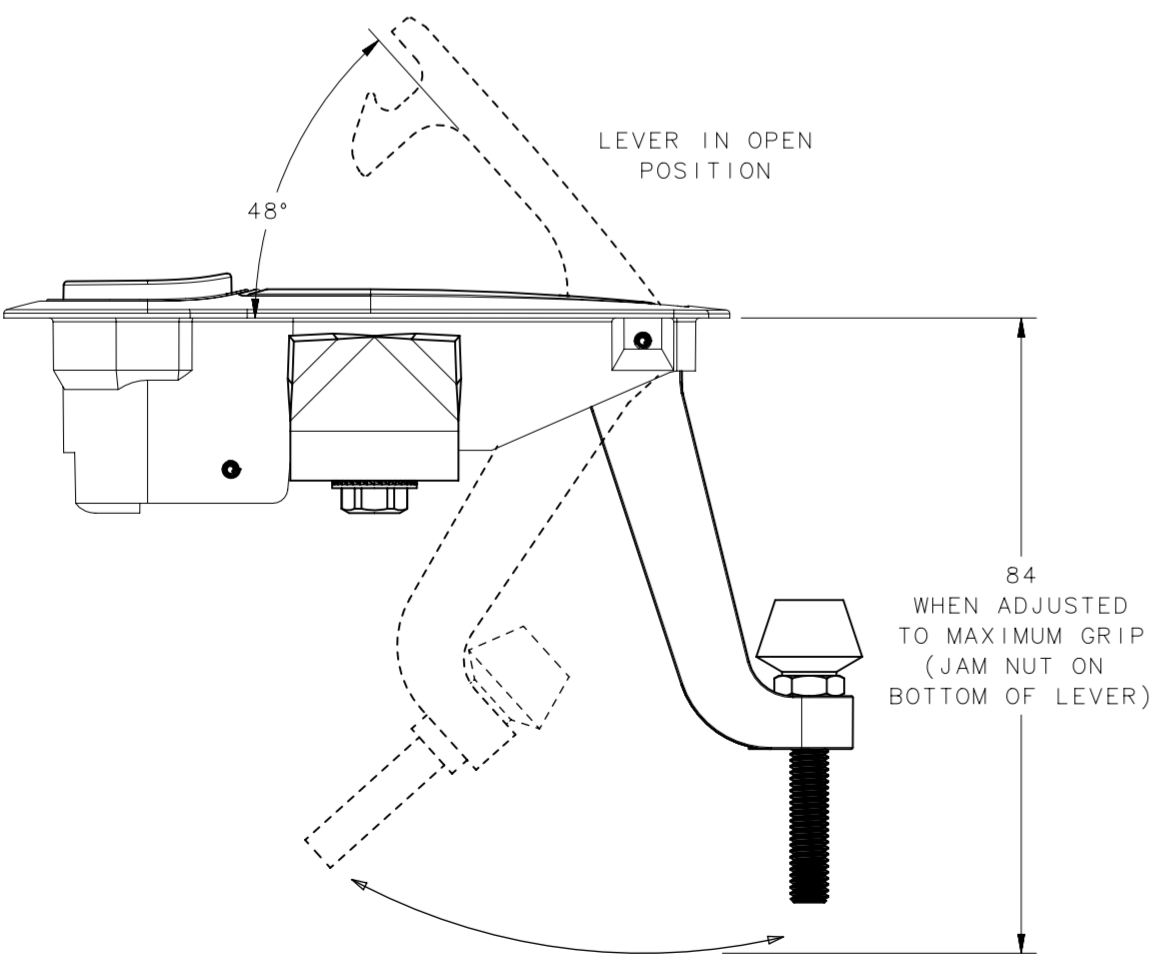

EXTENDED LEVER
NON LOCKING LATCH SHOWN

THIRD ANGLE PROJECTION		 CONNECT · CREATE · INNOVATE	
MILLIMETERS [IN]			
TOLERANCES UNLESS OTHERWISE NOTED		DESCRIPTION	
UP TO 0.5	+0.1	C2 COMPRESSION LATCH	
OVER 0.5 UP TO 6	+0.2		
OVER 6 UP TO 30	+0.4		
OVER 30	+0.6		
ANGLES	+5°		
PROPRIETARY ITEM EXCEPT FOR USES EXPRESSLY GRANTED IN WRITING, INFORMATION DISCLOSED HEREON IS CONFIDENTIAL AND ALL RIGHTS, PATENT AND OTHERWISE, ARE RESERVED BY SOUTHCO, INC.		SIZE SYSTEM	DWG NO.
PER ASME Y14.5M-1994		A2 NX	J-C2-5
DRAWN BY		DATE	SCALE
JEM		15JUN2017	1:1
		SHEET	1 OF 2

8

7

6

5

4

3

2

1

REVISION HISTORY			
REV	DATE	BY	DESCRIPTION
E	03AUG2022	JEM/AJT	PRN: P2022-1383

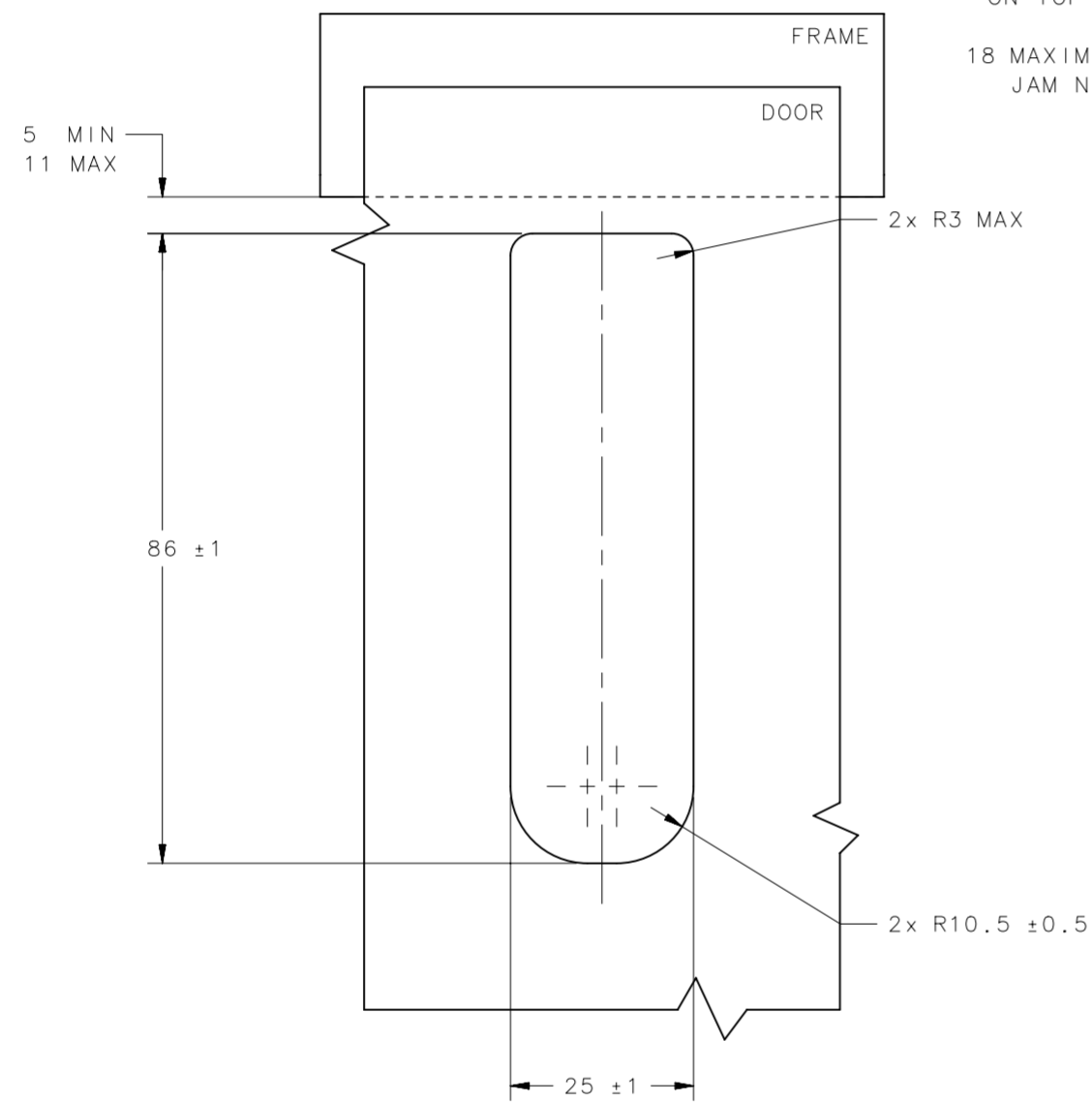

PANEL PREPARATION

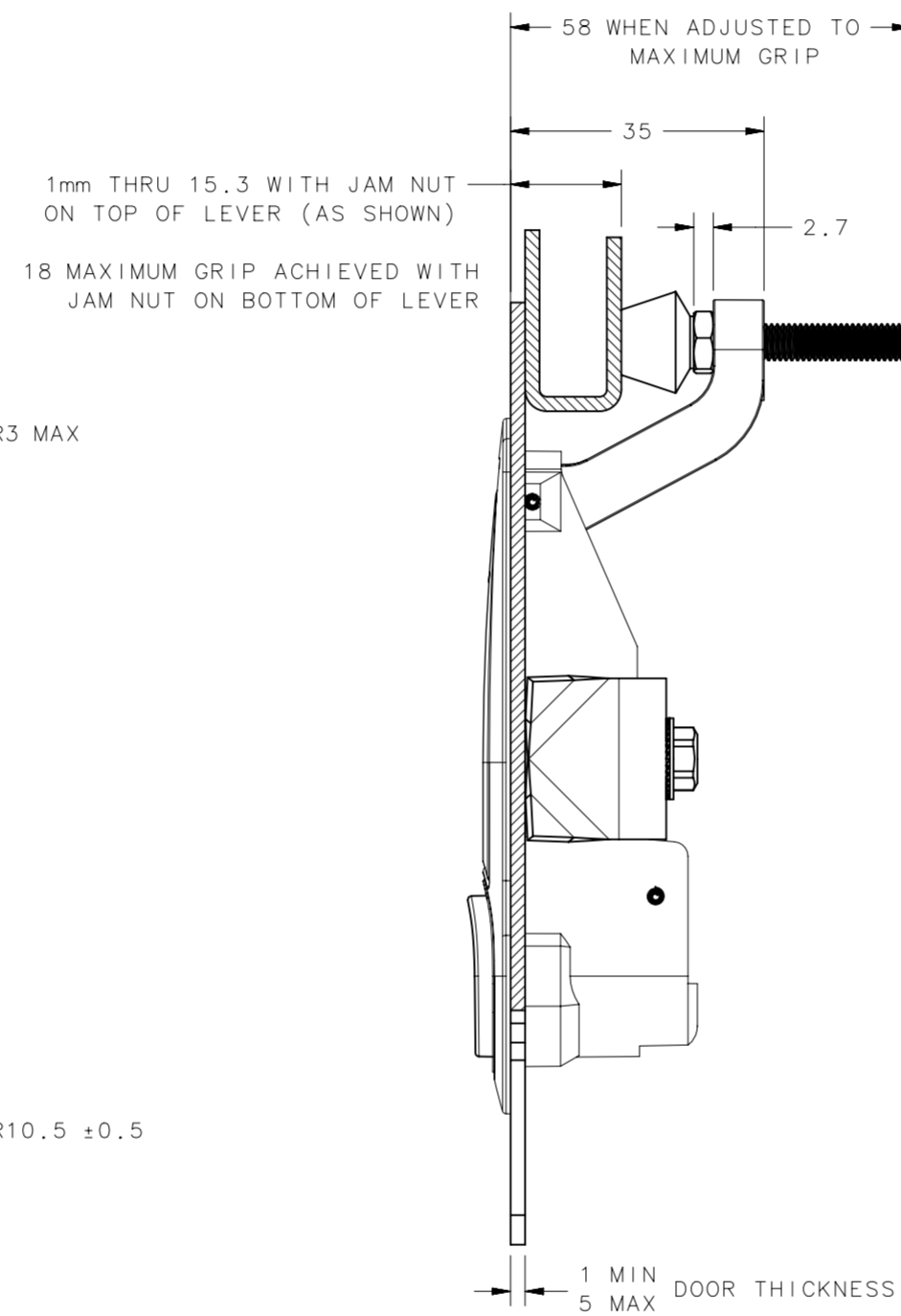

STANDARD GRIP

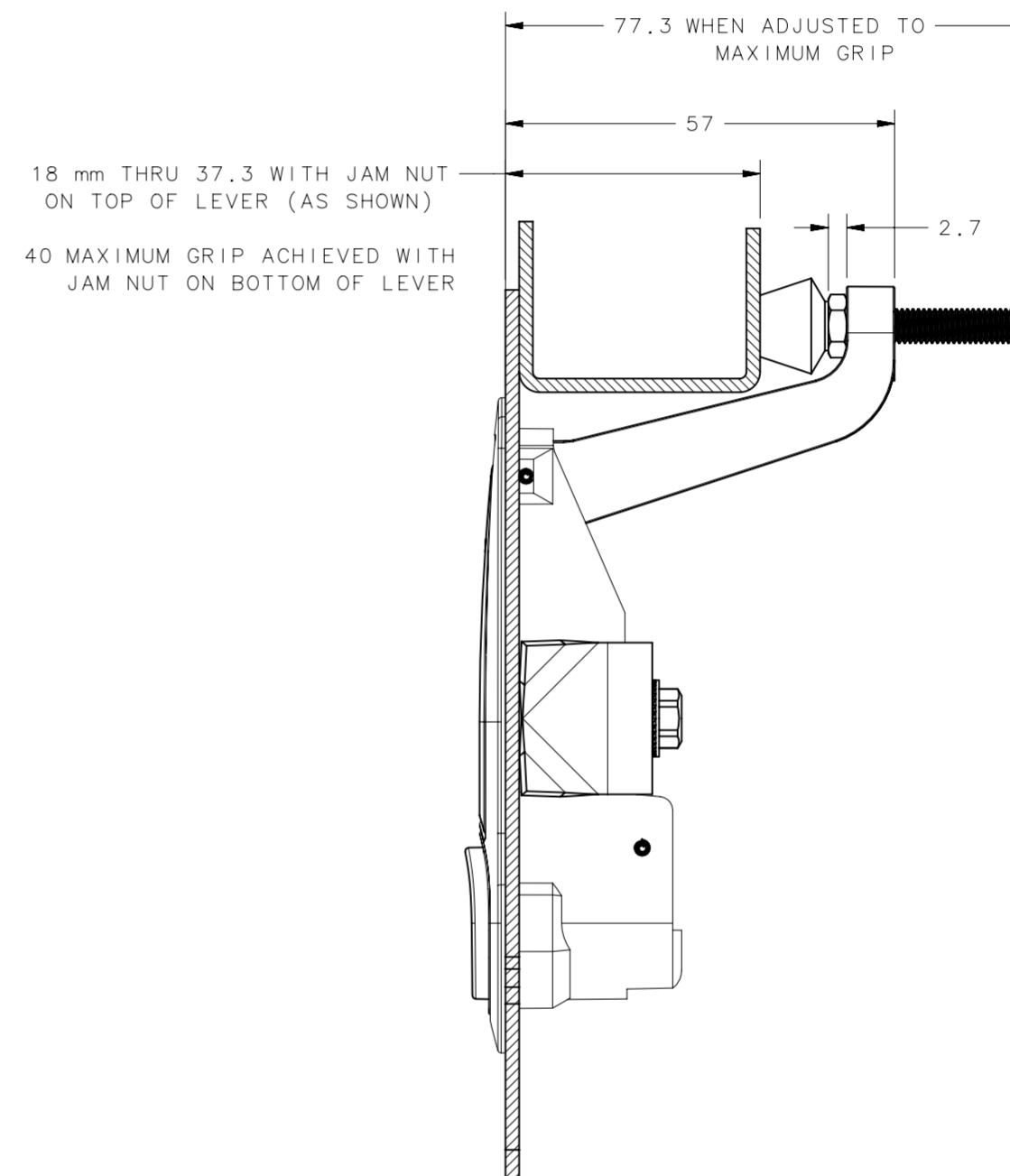

EXTENDED GRIP

THIRD ANGLE PROJECTION				southco CONNECT · CREATE · INNOVATE	
MILLIMETERS [IN]					
TOLERANCES UNLESS OTHERWISE NOTED		DESCRIPTION		C2 COMPRESSION LATCH	
UP TO 0.5 ±0.1		SIZE		A2	
OVER 0.5 UP TO 6 ±0.2		SYSTEM		NX	
OVER 6 UP TO 30 ±0.4		DWG NO.		J-C2-5	
OVER 30 ±0.6		DRAWN BY		JEM	
ANGLES ±5°		DATE		15JUN2017	
PER ASME Y14.5M-1994		SCALE		1:1	
<small>PROPRIETARY ITEM EXCEPT FOR USES EXPRESSLY GRANTED IN WRITING, INFORMATION DISCLOSED HEREON IS CONFIDENTIAL AND ALL RIGHTS, PATENT AND OTHERWISE, ARE RESERVED BY SOUTHCO, INC.</small>		SHEET		2 OF 2	

8

7

6

5

4

3

2

1