

Ø 9.5
No. 2 PHILLIPS RECESS

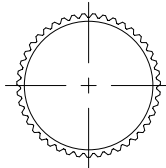

NO RECESS

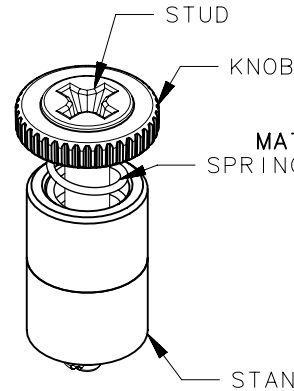

MATERIALS AND FINISH: RoHS COMPLIANT
 STUD : STEEL, HARDENED, ZINC PLATE PLUS SEALER
 STANDOFF : 6000 SERIES ALUMINUM, NATURAL
 KNOB : PC/ABS UL94-V0 RATED, FLAME RETARDANT;
 TRIARYLPHOSPHATE (DOES NOT CONTAIN BROMINATED, CHLORINATED, OR HALOGEATED ADDITIVES).
 SPRING: MUSIC WIRE, ZINC PLATE

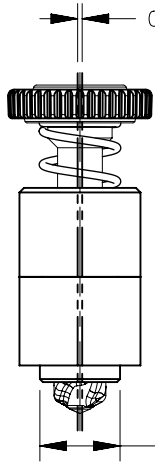

UNFASTENED

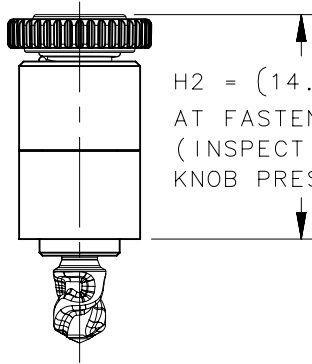

FASTENED

0.3 TOTAL FLOAT OF STUD IN STANDOFF

H2 = (14.8)
 AT FASTENED POSITION
 (INSPECTION HEIGHT = 14.2
 KNOB PRESSED TO END)

Ø 5.3

ASSEMBLY PART NUMBER

D9-52-33A₃B-KEEE

- A₁ - INSTALL _____
- 1 = 0.9 - 1.2 PANEL ("A")
- A₂ - STUD OD _____
- 3 = Ø 3.5 STUD OD
- A₃ - RECESS _____
- 0 = NO RECESS
- 1 = No. 2 PHILLIPS
- B - STUD LENGTH _____
- 1
- 2
- 3
- 4

- EEE - KNO COLOR
- 000 = BLACK
- SEE J-47-0-3 FOR ADDITIONAL COLORS
- K - KNO STYLE
- K = KNURLED

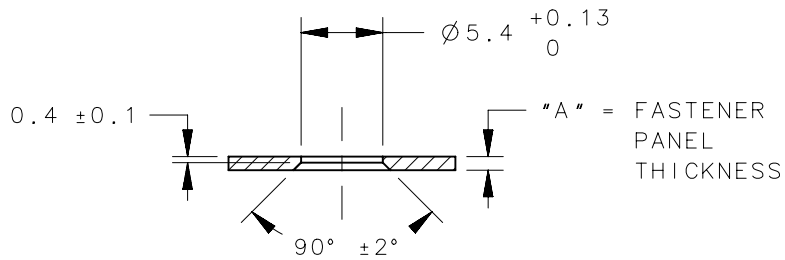

FASTENER PANEL PREPARATION

TO INSTALL FASTENER:

1. DRILL THEN COUNTERSINK A PANEL HOLE PER PANEL PREPARATION VIEW.
2. INSERT FASTENER AND FLARE INTO PANEL USING TOOL PART NUMBER 47-106.

	THIRD ANGLE PROJECTION
	MILLIMETERS [IN]
	TOLERANCES UNLESS OTHERWISE NOTED
	ALL DIMENSIONS WITHOUT TOLERANCES ARE FOR REFERENCE ONLY.
PROPRIETARY ITEM EXCEPT FOR USES EXPRESSLY GRANTED IN WRITING, INFORMATION DISCLOSED HEREON IS CONFIDENTIAL AND ALL RIGHTS, PATENT AND OTHERWISE, ARE RESERVED BY SOUTHCO, INC.	PER ASME Y14.5M-1994

D9-52-33AB-KEEE		FASTENER ASSEMBLY	
PART NUMBER		TYPE OF COMPONENT	
southco [®] CONNECT • CREATE • INNOVATE			
DESCRIPTION QUICK ACCESS FASTENER(OVER-MOLD) D9-52 FLARE-IN STYLE, 3.5 STUD SIZE			
SIZE A4	SYSTEM NX	DWG NO. J-D9-52-33-KEEE	
DRAWN BY ER	DATE 24JAN2019	SCALE 2:1	SHEET 1 OF 3

REVISION HISTORY			
REV	DATE	BY	DESCRIPTION
C	20NOV2019	ER/LC	PRN: P2019-2850

LENGTH 2 STUD SHOWN IN ALL VIEWS

REVISION HISTORY			
REV	DATE	BY	DESCRIPTION
C	20NOV2019	ER/LC	PRN: P2019-2850

WITH SADDLE RECEPTACLE D9-62-11
(ORDER SEPARATELY)
TMT = A+G+3.15

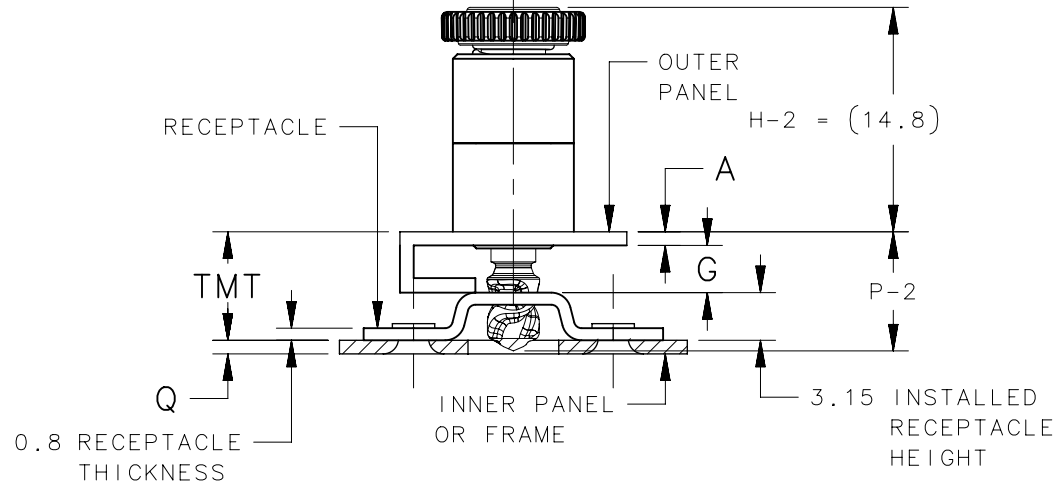

WITH SADDLE RECEPTACLE D9-63-11
(ORDER SEPARATELY)
TMT = A+G+Q

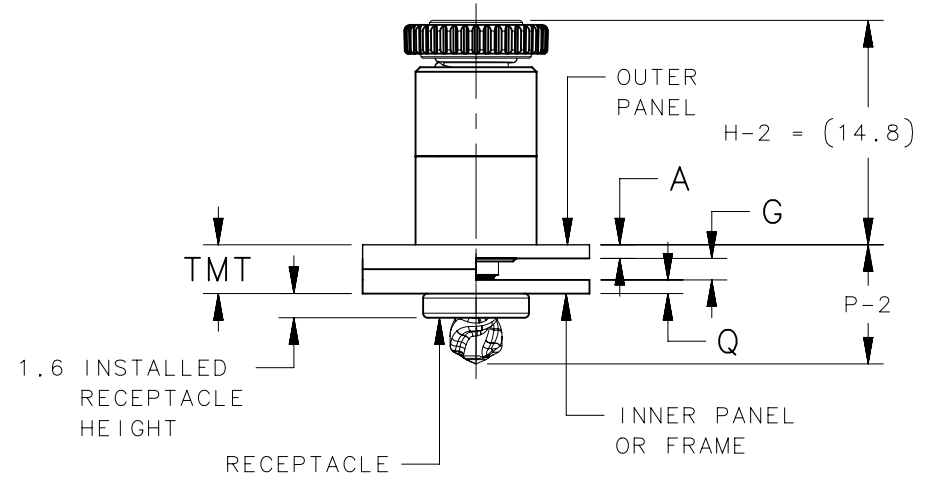

SADDLE STYLE RECEPTACLE						
STUD ASSEMBLY PART NUMBER	STUD LENGTH	(H-1)	P-2 MAX	TMT RANGE		
				MIN.	NOMINAL	MAX.
D9-52-33A1-KEEE	1	18.5	8.3	5.3	6	6.2
D9-52-33A2-KEEE	2	19.5	9.3	6.3	7	7.2
D9-52-33A3-KEEE	3	20.5	10.3	7.3	8	8.2
D9-52-33A4-KEEE	4	21.5	11.3	8.3	9	9.2

SEE J-D9-62 FOR SADDLE RECEPTACLE INFORMATION

PRESS-IN STYLE RECEPTACLE						
STUD ASSEMBLY PART NUMBER	STUD LENGTH	(H-1)	P-2 MAX	TMT RANGE		
				MIN.	NOMINAL	MAX.
D9-52-33A1-KEEE	1	18.5	8.3	1.4	2.1	2.3
D9-52-33A2-KEEE	2	19.5	9.3	2.4	3.1	3.3
D9-52-33A3-KEEE	3	20.5	10.3	3.4	4.1	4.3
D9-52-33A4-KEEE	4	21.5	11.3	4.4	5.1	5.3

SEE J-D9-63 FOR PRESS-IN RECEPTACLE INFORMATION

TMT = TOTAL MATERIAL THICKNESS
A = 0.9 MIN. PANEL THICKNESS
G = GAP
Q = 0.9 MIN. FRAME THICKNESS

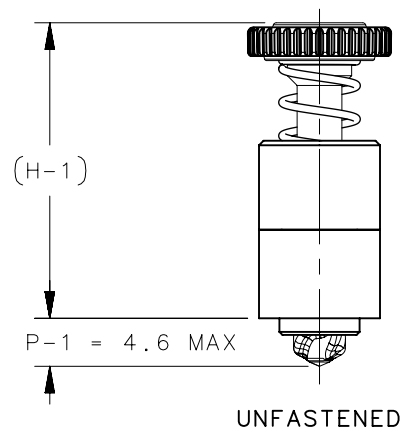

	THIRD ANGLE PROJECTION				
	MILLIMETERS [IN]				
	TOLERANCES UNLESS OTHERWISE NOTED	DESCRIPTION			
	ALL DIMENSIONS WITHOUT TOLERANCES ARE FOR REFERENCE ONLY.	QUICK ACCESS FASTENER(OVER-MOLD) D9-52 FLARE-IN STYLE, 3.5 STUD SIZE			
	PROPRIETARY ITEM	SIZE	SYSTEM	DWG NO.	
	EXCEPT FOR USES EXPRESSLY GRANTED IN WRITING, INFORMATION DISCLOSED HEREON IS CONFIDENTIAL AND ALL RIGHTS, PATENT AND OTHERWISE, ARE RESERVED BY SOUTHCO, INC.	A4	NX	J-D9-52-33-KEEE	
	PER ASME Y14.5M-1994	DRAWN BY	DATE	SCALE	SHEET
		ER	25JAN2019	2:1	2 OF 3

LENGTH 2 STUD SHOWN IN ALL VIEWS

WITH FLAT RECEPTACLE D9-61-11
MOUNTED BELOW PANEL
(ORDER SEPARATELY)

$$TMT = A+G+Q$$

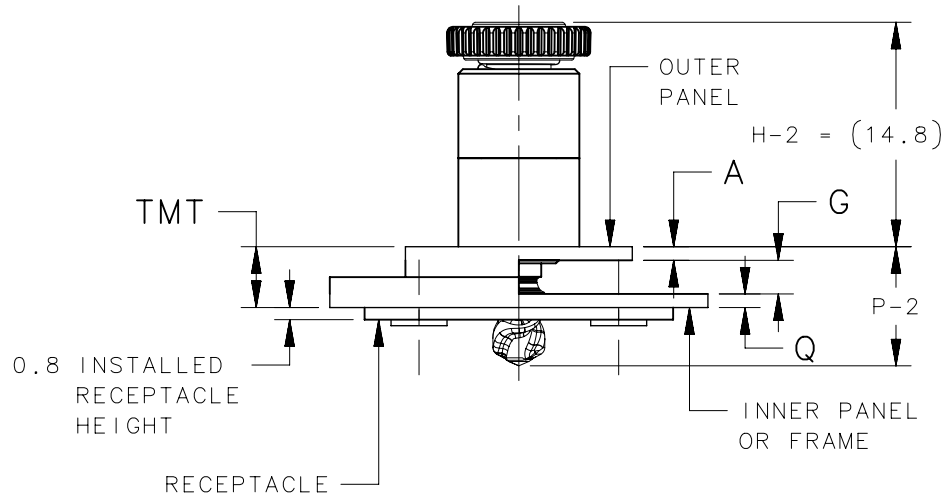

REVISION HISTORY			
REV	DATE	BY	DESCRIPTION
C	20NOV2019	ER/LC	PRN: P2019-2850

WITH FLAT RECEPTACLE D9-61-11
MOUNTED ABOVE PANEL
(ORDER SEPARATELY)

$$TMT = A+G+0.8$$

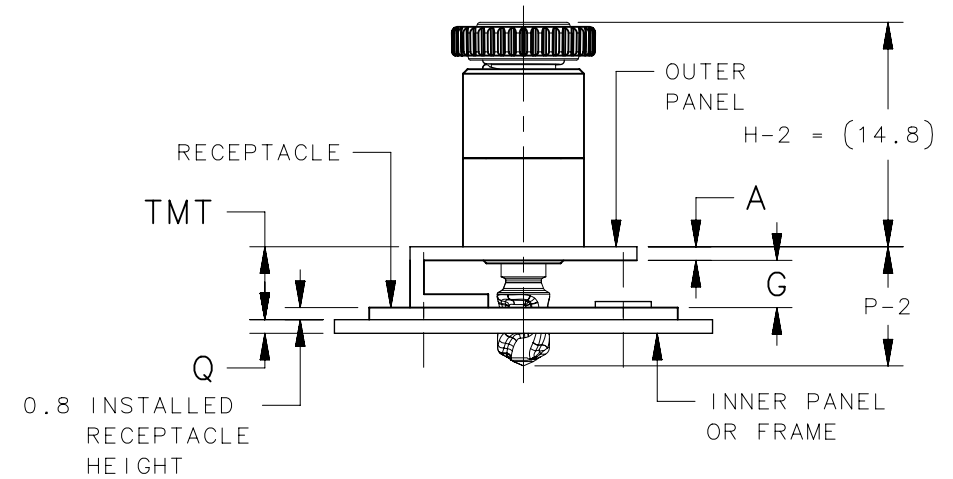

FLAT STYLE RECEPTACLE MOUNTED BELOW PANEL						
STUD ASSEMBLY PART NUMBER	STUD LENGTH	(H-1)	P-2 MAX	TMT RANGE		
				MIN.	NOMINAL	MAX.
D9-52-33A1-KEEE	1	18.5	8.3	2.1	2.8	3
D9-52-33A2-KEEE	2	19.5	9.3	3.1	3.8	4
D9-52-33A3-KEEE	3	20.5	10.3	4.1	4.8	5
D9-52-33A4-KEEE	4	21.5	11.3	5.1	5.8	6

SEE J-D9-61 FOR FLAT RECEPTACLE INFORMATION

FLAT STYLE RECEPTACLE MOUNTED ABOVE PANEL						
STUD ASSEMBLY PART NUMBER	STUD LENGTH	(H-1)	P-2 MAX	TMT RANGE		
				MIN.	NOMINAL	MAX.
D9-52-33A1-KEEE	1	18.5	8.3	2.9	3.6	3.8
D9-52-33A2-KEEE	2	19.5	9.3	3.9	4.6	4.8
D9-52-33A3-KEEE	3	20.5	10.3	4.9	5.6	5.8
D9-52-33A4-KEEE	4	21.5	11.3	5.9	6.6	6.8

SEE J-D9-61 FOR FLAT RECEPTACLE INFORMATION

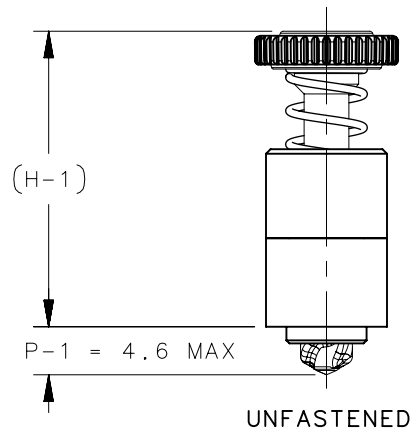

TMT = TOTAL MATERIAL THICKNESS
A = 0.9 MIN. PANEL THICKNESS
G = GAP
Q = 0.9 MIN. FRAME THICKNESS

	THIRD ANGLE PROJECTION			southco [®] CONNECT • CREATE • INNOVATE	
	MILLIMETERS [IN]				
	TOLERANCES UNLESS OTHERWISE NOTED	DESCRIPTION			
	ALL DIMENSIONS WITHOUT TOLERANCES ARE FOR REFERENCE ONLY.	QUICK ACCESS FASTENER(OVER-MOLD) D9-52 FLARE-IN STYLE, 3.5 STUD SIZE			
	PROPRIETARY ITEM	SIZE	SYSTEM	DWG NO.	
	EXCEPT FOR USES EXPRESSLY GRANTED IN WRITING, INFORMATION DISCLOSED HEREON IS CONFIDENTIAL AND ALL RIGHTS, PATENT AND OTHERWISE, ARE RESERVED BY SOUTHCO, INC.	A4	NX	J-D9-52-33-KEEE	
	PER ASME Y14.5M-1994	DRAWN BY	DATE	SCALE	SHEET
		ER	25JAN2019	2:1	3 OF 3