

REVISION HISTORY			
REV	DATE	BY	DESCRIPTION
I	24FEB2018	RKS/DMS	PRN: P2018-0481

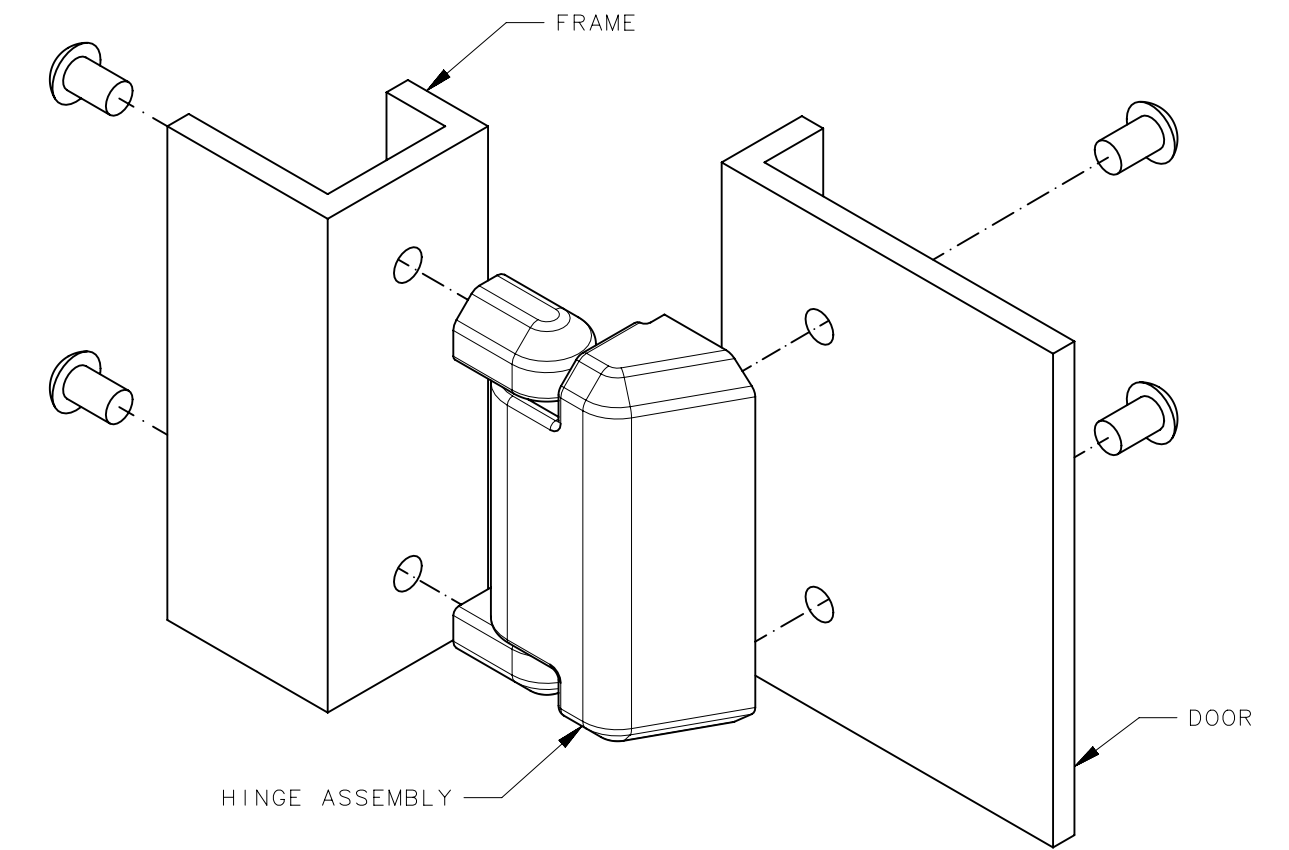

YY	FINISH
20	SATIN CHROME
50	BLACK PAINT
70	SILVER PAINT

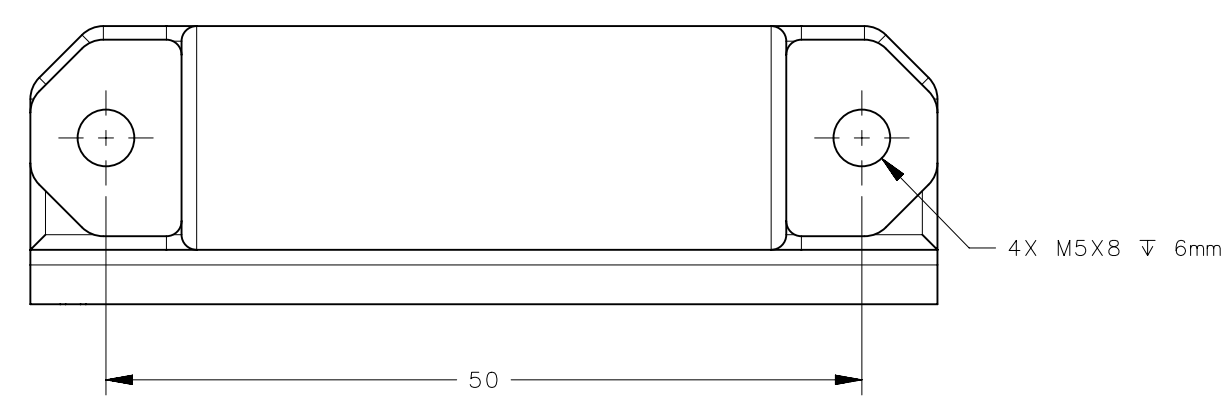
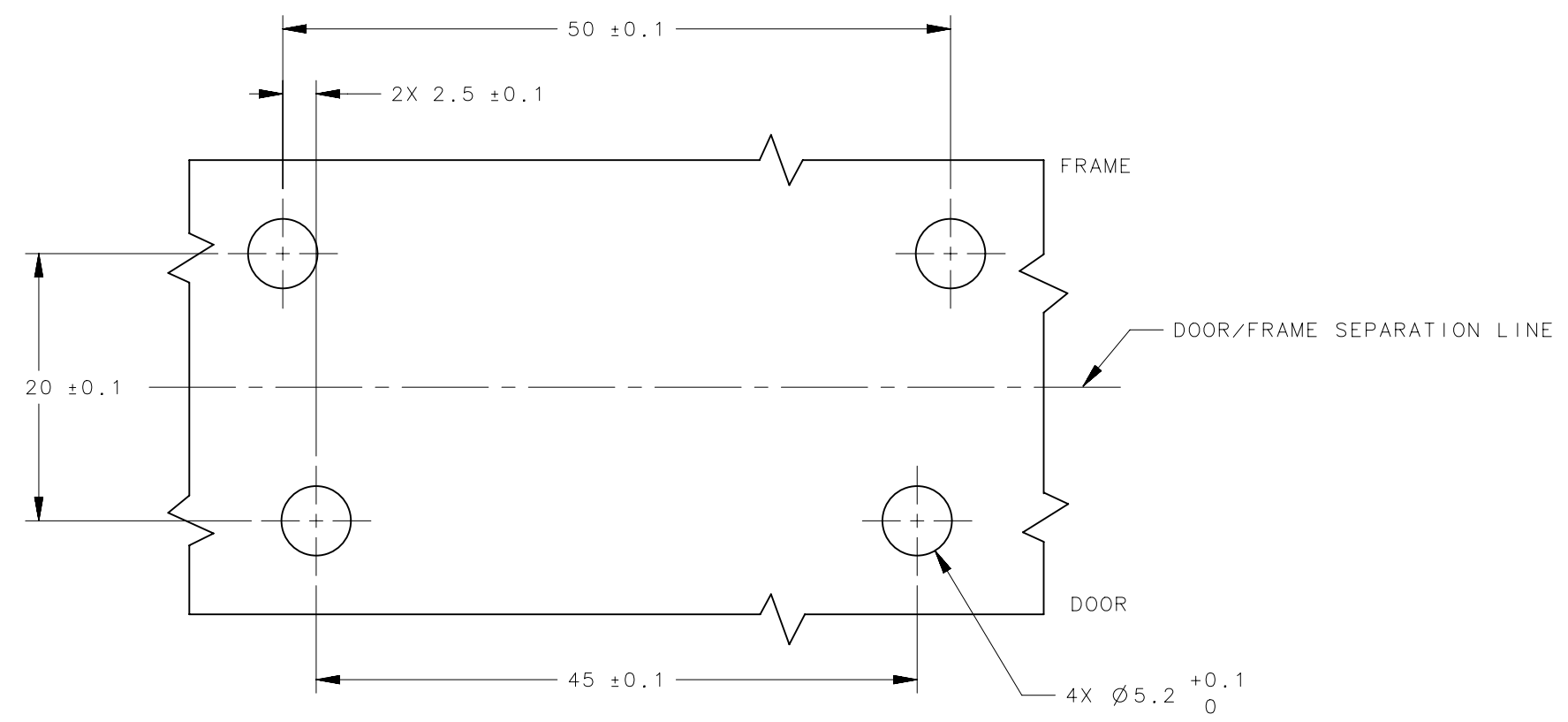
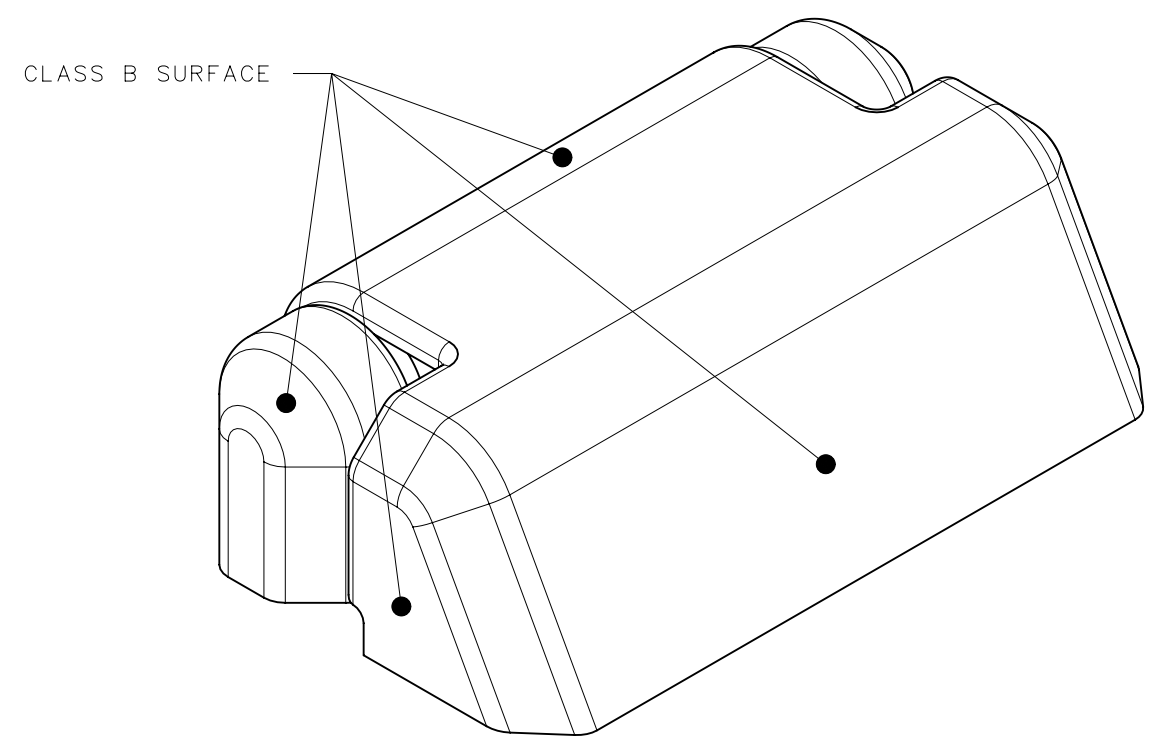
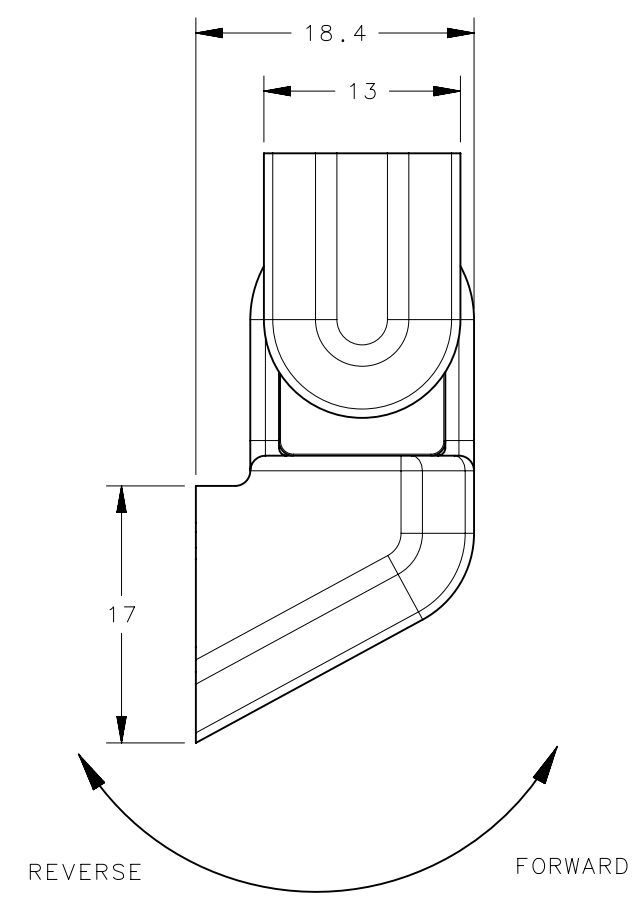
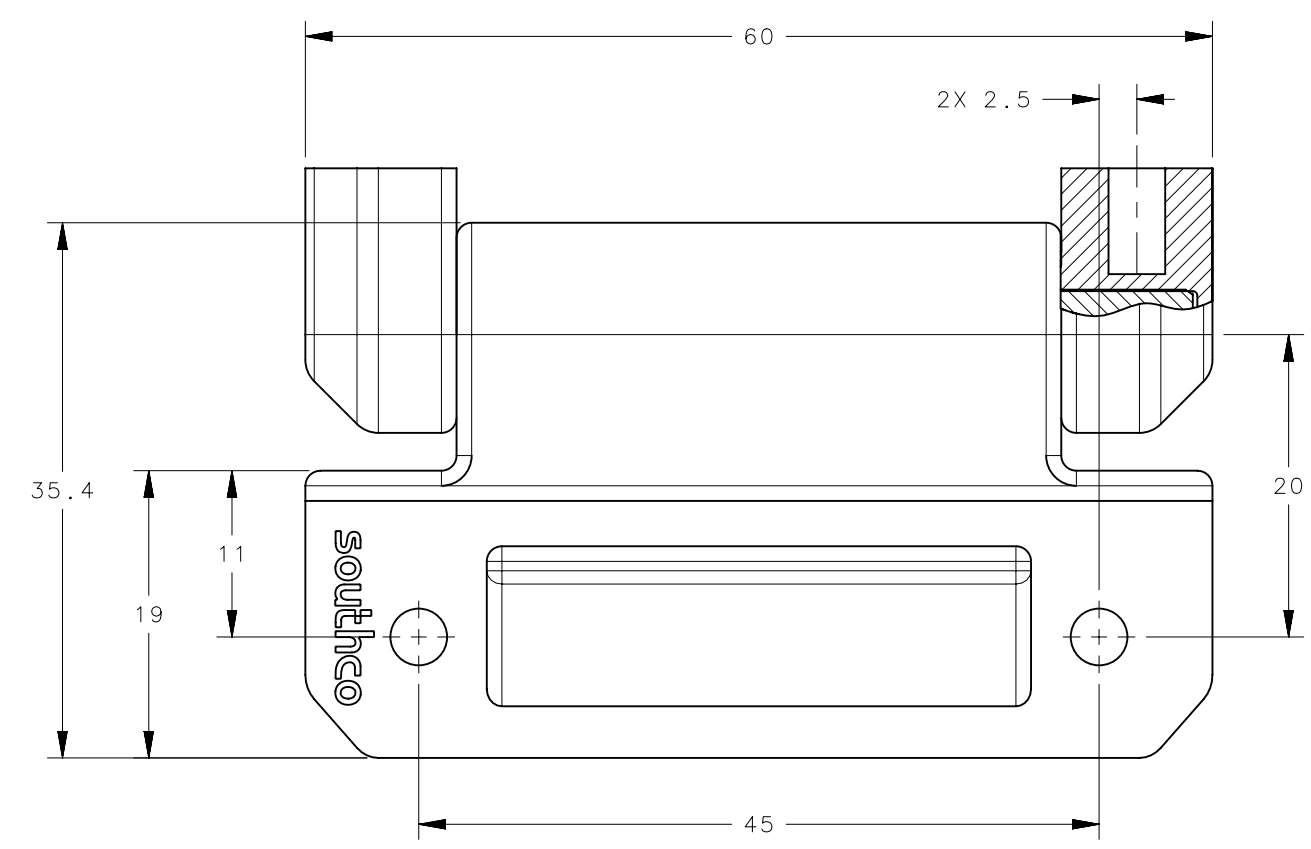

PART NO.	FORWARD TORQUE ±20% (lbf-in)	REVERSE TORQUE ±20% (lbf-in)	FORWARD TORQUE ±20% (n-m)	REVERSE TORQUE ±20% (n-m)
E6-60-400-[YY]	FREE OPERATING		FREE OPERATING	
E6-60-412S-[YY]	12			1.36
E6-60-420S-[YY]	20			2.26
E6-60-428S-[YY]	28			3.16
E6-60-436S-[YY]	36			4.07
E6-60-420F-[YY]	20	13.6	2.26	1.54
E6-60-428F-[YY]	28	19.1	3.16	2.16
E6-60-436F-[YY]	36	24.6	4.07	2.78
E6-60-444F-[YY]	44	30	4.97	3.39
E6-60-420R-[YY]	13.6	20	1.54	2.26
E6-60-428R-[YY]	19.1	28	2.16	3.16
E6-60-436R-[YY]	24.6	36	2.78	4.07
E6-60-444R-[YY]	30	44	3.39	4.97

NOTES:

A. OPERATION TORQUE TOLERANCE ±20%

B. MATERIAL AND FINISH:
HINGE BODY: ZINC ALLOY, SEE TABLE FOR FINISH.
O-RING: BUNA-N RUBBER
INTERNAL COMPONENTS: HARDENED STEEL

C. COSMETIC SPECIFICATION:
ALL SURFACES UNLESS OTHERWISE NOTED ARE TO CONFORM TO CLASS *C* DESIGNATION AS DESCRIBED IN SOUTHCO COSMETIC SPECIFICATION:
S-121-01 FOR SATIN CHROME

THIRD ANGLE PROJECTION		 CONNECT · CREATE · INNOVATE
MILLIMETERS [IN]		
TOLERANCES UNLESS OTHERWISE NOTED	DESCRIPTION	E6-60 HINGE ASSEMBLY
ALL DIMENSIONS WITHOUT TOLERANCES ARE FOR REFERENCE ONLY.	SIZE SYSTEM	DWG NO.
PROPRIETARY ITEM EXCEPT FOR USES EXPRESSLY GRANTED IN WRITING. INFORMATION DISCLOSED HEREON IS CONFIDENTIAL AND ALL RIGHTS, PATENT AND OTHERWISE, ARE RESERVED BY SOUTHCO, INC.	C NX	J-E6-60-400
PER ASME Y14.5M-1994	DRAWN BY	SCALE
	DZ/FV	2:1
	DATE	SHEET
	24AUG2005	1 OF 1