

REVISION HISTORY			
REV	DATE	BY	DESCRIPTION
B	18SEP2024	ASC/VK	PRN: P2024-1599

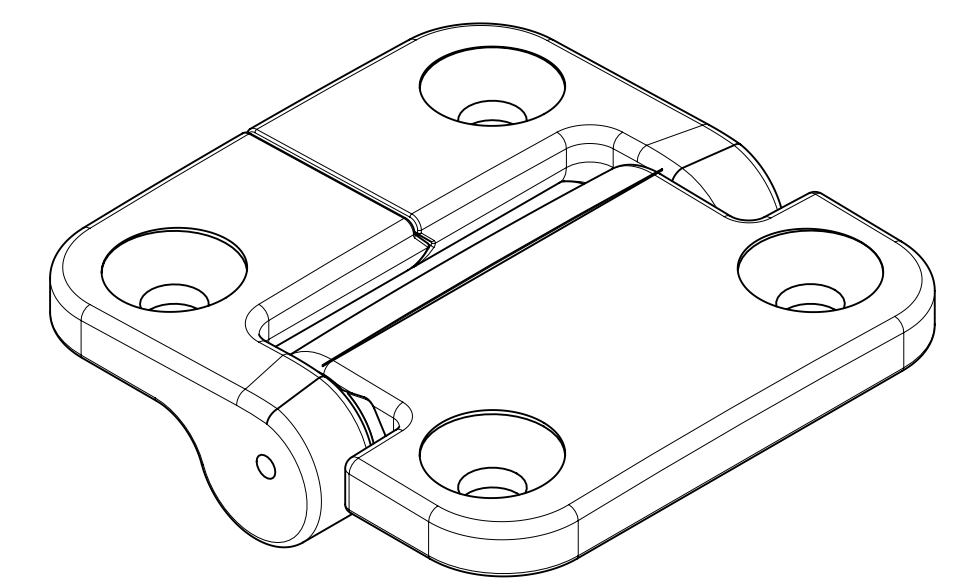

SCALE 7:4

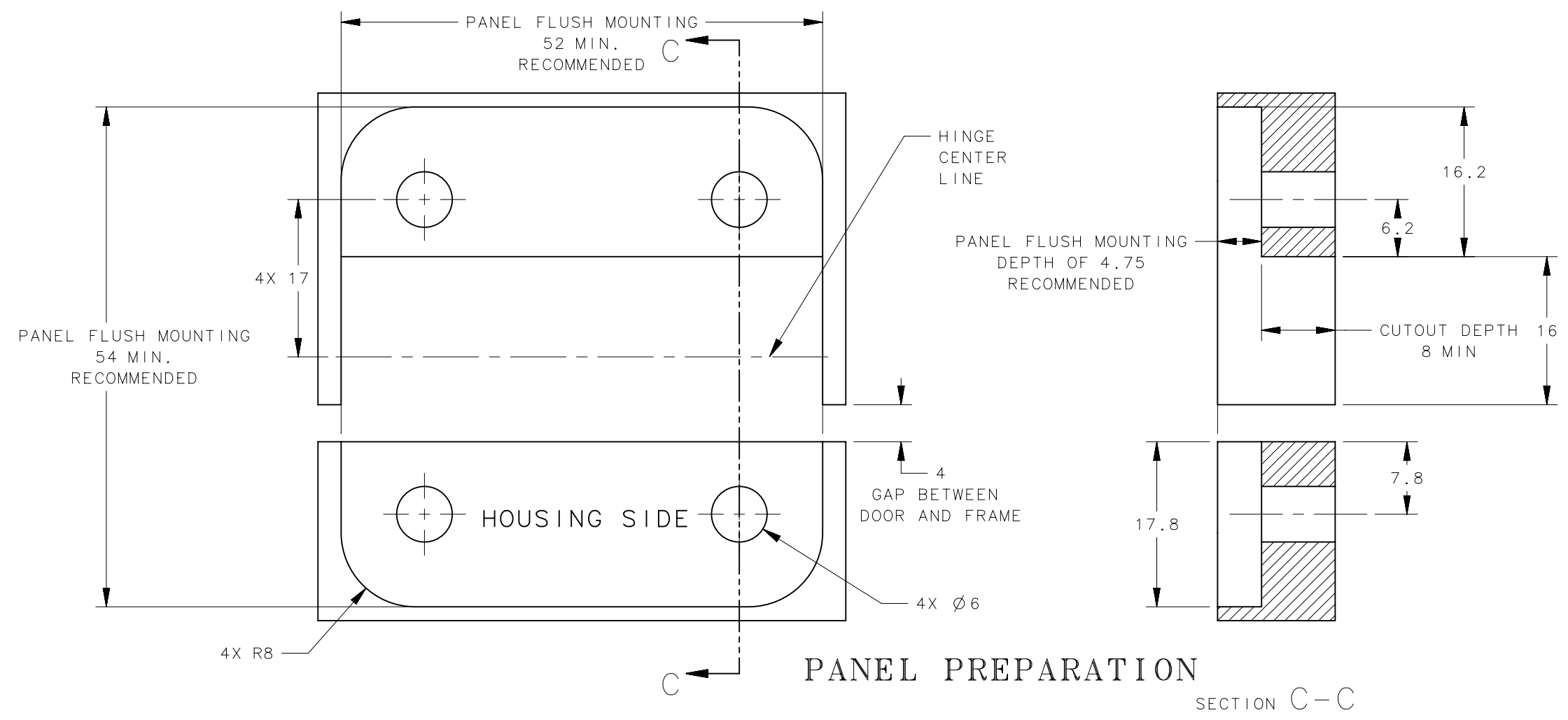
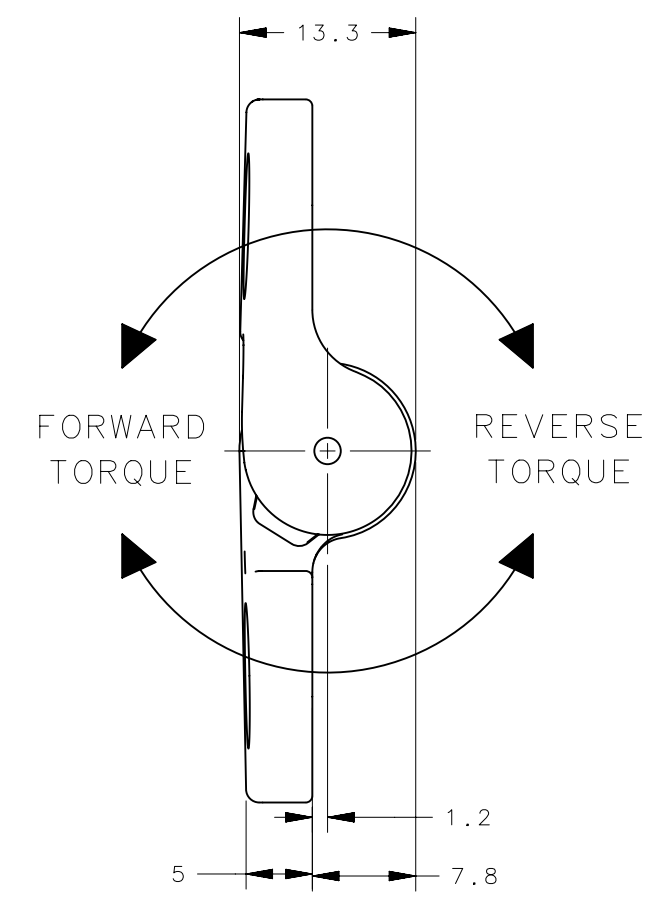
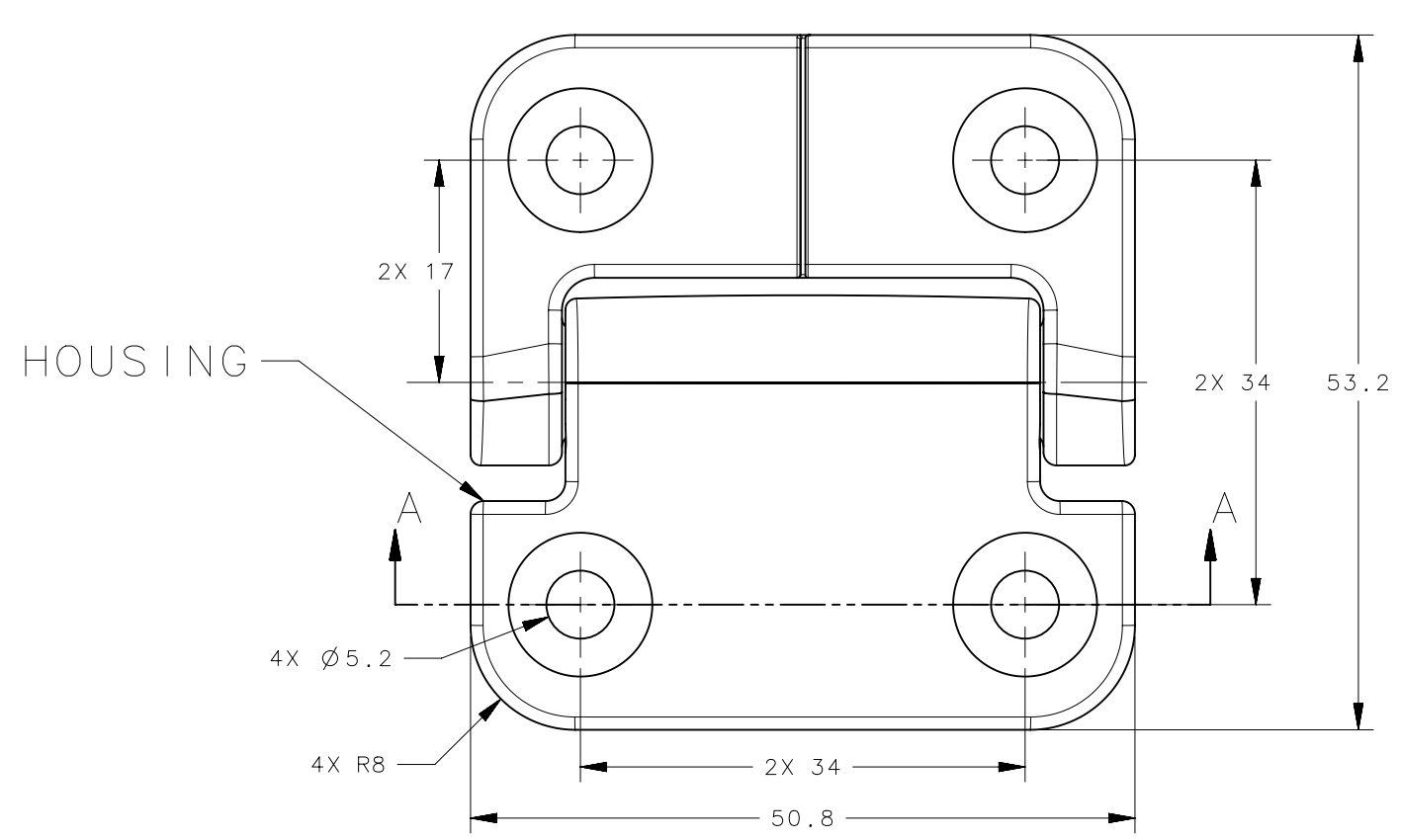

-XX	MATERIAL / FINISH
-6	SS (MIM) - BLACK PVD
-24	SS (MIM) - PASSIVATED
-85	SS (MIM) - HAND BUFFED

PART NUMBER	FORWARD TORQUE N-m (in-lbf)	REVERSE TORQUE N-m (in-lbf)
E6-73-400-XX	0.00 (0.00) *	0.00 (0.00) *
E6-73-408S-XX	0.90 (8.0)	0.90 (8.0)
E6-73-416S-XX	1.81 (16.0)	1.81 (16.0)
E6-73-420S-XX	2.26 (20.0)	2.26 (20.0)
E6-73-430S-XX	3.39 (30.0)	3.39 (30.0)
E6-73-420F-XX	2.26 (20.0)	1.54 (13.6) *
E6-73-430F-XX	3.39 (30.0)	2.30 (20.4) *
E6-73-440F-XX	4.52 (40.0)	3.08 (27.3) *
E6-73-420R-XX	1.54 (13.6) *	2.26 (20.0)
E6-73-430R-XX	2.30 (20.4) *	3.39 (30.0)
E6-73-440R-XX	3.08 (27.3) *	4.52 (40.0)

southco
CONNECT · CREATE · INNOVATE

DESCRIPTION: HINGE & CONTROLLED MOTION DEVICE

SIZE: C SYSTEM: NX DWG NO.: J-E6-73-400

DRAWN BY: AJH DATE: 27JAN2023 SCALE: 1.75:1 SHEET: 1 OF 1

- NOTES:
- PERFORMANCE TORQUE TOLERANCE $\pm 20\%$ (OVER LIFE OF THE HINGE)
 - DESIGNED TO ACCEPT M5 OR No. 10 SCREW OR EQUIVALENT
 - MATERIAL AND FINISH:
HINGE LEAVES: STAINLESS STEEL
SHAFT & PIN: STEEL
O-RINGS: BUNA-N RUBBER
BEARINGS: PLASTIC
 - RoHS COMPLIANT

THIRD ANGLE PROJECTION	
MILLIMETERS [IN]	
TOLERANCES UNLESS OTHERWISE NOTED	
UP TO 0.5	± 0.05
OVER 0.5 UP TO 6	± 0.1
OVER 6 UP TO 30	± 0.2
OVER 30	± 0.3
ANGLES	$\pm 1^\circ$
PROPRIETARY ITEM EXCEPT FOR USES EXPRESSLY GRANTED IN WRITING. INFORMATION DISCLOSED HEREON IS CONFIDENTIAL AND ALL RIGHTS, PATENT AND OTHERWISE, ARE RESERVED BY SOUTHCO, INC.	
PER ASME Y14.5M-2009	