

southco
 PROPRIETARY ITEM - EXCEPT FOR USES EXPRESSLY GRANTED IN WRITING INFORMATION DISCLOSED HEREON IS CONFIDENTIAL AND ALL RIGHTS RESERVED BY SOUTHCO, INC.

REV	DATE	DESCRIPTION	DESCRIPTION	DESCRIPTION	DESCRIPTION	DESCRIPTION	DESCRIPTION	DESCRIPTION	DESCRIPTION
A	03NOV2008	IR/DLH	RELEASED FOR PRODUCTION	HANDLE	BLACK POWDERCOAT	DISC COVER	STEEL	ZINC PLATE	ALL DIMENSIONS WITHOUT TOLERANCES ARE FOR REFERENCE ONLY.
B	09 DEC 08	IR/ACH	2008-1345	HOUSING	NATURAL	DUMMY CAM	STAINLESS	PASSIVATED	
C	04 FEB 09	IR/ACH	2009-0162	MOUNTING CUP	CHROME PLATE	CAM SCREW	BUNA-N	NATURAL/BLACK	
D	22SEP2014	CMS/BGL	2014-1872	TOOL ACTUATOR	NATURAL/BLACK	WAVE SPRING			
E	03AUG2016	CMS/LOCK	2016-1781	SHAFT	NATURAL/BLACK	HANDLE PIN			
F	08OCT2018	CMS/CDW	2018-2334	LOCKING PAWL	NATURAL/BLACK	FAWEL SPRING			
				LOCK PLUG		PADLOCK HASP			
				DIN LOCK ASSY		RETAINER			
				PANEL GASKETS		SHAFT O-RING			
				DIN DUST COVER		SCREW O-RINGS			
				HANDLE BUMPER					

PART NUMBER: H3-60- A LL -1 FF

PADLOCK/SERIES:

- 1 = NO PADLOCK, MULTIPOINT, GEARBOX
- 2 = PADLOCK, MULTIPOINT, GEARBOX
- 3, 4 = ACTUATOR VERSIONS

LOCKING OPTIONS:

- 00 = NO LOCK PROVIDED (DIN ONLY)
- 01 = CH751
- 02 = 300
- 03 = 333
- 04 = NON LOCKING
- 20 = NON LOCKING DIN WITH DETENT
- 21 = DIN CH751
- 22 = DIN 300
- 23 = DIN 333
- 24 = DIN W/O LOCK PLUG
- 40 = TOOL, 3mm DOUBLE BIT
- 41 = TOOL, 5mm DOUBLE BIT
- 42 = TOOL, TELCORDIA 216 (BELLCORE)
- 43 = TOOL, ELECTRONICS KEY
- 47 = TOOL, 8mm TRIANGLE
- 70 = DIN TOOL, 3mm DOUBLE BIT
- 71 = DIN TOOL, 5mm DOUBLE BIT
- 72 = DIN TOOL, TELCORDIA 216
- 73 = DIN TOOL, ELECTRONICS KEY
- 77 = DIN TOOL, 8mm TRIANGLE
- 78 = DIN TOOL, 7mm SQUARE

ASSEMBLY FINISH:

- 44 = SATIN CHROME
- 50 = BLACK POWDER COAT

OTHERS AVAILABLE UPON REQUEST

GRIP TABLE
CAM
PART No. E5-61YY

YY	GRIP	YY	GRIP
09	24.9	16	38.9
10	26.9	17	40.9
11	28.9	18	42.9
12	30.9	19	44.9
13	32.9	20	46.9
14	34.9	21	48.9
15	36.9	22	50.9

SEE J-E5-61-A (FLAT CAM)
 SEE J-E5-71 (ROLLER CAM)

SEE SHEET 2 FOR VIEW OF DIN AND TOOL ACCESS VERSIONS

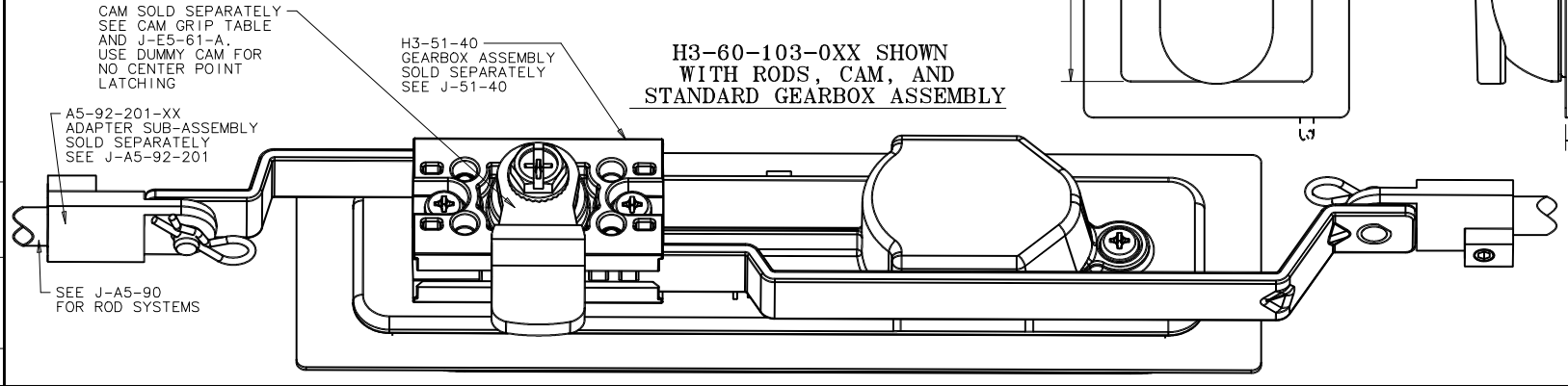
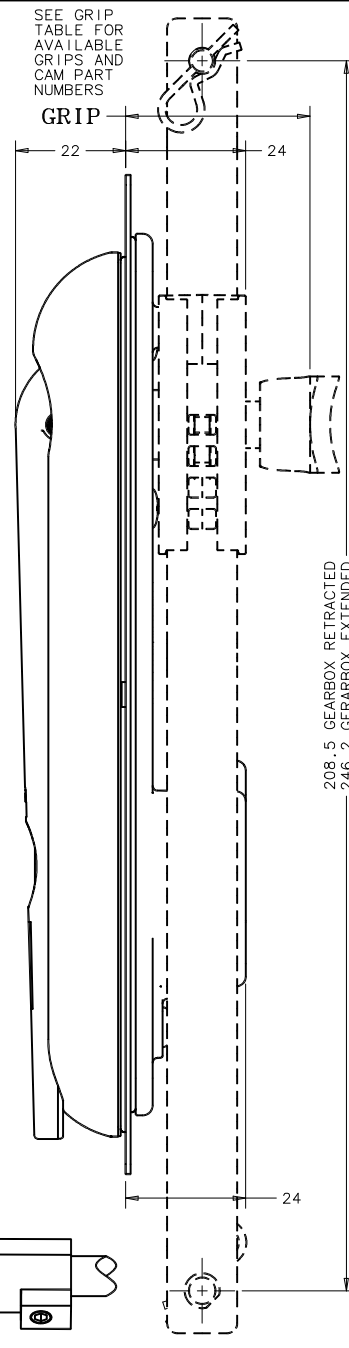
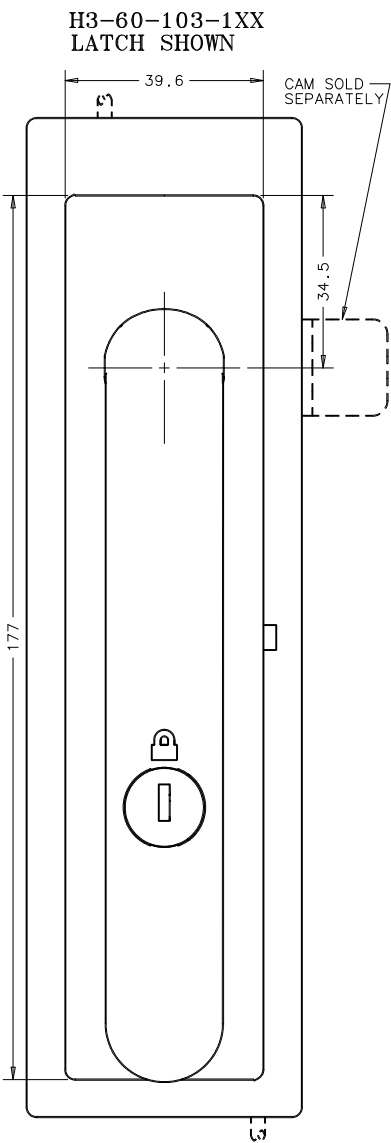
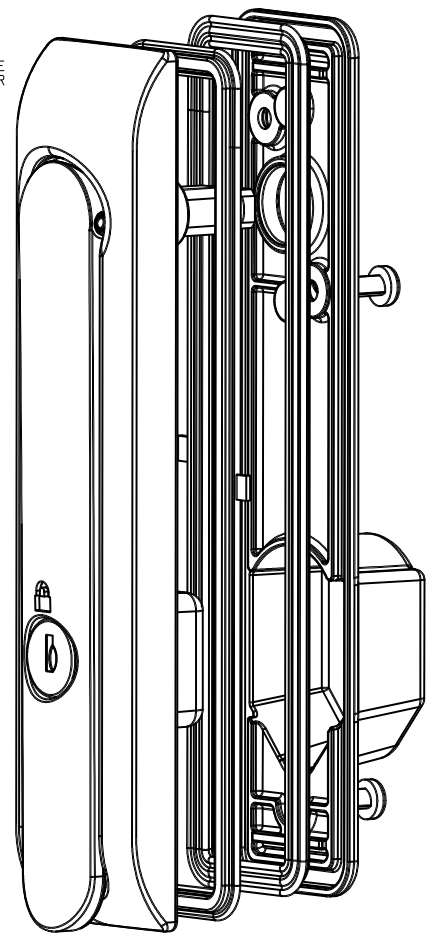

208.5 GEARBOX RETRACTED
 246.2 GEARBOX EXTENDED

southco
 PROPRIETARY ITEM - EXCEPT FOR USES EXPRESSLY GRANTED IN WRITING INFORMATION DISCLOSED HEREON IS CONFIDENTIAL AND ALL RIGHTS RESERVED BY SOUTHCO, INC.

REV	DATE	DESCRIPTION	RELEASED FOR PRODUCTION
A	03NOV2008	IR/DLH	PRN: 2008-1345
B	09 DEC 08	IR/ACH	PRN: 2009-0162
C	04 FEB 09	IR/ACH	PRN: 2014-1872
D	22SEP2014	CMS/BGL	PRN: 2014-1872
E	03AUG2016	CMS/LOCK	PRN: P2016-1781
F	09OCT2018	CMS/CDW	PRN: P2018-2334

DESCRIPTION	MATERIAL	FINISH/COLOR	DESCRIPTION	MATERIAL	FINISH/COLOR
SWINGHANDLE LATCH, MULTI POINT, GEARBOX, OUTDOOR, 25x150 SIZE	STEEL	ZINC PLATE	BLACK POWDERCOAT	STEEL	ZINC PLATE
HANDLE	ZAMAC 3	NATURAL	NATURAL	STAINLESS	PASS IVATED
HOUSING		CHROME PLATE	NATURAL/BLACK	BUNA-N	NATURAL/BLACK
MOUNTING CUP		NATURAL/BLACK	SCREW O-RINGS		
TOOL ACTUATOR					
SHAFT					
LOCKING PAWL					
LOCK PLUG					
DIN LOCK ASSY					
PANEL GASKETS					
DIN DUST COVER					
HANDLE BUMPER					

DRAWING NUMBER	J-H3-60-101-1
DRAWN	CHD
DATE	25 JUN 08
SCALE	1:1
FINISH/COLOR	ZINC PLATE
PAPER SIZE	A3
THIRD ANGLE PROJECTION	
SHEET 2 OF 2	

PANEL PREPARATION

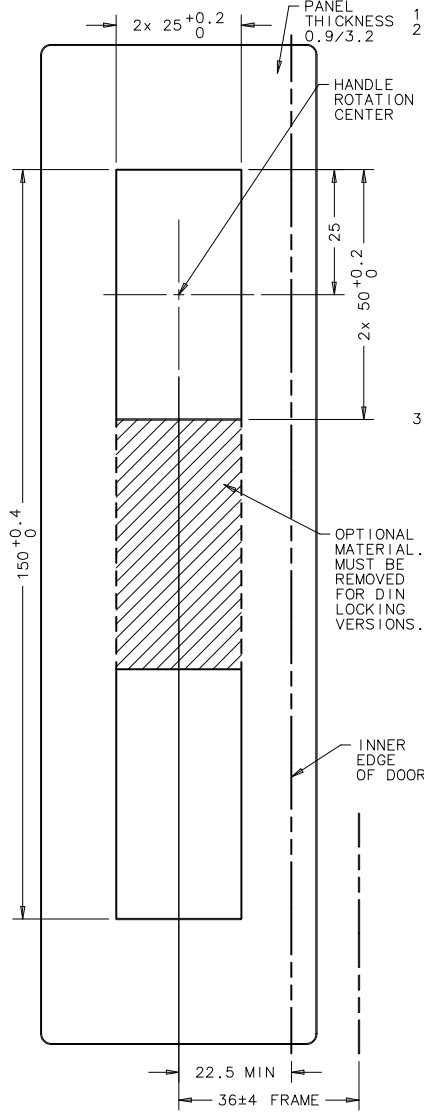

- NOTES:
- ALL LATCH COMPONENTS ARE RoHS COMPLIANT.
 - LATCH INSTALLATION:
 - PREPARE A BURR FREE PANEL OPENING AS SHOWN.
 - INSTALL LATCH SUB-ASSEMBLY FROM THE FRONT SIDE OF THE PANEL AND HOLD IN PLACE.
 - FROM THE BACK SIDE OF THE PANEL, SLIDE THE MOUNTING CUP ONTO THE HANDLE SHAFT.
 - SECURE THE CUP IN PLACE WITH THE THREE M4x0.7x12 SCREWS PROVIDED. MAX SCREW TORQUE 1.5 N-m.
 - PLACE THE GEARBOX ASSEMBLY ONTO HANDLE SHAFT. PLEASE NOTE THAT THE GEARBOX ORIENTATION ALSO SETS THE LATCH OPENING DIRECTION, THE DIRECTION CAN BE EASILY CHANGED FROM CW TO OPEN TO CCW TO OPEN BY SIMPLY REMOVING THE GEARBOX AND REINSTALLING IT WITH THE LONG ARM ON THE OPPOSITE SIDE FROM WHAT IS SHOWN. SECURE THE GEARBOX IN PLACE WITH THE TWO M4x0.7x12 SCREWS PROVIDED. MAX SCREW TORQUE 1.5 N-m.
 - PLACE SHAFT WAVE WASHER ONTO HANDLE SHAFT AGAINST THE TOP OF THE GEARBOX HOUSING FOLLOWED BY THE CAM. SECURE CAM TO SHAFT USING M6x1x14 SCREW. MAX SCREW TORQUE 2.0 N-m.
 - CYCLE THE LATCH FROM OPEN TO CLOSE TO MAKE SURE EVERYTHING MOVES FREELY.
 - FOR TWO POINT LATCHING (NO CENTER LATCHING), A 'DUMMY CAM' MUST BE USED TO MAINTAIN PROPER ASSEMBLY SPACING.
 - COSMETIC SPECIFICATION: ALL POWDERCOATED OR CHROME PLATED SURFACES, UNLESS OTHERWISE NOTED, ARE TO CONFORM TO A CLASS 'B' DESIGNATION. ALL OTHER SURFACES, UNLESS OTHERWISE NOTED, ARE TO CONFORM TO A CLASS 'C' DESIGNATION AS DESCRIBED IN SOUTHCO COSMETIC SPECIFICATIONS:
 - S-121-01 FOR CHROME PLATING
 - S-121-02 FOR ZINC PLATING
 - S-121-03 FOR POWDER COATING
 - S-121-05 FOR STAINLESS STEEL PARTS

PROPER CAM & GEARBOX INSTALLATION FOR ROTATING HANDLE CCW TO OPEN

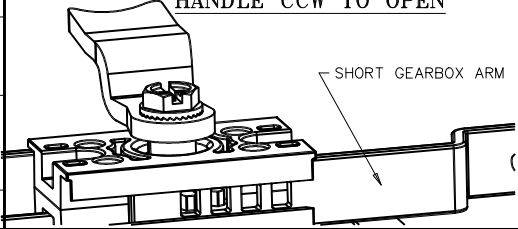

HARDWARE PACK

