

**NOTES**

1. FOR PANEL PREPARATION INSTRUCTIONS SEE DRAWING NUMBER J-MA-BB-C3C-DD-FFF SHEET 2
2. DRAWING SHOWS NOVA HANDLES
3. FOR STRIKERS SEE: J-MC-90-4XX
4. FOR McCOY STAR SLIDER STRIKER; SEE J-MC-90-6XX

**PART NUMBER SYSTEM**  
**MA-BB-C3C-DD-FFF0**

PRODUCT  
 DIRECTION [A]  
 DOOR THICKNESS [C]  
 HANDLE  
 FINISH

**REVISION HISTORY**

REV	DATE	BY	DESCRIPTION
1	31MAR2021	CMS/MGG	PRN: P2021-0625

**PRODUCT [BB]**

- 02- McCOY STAR
- 07- McCOY STAR WITH DOUBLE SPRING BOLT
- 09- McCOY STAR SLIDER

**HANDLE [DD]**

- 01-NOVA HANDLE
- 02-PORTOFINO HANDLE

**DIRECTION [C1]**

- 2-RIGHT OUT [SLIDER R]
- 3-RIGHT IN
- 4-LEFT OUT [SLIDER L]
- 5-LEFT IN

**FINISH FOR HANDLE, PRIVACY, ACCENTS AND ESCUTCHEON [FF]**

- 10-CHROME.
- 14-BRIGHT CHROME WITH DIAMOND BRASS ACCENT.
- 20-SATIN CHROME.
- 40-DIAMOND BRASS.

**DOOR THICKNESS [C3]**

- 0 - 22-30mm [7/8" - 1 3/16"]
- 1 - 28-37mm [1 1/8" - 1 1/2"]
- 2 - 36.5-45mm [1 7/16" - 1 3/4"]

OTHER HANDLE OPTIONS AVAILABLE REFER TO OLIVARI WEB SITE AND LITERATURE FOR 3 DIGIT HANDLE CODE.

**MATERIAL AND FINISH**

**LATCH MODULE**

- LOCK ENGINE: BRASS
- DEAD BOLT: BRASS, NICKEL PLATED
- SPRINGS: 304 STAINLESS STEEL

**LOCK MODULE**

- LOCK CASE AND COVER PLATE; 316 STAINLESS STEEL
- INTERNAL COMPONENTS: 316 STAINLESS STEEL
- STAR LOCK: BRASS
- SPRINGS: 316 STAINLESS STEEL
- SCREWS: 316 STAINLESS STEEL

FOREND: BRASS, CHROME PLATED

MOUNTING SCREWS M4 POZIDRIVE: 316 STAINLESS STEEL

HANDLES: BRASS, FINISH SEE TABLE

ESCUTCHEONS, ACCENTS AND TURN KNOB: BRASS, SEE TABLE FOR FINISH

SHUTTERS: 316 STAINLESS STEEL, ELECTRO POLISHED

SHUTTER HOUSING: ACETAL, BLACK

DRIVEBAR: BRASS

WASHERS: PA6, WHITE

SET SCREWS 10/32": 316 STAINLESS STEEL

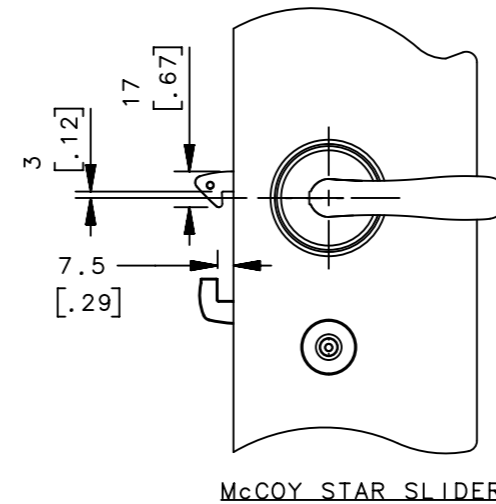
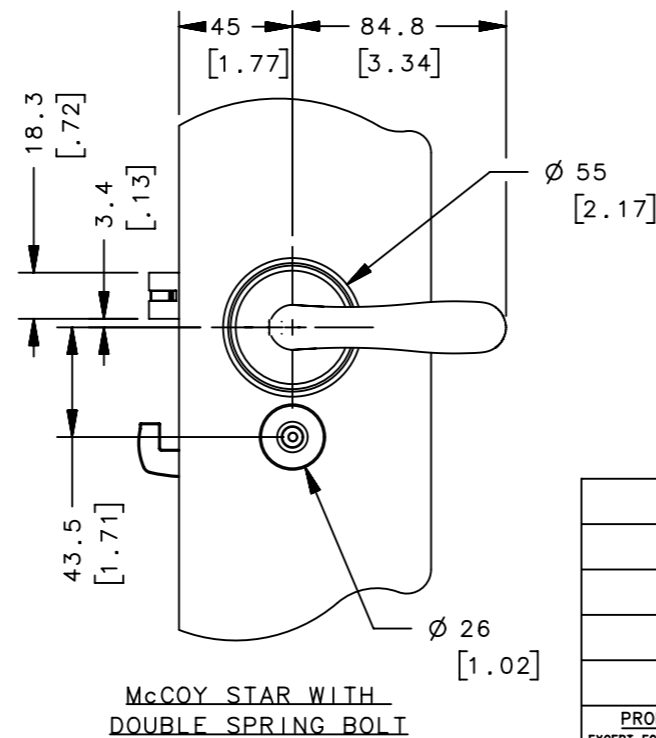
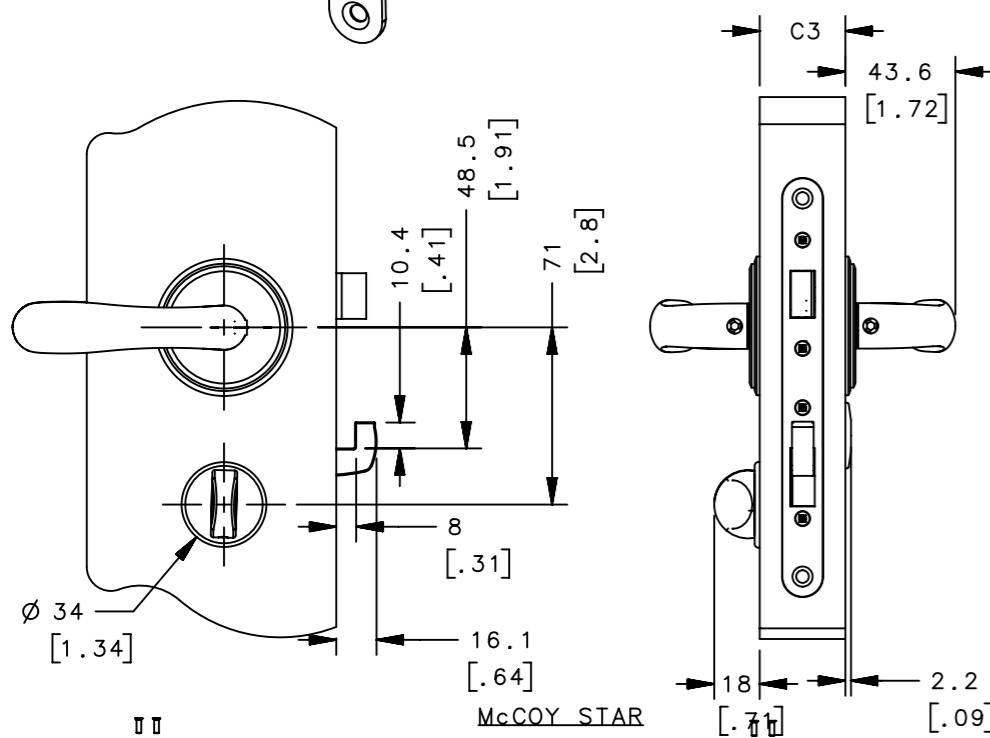
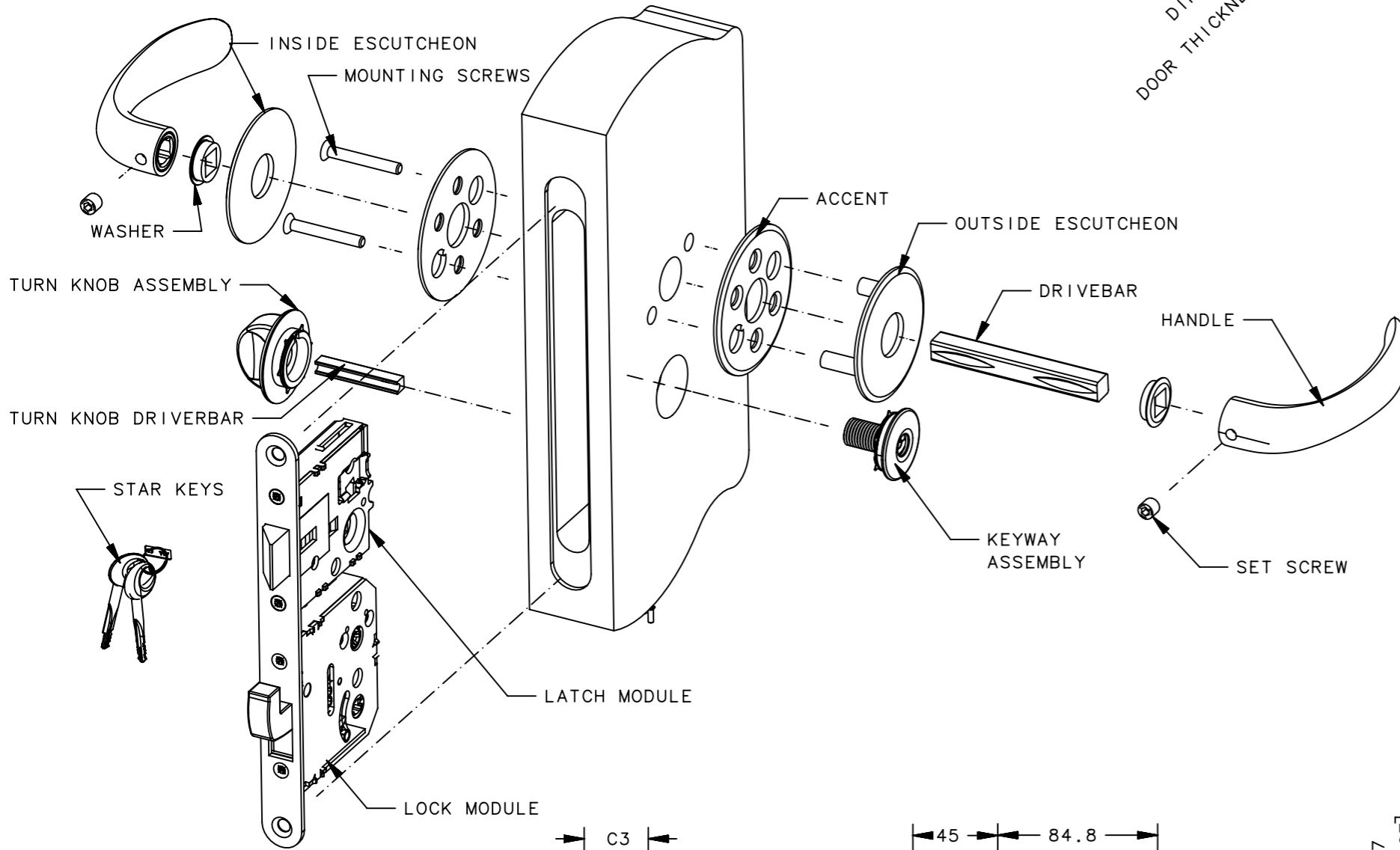

THIRD ANGLE PROJECTION				
MILLIMETERS [IN]	DESCRIPTION			
TOLERANCES UNLESS OTHERWISE NOTED	McCOY STAR - ROUND			
ALL DIMENSIONS WITHOUT TOLERANCES ARE FOR REFERENCE ONLY.	SIZE	SYSTEM	DWG NO.	
	A3	NX	J-MA-BB-C3C-DD-FFF	
PROPRIETARY ITEM	DRAWN BY	DATE	SCALE	SHEET
EXCEPT FOR USES EXPRESSLY GRANTED IN WRITING, INFORMATION DISCLOSED HEREON IS CONFIDENTIAL AND ALL RIGHTS, PATENT AND OTHERWISE, ARE RESERVED BY SOUTHCO, INC.	RFA/DTB	14JUNE2012	-	1 OF 4
PER ASME Y14.5M-1994				

REVISION HISTORY			
REV	DATE	BY	DESCRIPTION
1	31MAR2021	CMS/MGG	PRN: P2021-0625

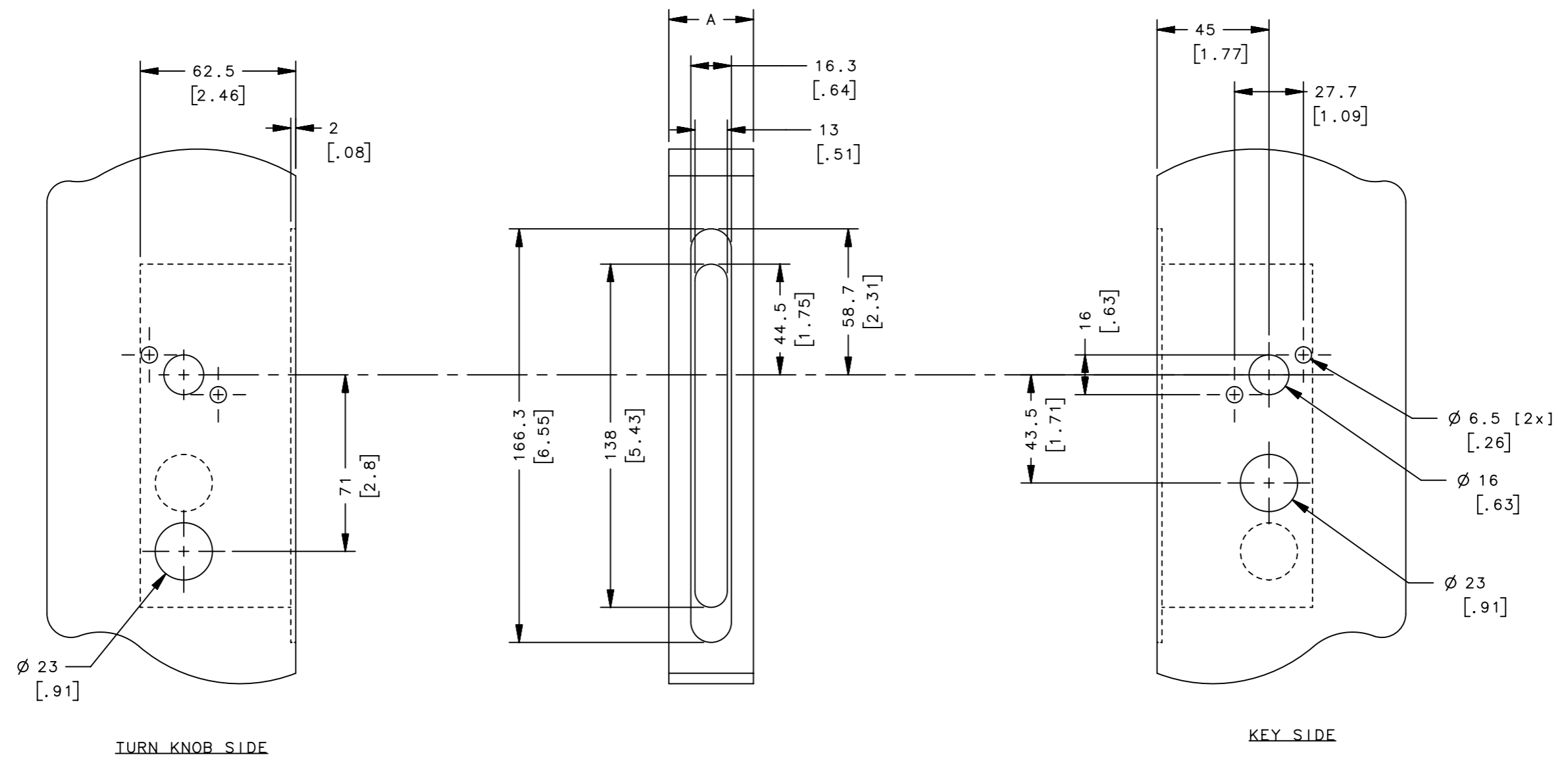

NOTE:  
 PANEL PREPARATION FOR ASSEMBLIES MA-BB-C3C-DD-FF0 AND MA-BB-C3C-DD-FF0  
 1 3 1 3

THIRD ANGLE PROJECTION				<b>southco</b> <sup>®</sup> CONNECT • CREATE • INNOVATE	
MILLIMETERS [IN]					
TOLERANCES UNLESS OTHERWISE NOTED		DESCRIPTION McCOY STAR -ROUND-PANEL PREPARATION			
ALL DIMENSIONS WITHOUT TOLERANCES ARE FOR REFERENCE ONLY.		SIZE A3	SYSTEM NX	DWG NO. J-MA-BB-C3C-DD-FFF	
PROPRIETARY ITEM		DRAWN BY RFA/DTB	DATE 27JUNE2012	SCALE -	SHEET 2 OF 4
EXCEPT FOR USES EXPRESSLY GRANTED IN WRITING, INFORMATION DISCLOSED HEREON IS CONFIDENTIAL AND ALL RIGHTS, PATENT AND OTHERWISE, ARE RESERVED BY SOUTHCO, INC.		PER ASME Y14.5M-1994			

REVISION HISTORY			
REV	DATE	BY	DESCRIPTION
1	31MAR2021	CMS/MGG	PRN: P2021-0625

**NOTES**

- FOR PANEL PREPERATION INSTRUCTIONS SEE DRAWING NUMBER J-MA-BB-C3C-DD-FFF SHEET 4
- FOR STRIKERS SEE: J-MC-90-4XX
- FOR McCOY STAR SLIDER STRIKER SEE: J-MC-90-6XX

**PART NUMBER SYSTEM**  
 MA-BB-C3C-DD-FF 1

PRODUCT  
 DIRECTION 1  
 DOOR THICKNESS [A] 3  
 HANDLE  
 FINISH

**PRODUCT [BB]**

- 02 - McCOY STAR
- 07 - McCOY STAR WITH DOUBLE SPRING BOLT
- 09 - McCOY STAR SLIDER

**DIRECTION [C1]**

- 2 - RIGHT OUT [SLIDER R]
- 3 - RIGHT IN
- 4 - LEFT OUT [SLIDER L]
- 5 - LEFT IN

**DOOR THICKNESS [C3]**

- 0 - 22-30mm [7/8" - 1 3/16"]
- 1 - 28-37mm [1 1/16" - 1 1/2"]
- 2 - 36.5-45mm [1 7/16" - 1 3/4"]

**HANDLE [DD]**

- 42-NORDIC HANDLE

**FINISH FOR HANDLE PRIVACY AND ESCUTCHEONS [FF]**

- 10-CHROME
- 20-SATIN CHROME
- 40-DIAMOND BRASS

**MATERIAL FINISH**

- LATCH MODULE**
- LOCK ENGINE; BRASS
  - DEAD BOLT; BRASS NICKEL PLATED
  - DEAD BOLT McCOY STAR SLIDER: 2348 STAINLESS STEEL
  - SPRINGS; 304 STAINLESS STEEL
- LOCK MODULE**
- LOCK CASE AND COVER PLATE; 316 STAINLESS STEEL
  - INTERNAL COMPONENTS; 316 STAINLESS STEEL
  - STAR LOCK PLUG; BRASS
  - SPRINGS; 316 STAINLESS STEEL
  - SCREWS; 316 STAINLESS STEEL
- FOREND; BRASS, CHROME PLATED  
 MOUNTING SCREWS M4 POZIDRIVE; 316 STAINLESS STEEL  
 HANDLES; BRASS, FINISH SEE TABLE  
 ESCUTCHEONS, ACCENTS AND TURN KNOB; 316 STAINLESS STEEL, SEE TABLE FOR FINISH  
 DRIVEBAR; BRASS  
 WASHERS; PA6 WHITE  
 SET SCREWS 10/32; 316 STAINLESS STEEL

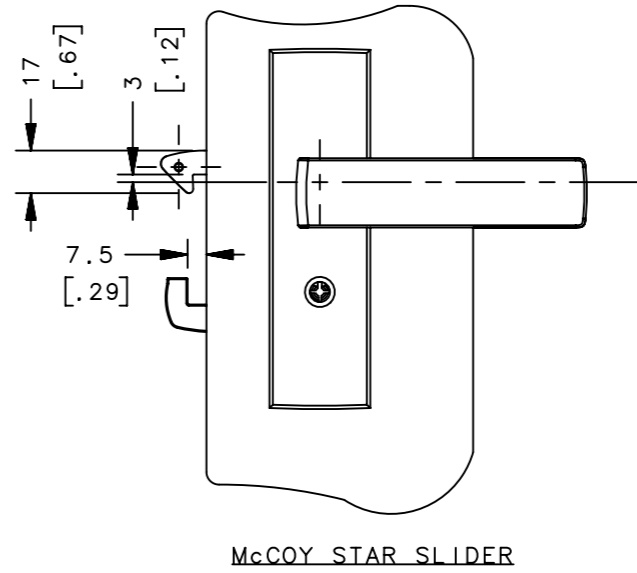
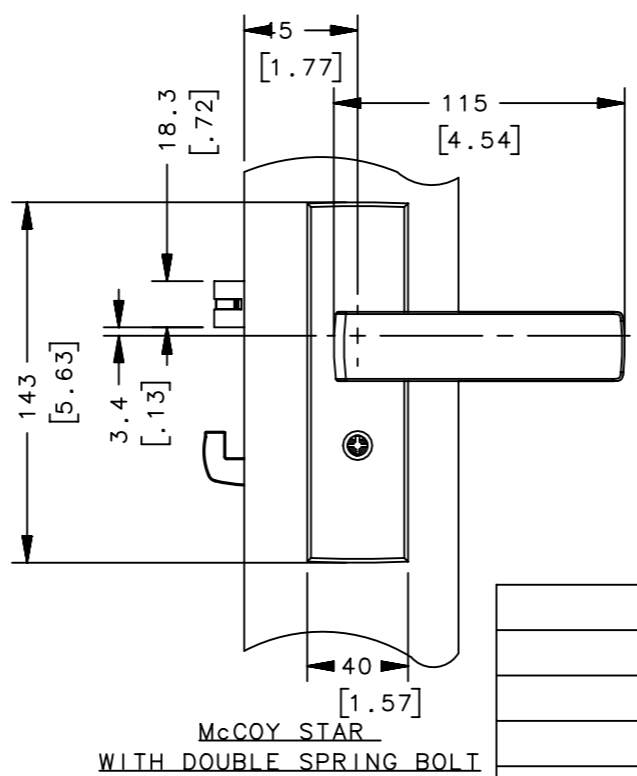
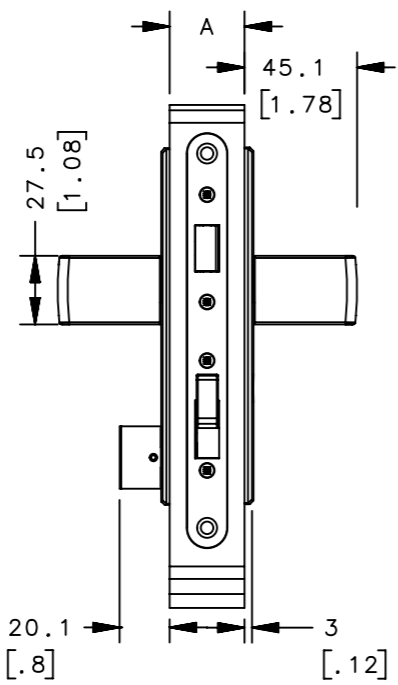
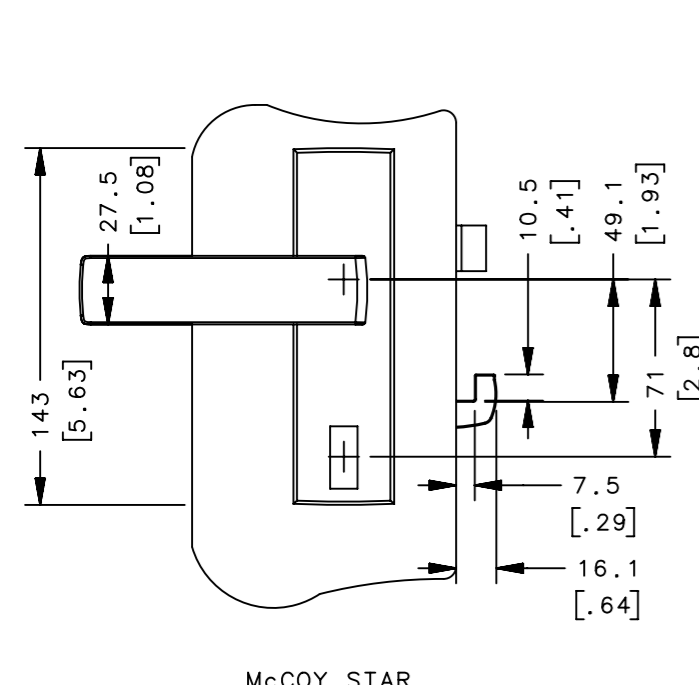
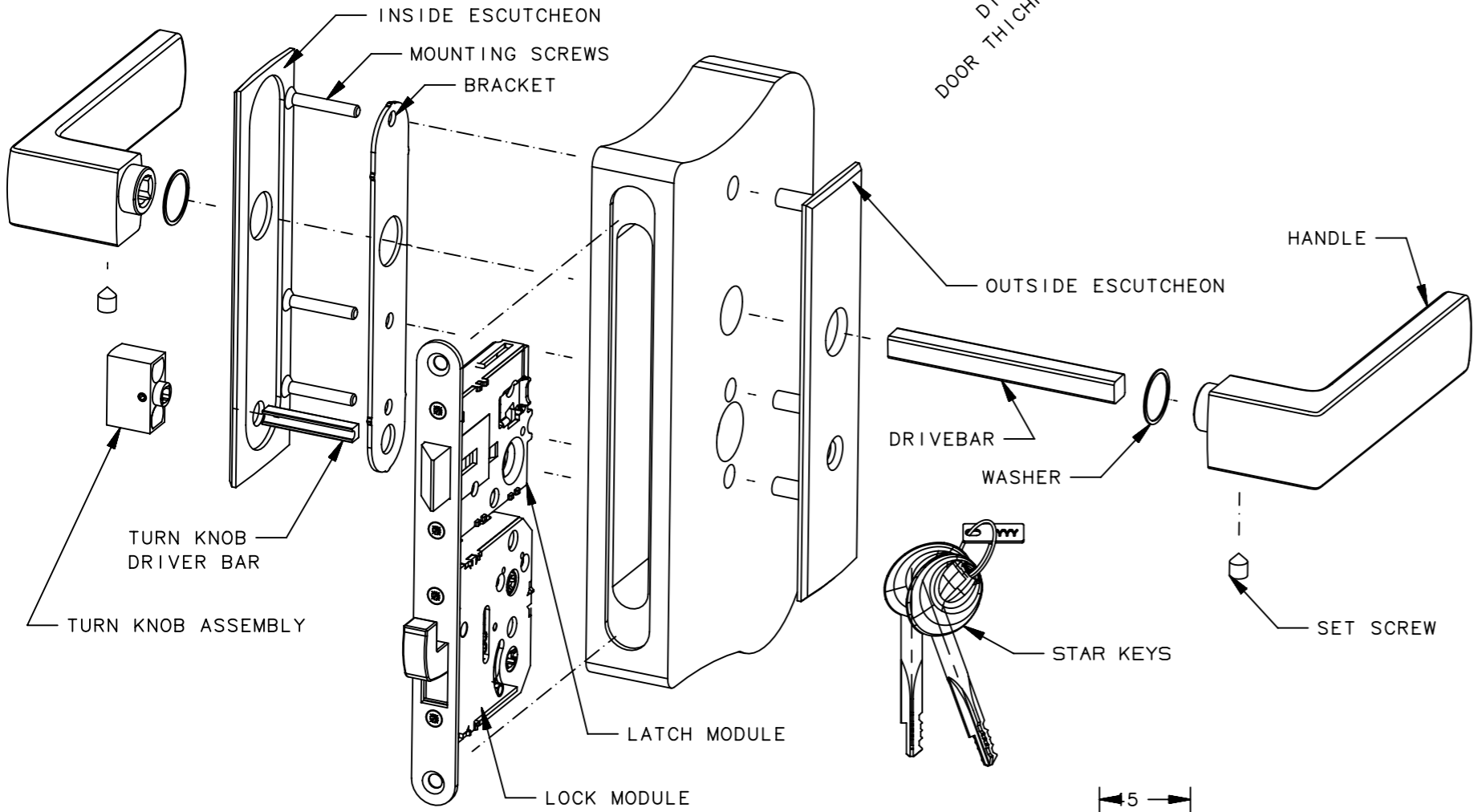

THIRD ANGLE PROJECTION				
MILLIMETERS [IN]	DESCRIPTION			<b>McCOY STAR-SQUARE</b>
TOLERANCES UNLESS OTHERWISE NOTED	SIZE	SYSTEM	DWG NO.	
ALL DIMENSIONS WITHOUT TOLERANCES ARE FOR REFERENCE ONLY.	A3	NX	J-MA-BB-C3C-DD-FFF	
	PER ASME Y14.5M-1994	DRAWN BY	DATE	
PROPRIETARY ITEM	RFA/DTB	04JULY2012	SCALE	
EXCEPT FOR USES EXPRESSLY GRANTED IN WRITING, INFORMATION DISCLOSED HEREON IS CONFIDENTIAL AND ALL RIGHTS, PATENT AND OTHERWISE, ARE RESERVED BY SOUTHCO, INC.			SHEET	
			3 OF 4	

REVISION HISTORY			
REV	DATE	BY	DESCRIPTION
I	31MAR2021	CMS/MGG	PRN: P2021-0625

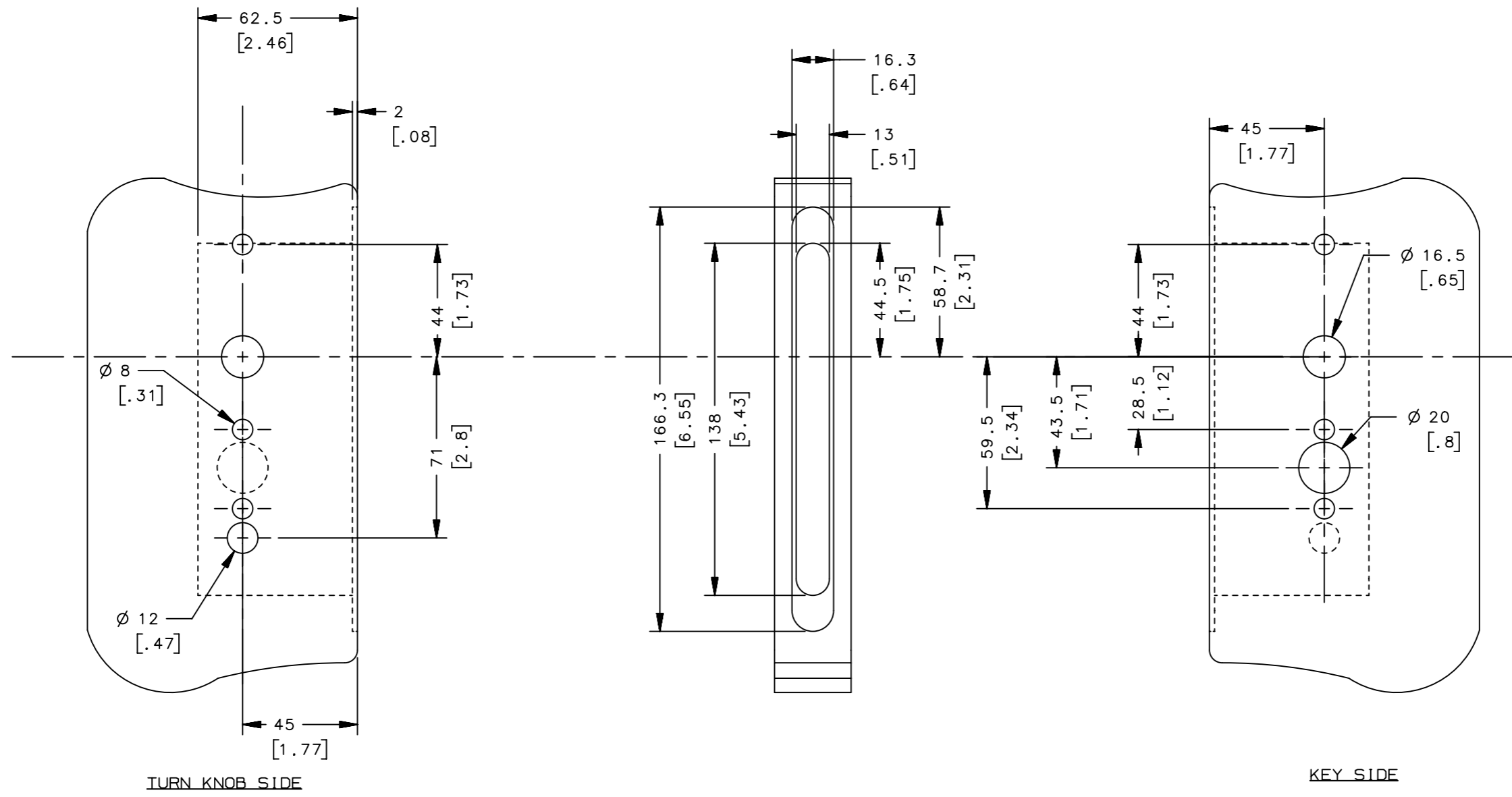

NOTE:  
 PANEL PREPARATION FOR ASSEMBLIES MA-BB-C3C-DD-FF1 AND MA-BB-C3C-DD-FF1  
 1 3 1 3

THIRD ANGLE PROJECTION		 CONNECT • CREATE • INNOVATE	
MILLIMETERS [IN]			
TOLERANCES UNLESS OTHERWISE NOTED		DESCRIPTION McCOY STAR-SQUARE PANEL PREPARATION	
ALL DIMENSIONS WITHOUT TOLERANCES ARE FOR REFERENCE ONLY.		SIZE A3	SYSTEM NX
<small>PROPRIETARY ITEM          EXCEPT FOR USES EXPRESSLY GRANTED          IN WRITING, INFORMATION DISCLOSED          HEREON IS CONFIDENTIAL AND ALL          RIGHTS, PATENT AND OTHERWISE,          ARE RESERVED BY SOUTHCO, INC.</small>		DWG NO. J-MA-BB-C3C-DD-FFF	DATE 04JULY2012
PER ASME Y14.5M-1994		DRAWN BY RFA/DTB	SCALE -
		SHEET 4 OF 4	

6

5

4

3

2

1

D

D

C

C

B

B

A

A

6

5

4

3

2

1