

REVISION HISTORY			
REV	DATE	BY	DESCRIPTION
D	29MAR2023	APA/VK	PRN: P2023-0586

MATERIAL AND FINISH
LATCH MODULE.
 - LOCK ENGINE: ALUMINIUM.
 - DEAD BOLT: REINFORCED NYLON (PA6).
 - INTERNAL COMPONENTS: POM, PA6.
 - SPRINGS: 304 STAINLESS STEEL.
LOCK MODULE.
 - HOUSING: POM.
 - INTERNAL COMPONENTS: PA6, BRASS, POM.
SCREWS AND NUTS: 316 STAINLESS STEEL.
HANDLES: BRASS [YY=10].
 ALUMINIUM [YY=50&60].
 SEE TABLE FOR FINISH.
CENTRUM FOR HANDLE: POM.
ESCUTCHEONS: BRASS [YY=10].
 ALUMINIUM [YY=50&60].
 SEE TABLE FOR FINISH.
PRIVACY KNOB: POM.
DRIVEBAR: ALUMINIUM.
WASHERS: POM.
SET SCREWS 10/32"; 316 STAINLESS STEEL.

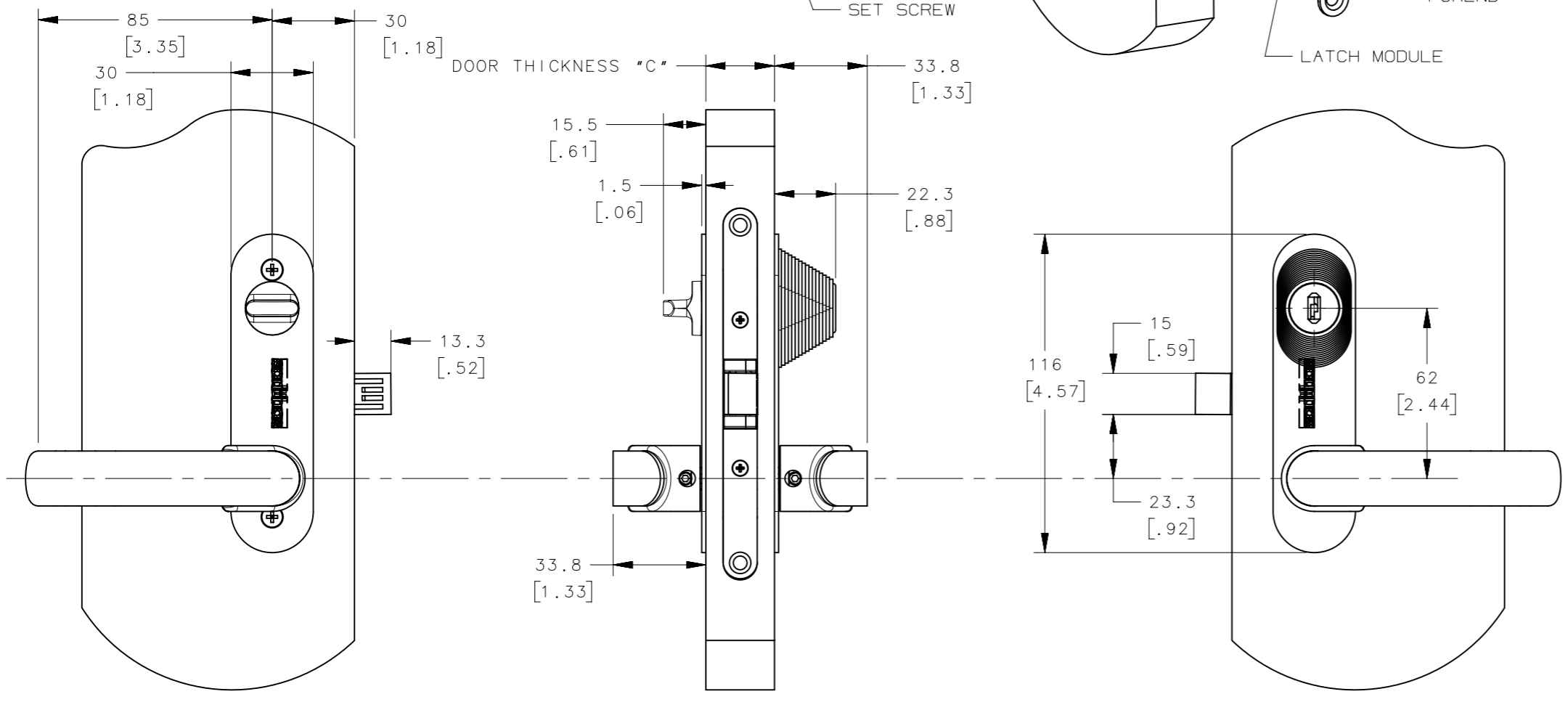
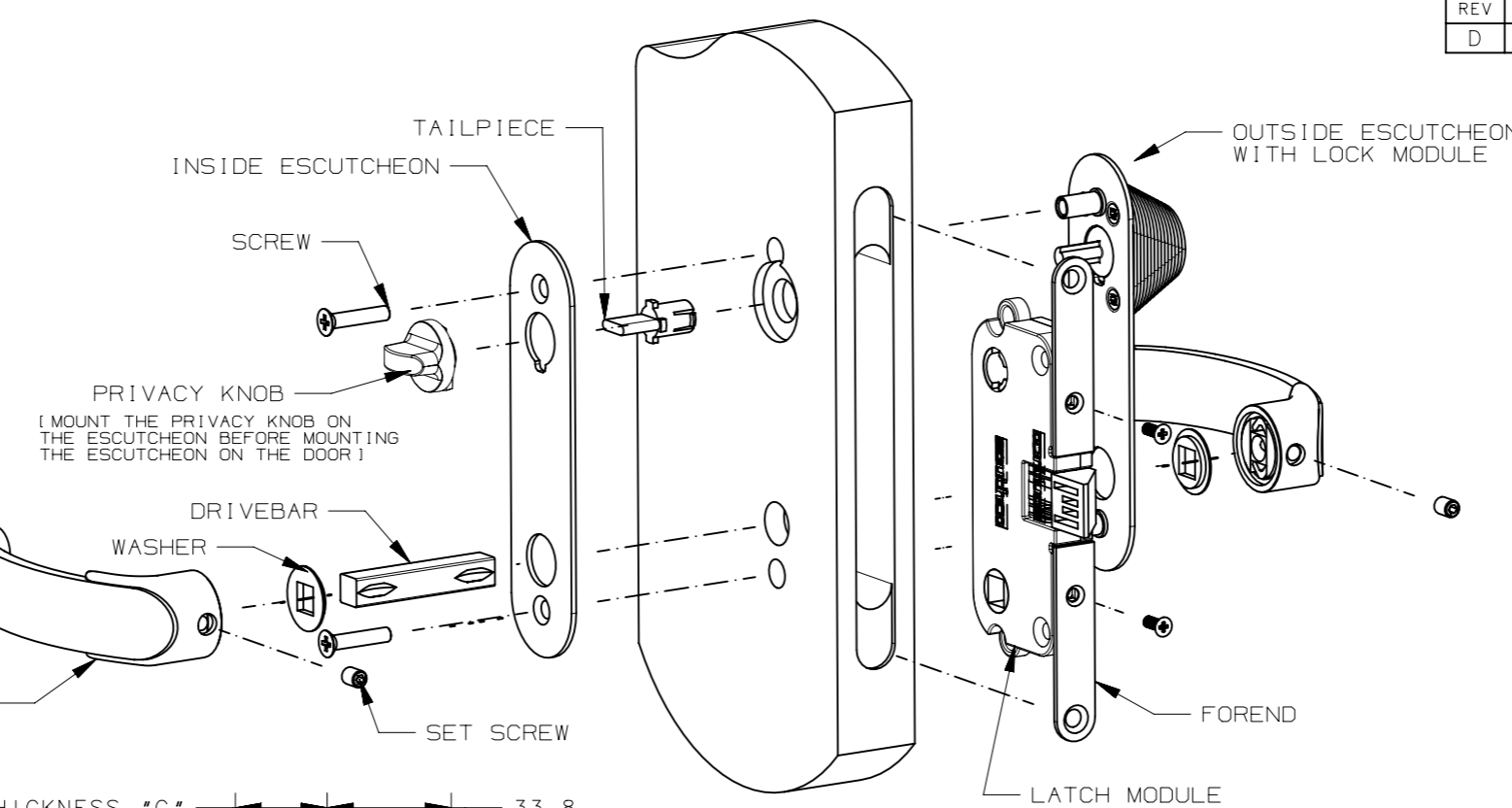

PART NUMBER SYSTEM
 ME-02-A1C-YY
 DIRECTION
 DOOR THICKNESS
 FINISH

DIRECTION [A]
 2 - RIGHT OUT
 3 - RIGHT IN
 4 - LEFT OUT
 5 - LEFT IN

FINISH FOR HANDLES AND ESCUTCHEONS [YY]
 10 - CHROME
 50 - BLACK
 60 - ALUMINIUM

DOOR THICKNESS [C]
 4 - 18-22mm [11/16" - 7/8"]
 5 - 22-27mm [7/8" - 1-1/16"]
 6 - 27-32mm [1-1/16" - 1-1/4"]
 7 - 32-37mm [1-1/4" - 1-1/2"]

- NOTES**
- DOOR THICKNESS RANGE "C": 18 - 37mm. [11/16" - 1-1/2"].
 - FOR PANEL PREPERATION INSTRUCTIONS SEE DRAWING J-ME-02-A1C-YY SHEET 2.
 - FOR AVAILABLE STRIKERS SEE H-MC-90-2XX-YY' H-MC-90-3XX-YY AND H-MC-9590.
 - SEE SOUTHCO MARINE HANDBOOK FOR MORE DETAILED INSTALLATION INSTRUCTIONS.

THIRD ANGLE PROJECTION	southco CONNECT • CREATE • INNOVATE	
TOLERANCES UNLESS OTHERWISE NOTED	DESCRIPTION OFFSHORE MORTISE KEY LOCKING	
ALL DIMENSIONS WITHOUT TOLERANCES ARE FOR REFERENCE ONLY.	SIZE A3	SYSTEM NX
PER ASME Y14.5M-1994	DWG NO. J-ME-02-A1C-YY	DATE 13DEC2012
PROPRIETARY ITEM EXCEPT FOR USES EXPRESSLY GRANTED IN WRITING, INFORMATION DISCLOSED HEREON IS CONFIDENTIAL AND ALL RIGHTS, PATENT AND OTHERWISE, ARE RESERVED BY SOUTHCO, INC.	DRAWN BY RFA/DTB	SCALE 1:2
		SHEET 1 OF 2

REVISION HISTORY			
REV	DATE	BY	DESCRIPTION
D	29MAR2023	APA/VK	PRN: P2023-0586

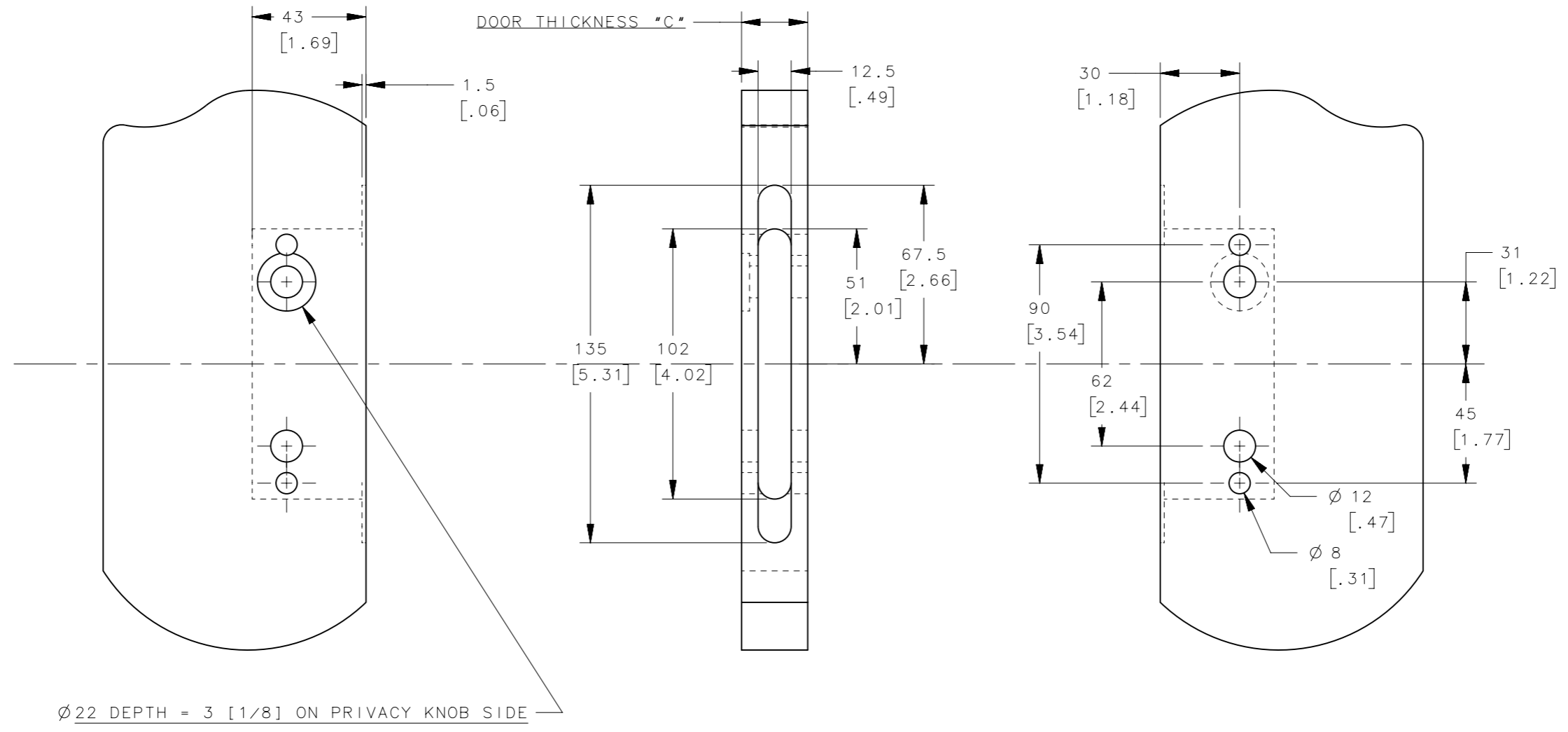

NOTE:
-PANEL PREPERATION FOR ASSEMBLIES ME-02-A1C-YY

THIRD ANGLE PROJECTION		southco [®] CONNECT • CREATE • INNOVATE	
MILLIMETERS [IN]			
TOLERANCES UNLESS OTHERWISE NOTED		DESCRIPTION OFFSHORE FLUSH KEY LOCKING PANEL PREPERATION	
ALL DIMENSIONS WITHOUT TOLERANCES ARE FOR REFERENCE ONLY.		SIZE A3	SYSTEM NX
PROPRIETARY ITEM EXCEPT FOR USES EXPRESSLY GRANTED IN WRITING, INFORMATION DISCLOSED HEREON IS CONFIDENTIAL AND ALL RIGHTS, PATENT AND OTHERWISE, ARE RESERVED BY SOUTHCO, INC.		DWG NO. J-ME-02-A1C-YY	DATE 13DEC2012
PER ASME Y14.5M-1994		DRAWN BY RFA/DTB	SCALE 1:2
		SHEET 2 OF 2	