

6

5

4

3

2

1

REVISION HISTORY			
REV	DATE	BY	DESCRIPTION
F	13MAY2024	CMS/CLB	PRN: P2024-0502

IN-LINE

TWO POINT

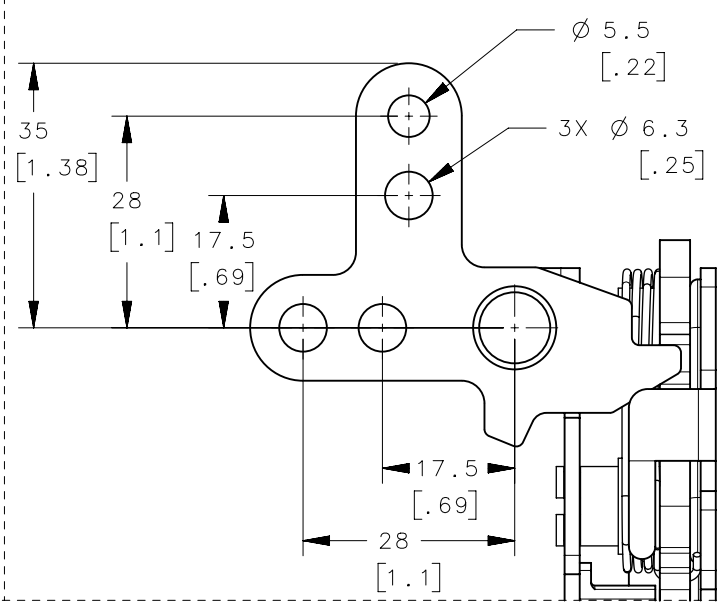
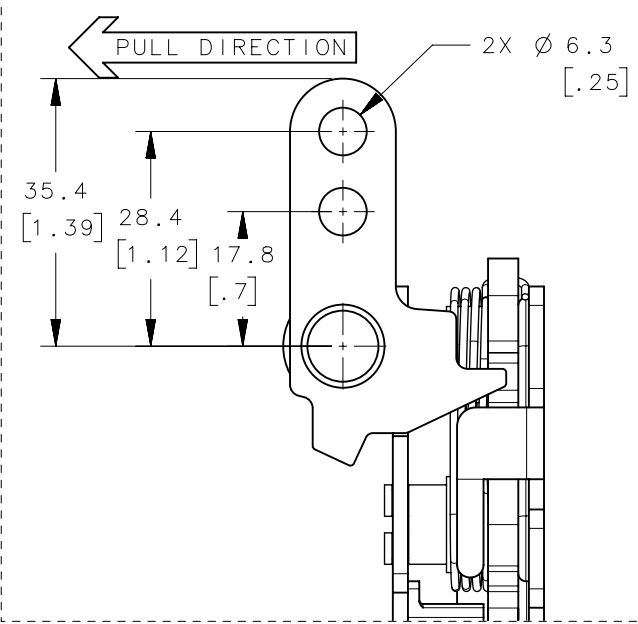

PANEL PREPARATION

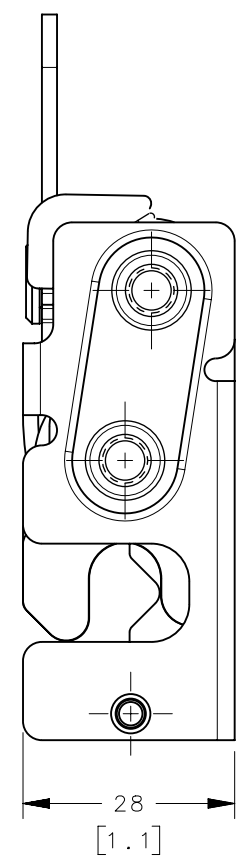
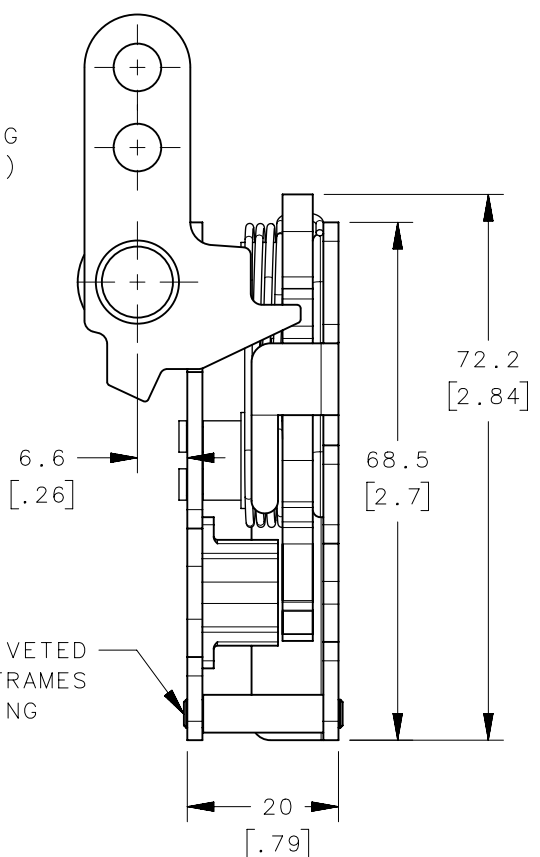
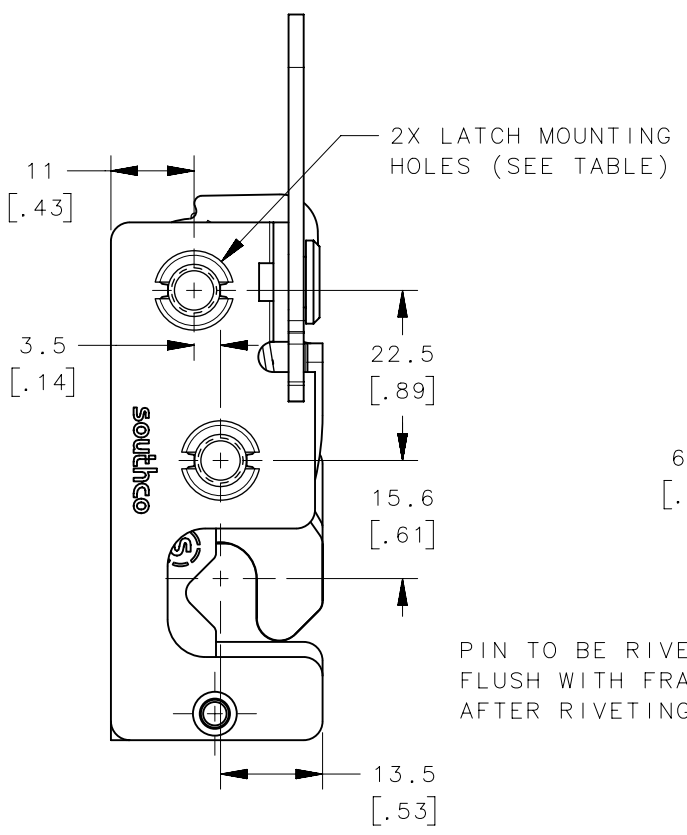
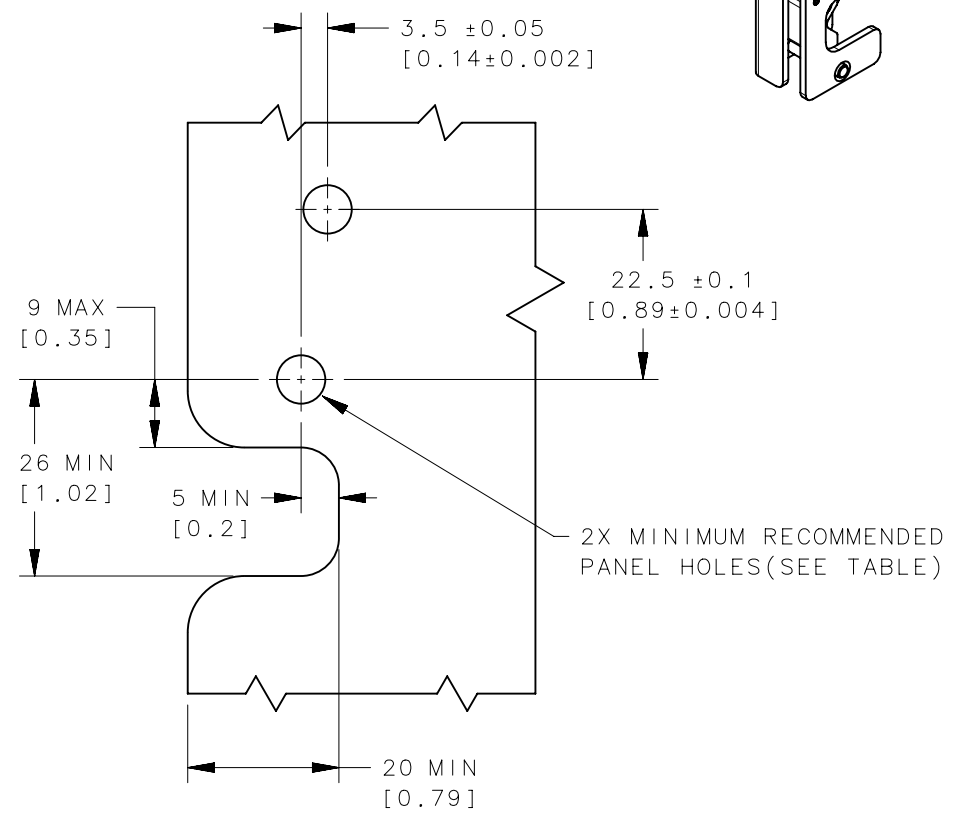

ASSEMBLY PART No. R4-10-05-20

STAGE & ACTUATION

- 2 - SINGLE STAGE, LEFT HAND
- 4 - TWO-STAGE, LEFT HAND

MOUNTING STYLE

- 0 - Ø 7.2 (.283) THRU
- 1 - 1/4-20 THREAD
- 2 - M6x1 THREAD

LEVER TYPE

- 1 - PERPENDICULAR
- 2 - IN-LINE
- 3 - TWO POINT

NOTES:

- A. MATERIAL AND FINISH:
  - HOUSING, LEVER, RIVET AND INTERNAL COMPONENTS: STAINLESS STEEL, PASSIVATED
  - GUIDE: DELRIN, BLACK
  - STOP BLOCK: EPDM, DURO 60, SHORE A
  - SPRING: STEEL, PTFE COATING, BLACK
- B. THESE DIMENSIONS REQUIRED FOR MOUNTING STRIKER BOLT.
- C. Ø 6.3 (.25) LEVER HOLES USE OPTIONAL CABLE RETAINER R4-0-43922 SOLD SEPARATELY.

THIRD ANGLE PROJECTION				
TOLERANCES UNLESS OTHERWISE NOTED		DESCRIPTION		
ALL DIMENSIONS WITHOUT TOLERANCES ARE FOR REFERENCE ONLY.		R4 MINI ROTARY LATCH, SS LEFT HAND - IB - STAINLESS		
PROPRIETARY ITEM	SIZE	SYSTEM	DWG NO.	
EXCEPT FOR USES EXPRESSLY GRANTED IN WRITING, INFORMATION DISCLOSED HEREON IS CONFIDENTIAL AND ALL RIGHTS, PATENT AND OTHERWISE, ARE RESERVED BY SOUTHCO, INC.	B	NX	J-R4-10-5AL-20	
PER ASME Y14.5M-2009	DRAWN BY	DATE	SCALE	SHEET
	CMG/DGJ	09SEP2014	1:1	1 OF 2

6

5

4

3

2

1

REVISION HISTORY			
REV	DATE	BY	DESCRIPTION
F	13MAY2024	CMS/CLB	PRN: P2024-0502

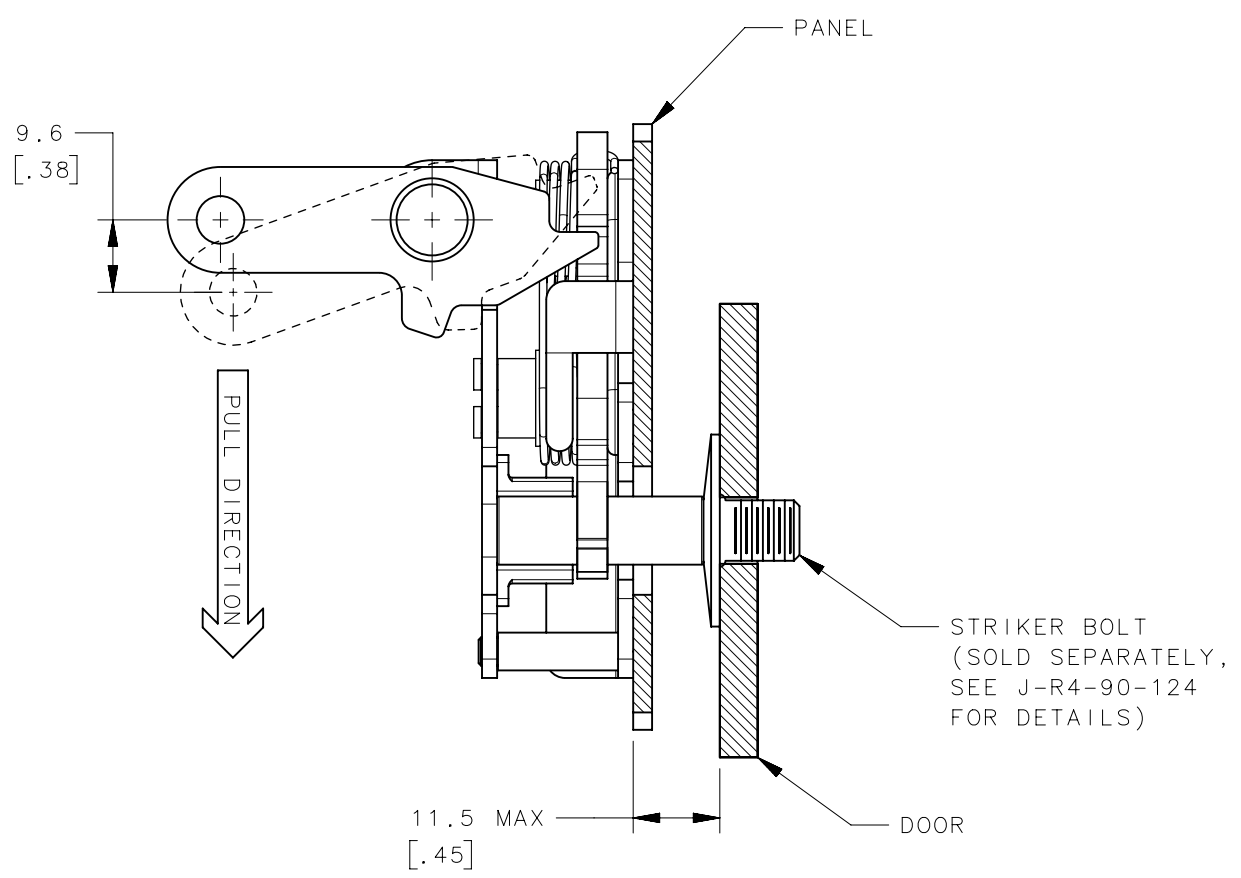

PRIMARY STAGE

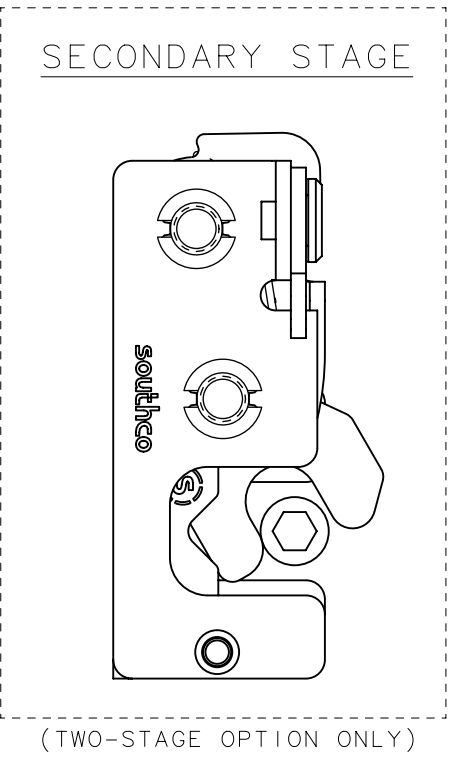
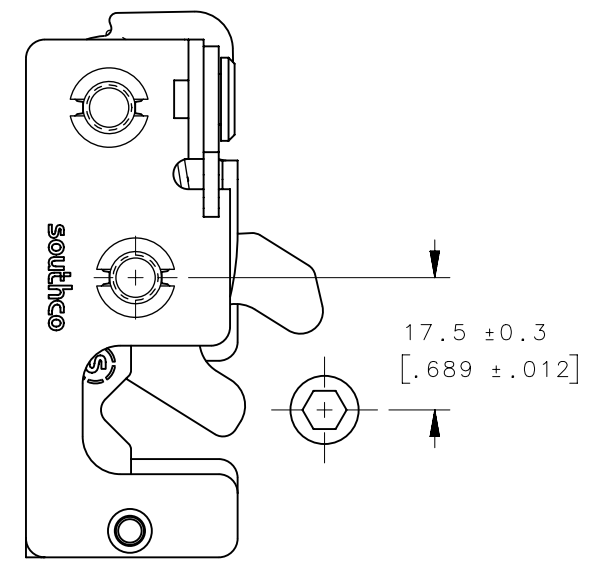

LATCHED STAGE

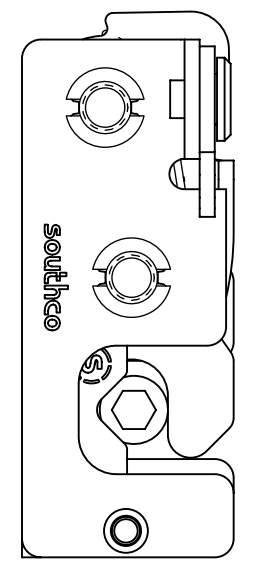

NOTES:

- A. THE TOLERANCE BETWEEN THE LATCH AND STRIKER BOLT ASSUMES A NON-RIGID DOOR INSTALLATION THAT WILL ALLOW THE DOOR TO MOVE INTO THE NOMINAL POSITION DURING LATCHING. RIGID DOORS MUST HAVE THE STRIKER INSTALLED PER THE PANEL PREPARATION RECOMMENDATION.
- B. THE MISALIGNMENT VIEW ASSUMES THE LATCH IS CONNECTED TO A PERFECTLY RIGID DOOR AND HINGE; THERE IS NO DOOR AND/OR HINGE SLACK ASSOCIATED WITH THESE DIMENSIONS. THE MISALIGNMENT VIEW DOES NOT TAKE FLEXING OF THE STRIKER BOLT INTO ACCOUNT.

R4-10-X0-X05-20	Ø 7.2 THRU	Ø 7.2 [.299]
R4-10-X1-X05-20	1/2-20 THREAD	Ø 6.8 [.268]
R4-10-X2-X05-20	M6X1 THREAD	Ø 6.4 [.252]
PART NUMBER	MOUNTING STYLE	MINIMUM PANEL HOLE

THIRD ANGLE PROJECTION				<b>southco</b> <sup>®</sup> CONNECT • CREATE • INNOVATE	
MILLIMETERS [IN]					
TOLERANCES UNLESS OTHERWISE NOTED		DESCRIPTION		R4 MINI ROTARY LATCH, SS	
ALL DIMENSIONS WITHOUT TOLERANCES ARE FOR REFERENCE ONLY.		SIZE		LEFT HAND - IB - STAINLESS	
PROPRIETARY ITEM		SYSTEM		DWG NO.	
EXCEPT FOR USES EXPRESSLY GRANTED IN WRITING, INFORMATION DISCLOSED HEREON IS CONFIDENTIAL AND ALL RIGHTS, PATENT AND OTHERWISE, ARE RESERVED BY SOUTHCO, INC.		NX		J-R4-10-5AL-20	
PER ASME Y14.5M-2009		DRAWN BY		SCALE	
		CMG/DGJ		1:1	
		DATE		SHEET	
		09SEP2014		2 OF 2	