

6

5

4

3

2

1

HAND ACTUATION

BOTTOM ACTUATION

TOP ACTUATION

REVISION HISTORY

REV	DATE	BY	DESCRIPTION
C	22MAR2024	SDR/CRM	PRN: P2024-0494

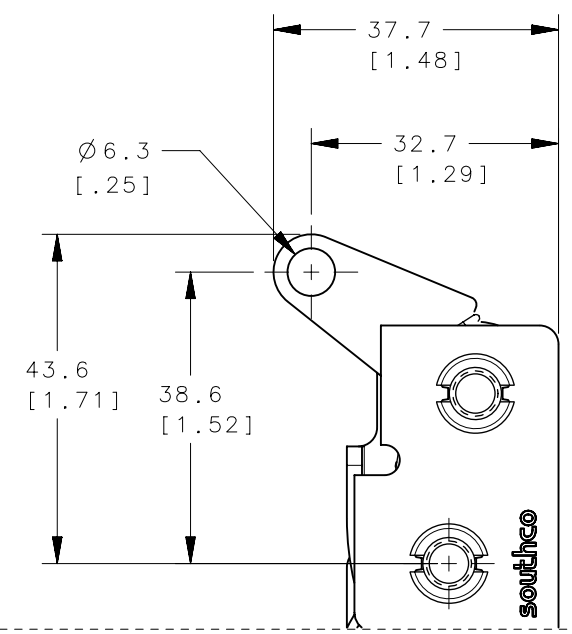
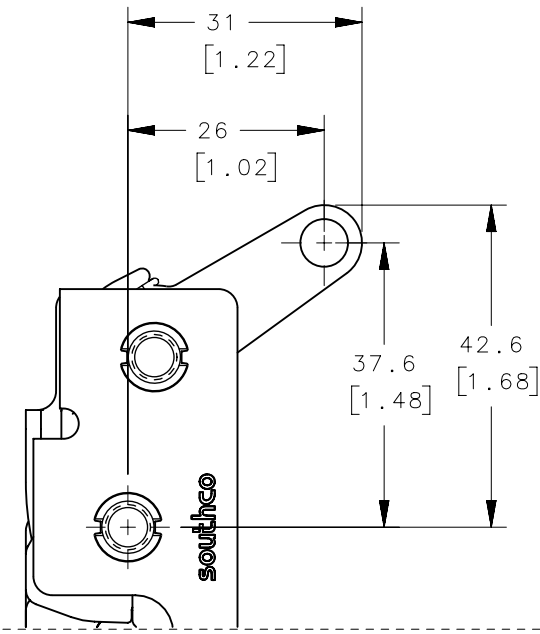
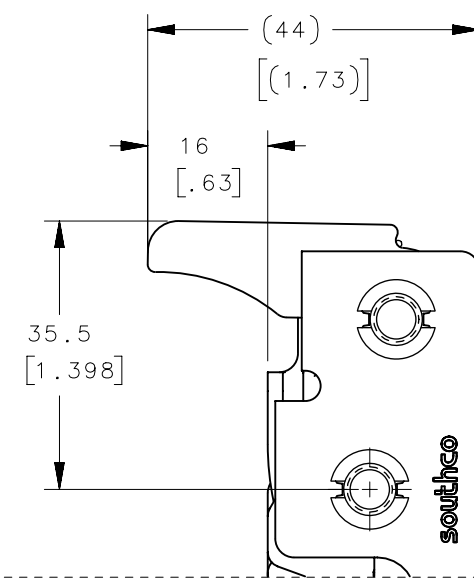

PANEL PREPARATION

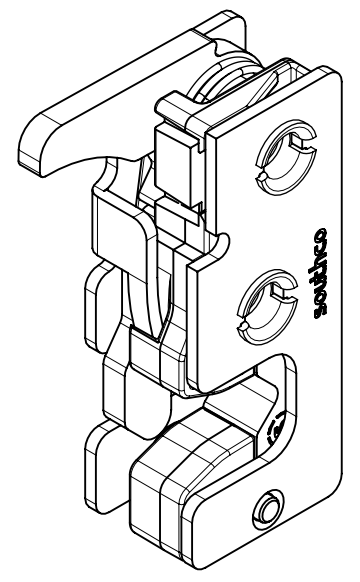
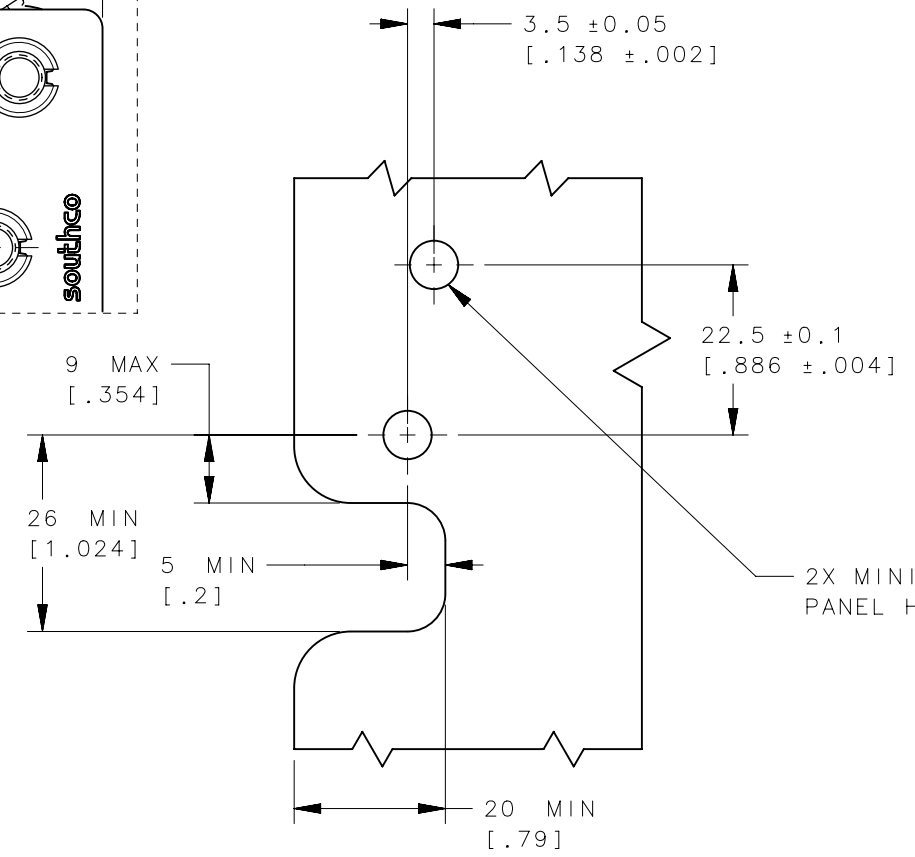

SCALE 1:1

BOTTOM ACTUATION SHOWN

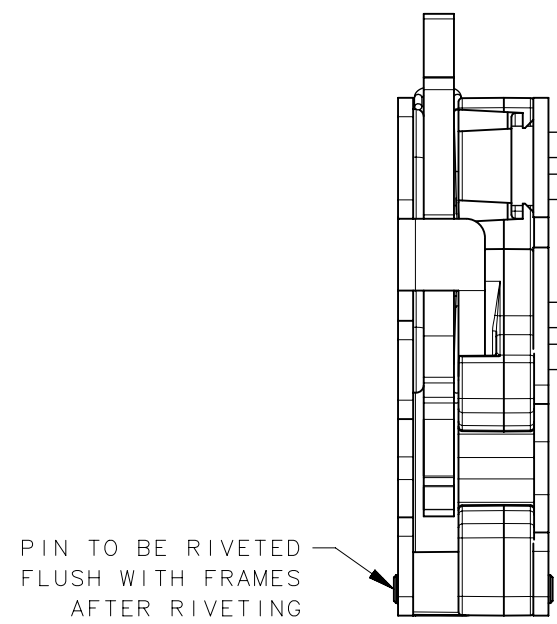
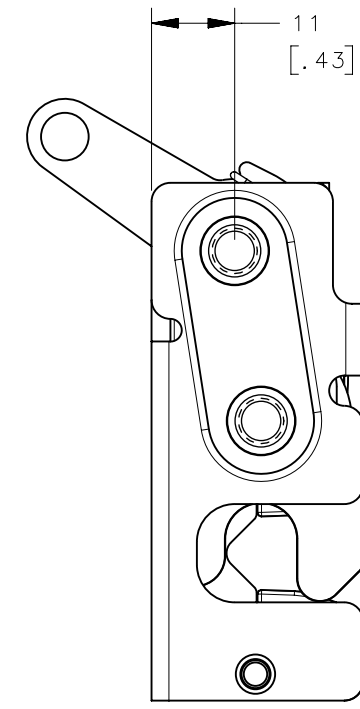

PIN TO BE RIVETED FLUSH WITH FRAMES AFTER RIVETING

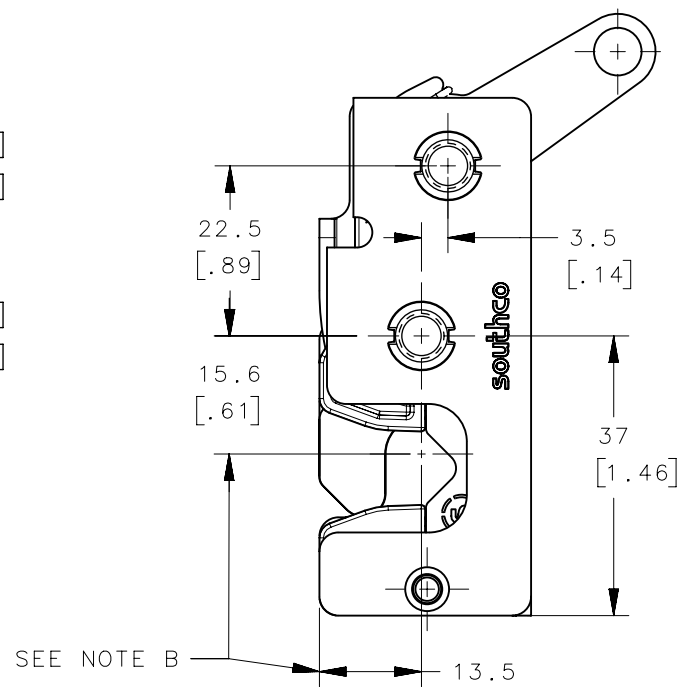

SEE NOTE B

NOTES:

- A. MATERIAL AND FINISH:
 - HOUSING, LEVER, RIVET AND INTERNAL COMPONENTS: STAINLESS STEEL, PASSIVATED
 - GUIDE: DELRIN, BLACK
 - STOP BLOCK: EPDM, DURO 60, SHORE A
 - SPRING: PTFE COATING, BLACK.
- B. THESE DIMENSIONS REQUIRED FOR MOUNTING STRIKER BOLT.

ASSEMBLY PART No.

R4-10-□□-□□05-20

STAGE & ACTUATION

- 1 - SINGLE STAGE, RIGHT HAND
- 3 - TWO-STAGE, RIGHT HAND

MOUNTING STYLE

- 0 - Ø7.2 (.283) THRU
- 1 - 1/4-20 THREAD
- 2 - M6x1 THREAD

LEVER TYPE

- 4 - HAND ACTUATION
- 5 - BOTTOM ACTUATION
- 6 - TOP ACTUATION

THIRD ANGLE PROJECTION	
MILLIMETERS [IN]	
TOLERANCES UNLESS OTHERWISE NOTED	
ALL DIMENSIONS WITHOUT TOLERANCES ARE FOR REFERENCE ONLY.	
PER ASME Y14.5M-2009	

southco CONNECT · CREATE · INNOVATE			
DESCRIPTION R4 MINI ROTARY LATCH RIGHT HAND - 1B - STAINLESS			
SIZE B	SYSTEM NX	DWG NO. J-R4-10-5BR-20	
DRAWN BY YK/DGJ	DATE 31DEC2014	SCALE 1:1	SHEET 1 OF 3

6

5

4

3

2

1

REVISION HISTORY			
REV	DATE	BY	DESCRIPTION
C	22MAR2024	SDR/CRM	PRN: P2024-0494

HAND ACTUATION SHOWN

PRIMARY STAGE

SECONDARY STAGE

LATCHED STAGE

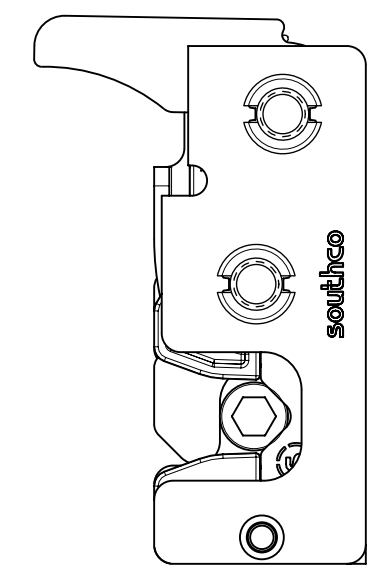
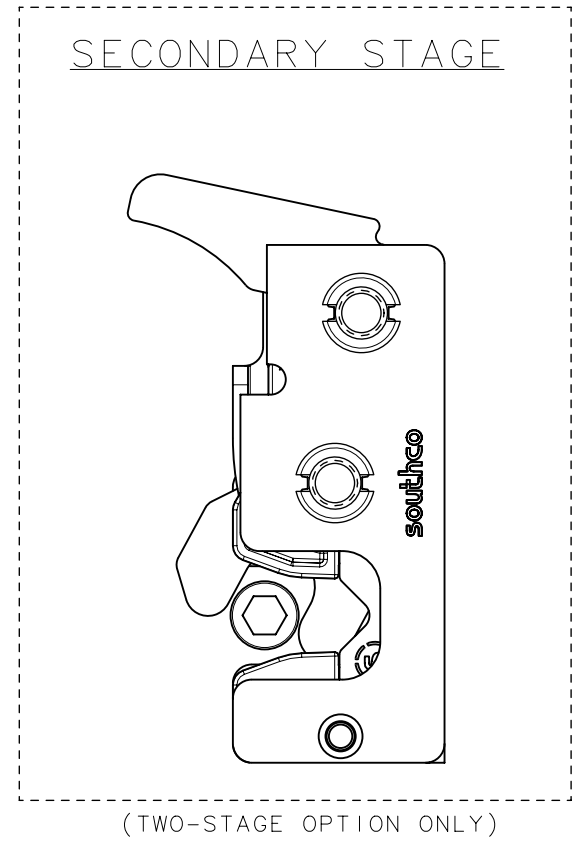
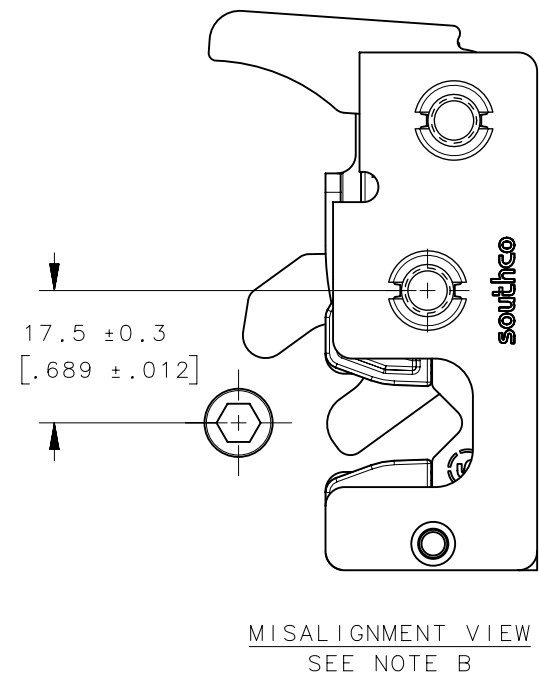
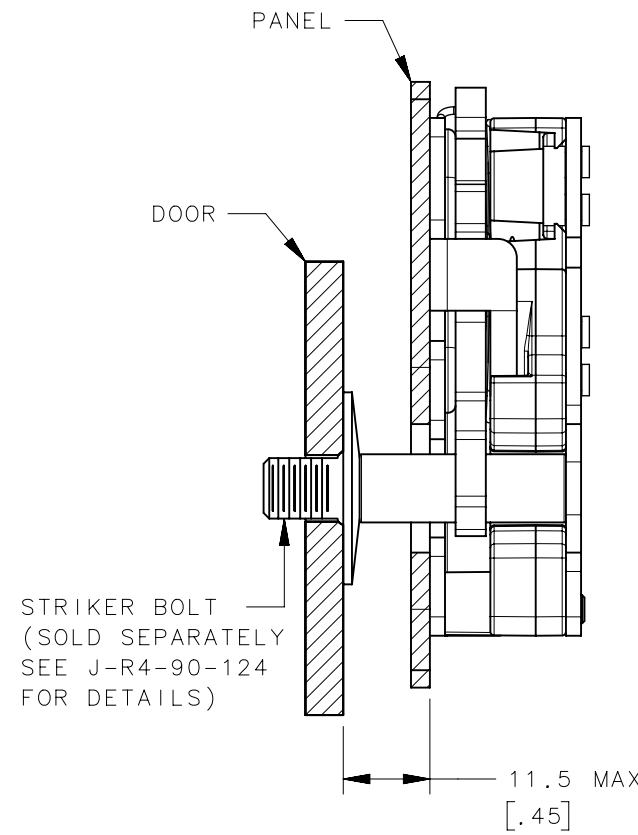

NOTES:

- A. THE TOLERANCE BETWEEN THE LATCH AND STRIKER BOLT ASSUMES A NON-RIGID DOOR INSTALLATION THAT WILL ALLOW THE DOOR TO MOVE INTO THE NOMINAL POSITION DURING LATCHING. RIGID DOORS MUST HAVE THE STRIKER INSTALLED PER THE PANEL PREPARATION RECOMMENDATION.
- B. THE MISALIGNMENT VIEW ASSUMES THE LATCH IS CONNECTED TO A PERFECTLY RIGID DOOR AND HINGE; THEREFORE, THERE IS NO DOOR AND/OR HINGE SLACK ASSOCIATED WITH THESE DIMENSIONS. THE MISALIGNMENT VIEW DOES NOT TAKE FLEXING OF THE STRIKER BOLT INTO ACCOUNT.

R4-10-X0-X05-20	Ø 7.2 THRU	Ø 7.2 [.299]
R4-10-X1-X05-20	1/2-20 THREAD	Ø 6.8 [.268]
R4-10-X2-X05-20	M6X1 THREAD	Ø 6.4 [.252]
PART NUMBER	MOUNTING STYLE	MINIMUM PANEL HOLE

THIRD ANGLE PROJECTION			 CONNECT · CREATE · INNOVATE	
MILLIMETERS [IN]				
TOLERANCES UNLESS OTHERWISE NOTED	DESCRIPTION R4 MINI ROTARY LATCH RIGHT HAND - 1B - STAINLESS			
ALL DIMENSIONS WITHOUT TOLERANCES ARE FOR REFERENCE ONLY.	SIZE B	SYSTEM NX	DWG NO. J-R4-10-5BR-20	
PROPRIETARY ITEM EXCEPT FOR USES EXPRESSLY GRANTED IN WRITING, INFORMATION DISCLOSED HEREON IS CONFIDENTIAL AND ALL RIGHTS, PATENT AND OTHERWISE, ARE RESERVED BY SOUTHCO, INC.	PER ASME Y14.5M-2009	DRAWN BY YK/DGJ	DATE 31DEC2014	SCALE 1:1 SHEET 2 OF 3

6

5

4

3

2

1

REVISION HISTORY			
REV	DATE	BY	DESCRIPTION
C	22MAR2024	SDR/CRM	PRN: P2024-0494

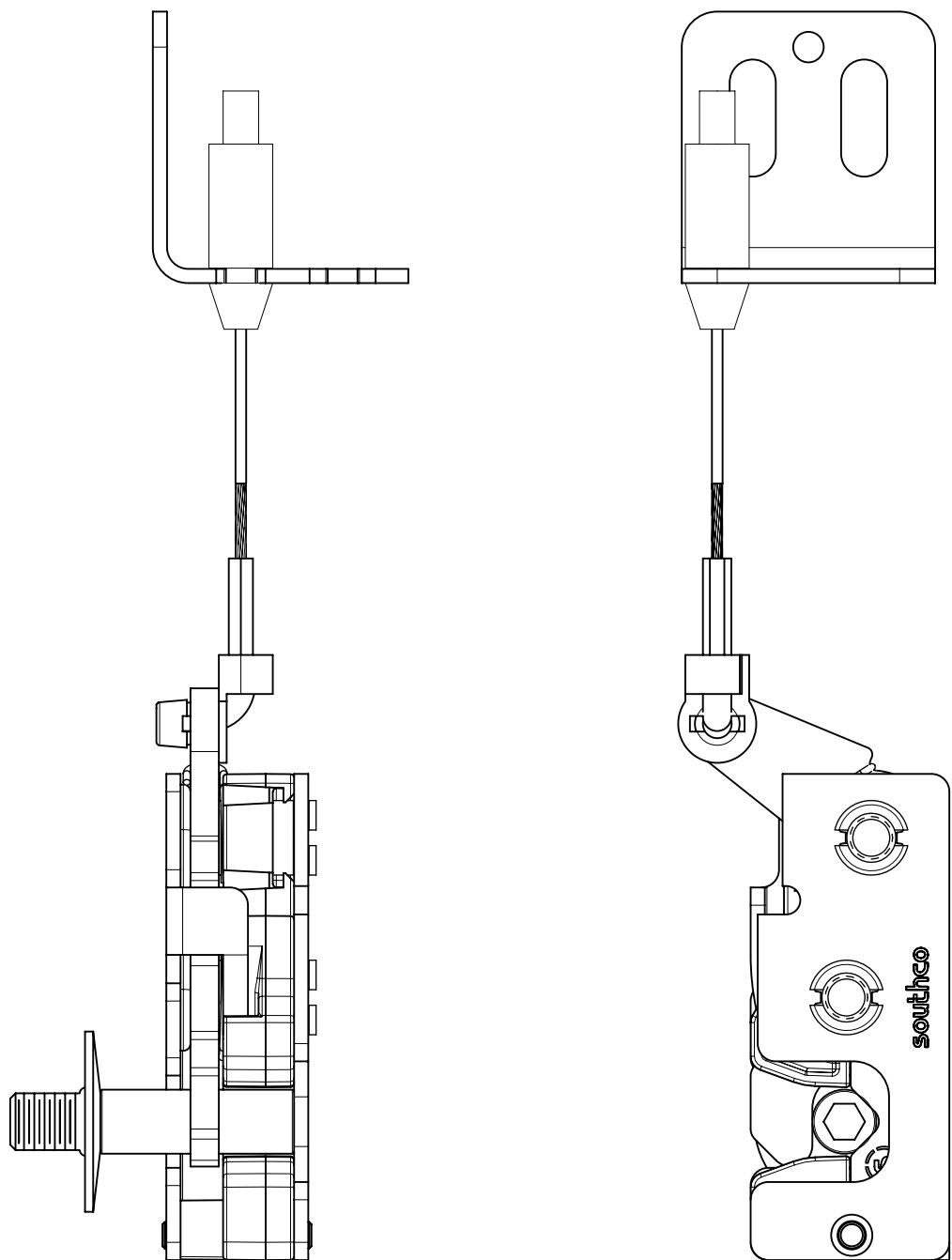
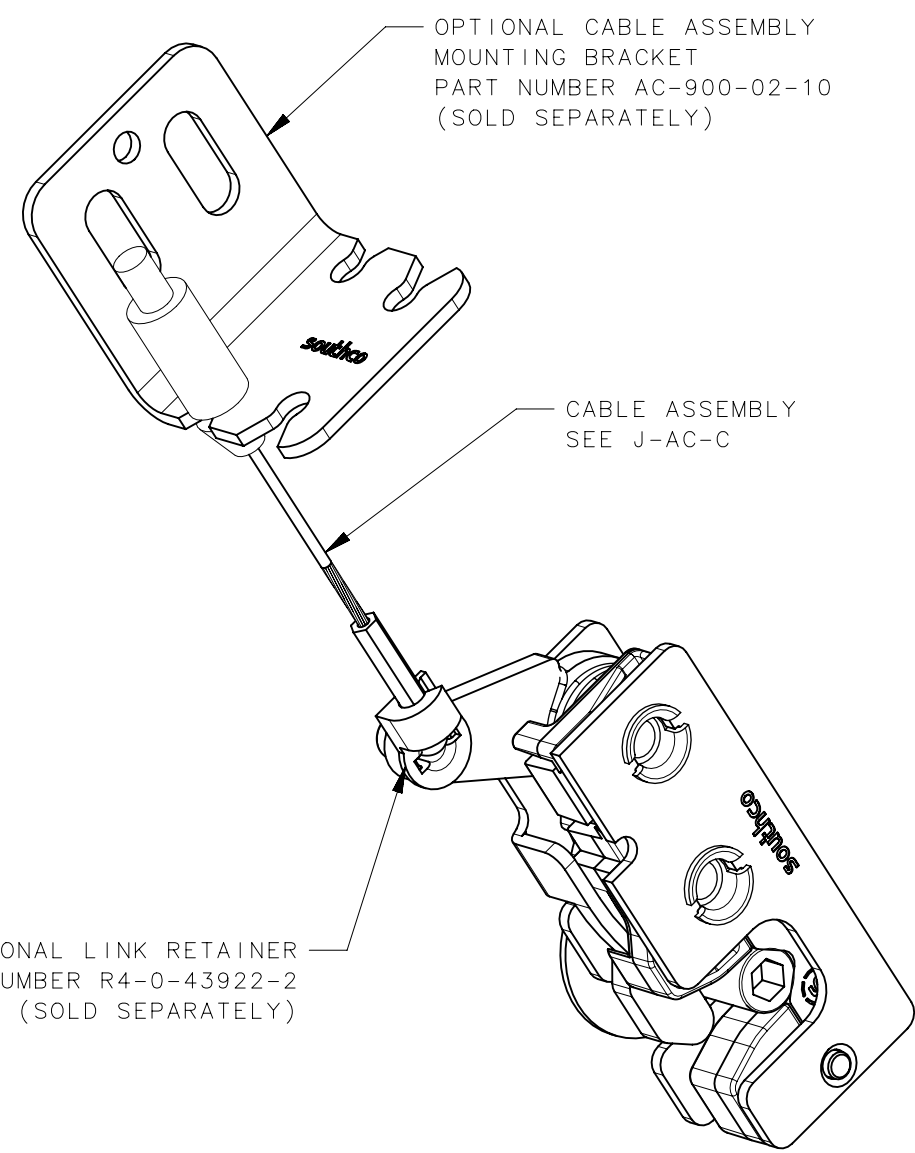

TOP ACTUATION SHOWN

PROPRIETARY ITEM <small>EXCEPT FOR USES EXPRESSLY GRANTED IN WRITING, INFORMATION DISCLOSED HEREON IS CONFIDENTIAL AND ALL RIGHTS, PATENT AND OTHERWISE, ARE RESERVED BY SOUTHCO, INC.</small>	THIRD ANGLE PROJECTION				southco [®] CONNECT • CREATE • INNOVATE		
	MILLIMETERS [IN]						
	TOLERANCES UNLESS OTHERWISE NOTED	DESCRIPTION			R4 MINI ROTARY LATCH RIGHT HAND - 1B - STAINLESS		
	ALL DIMENSIONS WITHOUT TOLERANCES ARE FOR REFERENCE ONLY.	SIZE	SYSTEM	DWG NO.	J-R4-10-5BR-20		
PER ASME Y14.5M-2009	B	NX	DATE	31DEC2014	SCALE	1:1	SHEET 3 OF 3
	YK/DGJ						

6

5

4

3

2

1