

R4-30-4 I-70 B-M

| REVISION HISTORY | | | |
|------------------|-----------|---------|-----------------|
| REV | DATE | BY | DESCRIPTION |
| E | 27FEB2024 | SAK/DMS | PRN: P2024-0346 |

I MOUNTING OPTION
 0 6.7 mm THRU HOLE
 1 1/4-20 THREAD
 2 M6 THREAD

B LATCHING
 1 STANDARD
 5 INTEGRATED BUMPER

M MATERIAL
 10 STEEL, ZINC PLATED
 15 STEEL, BLACK ZINC NICKEL PLATED
 77 STEEL, ZINC NICKEL PLATED

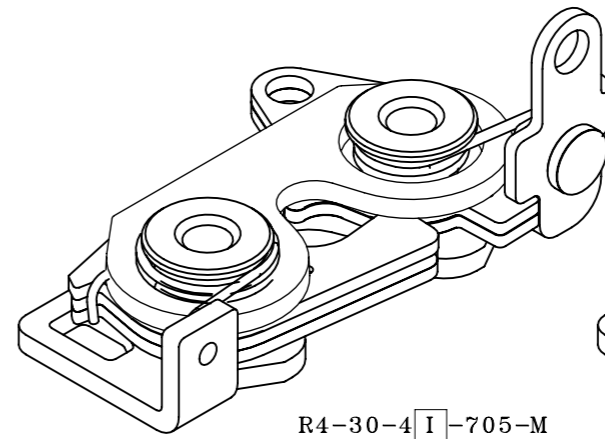

R4-30-4 I-705-M
(INTEGRATED BUMPER)

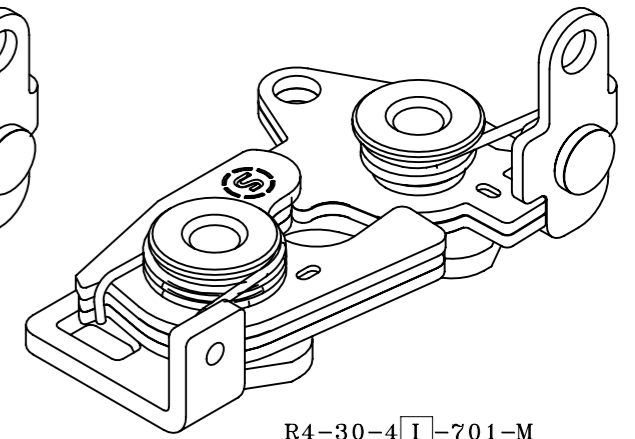

R4-30-4 I-701-M
(STANDARD)

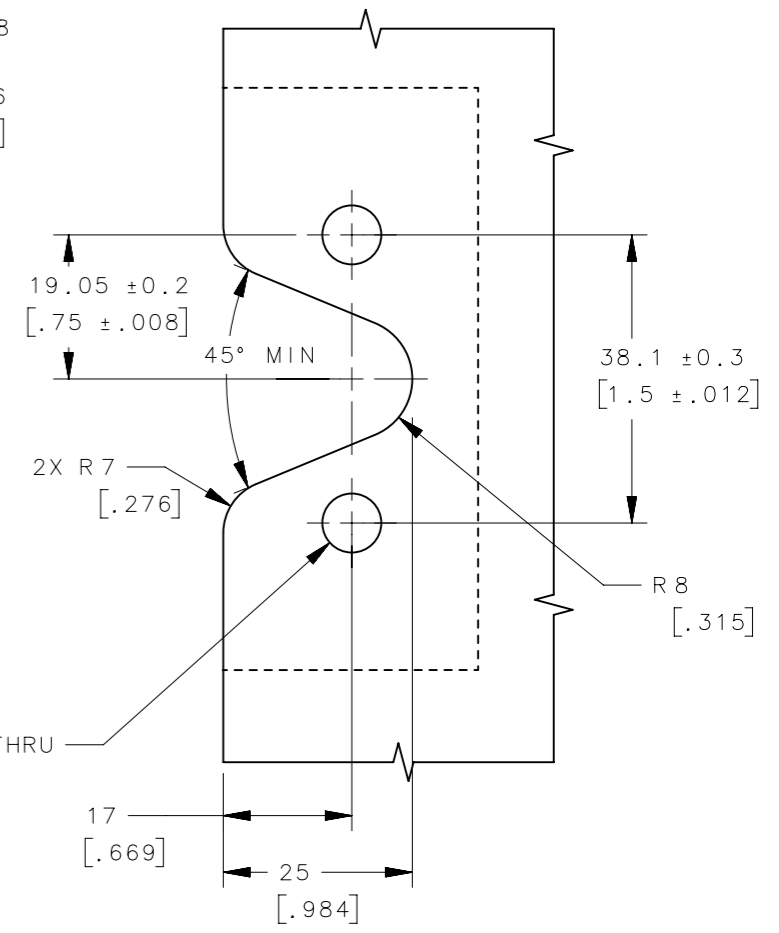
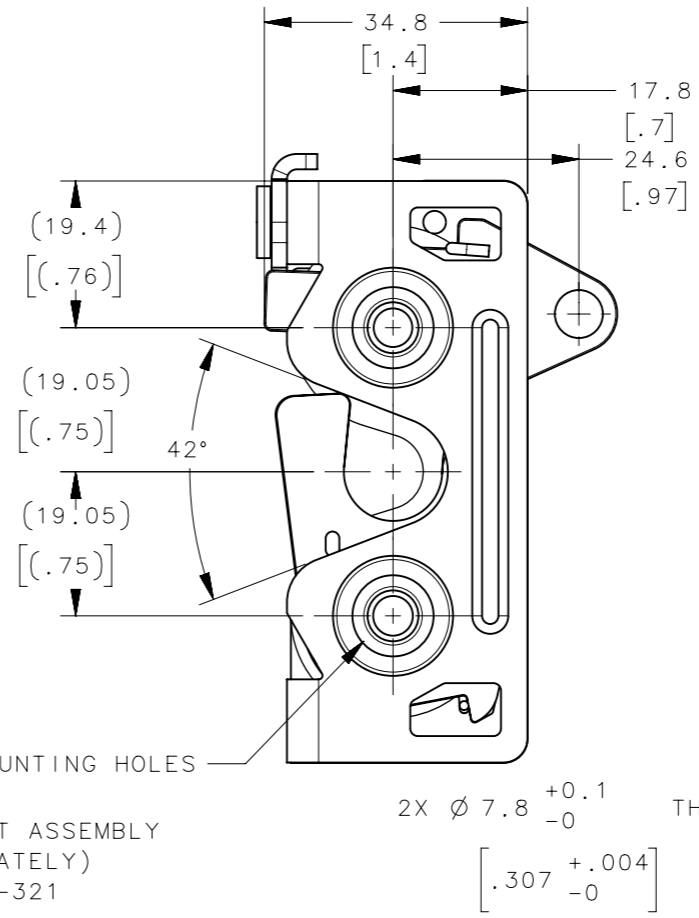
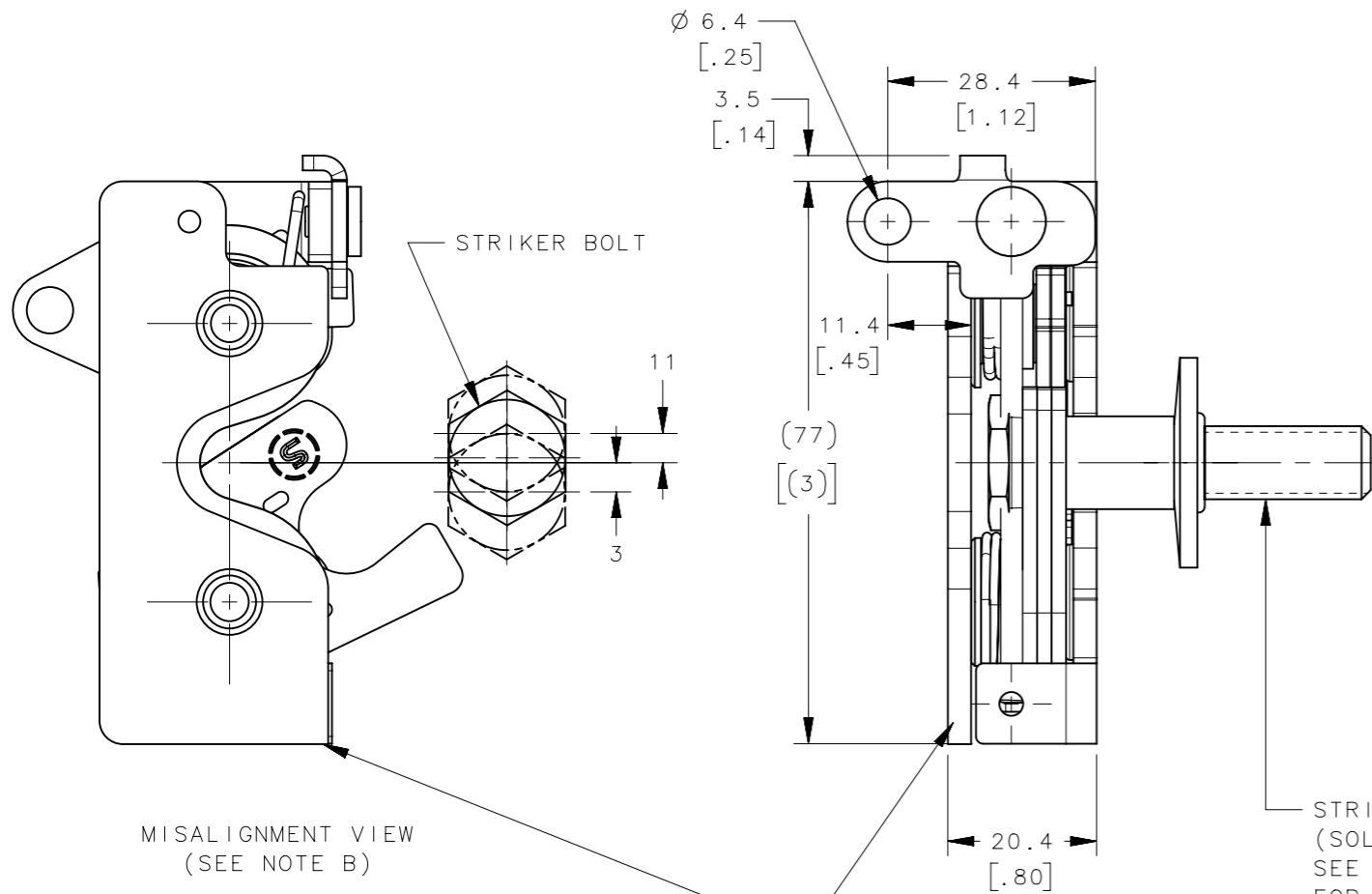

OPTIONAL: (SOLD SEPARATELY)
 SUPPORT PLATE (R4-38-101-10)
 SEE J-R4-38-101 FOR DETAILS

NOTES:

A. MATERIAL AND FINISH:

- HOUSING, LEVER AND INTERNAL COMPONENTS: STEEL
- PAWL AND TRIGGER: HARDENED STEEL,
- SPRING: STAINLESS STEEL, PASSIVATED

B. THE MISALIGNMENT VIEW ASSUMES THE LATCH IS CONNECTED TO A PERFECTLY RIGID DOOR AND HINGE; THEREFORE, THERE IS NO DOOR AND/OR HINGE SLACK ASSOCIATED WITH THESE DIMENSIONS, THE MISALIGNMENT VIEW DOES NOT TAKE FLEXING OF THE STRIKER BOLT INTO ACCOUNT.

C. RECOMMENDED MOUNTING TORQUE IS 9 Nm (80 INCH LBS)

| | | | |
|---|--|---|-------------------|
| THIRD ANGLE PROJECTION | | CONNECT · CREATE · INNOVATE | |
| MILLIMETERS [IN] | | | |
| TOLERANCES UNLESS OTHERWISE NOTED | | DESCRIPTION R4 LATCH ASSEMBLY - DUAL TRIGGER LEFT HAND ACTUATION | |
| ALL DIMENSIONS WITHOUT TOLERANCES ARE FOR REFERENCE ONLY. | | SIZE A3 | SYSTEM NX |
| PER ASME Y14.5M-2009 | | DWG NO. J-R4-30-40-701 | DATE 24JAN2017 |
| DRAWN BY RMO | | SCALE 1:1 | SHEET 1 OF 1 |