

PROPRIETY ITEM - EXCEPT FOR USES EXPRESSLY GRANTED IN WRITING.  
 INFORMATION DISCLOSED HEREON IS CONFIDENTIAL AND ALL RIGHTS  
 PATENT AND OTHERWISE ARE RESERVED BY SOUTHCO, INC.

PART NUMBER ST-12C- [ZZO] FA [Y] - [XX]

FINISH (XX) PART NUMBER SELECTION	
XX DESIGNATION	FINISH DESCRIPTION
33	NATURAL ZINC
50	FINISH

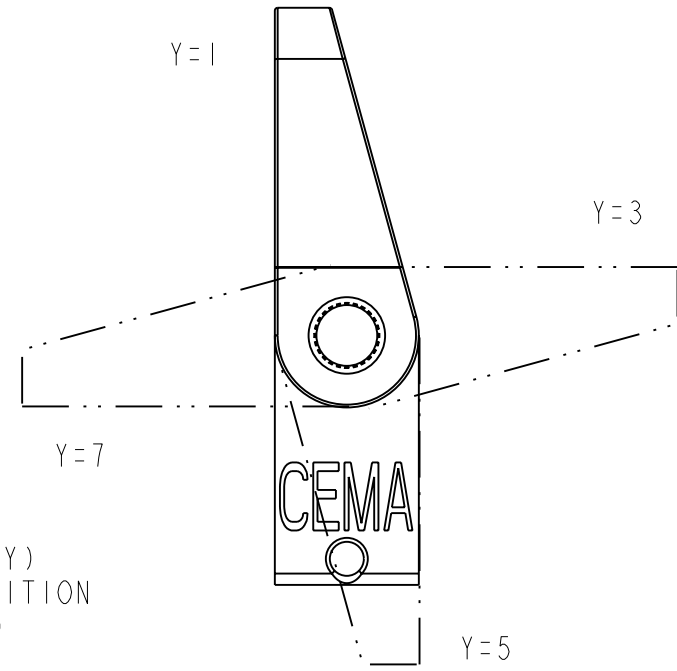

ADAPTER ANGLE (Y)  
 IN SHIPPING POSITION  
 (TOLERANCE  $\pm 5^\circ$ )

FRICTION TORQUE IN HIGH DIRECTION (ZZO) PART NUMBER SELECTION (TOLERANCE $\pm 15\%$ )		
ZZO DESIGNATION	HIGH TORQUE (lb-in)	LOW TORQUE (lb-in)
200	20	12
280	28	16.8
360	36	21.6
440	44	26.4

REVISION RECORD			
SYMB	DESCRIPTION	BY	DATE

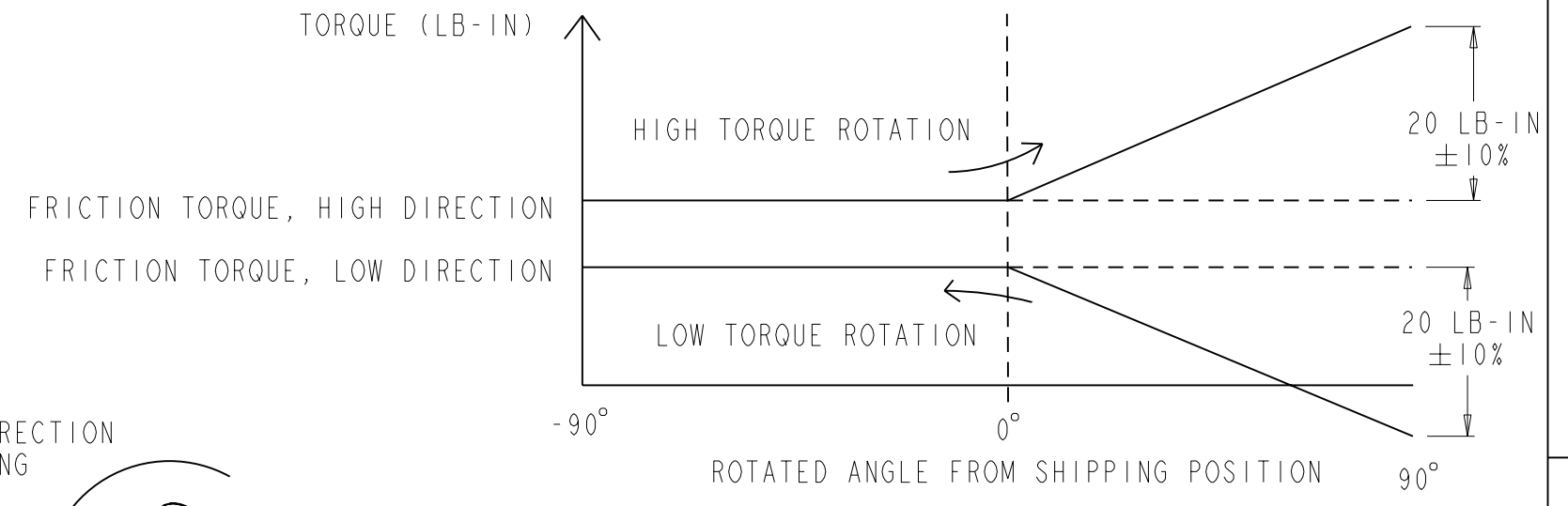

HIGH TORQUE DIRECTION  
 ADAPTER ROTATING

HIGH TORQUE DIRECTION  
 ADAPTER ROTATING

**TYPE A**  
**PART # ST-12C-200FA1-33 (20 lb-in)**  
**(SHOWN DIMENSIONED)**

**TYPE B**  
**PART # ST-12C-200FB1-33**  
**(MIRROR OF TYPE A)**

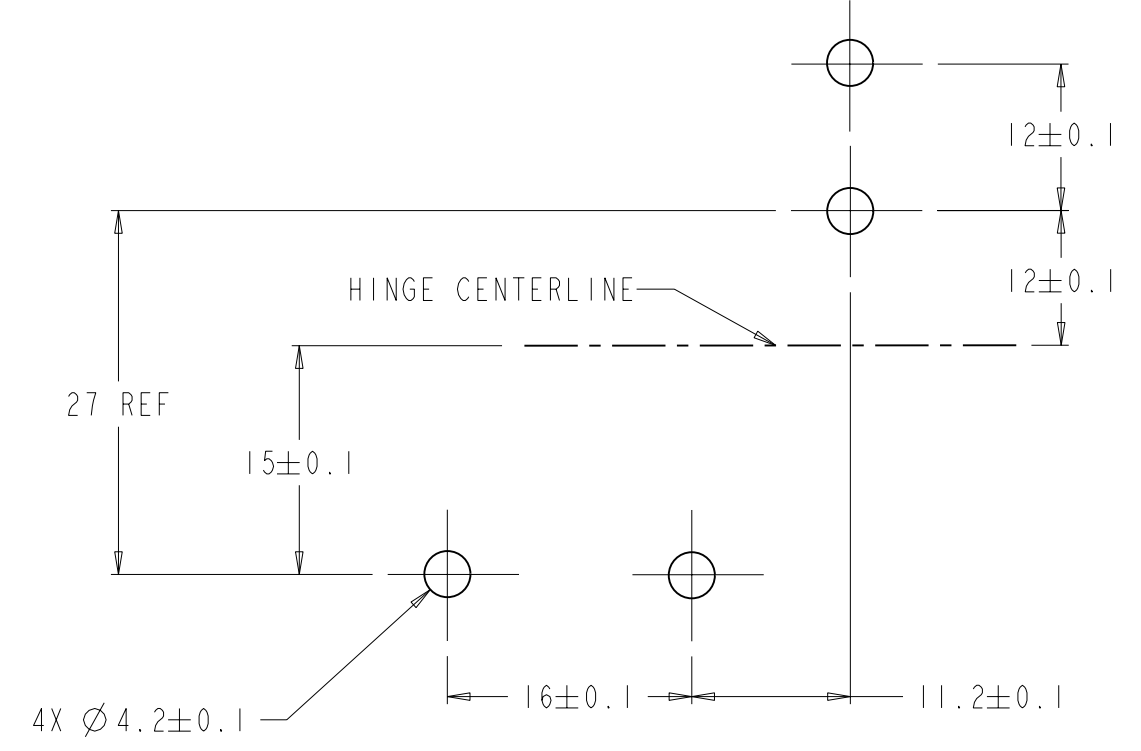
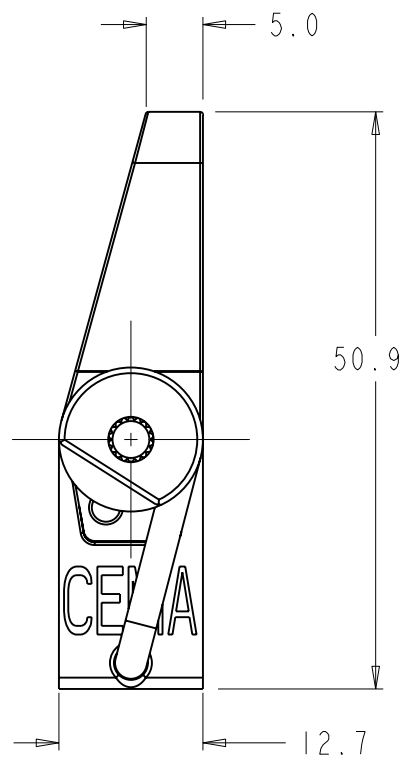
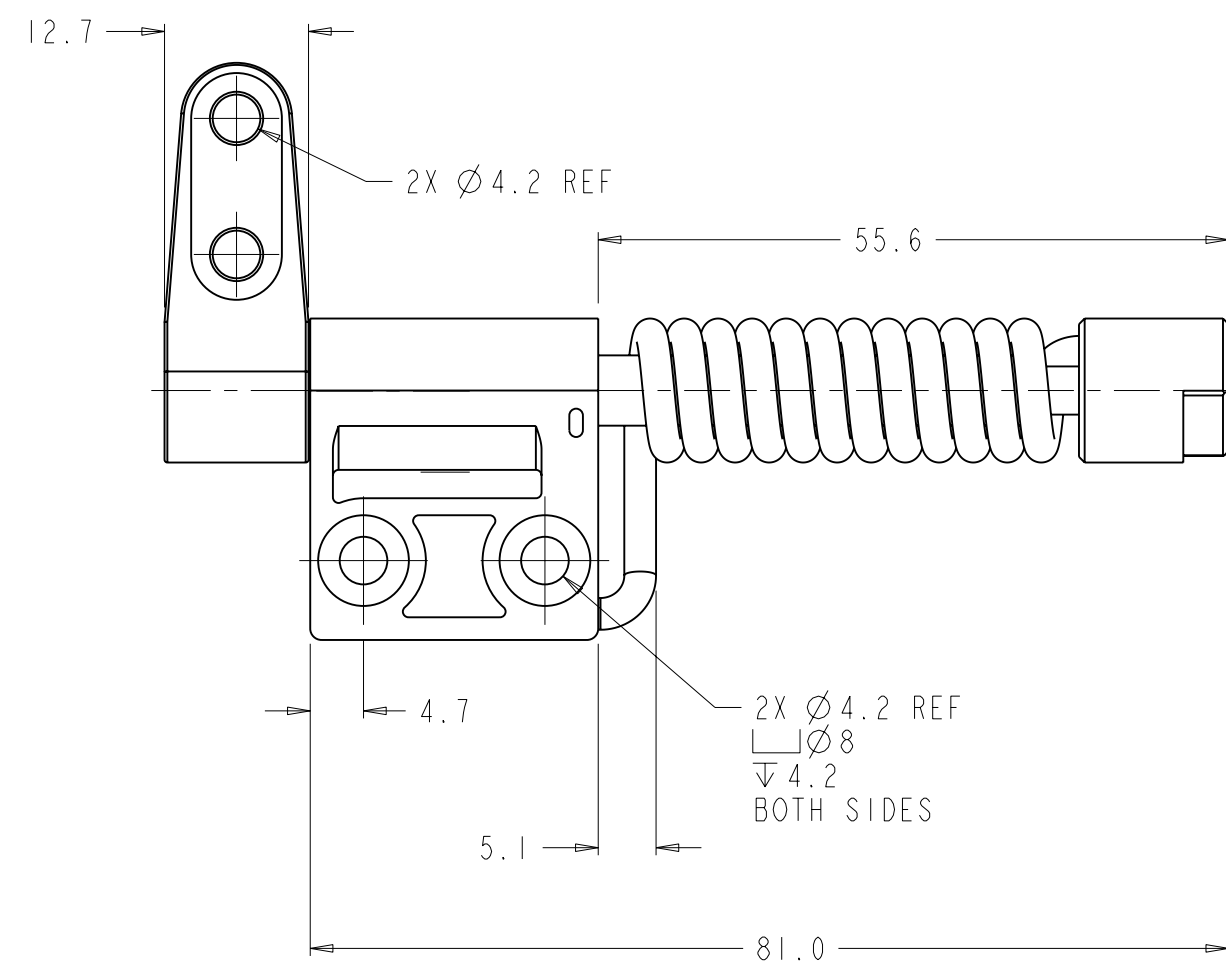
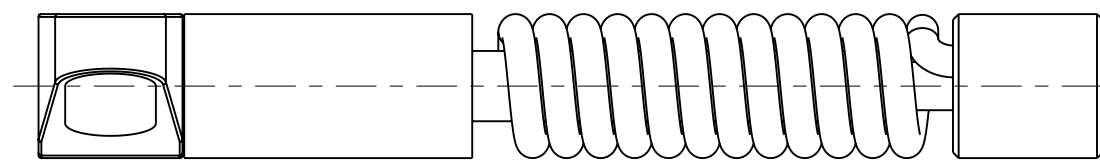

**PANEL PREPARATION**

**NOTES:**

1. MATERIALS:  
 HOUSING, ADAPTER, BEARING AND SPRING CAP- ZINC ALLOY  
 FINISH: SEE TABLE  
 SHAFT, PIN AND TORQUE ELEMENTS - HARDENED STEEL  
 SPRING - MUSIC WIRE
2. INSTALL HINGE USING A No. 8 OR M4 SOCKET HEAD CAP SCREW
3. FOR PROPER FUNCTION, ASSEMBLY MUST INCLUDE A MIRRORED PAIR OF (1) TYPE "A" & (1) TYPE "B" HINGE
4. ALLOWABLE RANGE OF MOTION: 90 DEGREES IN EITHER DIRECTION FROM SHIPPING POSITION

ALL DIMENSIONS  
 ARE IN MILLIMETERS  
 ALL DIMENSIONS  
 WITHOUT  
 TOLERANCES  
 ARE FOR  
 REFERENCE  
 ONLY

**southco®**

DESIGNER MJC 28NOV06	DRAFTER MJC 28NOV06
MODEL NAME ST-12C-AF	SCALE 1.500
	3.2 ALL SURFACES EXCEPT AS NOTED

TITLE ST-12 COUNTERBALANCED HINGE ASSEMBLY	
DWG No J-ST-12C-F	REVISION A
SOUTHCO PART NUMBER AS NOTED	
CALC. WEIGHT	FORMAT C