

PROPRIETY ITEM - EXCEPT FOR USES EXPRESSLY GRANTED IN WRITING.
 INFORMATION DISCLOSED HEREON IS CONFIDENTIAL AND ALL RIGHTS
 PATENT AND OTHERWISE ARE RESERVED BY SOUTHCO, INC.

PART NUMBER ST-12C- [ZZ0] RA [Y] - [XX]

FINISH (XX) PART NUMBER SELECTION	
XX DESIGNATION	FINISH DESCRIPTION
33	NATURAL ZINC
50	BLACK POWDER COAT

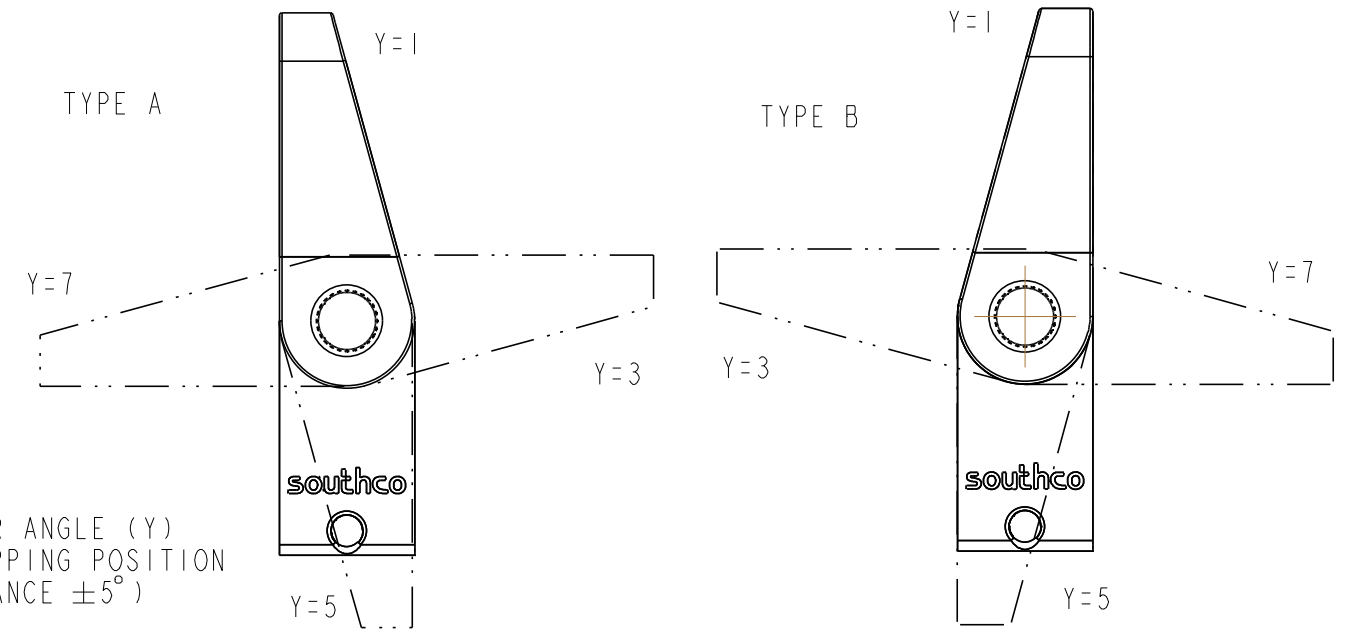

ADAPTER ANGLE (Y)
 IN SHIPPING POSITION
 (TOLERANCE $\pm 5^\circ$)

FRICTION TORQUE (ZZ0) PART NUMBER SELECTION (TOLERANCE $\pm 20\%$)		
ZZ0 DESIGNATION	HIGH TORQUE (lb-in)	LOW TORQUE (lb-in)
200	20	13.6
280	28	19.1
360	36	24.6
440	44	30.0

REVISION RECORD			
SYMB	DESCRIPTION	BY	DATE
C	P2008-0269	EN	13MAR08
D	PRN: P2008-1306	JT	21JAN09

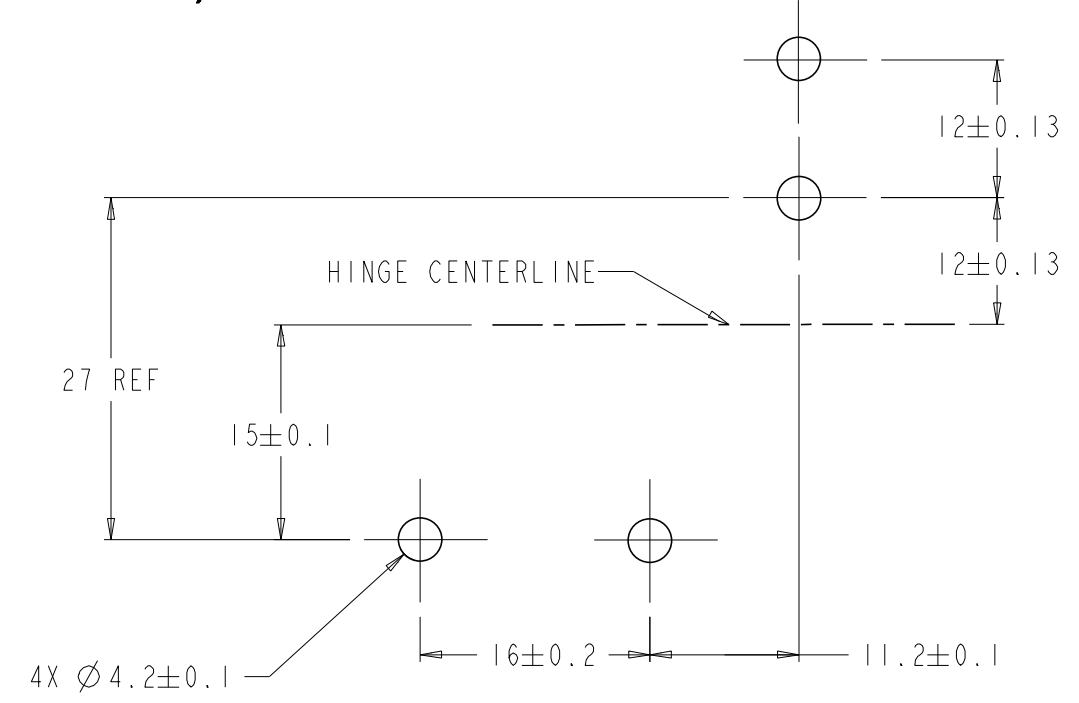
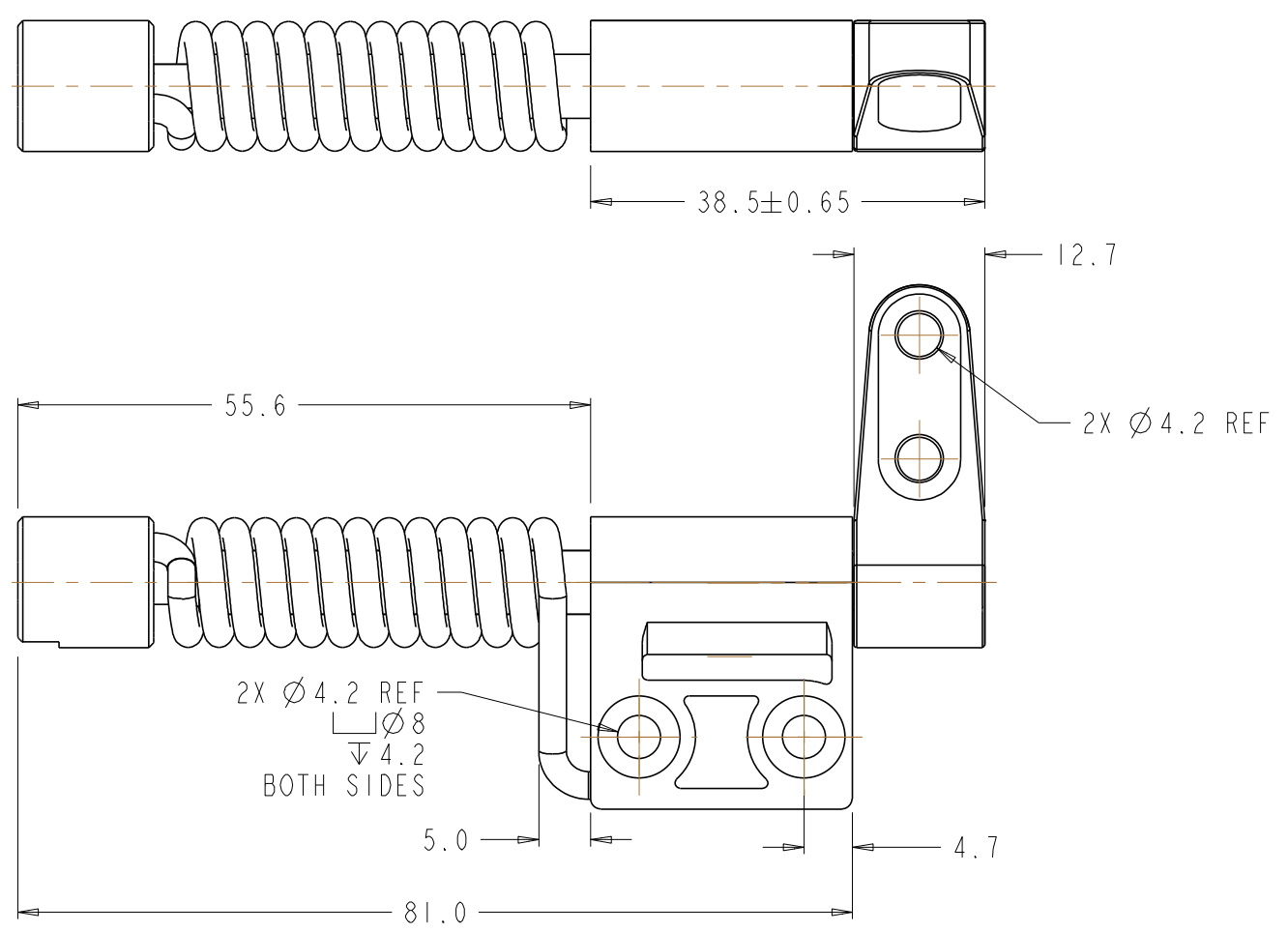
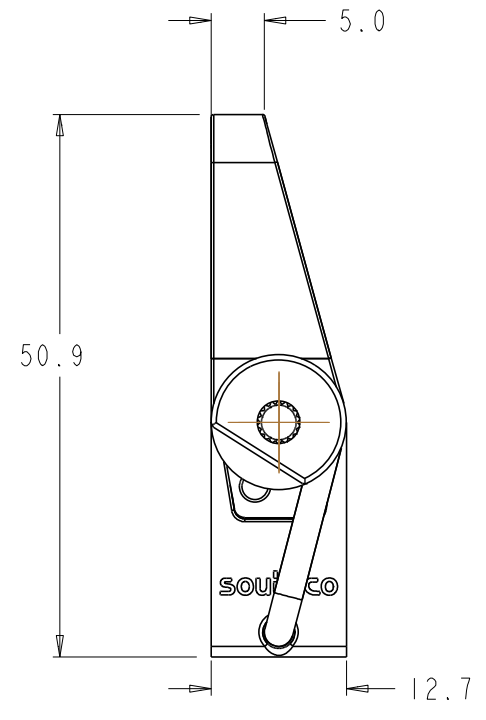
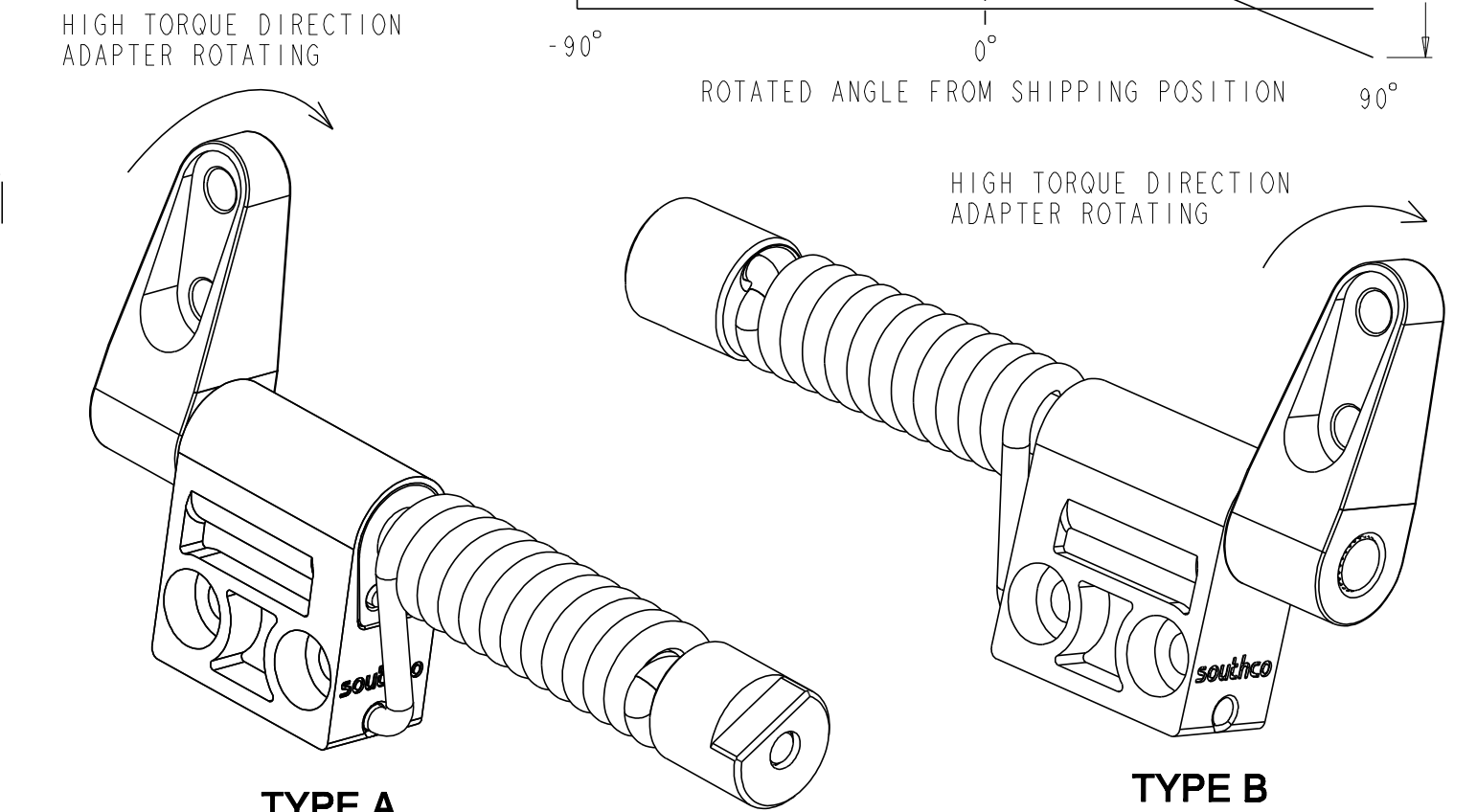
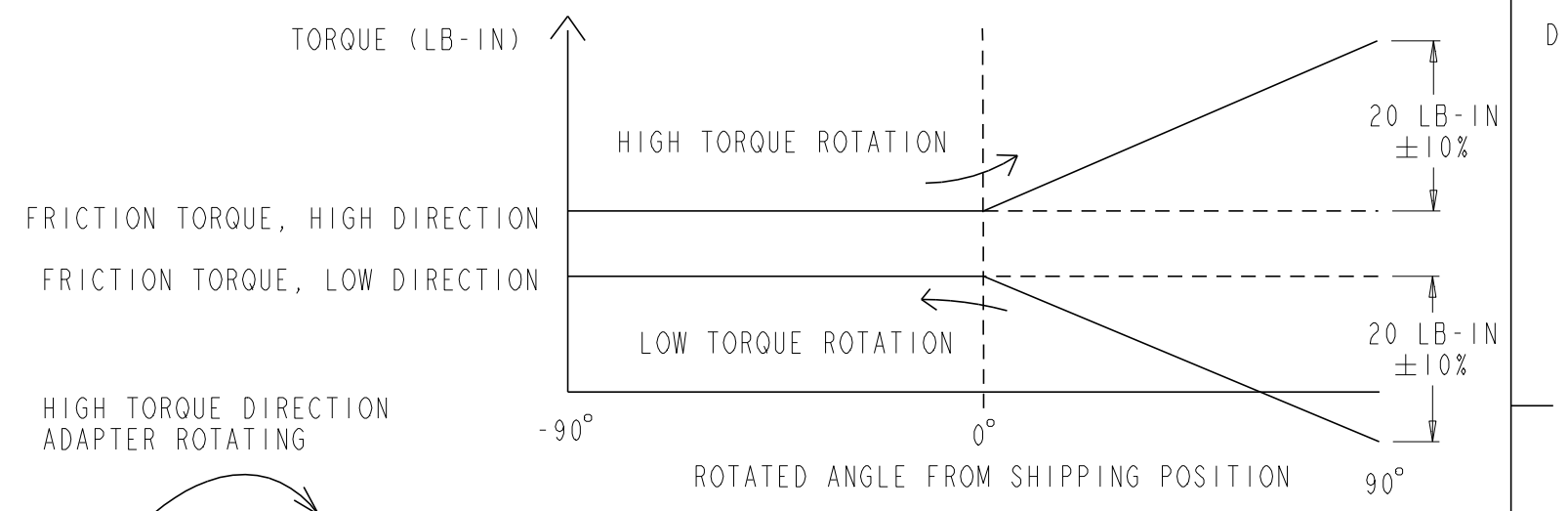

PANEL PREPARATION

- NOTES:
- MATERIAL:
 HOUSING, ADAPTER, BEARING AND SPRING CAP- ZINC ALLOY
 FINISH: SEE TABLE
 SHAFT, PIN AND TORQUE ELEMENTS - HARDENED STEEL
 SPRING - MUSIC WIRE
 - INSTALL HINGE USING A No. 8 OR M4 SOCKET HEAD CAP SCREW
 - FOR PROPER FUNCTION, ASSEMBLY MUST INCLUDE A MIRRORRED PAIR OF (1) TYPE "A" & (1) TYPE "B" HINGE
 - ALLOWABLE RANGE OF MOTION: 90 DEGREES IN EITHER DIRECTION FROM SHIPPING POSITION

ALL DIMENSIONS ARE IN MILLIMETERS ALL DIMENSIONS WITHOUT TOLERANCES ARE FOR REFERENCE ONLY		southco		TITLE ST-12 COUNTERBALANCED HINGE ASSEMBLY REVERSE	
DESIGNER MJC 28NOV06	DRAFTER MJC 28NOV06	DWG No J-ST-12C-R	REVISION D		
MODEL NAME ST-12C-AF	SCALE 1:500	SOUTHCO PART NUMBER AS NOTED			
3.2 ALL SURFACES EXCEPT AS NOTED		CALC. WEIGHT	FORMAT C		