

ST-12C Hinge

Position control · Constant torque · Counterbalanced

- Counterbalance spring allows easy opening
- Space efficient design provides high torque in minimum space
- Constant torque, never needs adjusting

Material and Finish

Zinc alloy and steel, natural

Performance Details

Radial load:

Maximum static load:

1000 N (225 lbf)

Axial load:

Maximum static load:

1200 N (270 lbf)

Cycle performance:

20,000 cycles within ±20% of static torque specification

Installation Notes

1. Install hinge using M4 (No. 8) socket head cap screw.
2. For proper function, assembly must include (1) type A and (1) type B hinge.
3. Application must limit rotation ±90° from shipping position.

Application

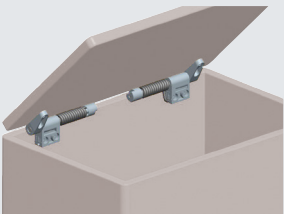

Part Number

See table

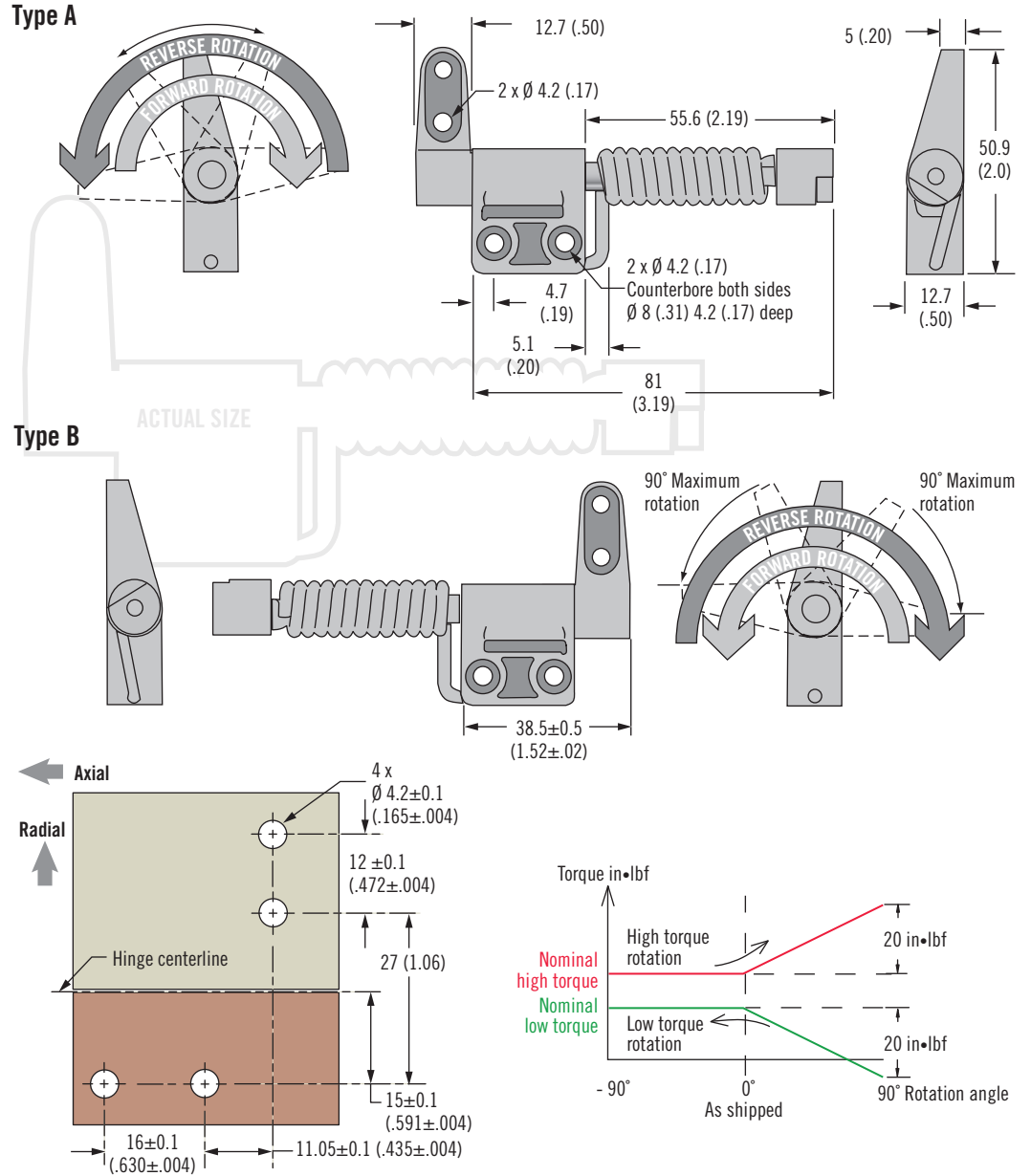

| Part Number | | Static Torque N·m (in·lbf) | |
|------------------|------------------|----------------------------|----------------------|
| Type A | Type B | Forward N·m (in·lbf) | Reverse N·m (in·lbf) |
| ST-12C-200FA1-33 | ST-12C-200FB1-33 | 2.3 (20) | 1.5 (13.6) |
| ST-12C-280FA1-33 | ST-12C-280FB1-33 | 3.2 (28) | 2.2 (19.1) |
| ST-12C-360FA1-33 | ST-12C-360FB1-33 | 4.1 (36) | 2.8 (24.6) |
| ST-12C-440FA1-33 | ST-12C-440FB1-33 | 5 (44) | 3.4 (30) |
| ST-12C-200RA1-33 | ST-12C-200RB1-33 | 1.5 (13.6) | 2.3 (20) |
| ST-12C-280RA1-33 | ST-12C-280RB1-33 | 2.2 (19.1) | 3.2 (28) |
| ST-12C-360RA1-33 | ST-12C-360RB1-33 | 2.8 (24.6) | 4.1 (36) |
| ST-12C-440RA1-33 | ST-12C-440RB1-33 | 3.4 (30) | 5 (44) |