

DRAWING NUMBER	TD-V2-1-J
SCALE	1:1
CHKD	CHW
DRAWN	AAB
DATE	29APR2004

ALL DIMENSIONS WITHOUT TOLERANCES ARE FOR REFERENCE ONLY.



GENERAL PERFORMANCE GUIDELINES

THE INFORMATION SHOWN ON THIS PAGE WAS DETERMINED UNDER ONE SET OF TEST CONDITIONS. SINCE CONDITIONS VARY WITH EACH APPLICATION IT IS SUPPLIED AS GENERAL GUIDE ONLY. NO SAFETY FACTOR HAS BEEN APPLIED. WE RECOMMEND TESTING THE PRODUCT UNDER ACTUAL APPLICATION CONDITIONS TO DETERMINE THE SUITABILITY FOR INTENDED USE.

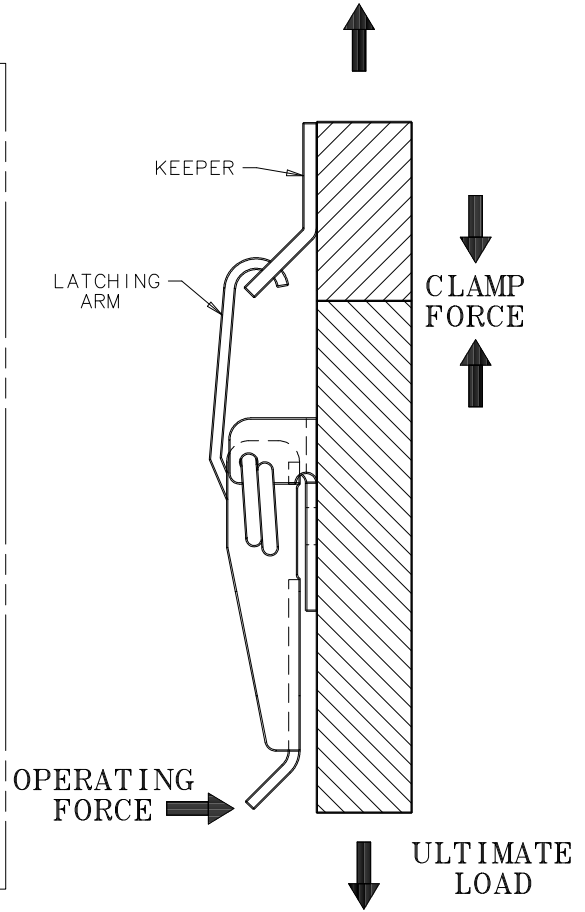
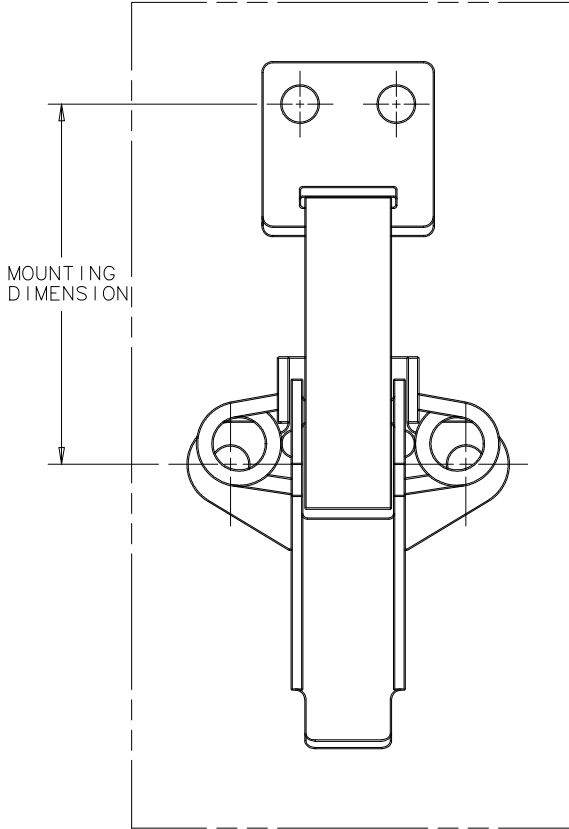

NO. V2 VERSA LATCH DRAW LATCH, SMALL SERIES, SHORT BLADE

PROPRIETARY ITEM - EXCEPT FOR USES EXPRESSLY GRANTED IN WRITING INFORMATION DISCLOSED HEREON IS CONFIDENTIAL AND ALL RIGHTS PATENT AND OTHERWISE ARE RESERVED BY SOUTHCO, INC.

southco

REV	DATE	DRAWN/CHKD	DESCRIPTION

PART NUMBERS	MATERIAL	MOUNTING DIMENSION	CLAMP FORCE (SEE NOTE A)	OPERATING FORCE (SEE NOTE B)	ULTIMATE LOAD (SEE NOTE C)
LATCH V2-0025-07 PLUS	CARBON STEEL	(55 mm) 2.17 in.	(330 N) 76 lbs.	(31 N) 7 lbs.	(1770 N) 400 lbs.
KEEPER PLATE V2-0018-07		(57.3 mm) 2.26 in.	(700 N) 160 lbs.	(66 N) 15 lbs.	
LATCH V2-0025-52 PLUS	STAINLESS STEEL	(55 mm) 2.17 in.	(260 N) 60 lbs.	(22 N) 5 lbs.	(1690 N) 380 lbs.
KEEPER PLATE V2-0018-52		(57.3 mm) 2.26 in.	(530 N) 120 lbs.	(57 N) 13 lbs.	

NOTES:

- A. CLAMP FORCE IS THE FORCE EXERTED ON THE MOUNTING PANELS BY THE LATCH AND KEEPER.
- B. OPERATING FORCE IS THE FORCE PERPENDICULAR TO THE MOUNTING SURFACE REQUIRED TO FULLY CLOSE THE LATCH.
- C. ULTIMATE FORCE IS THE FORCE WHICH CAUSES DEFORMATION OF THE LATCHING ARM, RESULTING IN FAILURE OF THE ASSEMBLY.