



# N6 铰链

表面安装 · 304 或 316 不锈钢

- 冲压铰链结构
- 高光泽处理选择
- 铰链盖面选择

## 材料及表面处理

不锈钢, 钝化或高光泽

## 性能详述

径向载荷:

最大静载荷: 534N

轴向载荷:

最大静载荷: 534N

## 安装说明

不提供螺钉

使用M5(8-32)埋头螺钉安装铰链

## 供可选盖面:

另外订购盖

清洁铰链叶表面, 去除污垢、油渍或油脂。

撕下背面胶纸, 将盖套在铰链上, 用力按压粘合。

### 系列1 (参阅零件号表格)

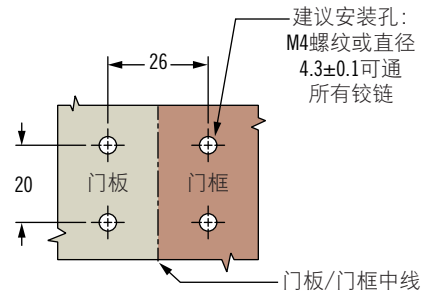
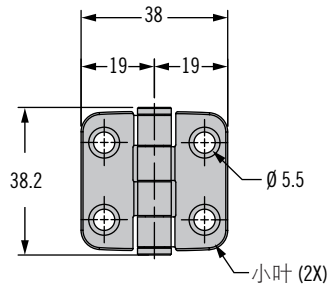

### 系列2 (参阅零件号表格)

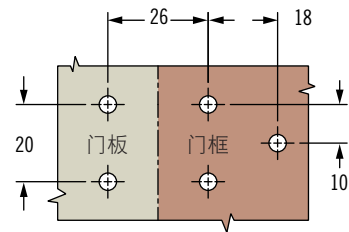
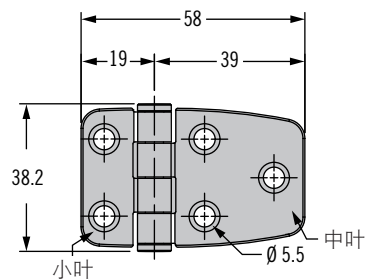

### 系列3 (参阅零件号表格)

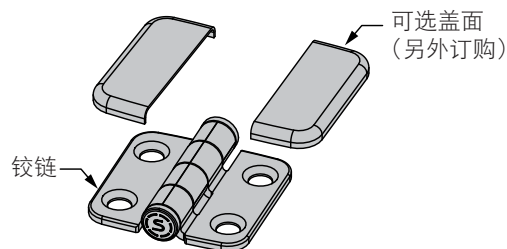
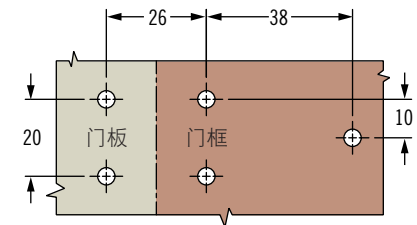
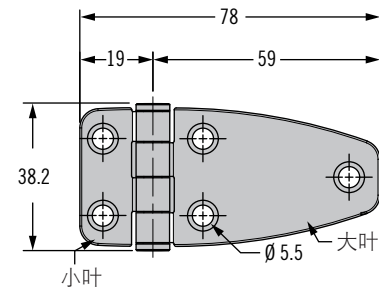

## 零件号

铰链和盖面需另外订购

## 零件号

304 不锈钢,  
钝化

316 不锈钢, 高光泽

| 系列 | 铰链           | 铰链           | 小叶表面             | 中叶表面             | 大叶表面             |
|----|--------------|--------------|------------------|------------------|------------------|
| 1  | N6-4E-422-20 | N6-4E-422-24 | N6-C-42-24(每边两个) | —                | —                |
| 2  | N6-4E-424-20 | N6-4E-424-24 | N6-C-42-24       | N6-C-44-24       | —                |
| 3  | N6-4E-426-20 | N6-4E-426-24 | N6-C-42-24       | —                | N6-C-46-24       |
| 4  | N6-4E-444-20 | N6-4E-444-24 | —                | N6-C-44-24(每边两个) | —                |
| 5  | N6-4E-446-20 | N6-4E-446-24 | —                | N6-C-44-24       | N6-C-46-24       |
| 6  | N6-4E-466-20 | N6-4E-466-24 | —                | —                | N6-C-46-24(每边两个) |

# N6 铰链

表面安装·304 或 316 不锈钢



## 系列4 (参阅零件号表格)

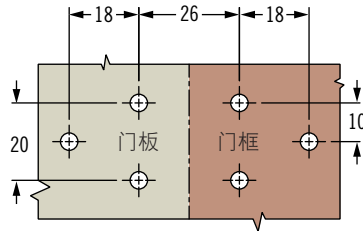
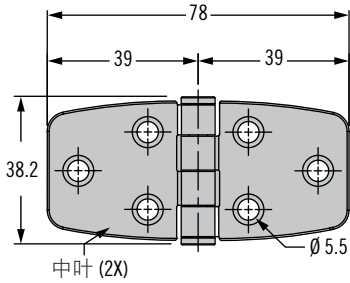

## 系列5 (参阅零件号表格)

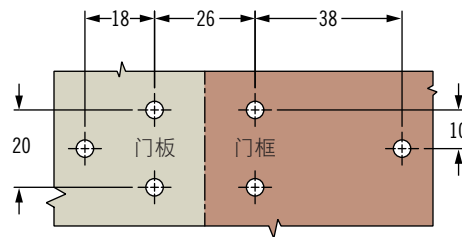
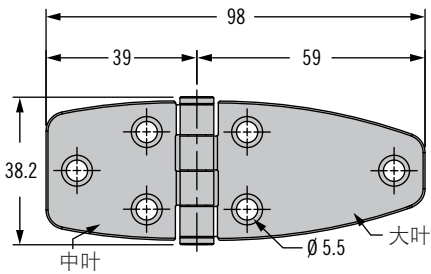

## 系列6 (参阅零件号表格)

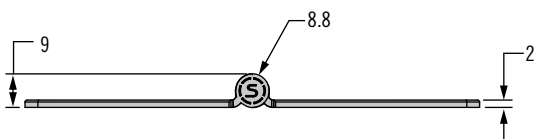
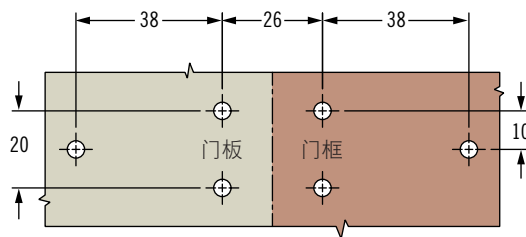
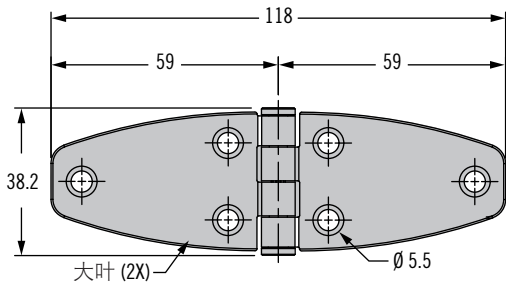

需另外订购盖面

供小叶用: 型号N6-C-42-24

供大叶用: 型号N6-C-46-24

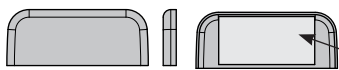

粘合胶纸  
(所有盖面均有)

供中叶用: 型号N6-C-44-24

