



# P7 CompactPCI® Inject / Eject Mechanism Ejectors

- Ergonomic design for easy operation
- Button protected to prevent accidental operation
- Button disengages microswitch prior to rotation of ejector handle
- Optional integrated microswitch

## Material and Finish

Ejector base and jaws:  
Zinc alloy, nickel plated  
Ejector cover: PC/ABS black  
Ejector button: PC/ABS red  
Torsion spring: Stainless steel  
Pin and faceplate mounting screws:  
Steel, zinc plated

## Performance Details

Flammability rating: UL94-V0  
CompactPCI is a registered trademark of PICMG® - PCI Industrial Computer Manufacturers Group, Inc.

## Upper Ejector

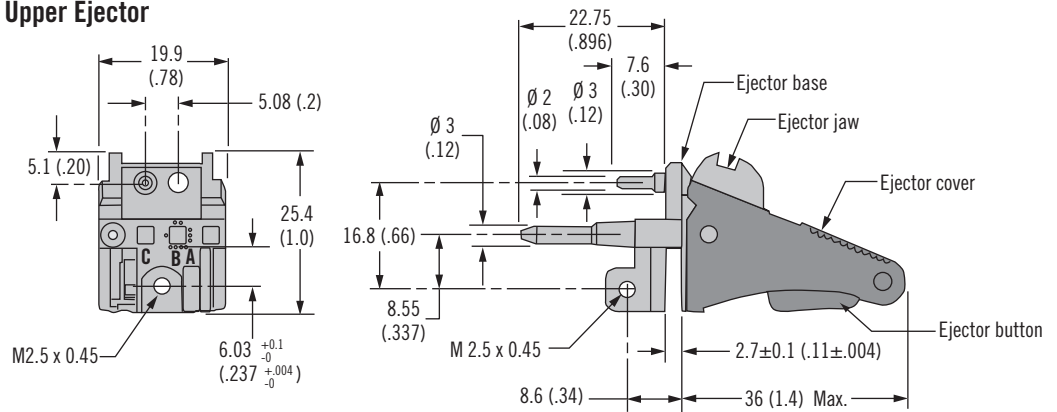

### Part Number

**P7-1-981-10**

## Lower Ejector (for use with microswitch)

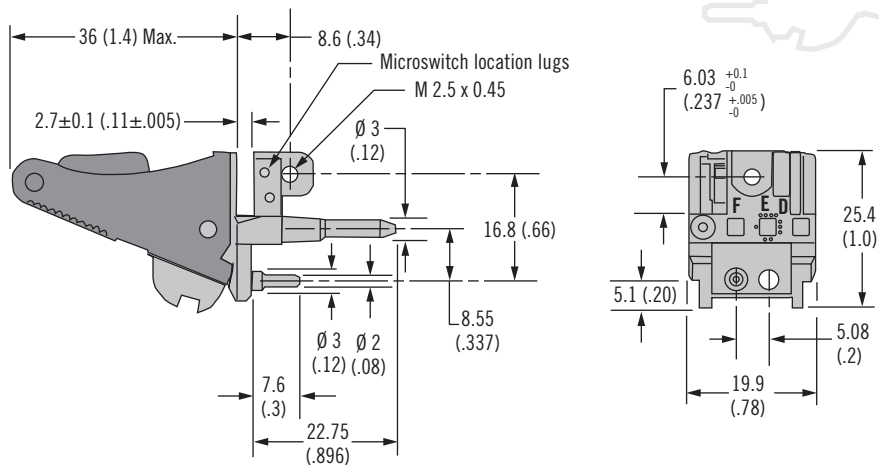

### Part Number

**P7-1-991-10**

## Faceplate Travel

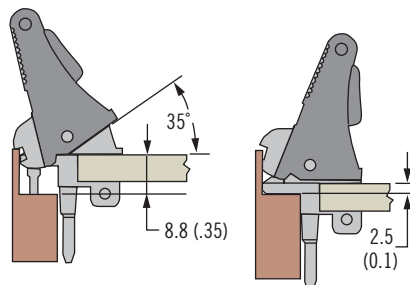

**Note:** 6.3 (0.24) total travel

Dimensions in millimeters (inch) unless otherwise stated

# P7 CompactPCI® Inject / Eject Mechanism

## Faceplate mounting hardware accessories

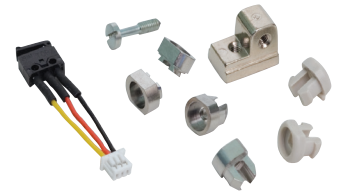

### Faceplate Preparation 6U and 9U

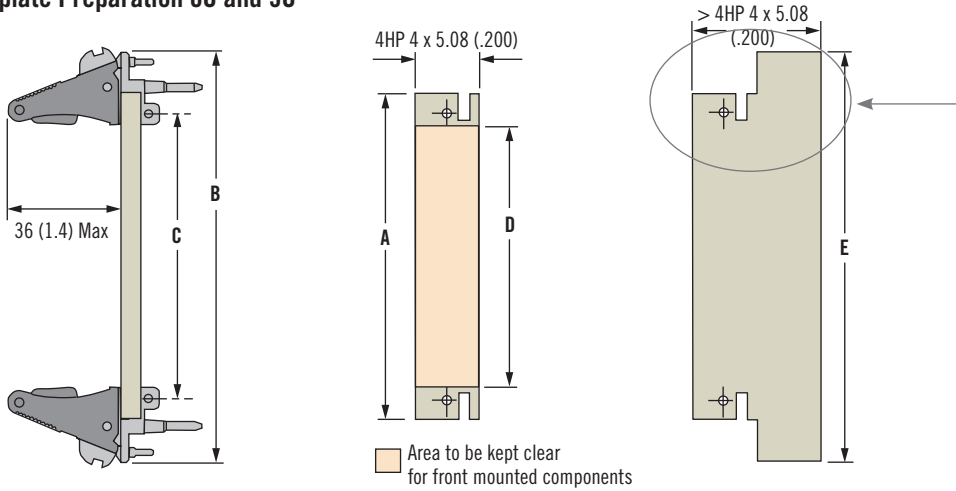

### 3U

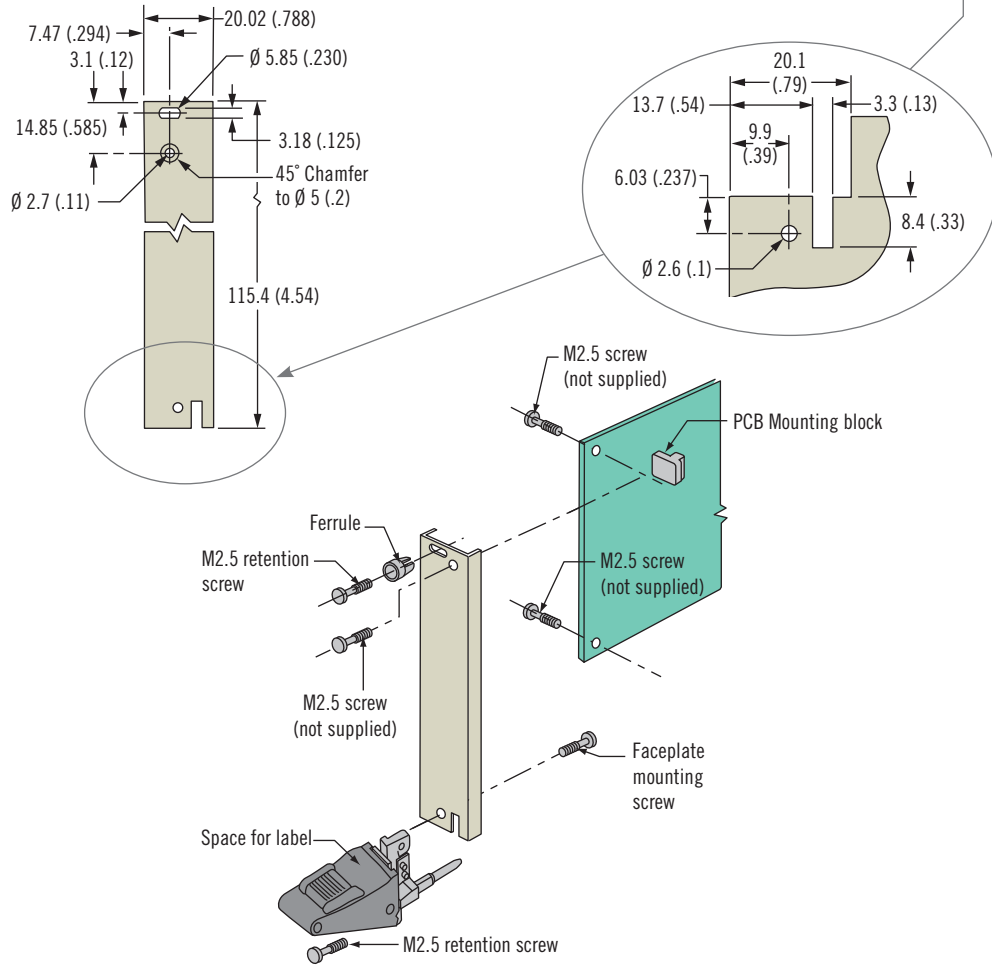

### Microswitch assembly:

Attaches to ejector, allows for hot swap

Part number: P7-0-46720



### M2.5 Retention screw:

Used with ferrules and ejectors

Material and finish: Steel, plated

Part number: P7-0-45297



### 3U Hardware

Captivates M2.5 screw on faceplate

### Snap-in ferrule:

Faceplate thickness

1.6 - 2.5 (.063 - .098)

Material and finish: ABS

Part number: P7-0-45227



### Press-in ferrule:

Faceplate thickness

1.5 - 2.4 (.059 - .094)

Material and finish: Steel, plated

Part number: P7-0-45302



### Press-in ferrule flush:

Minimum panel thickness 0.9 (.035)

Material and finish: Steel, plated

Part number: P7-0-45244



### PCB Mounting block:

Used to mount PCB in place of ejector

Material and finish: Zinc alloy, plated

Part number: P7-0-45234



### Notes

All panel preparation tolerances ±0.1 (.004)

Style	A	B	C	D	E
6U	235.4 (9.27)	255.85 (10.073)	222.25 (8.750)	214.65 (8.451)	262.05 (10.317)
9U	368.75 (14.518)	389.2 (15.323)	355.6 (14.00)	348 (13.701)	395.4 (15.567)

CompactPCI is a registered trademark of PICMG® - PCI Industrial Computer Manufacturers Group, Inc.

Dimensions in millimeters (inch) unless otherwise stated